

Submit to Appropriate
District Office
State Lease - 6 copies
Fee Lease - 5 copies

State of New Mexico
Energy, Minerals and Natural Resources Department

Form C-101
Revised 1-1-89

DISTRICT I
P.O. Box 1980, Hobbs, NM 88240

DISTRICT II
P.O. Drawer DD, Artesia, NM 88210

DISTRICT III
1000 Rio Brazos Rd., Aztec, NM 87410

OIL CONSERVATION DIVISION

P.O. Box 2088
Santa Fe, New Mexico 87504-2088

API NO. (assigned by OCD on New Wells)

30-015-26238

5. Indicate Type of Lease

STATE ☒ FEE ☐

6. State Oil & Gas Lease No.

LG-0465

7. Lease Name or Unit Agreement Name

Mary Wolf State

8. Well No.

5

9. Pool name or Wildcat

W. Millman-Grayburg

APPLICATION FOR PERMIT TO DRILL, DEEPEN, OR PLUG BACK

1a. Type of Work:

DRILL ☒

RE-ENTER ☐

DEEPEN ☐

PLUG BACK ☐

b. Type of Well:

OIL
WELL ☒

GAS
WELL ☐

OTHER ☐

SINGLE
ZONE ☐

MULTIPLE
ZONE ☐

2. Name of Operator

Southwest Royalties

3. Address of Operator

P. O. Drawer 11390, Midland, Texas 79702

4. Well Location

Unit Letter M : 330 Feet From The South Line and 990 Feet From The West Line

Section

12

Township

19S

Range

27E

NMPM

Eddy

County

10. Proposed Depth

2500'

11. Formation

12. Rotary or C.T.

Rotary

13. Elevations (Show whether DF, RT, GR, etc.)

3456' Grd.

14. Kind & Status Plug Bond

Statewide

15. Drilling Contractor

United Drilling

16. Approx. Date Work will start

December 1, 1989

17.

PROPOSED CASING AND CEMENT PROGRAM

SIZE OF HOLE	SIZE OF CASING	WEIGHT PER FOOT	SETTING DEPTH	SACKS OF CEMENT	EST. TOP
12 1/4"	8 5/8"	24#	320'	300	
7 7/8"	5 1/2"	10.5-15.5#	2500	450	

Plan to spud on or about December 1, 1989 with a 12 1/4" bit. Set 320' of 8 5/8" with 300 sxs. Drill out with a 7 7/8" bit with 10# brine to a total depth of 2500' or less. If commercial shows are present, 5 1/2" casing will be set with 450 sxs. or sufficient to circulate to surface. If dry hole, proper plugs will be set as directed by the N. M. O. C. D.

Part ID-1
11-12-89
New Loc &
API

APPROVAL VALID FOR 180 DAYS

RENEWED BY 5/15/90

UNLESS DRILL UNDERWAY

IN ABOVE SPACE DESCRIBE PROPOSED PROGRAM: IF PROPOSAL IS TO DEEPEN OR PLUG BACK, GIVE DATA ON PRESENT PRODUCTIVE ZONE AND PROPOSED NEW PRODUCTIVE ZONE. GIVE BLOWOUT PREVENTER PROGRAM, IF ANY.

I hereby certify that the information above is true and complete to the best of my knowledge and belief.

SIGNATURE Rebecca Olson TITLE Agent DATE 11-9-89

TYPE OR PRINT NAME Rebecca Olson (505) TELEPHONE NO 746-6520

(This space for State Use) ORIGINAL SIGNED BY

APPROVED BY SUPERVISOR, DISTRICT II TITLE DATE NOV 15 1989

CONDITIONS OF APPROVAL, IF ANY:

NOTIFY N.M.O.C.D. IN SUFFICIENT
TIME TO WITNESS CEMENTING THE

8 5/8"

MEXICO OIL CONSERVATION COMM. 4
WELL LOCATION AND ACREAGE DEDICATION PLAT

Form C-102
Supersedes C-128
Effective 1-1-65

All distances must be from the outer boundaries of the Section

Operator SOUTHWEST ROYALTIES			Lease Mary Wolf State		Well No. 5
Unit Letter M	Section 12	Township 19 South	Range 27 East	County Eddy County, N.M.	
Actual Footage Location of Well: 330 feet from the South line and 990 feet from the West line					
Ground Level Elev. 3456.	Producing Formation <i>Permian</i>		Pool <i>Permian</i>		Dedicated Acreage: <i>1.2</i> Acres

1. Outline the acreage dedicated to the subject well by colored pencil or hachure marks on the plat below.
2. If more than one lease is dedicated to the well, outline each and identify the ownership thereof (both as to working interest and royalty).
3. If more than one lease of different ownership is dedicated to the well, have the interests of all owners been consolidated by communitization, unitization, force-pooling, etc?

☐ Yes ☐ No If answer is "yes," type of consolidation _____

If answer is "no," list the owners and tract descriptions which have actually been consolidated. (Use reverse side of this form if necessary.) _____

No allowable will be assigned to the well until all interests have been consolidated (by communitization, unitization, forced-pooling, or otherwise) or until a non-standard unit, eliminating such interests, has been approved by the Commission.

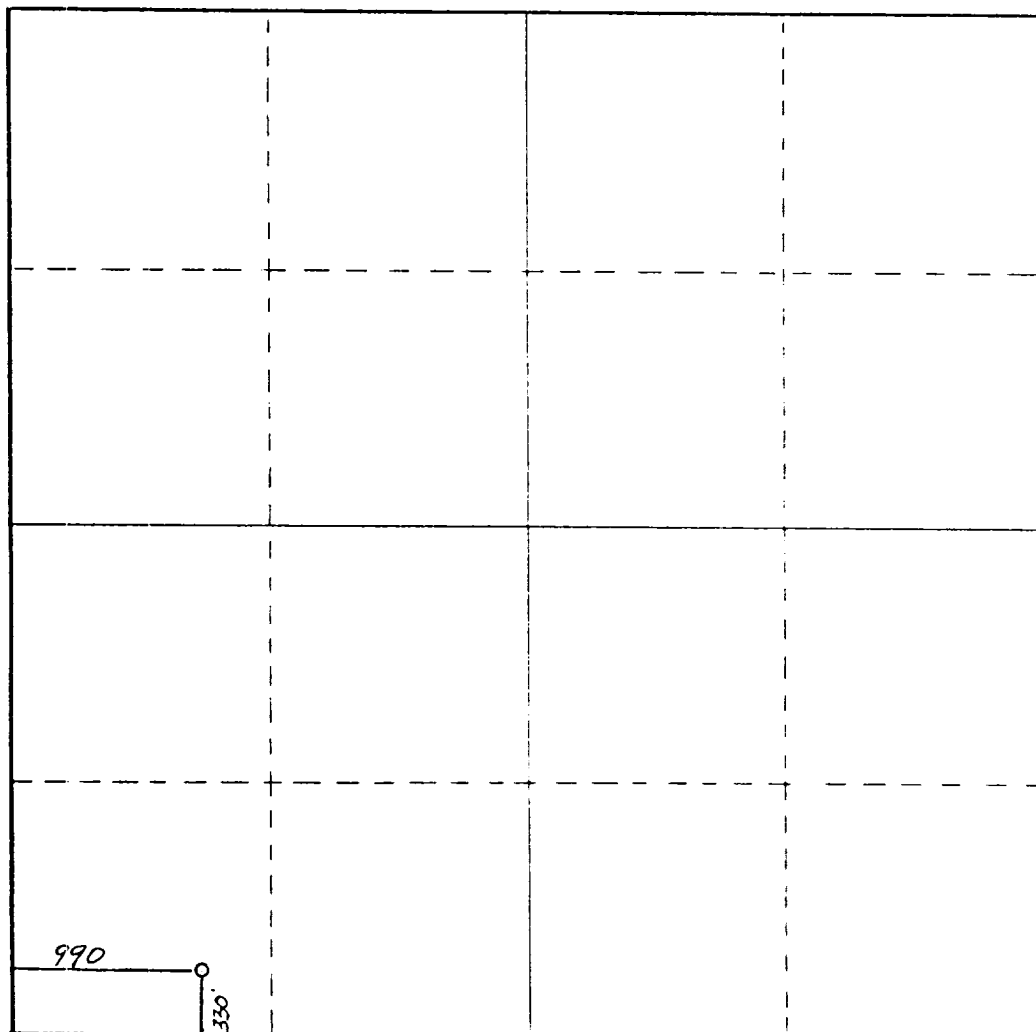

CERTIFICATION

I hereby certify that the information contained herein is true and complete to the best of my knowledge and belief.

Rebecca Olson

Name

Rebecca Olson

Position

Agent

Company

Southwest Royalties

Date

November 9, 1989

I hereby certify that the well location shown on this plat was plotted from field notes of actual surveys made by me or under my supervision, and that the same is true and correct to the best of my knowledge and belief.

Date Surveyed

November 9, 1989

Registered Professional Engineer and/or Land Surveyor

Jan R. Reddy

Certificate No.

NM PRALS NO. 5412

