

UNITED STATES
DEPARTMENT OF THE INTERIOR
BUREAU OF LAND MANAGEMENT

SUBMIT IN TRIPL
(Other instructions
verse side)

Form approved.
Budget Bureau No. 1004-0135
Expires August 31, 1985

5. LEASE DESIGNATION AND SERIAL NO

LC-058709-A

6. IF INDIAN, ALLOTTEE OR TRIBE NAME

7. UNIT AGREEMENT NAME

8. FARM OR LEASE NAME

West Taylor 12 Federal

9. WELL NO.

#1

10. FIELD AND POOL, OR WILDCAT

Wildcat San Andres

11. SEC., T., R., M., OR BLK. AND
SURVEY OR AREA

Sec. 12, T18S, R31E

12. COUNTY OR PARISH 13. STATE

Eddy

NM

1. OIL WELL ☒ GAS WELL ☐ OTHER ☐

2. NAME OF OPERATOR

Harvey E. Yates Company

3. ADDRESS OF OPERATOR

P.O. Box 1933, Roswell, N.M. 88202

4. LOCATION OF WELL (Report location clearly and in accordance with any State requirements.*
See also space 17 below.)

At surface

2210' FSL & 440' FWL

14. PERMIT NO.

15. ELEVATIONS (Show whether DF, RT, GR, etc.)

3754.8 GL

16. Check Appropriate Box To Indicate Nature of Notice, Report, or Other Data

NOTICE OF INTENTION TO:

SUBSEQUENT REPORT OF:

TEST WATER SHUT-OFF

PULL OR ALTER CASING

WATER SHUT-OFF

REPAIRING WELL

FRACTURE TREAT

MULTIPLE COMPLETE

FRACTURE TREATMENT

ALTERING CASING

SHOOT OR ACIDIZE

ABANDON*

SHOOTING OR ACIDIZING

ABANDONMENT*

REPAIR WELL

CHANGE PLANE

(Other) Footage change

(Other)

(NOTE: Report results of multiple completion on Well
Completion or Recompletion Report and Log form.)

17. DESCRIBE PROPOSED OR COMPLETED OPERATIONS (Clearly state all pertinent details, and give pertinent dates, including estimated date of starting any proposed work. If well is directionally drilled, give subsurface locations and measured and true vertical depths for all markers and zones pertinent to this work.)*

Please see enclosures for footage changes on the above captioned well.

From 1740' FSL & 660' FWL to 2210' FSL & 440' FWL.

SJS

Post ID-1
2-8-91
Amended Doc.

18. I hereby certify that the foregoing is true and correct

SIGNED

V. Teel

V. Teel

TITLE

Production Analyst

DATE

12/21/90

(This space for Federal or State office use)

APPROVED BY

TITLE

DATE

1/28/91

CONDITIONS OF APPROVAL, IF ANY:

*See Instructions on Reverse Side

OIL CONSERVATION DIVISION

DISTRICT I
P.O. Box 1980, Hobbs, NM 88240

P.O. Box 2088

Santa Fe, New Mexico 87504-2088

DISTRICT II
P.O. Drawer DD, Artesia, NM 88210

DISTRICT III
1000 Rio Brazos Rd., Aztec, NM 87410

WELL LOCATION AND ACREAGE DEDICATION PLAT

All Distances must be from the outer boundaries of the section

Operator HARVEY E. YATES CO.			Lease West Taylor 12 Federal		Well No. 1
Unit Letter L	Section 12	Township 18 South	Range 31 East	County Eddy	
Actual Footage Location of Well: 2210' feet from the South line and 440' feet from the West line					
Ground level Elev. 3754.8	Producing Formation San Andres		Pool Wildcat	Dedicated Acreage: 40 Acres	

1. Outline the acreage dedicated to the subject well by colored pencil or hatchure marks on the plat below.

2. If more than one lease is dedicated to the well, outline each and identify the ownership thereof (both as to working interest and royalty).

3. If more than one lease of different ownership is dedicated to the well, have the interest of all owners been consolidated by communitization, unitization, force-pooling, etc.?

☐ Yes ☐ No If answer is "yes" type of consolidation _____

If answer is "no" list the owners and tract descriptions which have actually been consolidated. (Use reverse side of this form if necessary.)

No allowable will be assigned to the well until all interests have been consolidated (by communitization, unitization, forced-pooling, or otherwise) or until a non-standard unit, eliminating such interest, has been approved by the Division.

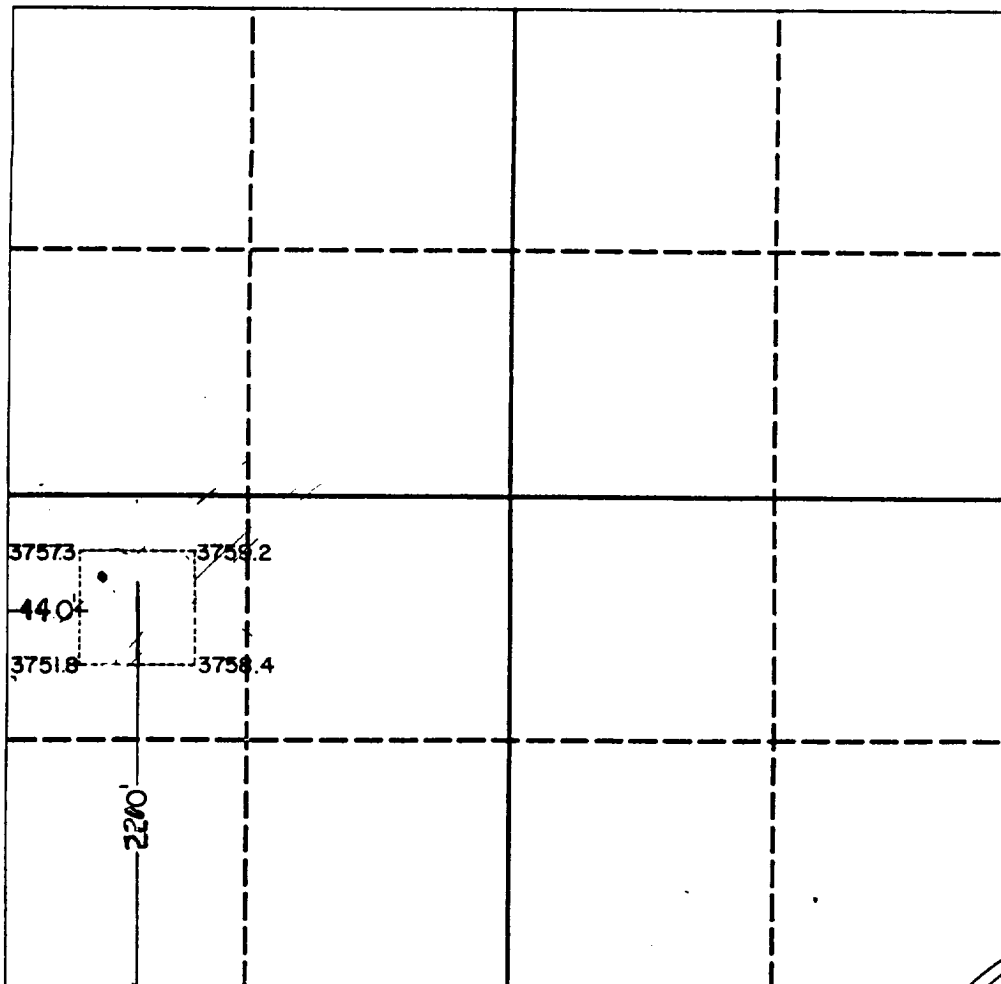

OPERATOR CERTIFICATION

I hereby certify that the information contained herein is true and complete to the best of my knowledge and belief.

Signature

Dan Girand

Printed Name

Contracts Administrator

Position

Harvey E. Yates Company

Company

12/21/90

Date

SURVEYOR CERTIFICATION

I hereby certify that the well location shown on this plat was plotted from field notes of actual surveys made by me or under my supervision, and that the same is true and correct to the best of my knowledge and belief.

Date Surveyed

September 13, 1990

Signature & Seal of Professional Surveyor

JOHN W. WEST
676
7977

HARVEY E. YATES COMPANY

P O BOX 1933

SUITE 300, SECURITY NATIONAL BANK BUILDING

505:523-6601

ROSWELL, NEW MEXICO 88201

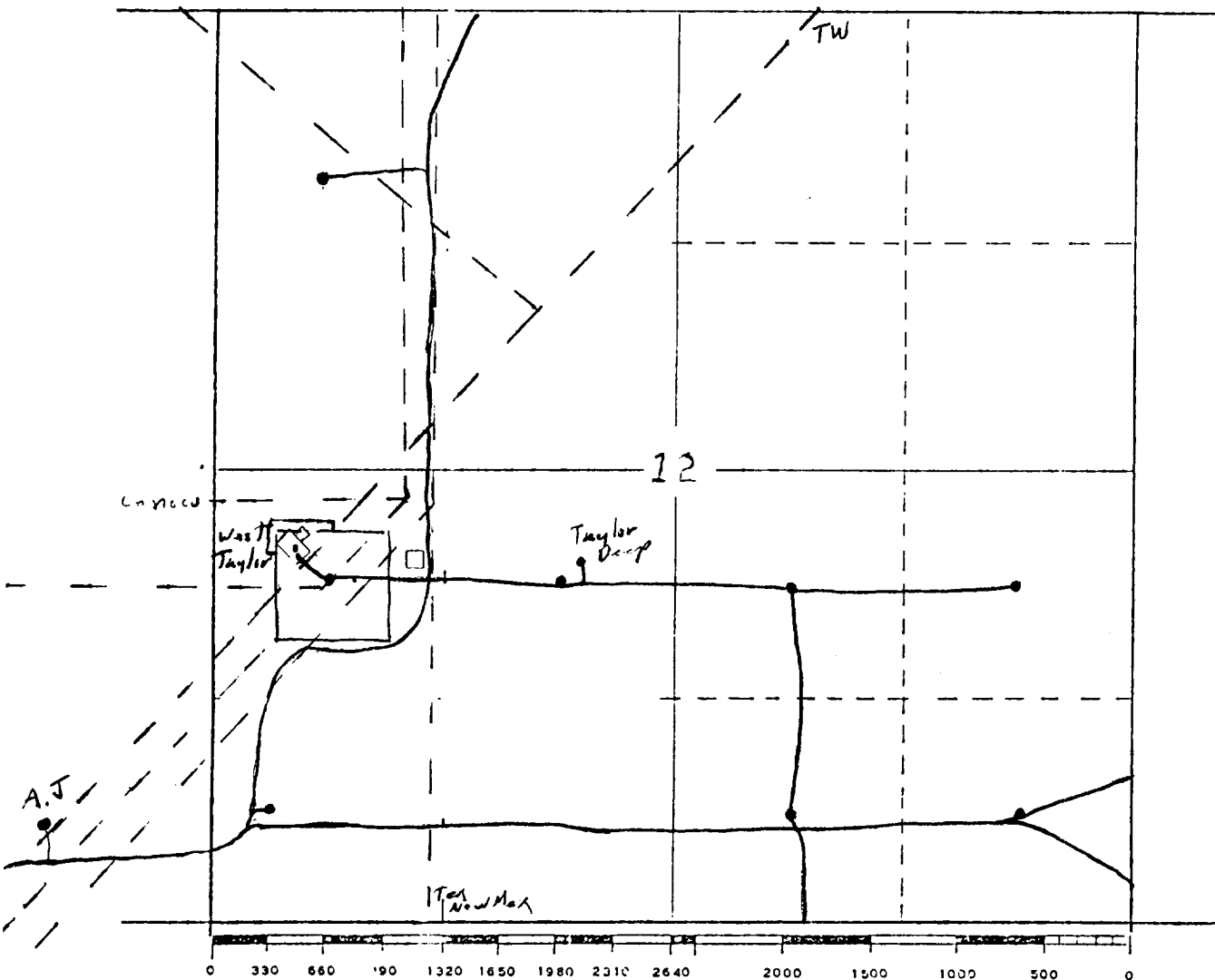

SCALE: 1" = 1000'

OPERATOR:

FIELD:

LEASE:

ACRES IN LEASE:

DESCRIPTION:

- ☐ Area covered
 by Arabi survey
 --- Pipeline
 — Road
 • Location
☐ Conoco compressor

DATE: