

marbob
energy corporation

MAR 19 1991

O. C. D.
ARTESIA, OFFICE

March 19, 1991

Bureau of Land Management
P.O. Box 1778
Carlsbad, NM 88220

Attn: Barry Hunt

Re: Patriot Federal No. 1
LC-065591
K-Sec. 12, T-17S, R-29E
Eddy County, New Mexico

Dear Barry:

Recently, we submitted a Surface Use Plan accompanied with maps, supporting documents, and Surveyor's plat for the above referenced location. Subsequently, Pecos Archaeology Consultants surveyed the location and recommended that we relocate the planned well-bore two-hundred (200) feet to the north of the original staking so that a certain potentially significant Indian site might be avoided. Therefore, we submit a revised C-102 survey plat, a topographical map (Exhibit A), and a map of Eddy County (Exhibit C) to be inserted with the original Application for Permit to Drill and the Surface Use Plan. Also, Barry, Central Valley Electric will provide electrical service to this location, so they will need to apply for Right-of-Way and any other permits that may be required.

Barry, please call me at 748-3303 if you should have any questions concerning this. Thank you for your help in this matter.

Sincerely,

David Martin
Land Department

DM/mm
Enclosures

Submit to Appropriate
District Office
State Lease - 4 copies
Fee Lease - 3 copies

State of New Mexico
Energy, Minerals and Natural Resources Department

Form C-102
Revised 1-1-89

OIL CONSERVATION DIVISION

P.O. Box 2088
Santa Fe, New Mexico 87504-2088

MAR 19 1991

DISTRICT I
P.O. Box 1980, Hobbs, NM 88240

DISTRICT II
P.O. Drawer DD, Artesia, NM 88210

O. C. D.
ARTESIA, OFFICE

DISTRICT III
1000 Rio Brazos Rd., Aztec, NM 87410

WELL LOCATION AND ACREAGE DEDICATION PLAT

All Distances must be from the outer boundaries of the section

Operator MARBOB ENERGY CORP.			Lease PATRIOT FEDERAL		Well No. 1
Unit Letter K	Section 12	Township 17 SOUTH	Range 29 EAST	County EDDY	
Actual Footage Location of Well: 1850 feet from the SOUTH line and 2310 feet from the WEST line					
Ground level Elev. 3646.6	Producing Formation San Andres	Pool Square Lake Grbg SA		Dedicated Acreage: 40 Acres	

1. Outline the acreage dedicated to the subject well by colored pencil or hatchure marks on the plat below.

2. If more than one lease is dedicated to the well, outline each and identify the ownership thereof (both as to working interest and royalty).

3. If more than one lease of different ownership is dedicated to the well, have the interest of all owners been consolidated by communitization, unitization, force-pooling, etc.?

☐ Yes ☐ No If answer is "yes" type of consolidation _____

If answer is "no" list the owners and tract descriptions which have actually been consolidated. (Use reverse side of this form if necessary.)

No allowable will be assigned to the well until all interests have been consolidated (by communitization, unitization, forced-pooling, or otherwise) or until a non-standard unit, eliminating such interest, has been approved by the Division.

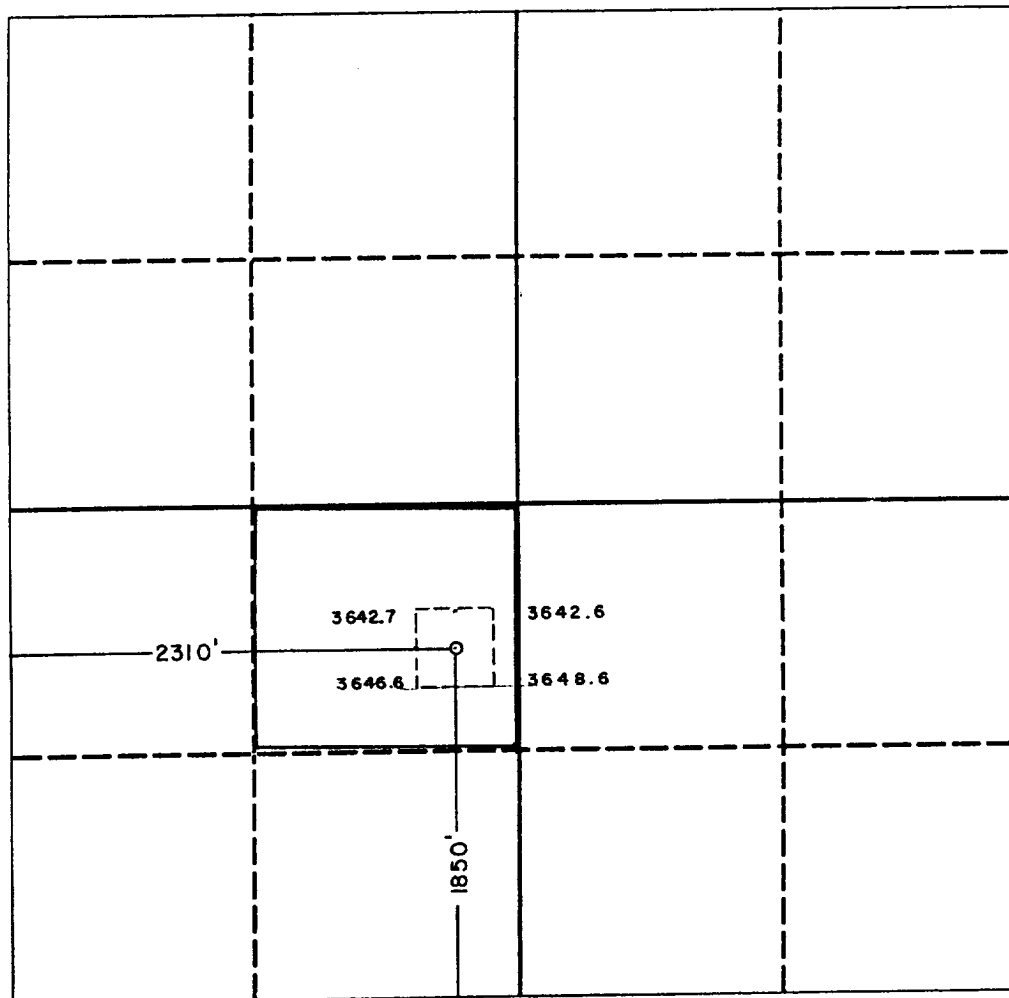

OPERATOR CERTIFICATION

I hereby certify that the information contained herein is true and complete to the best of my knowledge and belief.

Signature

Robin Smith

Printed Name

Robin Smith

Position

Production Clerk

Company

Marbob Energy Corporation

Date

March 19, 1991

SURVEYOR CERTIFICATION

I hereby certify that the well location shown on this plat was plotted from field notes of actual surveys made by me or under my supervision, and that the same is true and correct to the best of my knowledge and belief.

Date Surveyed

2-25-91

Signature & Seal of
Professional Surveyor

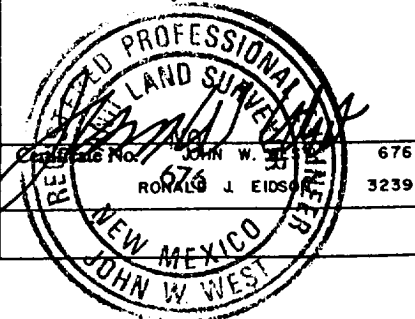

528 000
HENSLEY TANK

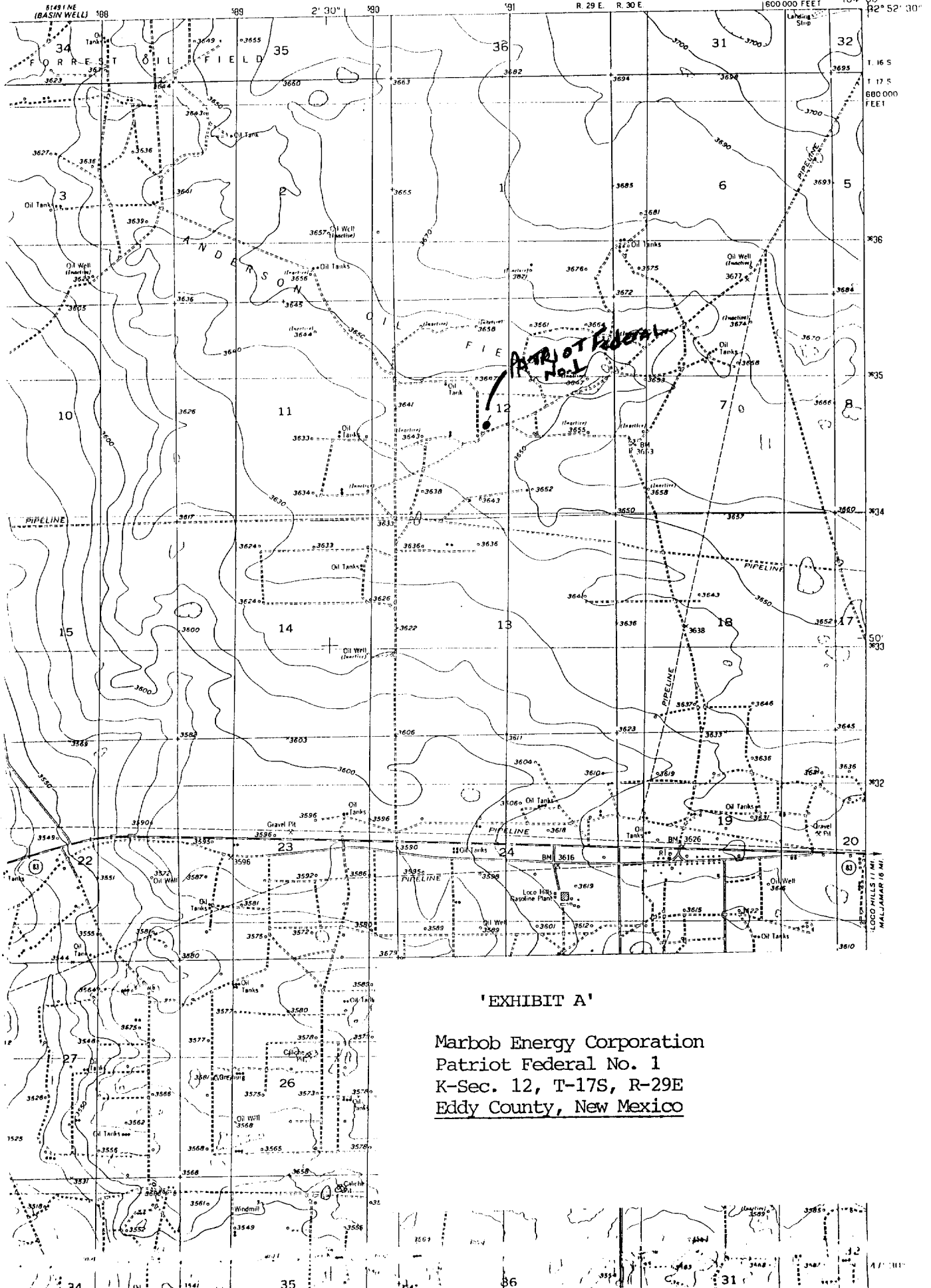

'EXHIBIT A'

Marbob Energy Corporation
Patriot Federal No. 1
K-Sec. 12, T-17S, R-29E
Eddy County, New Mexico

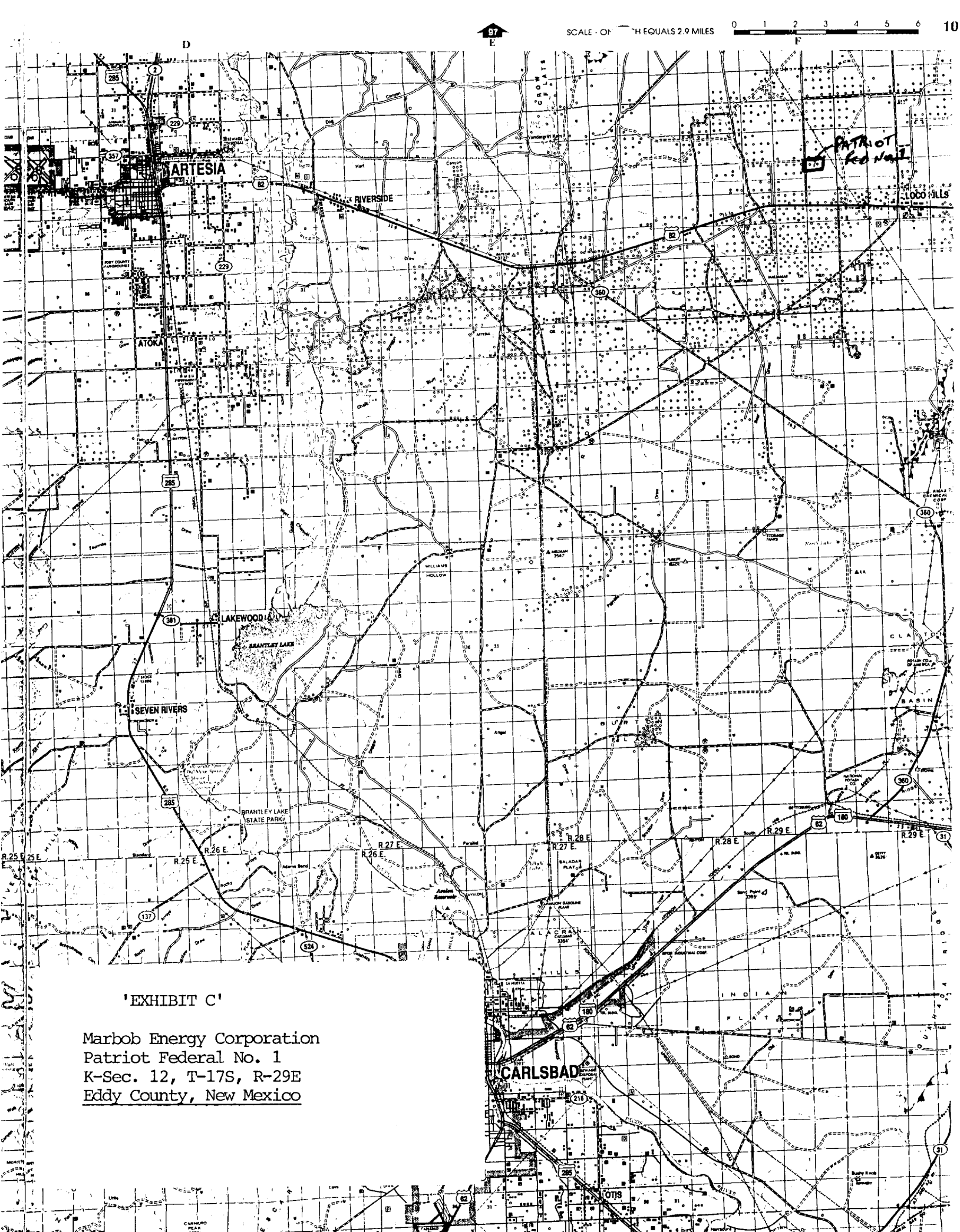

'EXHIBIT C'

Marbob Energy Corporation
Patriot Federal No. 1
K-Sec. 12, T-17S, R-29E
Eddy County, New Mexico