

OIL CONSERVATION DIVISION

P.O. Box 2088

Santa Fe, New Mexico 87504-2088

DISTRICT I

P.O. Box 1980, Hobbs, NM 88240

DISTRICT II

P.O. Drawer 50, Artesia, NM 88210

DISTRICT III

1000 Rio Grande Rd., Aztec, NM 87410

WELL LOCATION AND ACREAGE DEDICATION PLAT

All Distances must be from the outer boundaries of the section

Operator Bird Creek Resources Inc			Lease RML Federal		Well No. 2
Unit Letter N	Section 26	Township 22 South	Range 28 East	County NMNM	Eddy
Actual Footage Location of Well: 330 feet from the south line and 1650 feet from the west line					
Ground Level Elev. 3092.2'	Producing Formation Delaware/Bone Spring	Pool Undesignated	Dedicated Acreage: 40/80 Acres		

1. Outline the acreage dedicated to the subject well by colored pencil or backbone marks on the plat below.
2. If more than one lease is dedicated to the well, outline each and identify the ownership thereof (both as to working interest and royalty).
3. If more than one lease of different ownership is dedicated to the well, have the interest of all owners been consolidated by communization, unitization, force-pooling, etc.?

☐ Yes ☐ No If answer is "yes" type of consolidation _____

If answer is "no" list of owners and tract descriptions which have actually been consolidated. (Use reverse side of this form necessary.)

No allowable will be assigned to the well unit all interests have been consolidated (by communization, unitization, force-pooling, otherwise) or until a non-standard unit, eliminating such interest, has been approved by the Division.

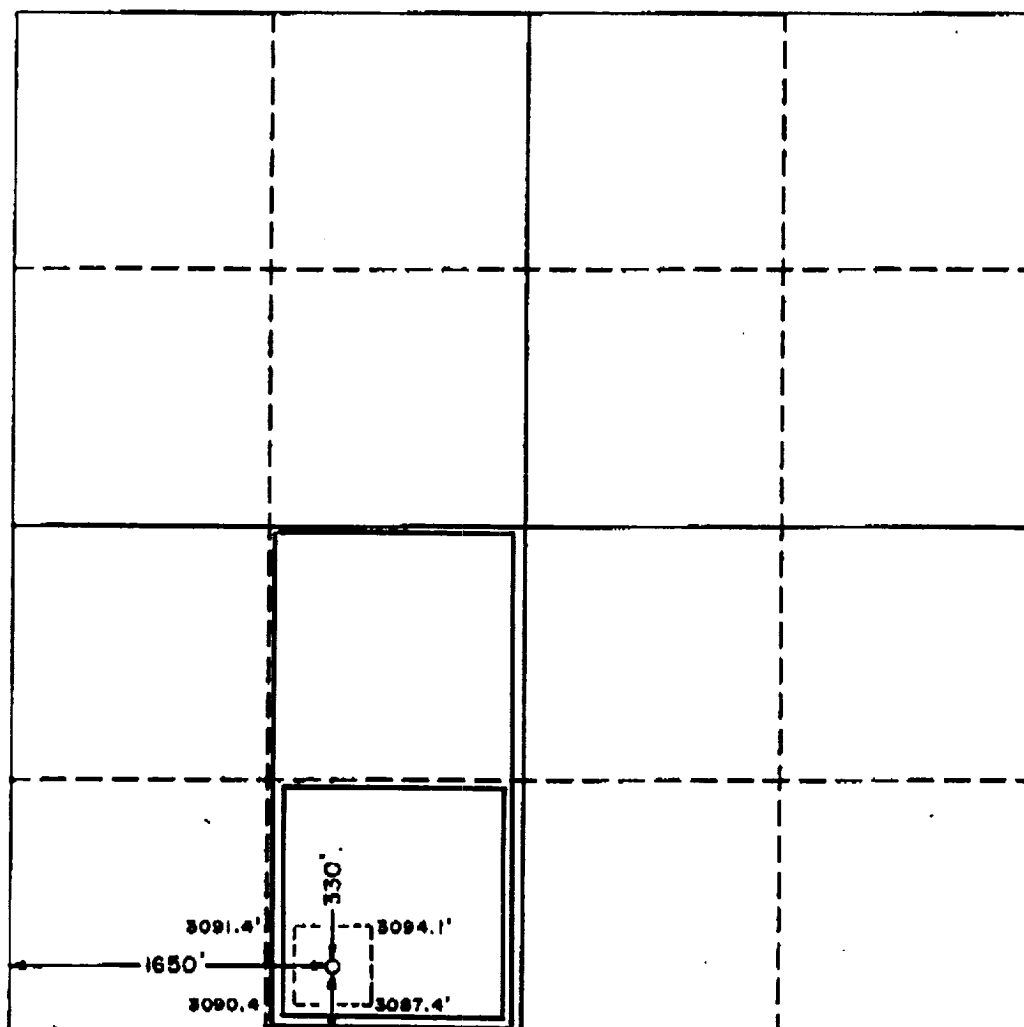

OPERATOR CERTIFICATION

I hereby certify the the information contained herein is true and complete to the best of my knowledge and belief.

Signature
Brad D. Burks
Printed Name
Brad D. Burks

Petition
Agent, PE 16172

Company
Bird Creek Resources, Inc.

Date
3-5-92

SURVEYOR CERTIFICATION

I hereby certify that the well location shown on this plat was plotted from field notes of actual surveys made by me or under my supervision, and that the same is true and correct to the best of my knowledge and belief.

Date Surveyed
March 3, 1992

Signature & Seal of
Professional Surveyor

James E. Jones
Certificate No. JOHN W. WEST, 678
RONALD A. EASON, 2839
JAMES E. JONES, 7877