

OIL CONSERVATION DIVISION

P.O. Box 2088
Santa Fe, New Mexico 87504-2088

DISTRICT I

P.O. Box 1980, Hobbs, NM 88240

DISTRICT II

P.O. Drawer DD, Artesia, NM 88210

DISTRICT III

1000 Rio Brazos Rd., Aztec, NM 87410

WELL LOCATION AND ACREAGE DEDICATION PLAT

All Distances must be from the outer boundaries of the section

Operator MERIT ENERGY COMPANY			Lease SUNDANCE FEDERAL		Well No. 2
Unit Letter D	Section 4	Township 24 SOUTH	Range 31 EAST	County EDDY	

Actual Footage Location of Well:

1250 feet from the NORTH line and		1250 feet from the WEST line	
Ground Level Elev. 3391.8'	Producing Formation DELAWARE	Pool Wildcat	Dedicated Acreage: 40 Acres

- Outline the acreage dedicated to the subject well by colored pencil or hatchure marks on the plat below.
- If more than one lease is dedicated to the well, outline each and identify the ownership thereof (both as to working interest and royalty).
- If more than one lease of different ownership is dedicated to the well, have the interest of all owners been consolidated by communitization, unitization, force-pooling, etc.?
☐ Yes ☐ No If answer is "yes" type of consolidation _____

If answer is "no" list of owners and tract descriptions which have actually been consolidated. (Use reverse side of this form necessary.)

No allowable will be assigned to the well unit all interests have been consolidated (by communitization, unitization, forced-pooling, otherwise) or until a non-standard unit, eliminating such interest, has been approved by the Division.

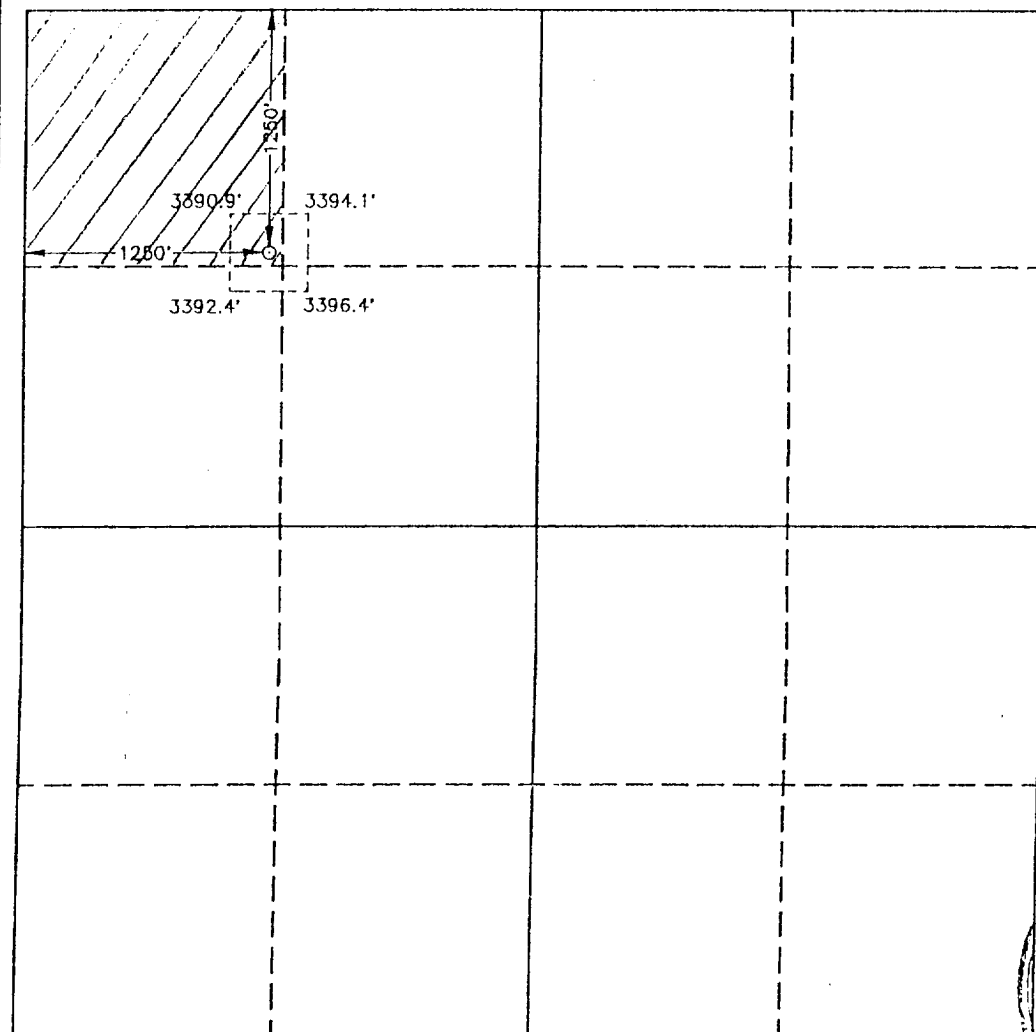

OPERATOR CERTIFICATION

I hereby certify the the information contained herein is true and complete to the best of my knowledge and belief.

Signature
Russell Whitel
Printed Name
Russell Whitel
Position
Production Supt.
Company
Merit Energy Company
Date

SURVEYOR CERTIFICATION

I hereby certify that the well location shown on this plat was plotted from field notes of actual surveys made by me or under my supervision, and that the same is true and correct to the best of my knowledge and belief.

Date Surveyed
OCTOBER 5, 1992

Signature & Seal of
Professional Surveyor

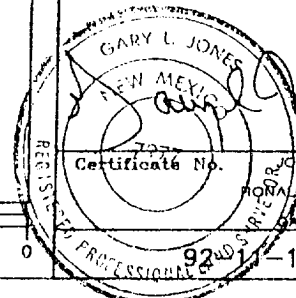

JOHN W. WEST, 676
RONALD J. EIDSON, 3239
GARY L. JONES, 7977

9200-1-1472

0 330 660 990 1320 1650 1980 2310 2640 2000 1500 1000 500 0