

Submit to Appropriate
District Office
State Lease - 6 copies
Fee Lease - 5 copies

State of New Mexico
Energy, Minerals and Natural Resources Department

Form C-101
Revised 1-1-89

OIL CONSERVATION DIVISION

DISTRICT I
P.O. Box 1980, Hobbs, NM 88240

DISTRICT II
P.O. Drawer DD, Artesia, NM 88210

DISTRICT III
1000 Rio Brazos Rd., Aztec, NM 87410

P.O. Box 2088
Santa Fe, New Mexico 87504-2088

RECEIVED

MAR 09 1993

API NO. (assigned by OCD on New Wells)

30-015-27393

5. Indicate Type of Lease

STATE ☒

FEE ☐

6. State Oil & Gas Lease No.

APPLICATION FOR PERMIT TO DRILL, DEEPEN, OR PLUG BACK

1a. Type of Work:

DRILL ☒

RE-ENTER ☐

DEEPEN ☐

PLUG BACK ☐

b. Type of Well:

OIL
WELL ☒

GAS
WELL ☐

OTHER

SINGLE
ZONE ☒

MULTIPLE
ZONE ☐

2. Name of Operator

Mack Energy Corporation

3. Address of Operator

P.O. Box 1359, Artesia, NM 88211-1359

7. Lease Name or Unit Agreement Name

G-J West Coop Unit

8. Well No.

#110

9. Pool name or Wildcat

Grayburg Jackson SR QN GB SA

4. Well Location
Unit Letter E

: 2260

Feet From The

North

Line and

990

Feet From The

West

Line

Section

16

Township

17S

Range

29E

NMPM

Eddy

County

10. Proposed Depth
4300'

11. Formation
San Andres

12. Rotary or C.T.
Rotary

13. Elevations (Show whether DF, RT, GR, etc.)

3583.1

14. Kind & Status Plug Bond
Statewide Bond

15. Drilling Contractor
LaRue Drilling

16. Approx. Date Work will start
3/15/93

17. PROPOSED CASING AND CEMENT PROGRAM

SIZE OF HOLE	SIZE OF CASING	WEIGHT PER FOOT	SETTING DEPTH	SACKS OF CEMENT	EST. TOP
17 1/2"	13 3/8"	54.5#	125'	Circulate	
12 1/4"	8 5/8"	24#	800'	Circulate	
7 7/8"	5 1/2"	17#	4300'	Sufficiently attempt to circ.	

Mack Energy proposes to drill to 125', run 13 3/8" casing and cement.
Drill to 800', run 8 5/8" casing and cement. Drill to 4300' and test
San Andres Zone, run 5 1/2" casing and cement, put on production.

Note: On Production string, a fluid caliber will be run, will figure
cement, with 25% excess, attempt to circulate.

POST 10-1
3-8-93
NEW 4 API

IN ABOVE SPACE DESCRIBE PROPOSED PROGRAM: IF PROPOSAL IS TO DEEPEN OR PLUG BACK, GIVE DATA ON PRESENT PRODUCTIVE ZONE AND PROPOSED NEW PRODUCTIVE ZONE. GIVE BLOWOUT PREVENTER PROGRAM, IF ANY.

I hereby certify that the information above is true and complete to the best of my knowledge and belief.

SIGNATURE Crissa D. Carter TITLE Production Clerk DATE 3/5/93

TYPE OR PRINT NAME Crissa D. Carter TELEPHONE NO. 748-1288

(This space for State Use)

APPROVED BY Mark Bailey TITLE Geologist DATE 3-15-93

CONDITIONS OF APPROVAL, IF ANY:

APPROVAL VALID FOR 30 DAYS

1. ALL TERMS 7-15-93

2. ALL TERMS UNDERWAY

Submit to Appropriate
District Office
State Lease - 4 copies
Fee Lease - 3 copies

State of New Mexico
Energy, Minerals and Natural Resources Department

Form C-102
Revised 1-1-89

OIL CONSERVATION DIVISION

DISTRICT I
P.O. Box 1980, Hobbs, NM 88240

P.O. Box 2088

Santa Fe, New Mexico 87504-2088

DISTRICT II
P.O. Drawer DD, Artesia, NM 88210

DISTRICT III
1000 Rio Brazos Rd., Aztec, NM 87410

WELL LOCATION AND ACREAGE DEDICATION PLAT

All Distances must be from the outer boundaries of the section

Operator MACK ENERGY CORPORATION		Lease G.J WEST		Well No. 110	
Unit Letter E	Section 16	Township 17 SOUTH	Range 29 EAST	County EDDY	
Actual Footage Location of Well: 2260 feet from the NORTH line and 990 feet from the WEST line					
Ground Level Elev. 3583.1'	Producing Formation		Pool	Dedicated Acreage: Acres	

1. Outline the acreage dedicated to the subject well by colored pencil or hachure marks on the plat below.
2. If more than one lease is dedicated to the well, outline each and identify the ownership thereof (both as to working interest and royalty).
3. If more than one lease of different ownership is dedicated to the well, have the interest of all owners been consolidated by communitization, unitization, force-pooling, etc.?
☐ Yes ☐ No If answer is "yes" type of consolidation _____

If answer is "no" list of owners and tract descriptions which have actually been consolidated. (Use reverse side of this form necessary.)

No allowable will be assigned to the well unit all interests have been consolidated (by communitization, unitization, forced-pooling, otherwise) or until a non-standard unit, eliminating such interest, has been approved by the Division.

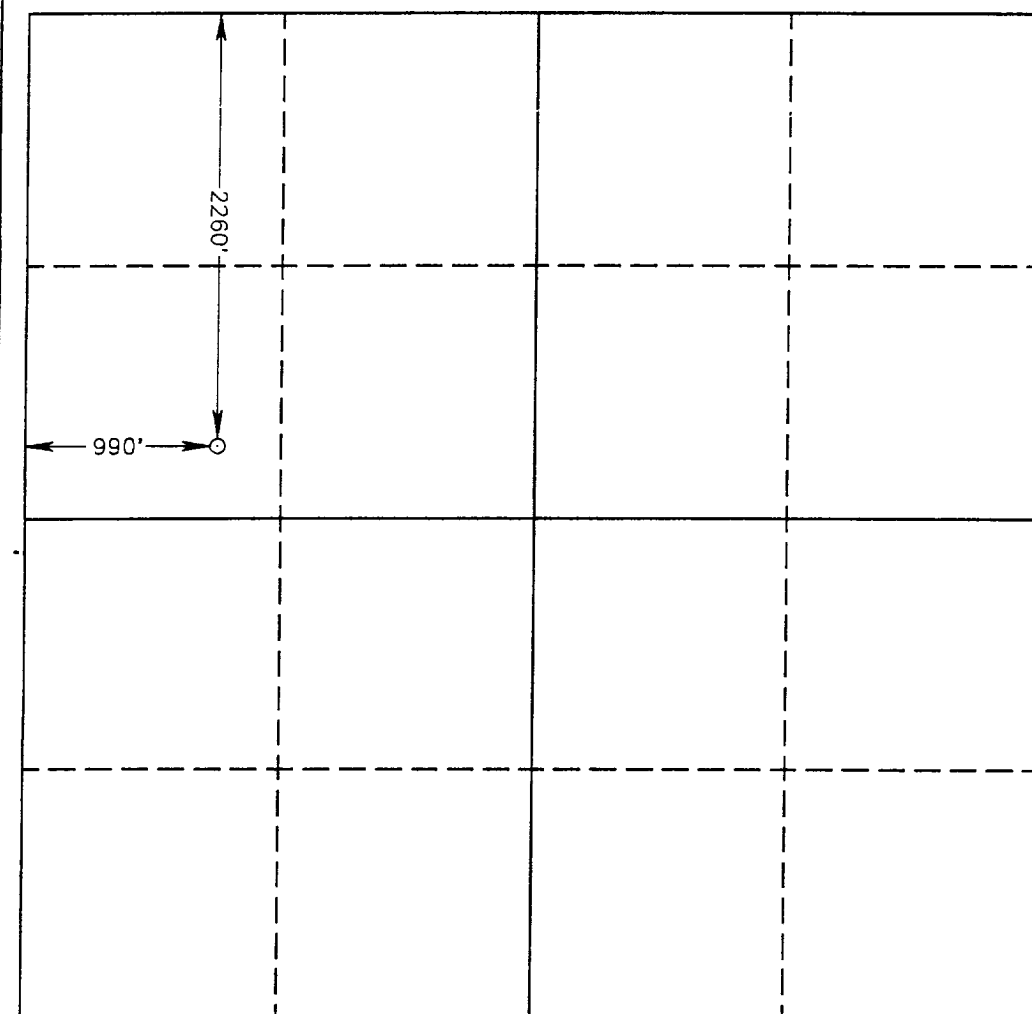

0 330 660 990 1320 1650 1980 2310 2640 2000 1500 1000 500 0

OPERATOR CERTIFICATION

I hereby certify the the information contained herein is true and complete to the best of my knowledge and belief.

Signature
Crissa D. Carter
Printed Name
Crissa D. Carter
Position
Production Clerk
Company
Mack Energy Corporation
Date
3/8/93

SURVEYOR CERTIFICATION

I hereby certify that the well location shown on this plat was plotted from field notes of actual surveys made by me or under my supervision, and that the same is true and correct to the best of my knowledge and belief.

Date Surveyed
MARCH 05, 1993
Signature & Seal of
Professional Surveyor
Angela Jones
Certificate No. JOHN W. WEST, 876
RONALD EDSON, 3239
GARY E. JONES, 7977
63177-10381