

Submit to Appropriate  
District Office  
State Lease - 6 copies  
Fee Lease - 5 copies

State of New Mexico  
Energy, Minerals and Natural Resources Department

Form C-101  
Revised 1-1-89

CITM  
BUT  
850P

DISTRICT I  
P.O. Box 1980, Hobbs, NM 88240

DISTRICT II  
P.O. Drawer DD, Artesia, NM 88210

DISTRICT III  
1000 Rio Brazos Rd., Aztec, NM 87410

OIL CONSERVATION DIVISION  
P.O. Box 2088  
Santa Fe, New Mexico 87504-2088

RECEIVED

API NO. (assigned by OCD on New Wells) 30-015-27636
5. Indicate Type of Lease STATE <input checked="" type="checkbox"/> FEE <input type="checkbox"/>
6. State Oil & Gas Lease No. OG-103
7. Lease Name or Unit Agreement Name Chalk Bluff 6 State
8. Well No. 2
9. Pool name or Wildcat Illinois Camp-Morrow

APPLICATION FOR PERMIT TO DRILL, DEEPEN, OR PLUG BACK					
1a. Type of Work: DRILL <input checked="" type="checkbox"/> RE-ENTER <input type="checkbox"/> DEEPEN <input type="checkbox"/> PLUG BACK <input type="checkbox"/>					
b. Type of Well: OIL WELL <input type="checkbox"/> GAS WELL <input checked="" type="checkbox"/> OTHER <input type="checkbox"/> SINGLE ZONE <input checked="" type="checkbox"/> MULTIPLE ZONE <input type="checkbox"/>					
2. Name of Operator Phillips Petroleum Company					
3. Address of Operator 4001 Penbrook Street, Odessa, TX 79762					
4. Well Location Unit Letter H : 2310 Feet From The North Line and 810 Feet From The East Line Section 6 Township 18-S Range 28-E NMPM Eddy County					
10. Proposed Depth 10,300'		11. Formation Morrow		12. Rotary or C.T. Rotary	
13. Elevations (Show whether DF, RT, GR, etc.) 3655.4 GL (Unprepared)		14. Kind & Status Plug. Bond Blanket		15. Drilling Contractor NA	
16. Approx. Date Work will start Upon approval					
17. PROPOSED CASING AND CEMENT PROGRAM					
SIZE OF HOLE	SIZE OF CASING	WEIGHT PER FOOT	SETTING DEPTH	SACKS OF CEMENT	EST. TOP
17-1/2"	13-3/8"	48#	400'	500 sx Cl C	Surface
12-1/4"	9-5/8"	36#	2600'	400 sx Cl C	Surface
				FB/150 sx Cl C	
8-1/2"	7"	23# & 26#	9450'	500 sx Cl H	7600'
			2nd Stage:	300 sx Cl C	6000'
6-1/8"	4-1/2"	11.6#	10,300'	150 sx Cl H	9150'

If circulation encountered:

7-7/8" 5-1/2" 15.5# & 17# 10,300' 300 sx Cl H 9000'  
2nd stage 300 sx Cl C FB/150 sx Cl C 6000'

IN ABOVE SPACE DESCRIBE PROPOSED PROGRAM: IF PROPOSAL IS TO DEEPEN OR PLUG BACK, GIVE DATA ON PRESENT PRODUCTIVE ZONE AND PROPOSED NEW PRODUCTIVE ZONE. GIVE BLOWOUT PREVENTER PROGRAM, IF ANY.

I hereby certify that the information above is true and complete to the best of my knowledge and belief.

SIGNATURE L. M. Sanders TITLE Supv. Regulatory Affairs DATE 08-17-93  
TYPE OR PRINT NAME L. M. Sanders (915)  
TELEPHONE NO. 368-1488

(This space for State Use)  
ORIGINAL SIGNED BY  
MIKE WILLIAMS  
SUPERVISOR, DISTRICT II

APPROVED BY \_\_\_\_\_ TITLE \_\_\_\_\_ DATE AUG 20 1993

CONDITIONS OF APPROVAL, IF ANY:

APPROVAL VALID FOR 180 DAYS  
PERMIT EXPIRES 2-20-94  
UNLESS DRILLING UNDERWAY

Submit to Appropriate  
District Office  
State Lease - 4 copies  
Fee Lease - 3 copies

State of New Mexico  
Energy, Minerals and Natural Resources Department

Form C-102  
Revised 1-1-89

OIL CONSERVATION DIVISION

DISTRICT I  
P.O. Box 1980, Hobbs, NM 88240

P.O. Box 2088  
Santa Fe, New Mexico 87504-2088

DISTRICT II  
P.O. Drawer DD, Artesia, NM 88210

DISTRICT III  
1000 Rio Brazos Rd., Aztec, NM 87410

WELL LOCATION AND ACREAGE DEDICATION PLAT

All Distances must be from the outer boundaries of the section

Operator PHILLIPS PETROLEUM COMPANY			Lease CHALK BLUFF 6 STATE		Well No. 2
Unit Letter H	Section 6	Township 18 SOUTH	Range 28 EAST	County EDDY	
Actual Footage Location of Well: 2310 feet from the NORTH line and 810 feet from the EAST line					
Ground Level Elev. 3655.4'	Producing Formation Morrow		Pool Illinois Camp-Morrow		Dedicated Acreage: 320.36 Acres

1. Outline the acreage dedicated to the subject well by colored pencil or hachure marks on the plat below.
2. If more than one lease is dedicated to the well, outline each and identify the ownership thereof (both as to working interest and royalty).
3. If more than one lease of different ownership is dedicated to the well, have the interest of all owners been consolidated by communitization, unitization, force-pooling, etc.?  
☐ Yes ☐ No If answer is "yes" type of consolidation \_\_\_\_\_

If answer is "no" list of owners and tract descriptions which have actually been consolidated. (Use reverse side of this form necessary.)

No allowable will be assigned to the well unit all interests have been consolidated (by communitization, unitization, forced-pooling, otherwise) or until a non-standard unit, eliminating such interest, has been approved by the Division.

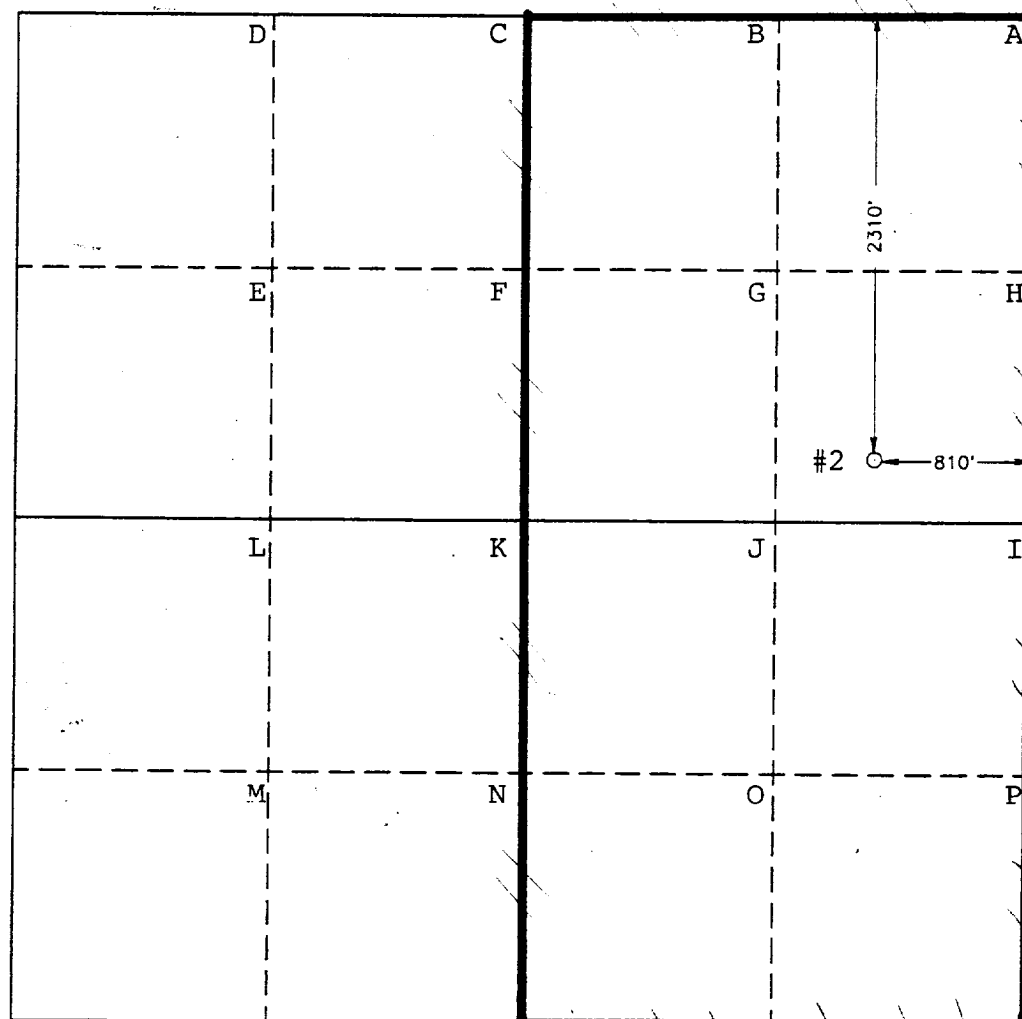

OPERATOR CERTIFICATION

I hereby certify the the information  
contained herein is true and complete to the  
best of my knowledge and belief.

Signature

Printed Name

L. M. Sanders

Position

Supv., Reg. Affairs

Company

Phillips Petroleum Co.

Date

8/17/93

SURVEYOR CERTIFICATION

I hereby certify that the well location shown  
on this plat was plotted from field notes of  
actual surveys made by me or under my  
supervision, and that the same is true and  
correct to the best of my knowledge and  
belief.

Date Surveyed

AUGUST 10, 1993

Signature & Seal of  
Professional Surveyor

GARY L. JONES  
NEW MEXICO  
7977  
JOHN W. WEST, 676  
RONALD L. JOHNSON, 3239  
PROFESSIONAL LAND SURVEYOR  
BART L. JONES, 7977

93-11-1503

## PROPOSED CASING & CEMENTING PROGRAM

Chalk Bluff 6 State No. 2

### 13 3/8" 48 lb/ft H-40 Surface Casing Set at 400' - 17 1/2" Hole:

Circulate to surface with 500 sacks of Class "C" + 2%  $\text{CaCl}_2$ .

Slurry Weight:	14.8 ppg
Slurry Yield:	1.32 ft <sup>3</sup> /sx
Water Requirement:	6.3 gals/sx

### 9 5/8" 36 lb/ft J-55 Intermediate Casing Set at 2600' - 12 1/4" Hole:

Lead: 400 sx Class "C" + 20% Diace1 "D" + 3% Salt. TOC = Surface.

Slurry Weight:	12.0 ppg
Slurry Yield:	2.79 ft <sup>3</sup> /sx
Water Requirement:	16.1 gals/sx

Tail: 150 sx Class "C" Neat.

Slurry Weight:	14.8 ppg
Slurry Yield:	1.32 ft <sup>3</sup> /sx
Water Requirement:	6.3 gals/sx

### **If Loss Circulation is Encountered:**

### 7" 23 & 26 lb/ft J-55 Production Casing Set at 9450' - 8 1/2" Hole:

1st Stage: 500 sx Class "H" + Retarder/Fluid Loss Additives as required. TOC = 7600'. Stage Tool set at 7600'.

Slurry Weight:	15.6 ppg
Slurry Yield:	1.19 ft <sup>3</sup> /sx
Water Requirement:	5.2 gals/sx

2nd Stage: 300 sx Class "C" Neat. TOC= 6000'.

Slurry Weight:	14.8 ppg
Slurry Yield:	1.32 ft <sup>3</sup> /sx
Water Requirement:	6.3 gals/sx

4 1/2" 11.6 lb/ft J-55 & L-80 Production Liner Set at 10300' - 6 1/8" Hole:

150 sx Class "H" + Retarder/Fluid Loss Additives as required. TOC = 9150'

Slurry Weight:	15.6 ppg
Slurry Yield:	1.19 ft <sup>3</sup> /sx
Water Requirement	5.2 gals/sx

If Loss Circulation is NOT Encountered:

5 1/2" 15.5 & 17 lb/ft J-55 & L-80 Production Casing Set at 10300'  
- 7 7/8" Hole:

1st Stage: 300 sx Class "H" + Retarder/Fluid Loss Additives as required. TOC = 9000'. Stage Tool set at 9000'.

Slurry Weight:	15.6 ppg
Slurry Yield:	1.19 ft <sup>3</sup> /sx
Water Requirement:	5.2 gals/sx

2nd Stage:

Lead: 300 sx Class "C" + 20% Diacel "D". TOC = 6000'.

Slurry Weight:	12.2 ppg
Slurry Yield:	2.69 ft <sup>3</sup> /sx
Water Requirement:	15.5 gals/sx

Tail: 150 sx Class "C" Neat.

Slurry Weight:	14.8 ppg
Slurry Yield:	1.32 ft <sup>3</sup> /sx
Water Requirement:	6.3 gals/sx

# PROPOSED MUD PROGRAM SUMMARY

Chalk Bluff 6 State No. 2

DEPTH	MUD WEIGHT	VISCOSITY	FLUID LOSS	% SOLIDS	COMMENTS
Surf - 400'	8.5-9.5 ppg	34-45 sec/1000 cc	No Control	---	Spud Mud
400' - 2600'	9.8-10.0 ppg	29 sec/1000 cc	No Control	---	Brine Water
2600' - 9900'	8.6-8.8 ppg	29 sec/1000 cc	No Control	---	Fresh Water
9900' - 10300'	8.6-8.8 ppg	34-38 sec/1000 cc	20 cc or less	---	Fresh Water Gel / Drispac Plus / XCD

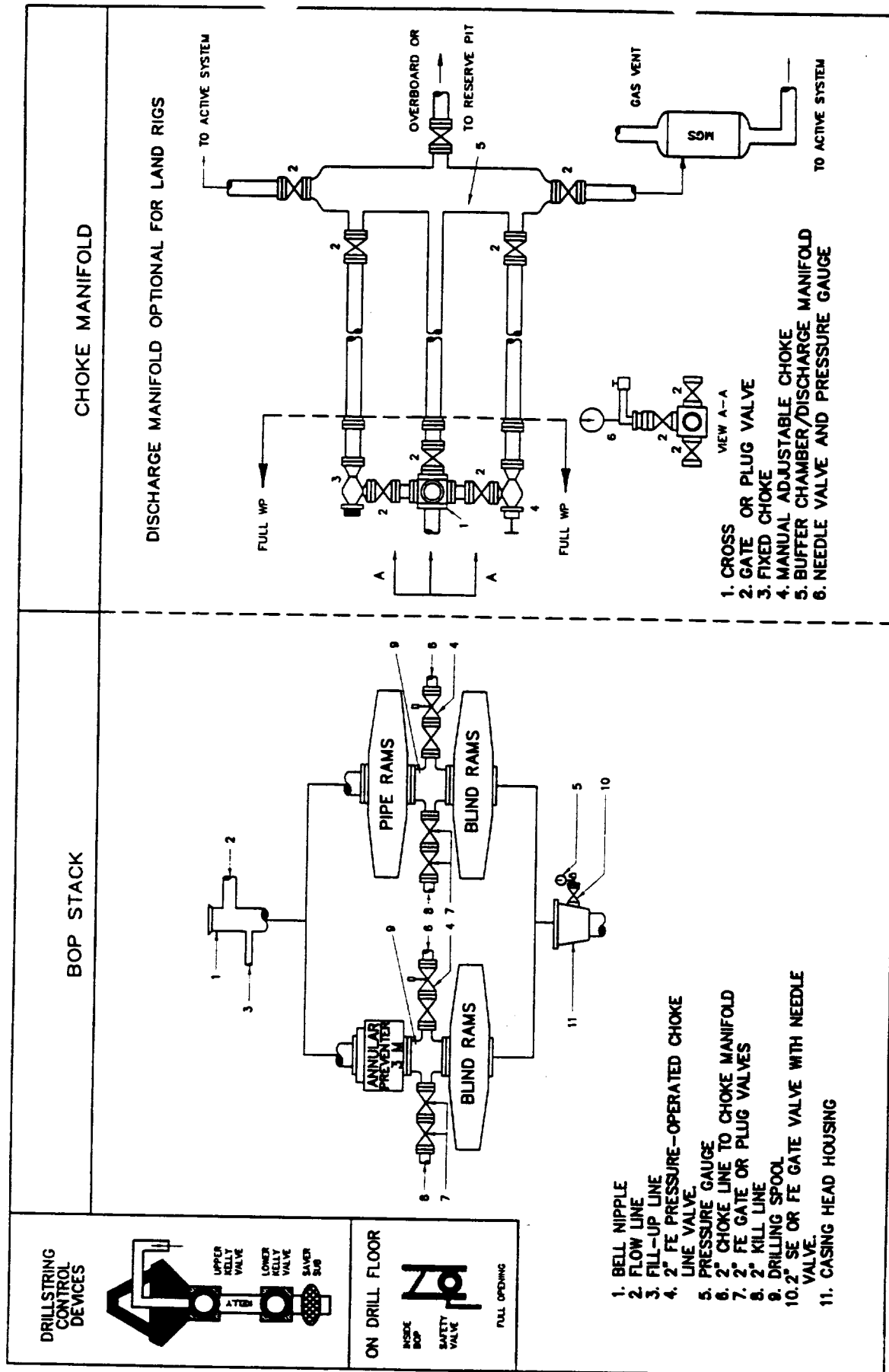

Fig. 2.4. Class 2 BOP and Choke Manifold.