

CLSF

Form 3160-5  
(June 1990)

UNITED STATES  
DEPARTMENT OF THE INTERIOR  
BUREAU OF LAND MANAGEMENT

SUNDRY NOTICES AND REPORTS ON WELLS

Do not use this form for proposals to drill or to deepen or reentry to a different reservoir.  
Use "APPLICATION FOR PERMIT—" for such proposals

SUBMIT IN TRIPLICATE

1. Type of Well

☒ Oil Well ☐ Gas Well ☐ Other

2. Name of Operator

YATES PETROLEUM CORPORATION

3. Address and Telephone No.

105 South Fourth Street, Artesia, New Mexico 88210

4. Location of Well (Footage, Sec., T., R., M., or Survey Description)

2510' FNL and 330' FWL  
Section 25-T18S-R30E

FORM APPROVED  
Budget Bureau No. 1004-0135  
Expires: March 31, 1993

5. Lease Designation and Serial No.

LC-028990(B)

6. If Indian, Allottee or Tribe Name

7. If Unit or CA, Agreement Designation

8. Well Name and No.

Creek AL Federal #13

9. API Well No.

30-015-27776

10. Field and Pool, or Exploratory Area

Shugart Grayburg

11. County or Parish, State

Eddy County, New Mexico

CHECK APPROPRIATE BOX(S) TO INDICATE NATURE OF NOTICE, REPORT, OR OTHER DATA

TYPE OF SUBMISSION

- ☐ Notice of Intent  
☐ Subsequent Report  
☐ Final Abandonment Notice

TYPE OF ACTION

- ☐ Abandonment  
☐ Recompletion  
☐ Plugging Back  
☐ Casing Repair  
☐ Altering Casing  
☒ Other Extend APD  
☐ Change of Plans  
☐ New Construction  
☐ Non-Routine Fracturing  
☐ Water Shut-Off  
☐ Conversion to Injection  
☐ Dispose Water

13. Describe Proposed or Completed Operations (Clearly state all pertinent details, and give pertinent dates, including estimated date of starting any proposed work. If well is directionally drilled, give subsurface locations and measured and true vertical depths for all markers and zones pertinent to this work.)\*

Yates Petroleum Corporation wishes to extend the above captioned wells expiration date for one (1) year.

Thank you.

APPROVED FOR 12 MONTH PERIOD  
ENDING 11/23/96

RECEIVED  
NOV 3 10 22 AM '95  
CARBON AREA

14. I hereby certify that the foregoing is true and correct

Signed Clifton R. May Title Regulatory Agent Date 11-02-95

(This space for Federal or State office use)

Approved by (DRG SCD) JOE G. LARA Title PETROLEUM ENGINEER Date 11/22/95

Title 18 U.S.C. Section 1001, makes it a crime for any person knowingly and willfully to make to any department or agency of the United States any false, fictitious or fraudulent statements or representations as to any matter within its jurisdiction.

\*See Instructions on Reverse

CLST

Form 3160-5  
(June 1990)

UNITED STATES  
DEPARTMENT OF THE INTERIOR  
BUREAU OF LAND MANAGEMENT

FORM APPROVED  
Budget Bureau No. 1004-0135  
Expires: March 31, 1993

SUNDRY NOTICES AND REPORTS ON WELLS

Do not use this form for proposals to drill or to deepen or reentry to a different reservoir.  
Use "APPLICATION FOR PERMIT—" for such proposals

5. Lease Designation and Serial No.  
LC-028990(B)

6. If Indian, Allottee or Tribe Name

SUBMIT IN TRIPLICATE

7. If Unit or CA, Agreement Designation

1. Type of Well  
☒ Oil Well ☐ Gas Well ☐ Other

8. Well Name and No.  
Creek AL Federal #13

2. Name of Operator  
YATES PETROLEUM CORPORATION

9. API Well No.  
30-015-27776

3. Address and Telephone No.  
105 South Fourth Street, Artesia, New Mexico 88210

4. Location of Well (Footage, Sec., T., R., M., or Survey Description)

10. Field and Pool, or Exploratory Area  
Shugart Grayburg

2510' 2310' FNL and 330' FWL  
Section 25-T18S-R30E

11. County or Parish, State  
Eddy County, New Mexico

12. CHECK APPROPRIATE BOX(S) TO INDICATE NATURE OF NOTICE, REPORT, OR OTHER DATA

TYPE OF SUBMISSION

- ☐ Notice of Intent  
☐ Subsequent Report  
☐ Final Abandonment Notice

TYPE OF ACTION

- ☐ Abandonment  
☐ Recompletion  
☐ Plugging Back  
☐ Casing Repair  
☐ Altering Casing  
☒ Other

Extend APD

- ☐ Change of Plans  
☐ New Construction  
☐ Non-Routine Fracturing  
☐ Water Shut-Off  
☐ Conversion to Injection  
☐ Dispose Water

(Note: Report results of multiple completion on Well Completion or Recompletion Report and Log form.)

13. Describe Proposed or Completed Operations (Clearly state all pertinent details, and give pertinent dates, including estimated date of starting any proposed work. If well is directionally drilled, give subsurface locations and measured and true vertical depths for all markers and zones pertinent to this work.)\*

YATES PETROLEUM CORPORATION WISHES TO EXTEND THE ABOVE CAPTIONED WELLS EXPIRATION

DATE FOR ANOTHER YEAR.

THANK YOU.

APPROVED 12 MONTH PERIOD  
ENDING 11/23/95

DEC 06 '94  
B. C. D.  
DISTRICT OFFICE

OCT 28 10 43 AM '94  
CARLOS J. GARCIA  
AREA CHIEF

RECEIVED

14. I hereby certify that the foregoing is true and correct

Signed Ken DeLuca

Title LANDMAN

Date 10/26/94

(This space for Federal or State office use)

(ORIG. SGD.) JOE G. LARA

Approved by  
Conditions of approval, if any:

Title PETROLEUM ENGINEER

Date 12/2/94

Title 18 U.S.C. Section 1001, makes it a crime for any person knowingly and willfully to make to any department or agency of the United States any false, fictitious or fraudulent statements or representations as to any matter within its jurisdiction.

\*See Instruction on Reverse Side

NM OIL CONS COMMISSION  
DRAWER DD  
ARTESIA, NM 88210 STATES  
DEPARTMENT OF THE INTERIOR  
BUREAU OF LAND MANAGEMENTSUBMIT IN 'PLICATE'  
(Other instructions on  
reverse side)FORM APPROVED  
OMB NO. 1004-0136  
Expires: February 28, 1995

## APPLICATION FOR PERMIT TO DRILL OR DEEPEN

1a. TYPE OF WORK <b>DRILL</b> <input checked="" type="checkbox"/> <b>DEEPEN</b> <input type="checkbox"/>		5. LEASE DESIGNATION AND SERIAL NO. LC-028990 (B) (SSS)
b. TYPE OF WELL OIL WELL <input checked="" type="checkbox"/> GAS WELL <input type="checkbox"/> OTHER <input type="checkbox"/> SINGLE ZONE <input type="checkbox"/> MULTIPLE ZONE <input type="checkbox"/>		6. IF INDIAN, ALLOTTEE OR TRIBE NAME
2. NAME OF OPERATOR YATES PETROLEUM CORPORATION		7. UNIT AGREEMENT NAME
3. ADDRESS AND TELEPHONE NO. 105 South Fourth Street, Artesia, New Mexico 88210		8. FARM OR LEASE NAME, WELL NO. Creek "AL" Federal #13
4. LOCATION OF WELL (Report location clearly and in accordance with any State requirements.)* At surface 2510' FNL & 330' FWL; Unit Letter E At proposed prod. zone Same		9. API WELL NO. 30-015-27776
14. DISTANCE IN MILES AND DIRECTION FROM NEAREST TOWN OR POST OFFICE* Approximately 16 miles Southeast of Loco Hills, New Mexico		10. FIELD AND POOL, OR WILDCAT Shugart Grayburg
15. DISTANCE FROM PROPOSED* LOCATION TO NEAREST PROPERTY OR LEASE LINE, FT. (Also to nearest drlg. unit line, if any)	16. NO. OF ACRES IN LEASE 560	11. SEC., T., R., M., OR BLK. AND SURVEY OR AREA Sec. 25-T18S-R30E
18. DISTANCE FROM PROPOSED LOCATION* TO NEAREST WELL, DRILLING, COMPLETED, OR APPLIED FOR, ON THIS LEASE, FT.	19. PROPOSED DEPTH 3,600'	12. COUNTY OR PARISH Eddy
21. ELEVATIONS (Show whether DF, RT, GR, etc.) 3,453' GR		13. STATE NM
20. ROTARY OR CABLE TOOLS Rotary		22. APPROX. DATE WORK WILL START* ASAP

## PROPOSED CASING AND CEMENTING PROGRAM

SIZE OF HOLE	GRADE, SIZE OF CASING	WEIGHT PER FOOT	SETTING DEPTH	QUANTITY OF CEMENT
12 1/4"	8 5/8"	24# K-55	500'	175sx <u>circulated</u>
7 7/8"	5 1/2"	14# K-55	3,600'	250sx <u>CIRCULATE</u>

Yates Petroleum Corporation proposes to drill and test the Grayburg and intermediate formations. Approximately 500' of surface casing will be set and cement circulated. If commercial, production casing will be run and cemented with adequate cover, perforated and stimulated as needed for production.

MUD PROGRAM: FW/Spud mud 500'; Brine, Salt Water Gel + Starch, to TD.

BOPE PROGRAM: BOPE will be installed on the 8 5/8" casing and tested daily.

Unorthodox Location...

- . . SUBJECT TO  
LIKE APPROVAL  
BY STATE

IN ABOVE SPACE DESCRIBE PROPOSED PROGRAM: If proposal is to deepen, give data on present productive zone and proposed new productive zone. If proposal is to drill or deepen directionally, give pertinent data on subsurface locations and measured and true vertical depths. Give blowout preventer program, if any.

SIGNED Clyde R. May TITLE PERMIT AGENT DATE 9/27/93  
(This space for Federal or State office use)

PERMIT NO. \_\_\_\_\_ APPROVAL DATE \_\_\_\_\_

Application approval does not warrant or certify that the applicant holds legal or equitable title to those rights in the subject lease which would entitle it to production thereon.  
CONDITIONS OF APPROVAL, IF ANY: **APPROVAL SUBJECT TO GENERAL REQUIREMENTS AND SPECIAL STIPULATIONS ATTACHED**

Signed Robert Lucero TITLE Acting State Director DATE 11-23-93  
\* PENDING NSL APPROVAL \*See Instructions On Reverse Side

Title 18 U.S.C. Section 1001 makes it a crime for any person knowingly and willfully to make to any department or agency of the United States any false, fictitious or fraudulent statements or representations as to any matter within its jurisdiction.

# OIL CONSERVATION DIVISION

DISTRICT I  
P.O. Box 1980, Hobbs, NM 88240

P.O. Box 2088

Santa Fe, New Mexico 87504-2088

DISTRICT II  
P.O. Drawer DD, Artesia, NM 88210

DISTRICT III  
1000 Rio Brazos Rd., Aztec, NM 87410

## WELL LOCATION AND ACREAGE DEDICATION PLAT

All Distances must be from the outer boundaries of the section

Operator YATES PETROLEUM CORPORATION			Lease CREEK "AL" FEDERAL		Well No. 13
Unit Letter E	Section 25	Township 18 SOUTH	Range 30 EAST	County EDDY	

Actual Footage Location of Well:

2510	feet from the	NORTH	line and	330	feet from the	WEST	line
Ground level Elev. 3453	Producing Formation GRAYBURG		Pool SHUGART GRAYBURG	Dedicated Acreage: 40		Acres	

1. Outline the acreage dedicated to the subject well by colored pencil or hatchure marks on the plat below.
2. If more than one lease is dedicated to the well, outline each and identify the ownership thereof (both as to working interest and royalty).
3. If more than one lease of different ownership is dedicated to the well, have the interest of all owners been consolidated by communitization, unitization, force-pooling, etc?  
☐ Yes ☐ No If answer is "yes" type of consolidation \_\_\_\_\_  
If answer is "no" list the owners and tract descriptions which have actually been consolidated. (Use reverse side of this form if necessary.) \_\_\_\_\_  
No allowable will be assigned to the well until all interests have been consolidated (by communitization, unitization, forced-pooling, or otherwise) or until a non-standard unit, eliminating such interest, has been approved by the Division.

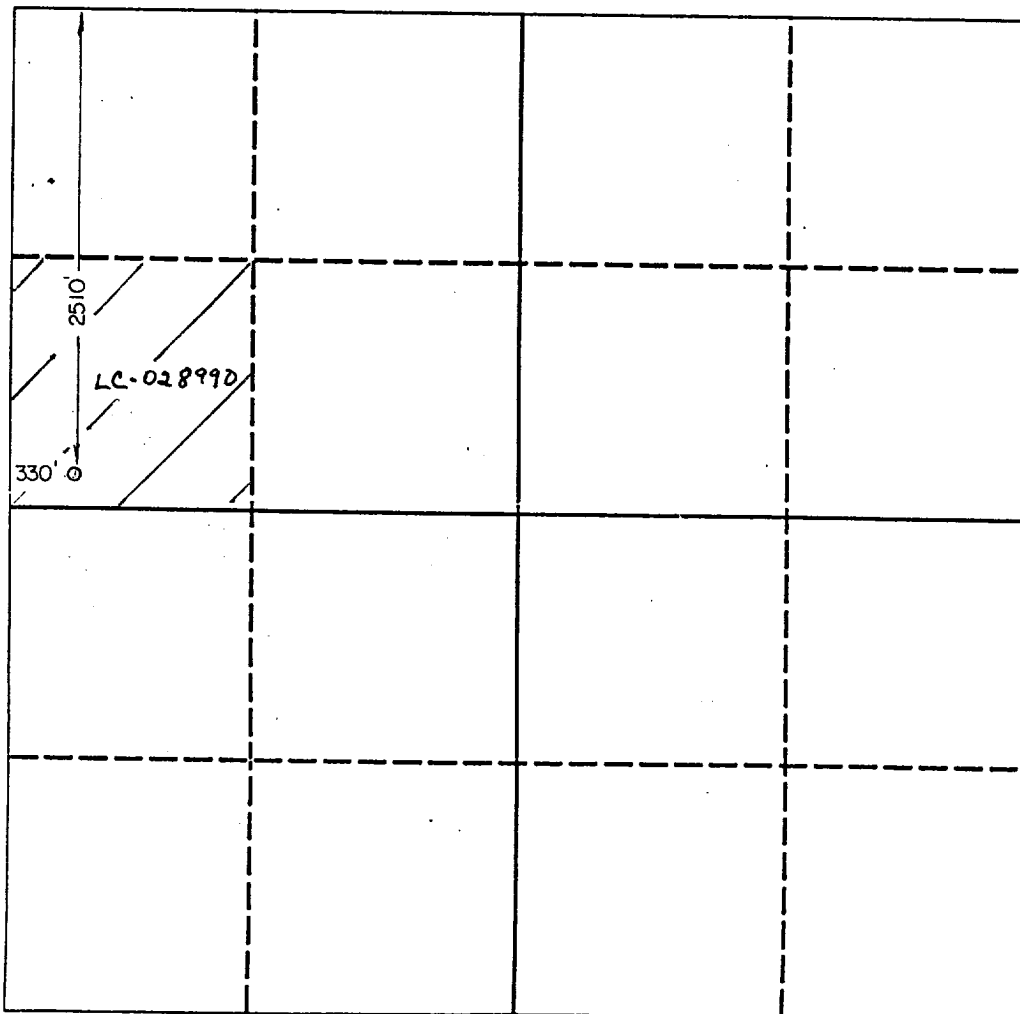

### OPERATOR CERTIFICATION

I hereby certify that the information contained herein is true and complete to the best of my knowledge and belief.

Signature  
*Clifton R. May*  
Printed Name  
CLIFTON R. MAY  
Position  
Permit Agent  
Company  
Yates Petroleum Corporation  
Date  
9/27/93

### SURVEYOR CERTIFICATION

I hereby certify that the well location shown on this plat was plotted from field notes of actual surveys made by me or under my supervision, and that the same is true and correct to the best of my knowledge and belief.

Date Surveyed  
9/07/93  
Signature & Seal of Professional Surveyor  
*Herschel L. Jones*  
HERSCHEL L. JONES  
3640  
Certificate No. 3640

0 330 660 990 1320 1650 1980 2310 2640 2000 1500 1000 500 0

# YATES PETROLEUM CORPORATION

Creek "AL" Federal #13  
2510' FNL & 330' FWL  
Sec. 25-T18S-R30E  
Eddy County, New Mexico

1. The estimated tops of geologic markers are as follows:

Salt	687'
Salt Base	1627'
Yates	1823'
Queen	2926'
Penrose	3127'
Grayburg	3317'
TD	3600'

2. The estimated depths at which anticipated water, oil or gas formations are expected to be encountered:

Water: 0-400'  
Oil or Gas: 3127' and 3187'

3. Pressure Control Equipment: BOPE will be installed on the 8 5/8" casing and rated for 2000 BOP systems will be consistent with API RP 53. Pressure tests will be conducted before drilling out from under all casing strings which are set and cemented in place. Blowout Preventor controls will be installed prior to drilling the surface plug and will remain in use until the well is completed or abandoned. Preventors will be inspected and operated at least daily to ensure good mechanical working order, and this inspection recorded on the daily drilling report. See Exhibit B.

## Auxiliary Equipment:

- A. Auxiliary Equipment: Kelly cock, pit level indicators, flow sensor equipment and a sub with full opening valve to fit the drill pipe and collars will be available on the rig floor in the open position at all times for use when kelly is not in use.

4. THE PROPOSED CASING AND CEMENTING PROGRAM:

- A. Casing Program: (All New)

<u>Hole Size</u>	<u>Casing Size</u>	<u>Wt./Ft</u>	<u>Grade</u>	<u>Thread</u>	<u>Coupling</u>	<u>Interval</u>	<u>Length</u>
12 1/4"	8 5/8"	24#	K55	8R	ST&C	0-500'	500'
7 7/8"	5 1/2"	14#	K55	8R	LT&C	0-3600'	3600'

Minimum Casing Design Factors: Collapse 1.125, Burst 1.0, Joint Strength 1.8

RECEIVED

OCT 7 11 15 AM '93  
OAS  
ARC

**YATES PETROLEUM CORPORATION**

**Creek "AL" Federal #13  
2510' FNL and 330' FWL  
Section 25-T18S-R30E  
Eddy County, New Mexico**

**H2S Drilling Operations Plan**

Personnel employed at the rig site shall receive training in H2S detection, safe drilling procedures and contingency plans. H2S safety equipment shall be installed and functional 3 days or 500 feet prior to encountering known or probable H2S zone at 3150' feet.

Submitted with the APD is a well site diagram showing:

- 1) Drilling rig orientation, location of flare pit.
- 2) Prevailing wind direction.
- 3) Location of access road.

Primary briefing area will be established 150' from wellbore and up wind of prevailing wind direction. Secondary briefing area will be established 180 degrees from primary briefing area.

A H2S warning sign will be posted at the entrance of the location. Depending on conditions, a green, yellow, or red flag will be displayed.

**Green - Normal conditions**

**Yellow - Potential danger**

**Red - Danger H2S present**

Wind indicators will be placed on location at strategic, highly visible areas. H2S monitors ( a minimum of three) will be positioned on location for best coverage and response. H2S concentrations of 10 ppm will trigger a flashing light and 20 ppm will trigger an audible siren.

H2S breathing equipment will consist of:

- 1) 30 minute "pressure demand" type working unit for each member of rig crew on location.
- 2) 5 minute escape packs for each crew member.
- 3) Trailer with a "cascade air system: to facilitate working in a H2S environment for time period greater than 30 minutes.

Breathing equipment will be stored in weather proof cases or facilities. They will be inspected and maintained weekly.

The mud system will be designed to minimize or eliminate the escape of H<sub>2</sub>S at the rig floor. This will be accomplished through the use of proper mud weight, proper pH control of the drilling fluid and the use of H<sub>2</sub>S scavengers in the drilling fluid. A mud gas separator will be utilized when H<sub>2</sub>S is present in the mud.

Drilling experience has shown that wells in developmental areas, (i.e. Dagger Draw, Livingston Ridge Delaware, and Lusk Delaware) are normally pressured and don't experience either H<sub>2</sub>S kicks or loss of returns. Due to these circumstances, we request exceptions to the rule requiring flare line with remote lighter and choke manifold with minimum of one remote choke. This equipment would be provided on exploratory wells or wells with the known potential for H<sub>2</sub>S kicks. Additionally, a SO<sub>2</sub> monitor would be positioned near the flare line, and a rotating head utilized.

The drill string, casing, tubing, wellhead, blowout preventers and associated lines and valves will be suitable for anticipated H<sub>2</sub>S encounters.

Radio and or mobile telephone communication will be available on site. Mobile telephone communication will be available in company vehicles.

Drill stem testing to be performed with a minimum number of essential people on location. They will be those necessary to safely conduct the test. If H<sub>2</sub>S is encountered during a drill stem test, essential personnel will mask up and determine H<sub>2</sub>S concentration. The recovery will then be reversed to flare pit. Pulling of test tools will be conducted in a safe manner.

## **MULTI-POINT SURFACE USE AND OPERATIONS PLAN**

**Yates Petroleum Corporation**

**Creek "AL" Federal #13**

**2510' FNL & 330' FWL**

**Sec. 25-T18S-R30E**

**Eddy County, New Mexico**

This plan is submitted with Form 3160-3, Application for Permit to Drill, covering the above described well. The purpose of this plan is to describe the location of the proposed well, the proposed construction activities and operations plan, the magnitude of the surface disturbance involved and the procedures to be followed in rehabilitating the surface after completion of the operations, so that a complete appraisal can be made of the environmental effect associated with the operations.

### **1. EXISTING ROADS:**

Exhibit A is a portion of the BLM map showing the well and roads in the vicinity of the proposed location. The proposed wellsite is located approximately 16 miles Southeast of Loco Hills, New Mexico and the access route to the location is indicated in red and green on Exhibit A.

#### **DIRECTIONS:**

From Loco Hills go east on Highway 82 and Rt. 31 (Rd. 222). Turn South for 6.5 miles to Grubbs Rd. (CR 250). Turn west on Grubbs for 2.5 miles. Turn North on caliche road for approximately .4 miles to start of new road.

### **2. PLANNED ACCESS ROAD**

- A. The proposed new access will be approximately 500' in length from the point of origin to the southwest edge of the drilling pad. The road will lie in a Southwest to Northeast direction.
- B. The new road will be 14 feet in width (driving surface) and will be adequately drained to control runoff and soil erosion.
- C. The new road will be bladed with drainage on one side. No traffic turnouts will be built.
- D. The route of the road is visible.
- E. Existing roads will be maintained in the same or better condition.

### **3. LOCATION OF EXISTING WELL**

- A. There is drilling activity within a one-mile radius of the wellsite.
- B. Exhibit D shows existing wells within a one-mile radius of the proposed wellsite.

4. LOCATION OF EXISTING AND/OR PROPOSED FACILITIES

- A. There are production facilities on this lease at the present time.
- B. In the event that the well is productive, the necessary production facilities will be installed on the drilling pad. If the well is productive oil, a gas or diesel self-contained unit will be used to provide the necessary power. No power will be required if the well is productive of gas.

5. LOCATION AND TYPE OF WATER SUPPLY:

- A. It is planned to drill the proposed well with a fresh water system. The water will be obtained from commercial sources and will be hauled to the location by truck over the existing and proposed roads shown in Exhibit A.

6. SOURCE OF CONSTRUCTION MATERIALS:

If any material is needed, dirt contractor will get the material and pay for it from the closest source.

7. METHODS OF HANDLING WASTE DISPOSAL:

- A. Drill cuttings will be disposed of in the reserve pits.
- B. Drilling fluids will be allowed to evaporate in the reserve pits until the pits are dry.
- C. Water produced during operations will be collected in tanks until hauled to an approved disposal system, or separate disposal application will be submitted.
- D. Oil produced during operations will be stored in tanks until sold.
- E. Current laws and regulations pertaining to the disposal of human waste will be complied with.
- F. All trash, junk, and other waste materials will be contained in trash cages or bins to prevent scattering and will be removed and deposited in an approved sanitary land fill. Burial on site is not approved.

8. ANCILLARY FACILITIES:

- A. None required:

9. WELLSITE LAYOUT:

- A. Exhibit C shows the relative location and dimensions of the well pad, the reserve pits, the location of the drilling equipment, rig orientation and access road approach.
- B. The reserve pits will be plastic lined.
- C. A 400' x 400' area has been staked and flagged.

10. PLANS FOR RESTORATION

- A. After finishing drilling and/or completion operations, all equipment and other material not needed for further operations will be removed. The location will be cleaned of all trash and junk to leave the wellsite in as aesthetically pleasing a condition as possible.
- B. Unguarded pits, if any, containing fluids will be fenced until they have dried and been leveled.
- C. If the proposed well is non-productive, all rehabilitation and/or vegetation requirements of the Bureau of Land Management will be complied with and will be accomplished as expeditiously as possible. All pits will be filled level after they have evaporated and dried.

11. SURFACE OWNERSHIP: Bureau of Land Management, Carlsbad, New Mexico

12. OTHER INFORMATION:

- A. Topography: Refer to the existing archaeological report for a description of the topography, flora, fauna, soil characteristics, dwellings, historical and cultural sites.
- B. The primary surface use is for grazing.

13. OPERATOR'S REPRESENTATIVE

A. Through A.P.D. Approval:

Ken Beardemphl, Landman  
Yates Petroleum Corporation  
105 South Fourth Street  
Artesia, New Mexico 88210  
Phone (505) 748-1471

B. Through Drilling Operations,  
Completions and Production:

Mike Slater, Operations Manager  
Yates Petroleum Corporation  
105 South Fourth Street  
Artesia, New Mexico 88210  
Phone (505) 748-1471

14. CERTIFICATION:

I hereby certify that I, or persons under my direct supervision, have inspected the proposed drill site and access route, that I am familiar with the conditions which presently exist; that the statements made in this plan are to the best of my knowledge, true and correct; and , that the work associated with the operations proposed herein will be performed by Yates Petroleum Corporation and its contractors and subcontractors in conformity with this plan and the terms and conditions under which it is approved. This statement is subject to the provisions of 18 U.S.C. 1001 for the filing of a false statement.

7/23/93

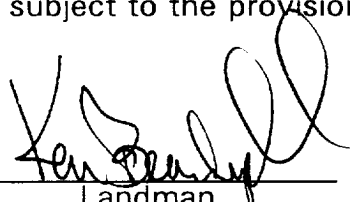
  
\_\_\_\_\_  
Landman

**Yates Petroleum Corporation**  
105 SOUTH 4th STREET  
ARTESIA, NEW MEXICO 88210

CREEK "AL" FEDERAL #13  
2510' FNL & 330' FWL  
Sec. 25-T18S-R30E  
Eddy County, New Mexico

