

Submit to Appropriate  
District Office  
State Lease - 6 copies  
Free Lease - 5 copies

State of New Mexico  
Energy, Minerals and Natural Resources Department

Form C-101  
Revised 1-1-89

DISTRICT I  
P.O. Box 1980, Hobbs, NM 88240

DISTRICT II  
P.O. Drawer DD, Artesia, NM 88210

DISTRICT III  
1000 Rio Brazos Rd., Aztec, NM 87410

OIL CONSERVATION DIVISION

P.O. Box 2088  
Santa Fe, New Mexico 87504-2088

API NO. (assigned by OCD on New Wells)

30-015-27779

5. Indicate Type of Lease

STATE ☒ FEE ☐

6. State Oil & Gas Lease No.

E-5233-9

APPLICATION FOR PERMIT TO DRILL, DEEPEN, OR PLUG BACK

1a. Type of Work:

DRILL ☒

RE-ENTER ☐

DEEPEN ☐

PLUG BACK ☐

b. Type of Well:

OIL  
WELL ☒

GAS  
WELL ☐

OTHER ☐

SINGLE  
ZONE ☐

MULTIPLE  
ZONE ☐

7. Lease Name or Unit Agreement Name

Big Eddy Unit

8. Well No.

133

2. Name of Operator

Enron Oil & Gas Company ✓

3. Address of Operator

P. O. Box 2267, Midland, Texas 79702

4. Well Location

Unit Letter 0 : 660 Feet From The south Line and 1980 Feet From The east Line

Section 16 Township 21S Range 29E NMPM Eddy County

10. Proposed Depth

7200

11. Formation

Delaware

12. Rotary or C.T.

Rotary

13. Elevations (Show whether DF, RT, GR, etc.)

3405.4' GR

14. Kind & Status Plug Bond

Blanket-Active

15. Drilling Contractor

Nabors Drig

16. Approx. Date Work will start

When permitted

17.

PROPOSED CASING AND CEMENT PROGRAM

SIZE OF HOLE	SIZE OF CASING	WEIGHT PER FOOT	SETTING DEPTH	SACKS OF CEMENT	EST. TOP
14-3/4	11-3/4	42#	650	275	Circulated
11	8-5/8	32#	3100	800	Circulated
7-7/8	5-1/2	15.5#	7200	600	2600'

The BOP Equipment will consist of a double ram-type (3000 psi WP preventer) and an annular preventer (3000 psi WP). Units will be hydraulically operated and the ram type will be equipped with blind rams on top and drill pipe rams on bottom. All will be installed on the 11-3/4" surface casing and used continuously until TD is reached.

Acreage is dedicated.

IN ABOVE SPACE DESCRIBE PROPOSED PROGRAM: IF PROPOSAL IS TO DEEPEN OR PLUG BACK, GIVE DATA ON PRESENT PRODUCTIVE ZONE AND PROPOSED NEW PRODUCTIVE ZONE. GIVE BLOWOUT PREVENTER PROGRAM, IF ANY.

I hereby certify that the information above is true and complete to the best of my knowledge and belief.

SIGNATURE

Betty Gildon

TITLE Regulatory Analyst

DATE 12/6/93

TYPE OR PRINT NAME

Betty Gildon

TELEPHONE NO. 915/686-3714

TELEPHONE NO.

(This space for State Use)

APPROVED BY

Mark Kelly

TITLE GEOLOGIST

DATE 12-8-93

CONDITIONS OF APPROVAL, IF ANY:

APPROVAL VALID FOR 180 DAYS  
PERMIT EXPIRES 6-8-94  
UNLESS DRILLING UNDERWAY

Submit to Appropriate  
District Office  
State Lease - 4 copies  
Fee Lease - 3 copies

State of New Mexico  
Energy, Minerals and Natural Resources Department

Form C-102  
Revised 1-1-89

**DISTRICT I**

P.O. Box 1980, Hobbs, NM 88240

**DISTRICT II**

P.O. Drawer DD, Artesia, NM 88210

**DISTRICT III**

1000 Rio Brazos Rd., Aztec, NM 87410

**OIL CONSERVATION DIVISION**

P.O. Box 2088

Santa Fe, New Mexico 87504-2088

**WELL LOCATION AND ACREAGE DEDICATION PLAT**

All Distances must be from the outer boundaries of the section

Operator <b>ENRON OIL &amp; GAS COMPANY</b>		Lease <b>BIG EDDY UNIT</b>		Well No. <b>133</b>	
Unit Letter <b>()</b>	Section <b>16</b>	Township <b>21 SOUTH</b>	Range <b>29 EAST</b>	County <b>EDDY</b>	
Actual Footage Location of Well: <b>660</b> feet from the <b>SOUTH</b> line and <b>1980</b> feet from the <b>EAST</b> line					
Ground Level Elev. <b>3405.4'</b>	Producing Formation <b>Delaware</b>		Pool <b>Und.</b>	Dedicated Acreage: <b>40</b> Acres	

1. Outline the acreage dedicated to the subject well by colored pencil or hachure marks on the plat below.
2. If more than one lease is dedicated to the well, outline each and identify the ownership thereof (both as to working interest and royalty).
3. If more than one lease of different ownership is dedicated to the well, have the interest of all owners been consolidated by communitization, unitization, force-pooling, etc.?  
☐ Yes ☐ No If answer is "yes" type of consolidation \_\_\_\_\_

If answer is "no" list of owners and tract descriptions which have actually been consolidated. (Use reverse side of this form necessary.)

No allowable will be assigned to the well unit all interests have been consolidated (by communitization, unitization, forced-pooling, otherwise) or until a non-standard unit, eliminating such interest, has been approved by the Division.

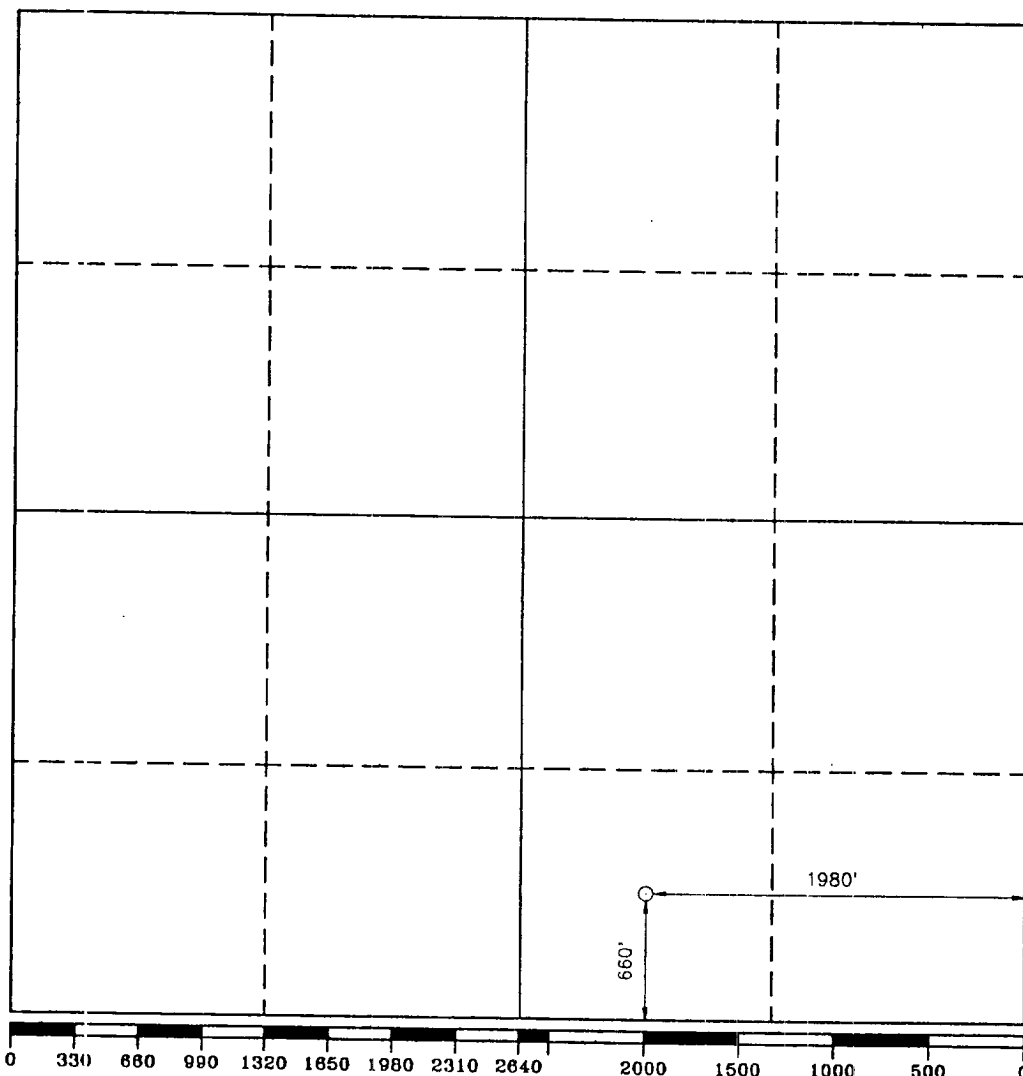

**OPERATOR CERTIFICATION**

I hereby certify the the information contained herein is true and complete to the best of my knowledge and belief.

Signature

Printed Name  
**Betty Gildon**

Position

**Regulatory Analyst**

Company

**Enron Oil & Gas Company**

Date

**12/6/93**

**SURVEYOR CERTIFICATION**

I hereby certify that the well location shown on this plat was plotted from field notes of actual surveys made by me or under my supervision, and that the same is true and correct to the best of my knowledge and belief.

Date Surveyed

**NOVEMBER 8, 1993**

Signature & Seal of  
Professional Surveyor

**GARY L. JONES**  
NEW MEXICO  
REG. 7877  
Certificate No. **JOHN W. WEISS 876**  
**RONALD J. ERSCH 8288**  
**GARY L. JONES 7877**

93-11-2218