

Submit to Appropriate
District Office
State Lease - 6 copies
Fee Lease - 5 copies

State of New Mexico
Energy, Minerals and Natural Resources Department

Form C-101
Revised 1-1-89

OIL CONSERVATION DIVISION

P.O. Box 2088
Santa Fe, New Mexico 87504-2088

DISTRICT I
P.O. Box 1980, Hobbs, NM 88240

DISTRICT II
P.O. Drawer DD, Artesia, NM 88210

DISTRICT III
1000 Rio Brazos Rd., Aztec, NM 87410

FEB 11 1994

API NO. (assigned by OCD on New Wells)

30-015-27852

5. Indicate Type of Lease

STATE ☒ FEE ☐

6. State Oil & Gas Lease No.

LG-5998

APPLICATION FOR PERMIT TO DRILL, DEEPEN, OR PLUG BACK

1a. Type of Work:

DRILL ☒ RE-ENTER ☐ DEEPEN ☐ PLUG BACK ☐

b. Type of Well:

OIL WELL ☒ GAS WELL ☐ OTHER ☐

SINGLE ZONE ☒ MULTIPLE ZONE ☐

7. Lease Name or Unit Agreement Name

Queen Lake State

2. Name of Operator

Energex Company ✓

8. Well No.

#2

3. Address of Operator

100 N. Penn, Roswell, New Mexico 88201

9. Pool name or Wildcat

Willow Lake - Delaware

4. Well Location

Unit Letter 0 : 1980 Feet From The East Line and 660 Feet From The South Line

Section 36 Township 24 South Range 28 East NMPM Eddy County

10. Proposed Depth

5500

11. Formation

Delaware

12. Rotary or C.T.

Rotary

13. Elevations (Show whether DF, RT, GR, etc.)

2932 GL

14. Kind & Status Plug. Bond

Statewide

15. Drilling Contractor

unknown

16. Approx. Date Work will start

Feb. 20, 1994

17.

PROPOSED CASING AND CEMENT PROGRAM

SIZE OF HOLE	SIZE OF CASING	WEIGHT PER FOOT	SETTING DEPTH	SACKS OF CEMENT	EST. TOP
17-1/2"	13-3/8"	48#	550	550 SX	Circ
12-1/4"	8-5/8"	24-32#	1700 2600	800 SX	Circ
7-7/8"	5-1/2"	15.5#	5500	650 SX	2500

Propose to drill and test Delaware formation approximately 550' of surface and 2700' of intermediate casing. Cement will be circulated on both strings. If commercial will run 5-1/2" and tie back in to 8-5/8" casing.

Mud: Native 0-550'

Brine 550'-2700

Salt, gel & cut brine 1700-5500'

BOP Program: 10", nipple up on 8-5/8" casing.

IN ABOVE SPACE DESCRIBE PROPOSED PROGRAM: IF PROPOSAL IS TO DEEPEN OR PLUG BACK, GIVE DATA ON PRESENT PRODUCTIVE ZONE AND PROPOSED NEW PRODUCTIVE ZONE. GIVE BLOWOUT PREVENTER PROGRAM, IF ANY.

I hereby certify that the information above is true and complete to the best of my knowledge and belief.

SIGNATURE James L. Schultz TITLE Agent DATE 2/9/94

TYPE OR PRINT NAME James L. Schultz TELEPHONE NO. 622-6713

(This space for State Use)

APPROVED BY Mark Gehlert TITLE GEOLOGIST DATE 2-11-94

CONDITIONS OF APPROVAL, IF ANY:

APPROVAL VALID FOR 180 DAYS
PERMIT EXPIRES 8-11-94
UNLESS DRILLING UNDERWAY

Submit to Appropriate
District Office
State Lease - 4 copies
Fee Lease - 3 copies

State of New Mexico
Energy, Minerals and Natural Resources Department

Form C-102
Revised 1-1-89

OIL CONSERVATION DIVISION

P.O. Box 2088
Santa Fe, New Mexico 87504-2088

DISTRICT I
P.O. Box 1980, Hobbs, NM 88240

DISTRICT II
P.O. Drawer DD, Artesia, NM 88210

DISTRICT III
1000 Rio Brazos Rd., Aztec, NM 87410

WELL LOCATION AND ACREAGE DEDICATION PLAT

All Distances must be from the outer boundaries of the section

Operator ENERGEX COMPANY			Lease QUEEN LAKE STATE		Well No. 2
Unit Letter 0	Section 36	Township 24 SOUTH	Range 28 EAST	County EDDY COUNTY, NM	
Actual Footage Location of Well: 1980 feet from the EAST line and 660 feet from the SOUTH line					
Ground level Elev. 2932.	Producing Formation Delaware		Pool Willow Lake	Dedicated Acreage: 40 Acres	

1. Outline the acreage dedicated to the subject well by colored pencil or hatchure marks on the plat below.
2. If more than one lease is dedicated to the well, outline each and identify the ownership thereof (both as to working interest and royalty).
3. If more than one lease of different ownership is dedicated to the well, have the interest of all owners been consolidated by communitization, unitization, force-pooling, etc.?
☐ Yes ☐ No If answer is "yes" type of consolidation _____
If answer is "no" list the owners and tract descriptions which have actually been consolidated. (Use reverse side of this form if necessary).
No allowable will be assigned to the well until all interests have been consolidated (by communitization, unitization, forced-pooling, or otherwise) or until a non-standard unit, eliminating such interest, has been approved by the Division.

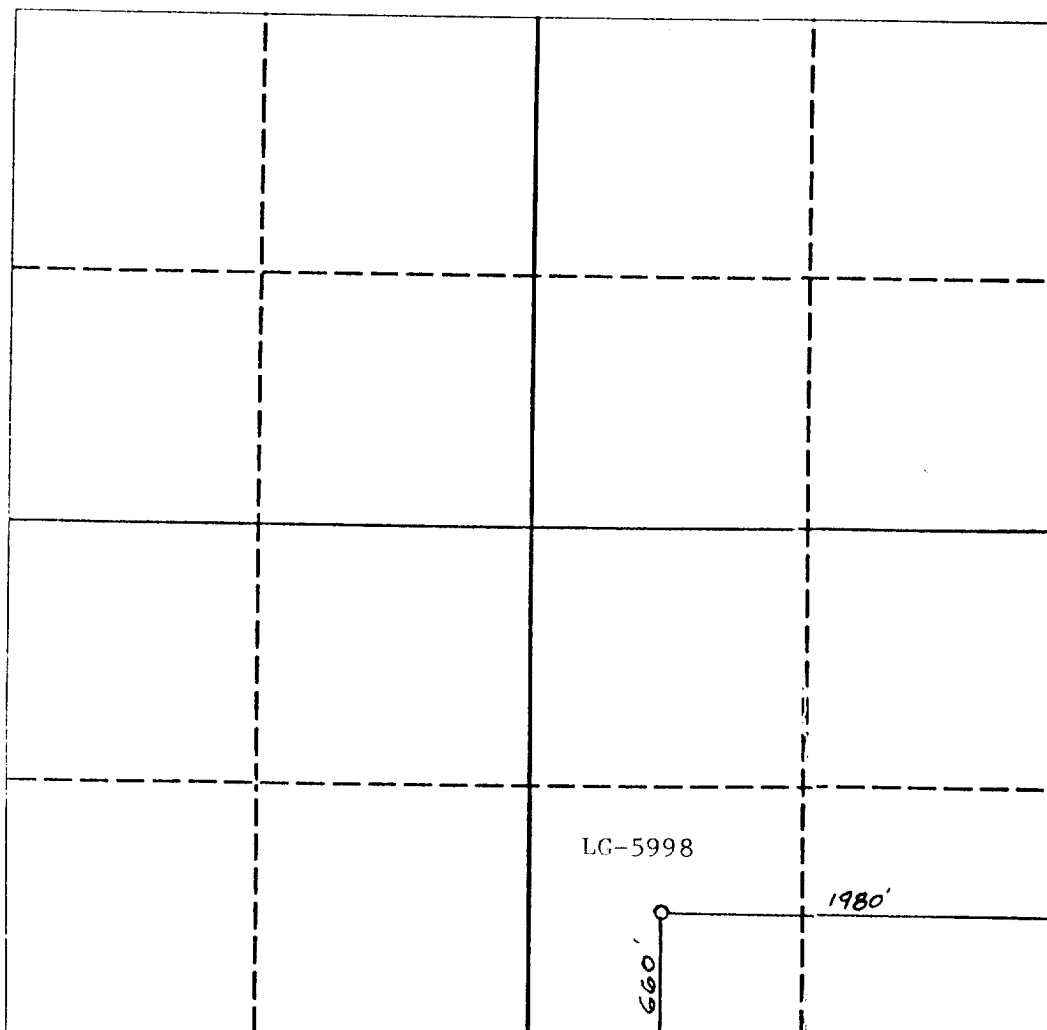

OPERATOR CERTIFICATION

I hereby certify that the information contained herein in true and complete to the best of my knowledge and belief.

Signature <i>James L. Schultz</i>
Printed Name James L. Schultz
Position Agent
Company Energex Company
Date 2/9/94

SURVEYOR CERTIFICATION

I hereby certify that the well location shown on this plat was plotted from field notes of actual surveys made by me or under my supervision, and that the same is true and correct to the best of my knowledge and belief.

Date Surveyed JANUARY 24, 1994
Signature & Seal of Professional Surveyor <i>James L. Schultz</i>
Certificate No. 5412
Professional Engineer NEW MEXICO