

Submit to Appropriate  
District Office  
State Lease - 4 copies  
Fee Lease - 3 copies

State of New Mexico  
Energy, Minerals and Natural Resources Department

Form C-102  
Revised 1-1-89

## OIL CONSERVATION DIVISION

P.O. Box 2088  
Santa Fe, New Mexico 87504-2088

## DISTRICT I

P.O. Box 1800, Hobbs, NM 88240

## DISTRICT II

P.O. Drawer DD, Artesia, NM 88210

## DISTRICT III

1000 Rio Brazos Rd., Artec, NM 87410

## WELL LOCATION AND ACREAGE DEDICATION PLAT

All Distances must be from the outer boundaries of the section

Operator <b>DEVON ENERGY CORPORATION</b>			Lease <b>TODD 13F FEDERAL</b>		Well No. <b>6</b>
Unit Letter <b>F</b>	Section <b>13</b>	Township <b>23 SOUTH</b>	Range <b>31 EAST</b>	County <b>EDDY</b>	
Actual Footage Location of Well:					
1980 feet from the NORTH line and		1980 feet from the WEST line			
Ground Level Elev. <b>3493.3'</b>	Producing Formation <b>Delaware</b>	Pool <b>Ingle Wells Delaware</b>		Dedicated Acreage: <b>40 Acres</b>	

- Outline the acreage dedicated to the subject well by colored pencil or hatchure marks on the plat below.
  - If more than one lease is dedicated to the well, outline each and identify the ownership thereof (both as to working interest and royalty).
  - If more than one lease of different ownership is dedicated to the well, have the interest of all owners been consolidated by communitization, unitization, force-pooling, etc.?
 

☐ Yes
 ☐ No
 

If answer is "yes" type of consolidation \_\_\_\_\_
- If answer is "no" list of owners and tract descriptions which have actually been consolidated. (Use reverse side of this form necessary.)
- No allowable will be assigned to the well unit all interests have been consolidated (by communitization, unitization, forced-pooling, otherwise) or until a non-standard unit, eliminating such interest, has been approved by the Division.

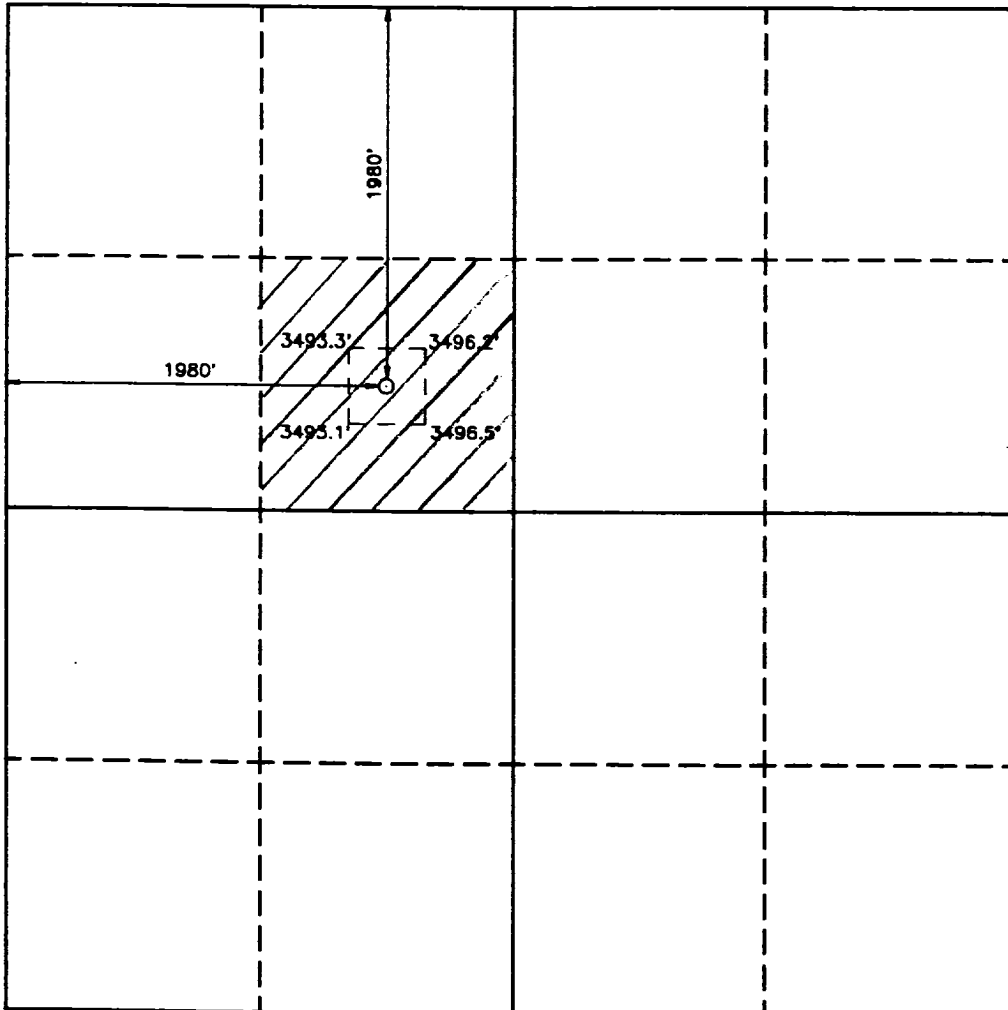

0 330 660 990 1320 1650 1980 2310 2640 2000 1500 1000 500 0

## OPERATOR CERTIFICATION

I hereby certify the the information contained herein is true and complete to the best of my knowledge and belief.

Signature

Printed Name

Charles W. Horsman

Position

District Engineer

Company Devon Energy Corporation (Nevada)

Date

December 15, 1993

## SURVEYOR CERTIFICATION

I hereby certify that the well location shown on this plat was plotted from field notes of actual surveys made by me or under my supervision, and that the same is true and correct to the best of my knowledge and belief.

Date Surveyed

NOVEMBER 16, 1993

Signature & Seal of Professional Surveyor

GARY L. JONES  
NEW MEXICO  
Professional Surveyor  
Certificate No. JOHN W. REED, 876  
RONALD W. JONES, 3230  
PROFESSOR GARY L. JONES, 7977

93-11-2306