

UNITED STATES
DEPARTMENT OF THE INTERIOR
BUREAU OF LAND MANAGEMENT

APPLICATION FOR PERMIT TO DRILL OR DEEPEN

1a. TYPE OF WORK

DRILL ☒

DEEPEN ☒

b. TYPE OF WELL

OIL
WELL ☒

GAS
WELL ☐

OTHER ☐

SINGLE
ZONED ☐

MULTIPLE
ZONE ☐

2. NAME OF OPERATOR

Bass Enterprises Production Co.

3. ADDRESS AND TELEPHONE NO.

P.O. Box 2760, Midland, TX 79702 915-683-2277

4. LOCATION OF WELL (Report location clearly and in accordance with any State requirements.)*
At surface

1830' FWL & 660' FNL, Section 11, T-21-S, R-28-E
At proposed prod. zone

Same

14. DISTANCE IN MILES AND DIRECTION FROM NEAREST TOWN OR POST OFFICE*

6 miles ENE from Carlsbad, New Mexico

ARIESIA, OFFICE

15. DISTANCE FROM PROPOSED*
LOCATION TO NEAREST
PROPERTY OR LEASE LINE, FT.
(Also to nearest drlg. unit line, if any)

660'

16. NO. OF ACRES IN LEASE
240

17. NO. OF ACRES ASSIGNED
TO THIS WELL
40

18. DISTANCE FROM PROPOSED LOCATION*
TO NEAREST WELL, DRILLING, COMPLETED,
OR APPLIED FOR, ON THIS LEASE, FT.

None

19. PROPOSED DEPTH
6700'

20. ROTARY OR CABLE TOOLS
Rotary

21. ELEVATIONS (Show whether DF, RT, GR, etc.)

3358.6' GL

22. APPROX. DATE WORK WILL START*
Upon Approval

23. PROPOSED CASING AND CEMENTING PROGRAM

SIZE OF HOLE	GRADE SIZE OF CASING	WEIGHT PER FOOT	SETTING DEPTH	QUANTITY OF CEMENT
* 14-3/4"	11-3/4" WC-40	42#	600'	400 sx circ to surface
** 11"	8-5/8" WC-50	32#	3000'	835 sx circ to surface
*** 7-7/8"	5-1/2" K-55	15.5#	6700'	660 sx tie back to 2500'

* Surface casing to be set \pm 100' above the salt in the Rustler Anhydrite.

Intermediate casing to be set in the top of the Lamar Lime.

Drilling procedure, BCP diagram, anticipated tops and surface use plans attached.

** Intermediate casing will be run only in the event of severe lost circulation.

*** Cement will be circulated to surface on production string if intermediate casing is not run. DV Tool at 4500'

Certified Mail: P 237 023 521 GGR

IN ABOVE SPACE DESCRIBE PROPOSED PROGRAM: If proposal is to deepen, give data on present productive zone and proposed new productive zone. If proposal is to drill or deepen directionally, give pertinent data on subsurface locations and measured and true vertical depths. Give blowout preventer program, if any.

24.

SIGNED

William R. Dannels

William R. Dannels

TITLE Division Drilling Supt.

DATE

11/18/93

(This space for Federal or State office use)

PERMIT NO.

APPROVAL DATE

Application approval does not warrant or certify that the applicant holds legal or equitable title to those rights in the subject lease which would entitle the applicant to conduct operations thereon.
CONDITIONS OF APPROVAL, IF ANY:

APPROVAL SUBJECT TO
GENERAL REQUIREMENTS AND
SPECIAL STIPULATIONS
ATTACHED

APPROVED BY

(ORIG. SGD.) RICHARD L. MANUS

TITLE

AREA MANAGER

DATE

MAY 6 1994

*See Instructions On Reverse Side

Submit to Appropriate
District Office
State Lease - 4 copies
Fee Lease - 3 copies

State of New Mexico
Energy, Minerals and Natural Resources Department

Form C-102
Revised 1-1-89

OIL CONSERVATION DIVISION

DISTRICT I

P.O. Box 1980, Hobbs, NM 88240

P.O. Box 2088

Santa Fe, New Mexico 87504-2088

DISTRICT II

P.O. Drawer DD, Artesia, NM 88210

DISTRICT III

1000 Rio Brazos Rd., Aztec, NM 87410

WELL LOCATION AND ACREAGE DEDICATION PLAT

All Distances must be from the outer boundaries of the section

Operator BASS ENTERPRISES PRODUCTION			Lease BIG EDDY UNIT		Well No. 129
Unit Letter C	Section 11	Township 21 SOUTH	Range 28 EAST	County EDDY	

Actual Footage Location of Well:

1830 feet from the WEST line and 660 feet from the NORTH line

Ground Level Elev. 3358.6'	Producing Formation Delaware	Pool Sand Point <i>SCANLON</i>	Dedicated Acreage: 40 Acres
-------------------------------	---------------------------------	-----------------------------------	--------------------------------

- Outline the acreage dedicated to the subject well by colored pencil or hachure marks on the plat below.
- If more than one lease is dedicated to the well, outline each and identify the ownership thereof (both as to working interest and royalty).
- If more than one lease of different ownership is dedicated to the well, have the interest of all owners been consolidated by communitization, unitization, force-pooling, etc.?
☐ Yes ☐ No If answer is "yes" type of consolidation _____

If answer is "no" list of owners and tract descriptions which have actually been consolidated. (Use reverse side of this form necessary.)

No allowable will be assigned to the well unit all interests have been consolidated (by communitization, unitization, forced-pooling, otherwise) or until a non-standard unit, eliminating such interest, has been approved by the Division.

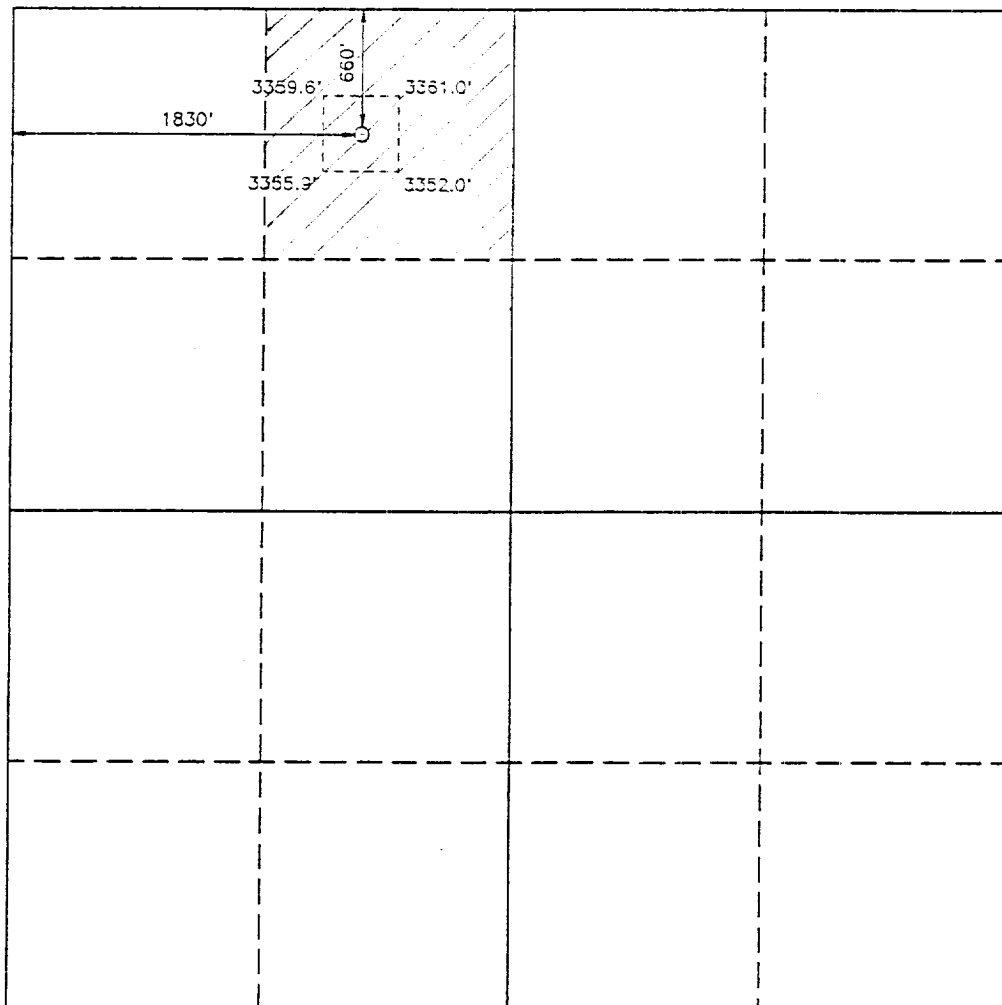

OPERATOR CERTIFICATION

I hereby certify the the information contained herein is true and complete to the best of my knowledge and belief.

Signature
William R. Dannels

Printed Name
William R. Dannels

Position
Division Drilling Supt.
Company
Bass Enterprises Prod. Co.

Date
11-18-93

SURVEYOR CERTIFICATION

I hereby certify that the well location shown on this plat was plotted from field notes of actual surveys made by me or under my supervision, and that the same is true and correct to the best of my knowledge and belief.

Date Surveyed
OCTOBER 28, 1993

Signature & Seal of
Professional Surveyor
GARY L. JONES
NEW MEXICO
1977
Certificate No. *JOHN W. WEST* 676
RONALD L. EDSON 3238
GARY L. JONES 7977

93-11-2106

3000 PSI WP

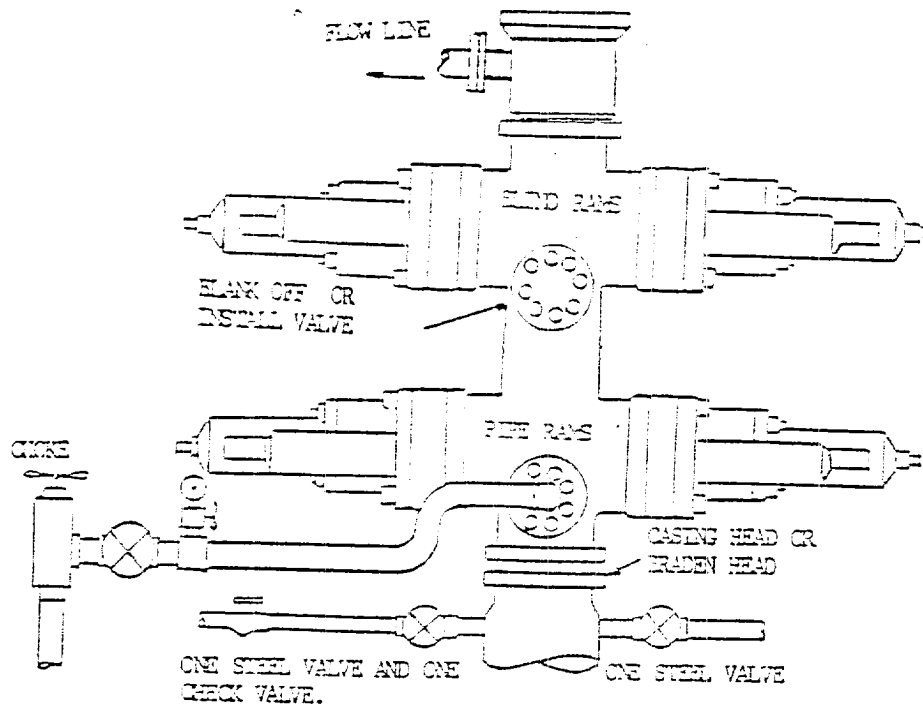

THE FOLLOWING CONSTITUTE MINIMUM BLOWOUT PREVENTER REQUIREMENTS

- A. One double gate blowout preventer with lower rans for pipe and upper rans blind, all hydraulically controlled.
- B. Opening on preventers between rans to be flanged, studded or clamped and at least two inches diameter.
- C. All connections from operating manifold to preventers to be all steel hose or tube a minimum of one inch in diameter.
- D. The available closing pressure shall be at least 15% in excess of that required with sufficient volume to operate (close, open, and re-close) the preventers.
- E. All connections to and from preventers to have a pressure rating equivalent to that of the BOP's.
- F. Manual controls to be installed before drilling cement plug.
- G. Valve to control flow through drill pipe to be located on rig floor.
- H. Choke may be either positive or adjustable. Choke spool may be used between rans.