

NM OIL CONS. COMMISSION
DRAWER DD
ARTESIA, NM UNITED STATES
DEPARTMENT OF THE INTERIOR
BUREAU OF LAND MANAGEMENT

SUBMIT IN TRIPLICATE*
(Other instructions on
reverse side)

Form approved.
Budget Bureau No. 1004-0136
Expires: December 31, 1991

clh

APPLICATION FOR PERMIT TO DRILL OR DEEPEN

1a. TYPE OF WORK
DRILL ☒ DEEPEN ☐

b. TYPE OF WELL
OIL WELL ☒ GAS WELL ☐ OTHER ☐

2. NAME OF OPERATOR
Bass Enterprises Production Company

3. ADDRESS AND TELEPHONE NO.
P.O. Box 2760, Midland, TX 79702 (915) 683-2277

4. LOCATION OF WELL (Report location clearly and in accordance with any State requirements.)
At surface 1980' FNL & 1980' FWL, Section 19, T-24-S, R-31-E
At proposed prod. zone

14. DISTANCE IN MILES AND DIRECTION FROM NEAREST TOWN OR POST OFFICE*
15 miles west from Malaga, New Mexico

15. DISTANCE FROM PROPOSED* LOCATION TO NEAREST PROPERTY OR LEASE LINE, FT.
(Also to nearest drig. unit line, if any) 660

18. DISTANCE FROM PROPOSED LOCATION* TO NEAREST WELL, DRILLING COMPLETED, OR APPLIED FOR, ON THIS LEASE, FT. 1320

21. ELEVATIONS (Show whether DF, RT, GR, etc.)
3480' - GR

5. LEASE DESIGNATION AND SERIAL NO.
NM 025533

6. IF INDIAN, ALLOTTEE OR TRIBE NAME

7. UNIT AGREEMENT NAME
Poker Lake Unit 1796

8. FARM OR LEASE NAME, WELL NO.
Poker Lake Unit #104

9. AN WELL NO.
30-115-27969

10. FIELD AND POOL, OR WILDCAT
Poker Lake (Delaware)

11. SEC. T., R., M., OR BLK. AND SURVEY OR AREA
96047
Section 19, T-24-S, R-31-E

12. COUNTY OR PARISH
Eddy

13. STATE
New Mexico

16. NO. OF ACRES IN LEASE
324.37

17. NO. OF ACRES ASSIGNED TO THIS WELL
40

19. PROPOSED DEPTH
8350'

20. ROTARY OR CABLE TOOLS
Rotary

22. APPROX. DATE WORK WILL START*
Upon Approval

23. PROPOSED CASING AND CEMENTING PROGRAM

SIZE OF HOLE	GRADE SIZE OF CASING	WEIGHT PER FOOT	SETTING DEPTH	QUANTITY OF CEMENT
*14-3/4"	WC-40 11-3/4"	42#	850'	480 SX Circ. to Surface
**11"	WC-50 8-5/8"	32#	4120'	775 SX Circ. to Surface
*** 7-7/8"	K-55 5-1/2"	15.5#	8350'	620 SX (Tie back to int. csq @ 3920')

*Surface casing to be set + 100' above salt in the Rustler Anhydrite.
**Intermediate casing to be set in the top of the Lamar Lime.
***D.V. Tool to be set @ + 6000'; Cement to tie back to 3920'.

Post #D-1
5-27-94
New Loc & API

EXP. INT.
7-30-96

Drilling procedure, BOP diagram, anticipated tops and surface use plans attached.

This well is outside the R-111 Potash areas.

CONFIRMATION#P 237 023 593-BGH:PGO

IN ABOVE SPACE DESCRIBE PROPOSED PROGRAM: If proposal is to deepen, give data on present productive zone and proposed new productive zone. If proposal is to drill or deepen directionally, give pertinent data on subsurface locations and measured and true vertical depths. Give blowout preventer program, if any.

24. SIGNED William R. Donnell TITLE Division Drlg. Supt. DATE 4-8-94

(This space for Federal or State office use)

PERMIT NO. _____ APPROVAL DATE _____
Application approval does not warrant or certify that the applicant holds legal or equitable title to those rights in the subject lease which would entitle the applicant to conduct operations thereon.
CONDITIONS OF APPROVAL, IF ANY: **APPROVAL SUBJECT TO GENERAL REQUIREMENTS AND SPECIAL STIPULATIONS ATTACHED**

APPROVED BY (ORIG. SCD.) RICHARD L. MANUS TITLE AREA MANAGER DATE MAY 13 1994

*See Instructions On Reverse Side

Submit to Appropriate
District Office
State Lease - 4 copies
Fee Lease - 3 copies

State of New Mexico
Energy, Minerals and Natural Resources Department

Form C-102
Revised 1-1-89

OIL CONSERVATION DIVISION

P.O. Box 2088
Santa Fe, New Mexico 87504-2088

DISTRICT I

P.O. Box 1980, Hobbs, NM 88240

DISTRICT II

P.O. Drawer DD, Artesia, NM 88210

DISTRICT III

1000 Elc Brazos Rd., Aztec, NM 87410

WELL LOCATION AND ACREAGE DEDICATION PLAT

All Distances must be from the outer boundaries of the section

Operator BASS ENTERPRISES PRODUCTION COMPANY			Lease POKER LAKE UNIT		Well No. 104
Unit Letter F	Section 19	Township 24 SOUTH	Range 31 EAST	NMPM	County EDDY
Actual Footage Location of Well: 1980 feet from the NORTH line and 1980 feet from the WEST line					
Ground Level Elev. 3480'	Producing Formation Delaware	Pool Poker Lake (Delaware)			Dedicated Acreage: 40 Acres

- Outline the acreage dedicated to the subject well by colored pencil or hatchure marks on the plat below.
- If more than one lease is dedicated to the well, outline each and identify the ownership thereof (both as to working interest and royalty).
- If more than one lease of different ownership is dedicated to the well, have the interest of all owners been consolidated by communization, unitization, force-pooling, etc.?
☐ Yes ☐ No If answer is "yes" type of consolidation _____
If answer is "no" list of owners and tract descriptions which have actually been consolidated. (Use reverse side of this form necessary).
No allowable will be assigned to the well unit all interests have been consolidated (by communization, unitization, forced-pooling, otherwise) or until a non-standard unit, eliminating such interest, has been approved by the Division.

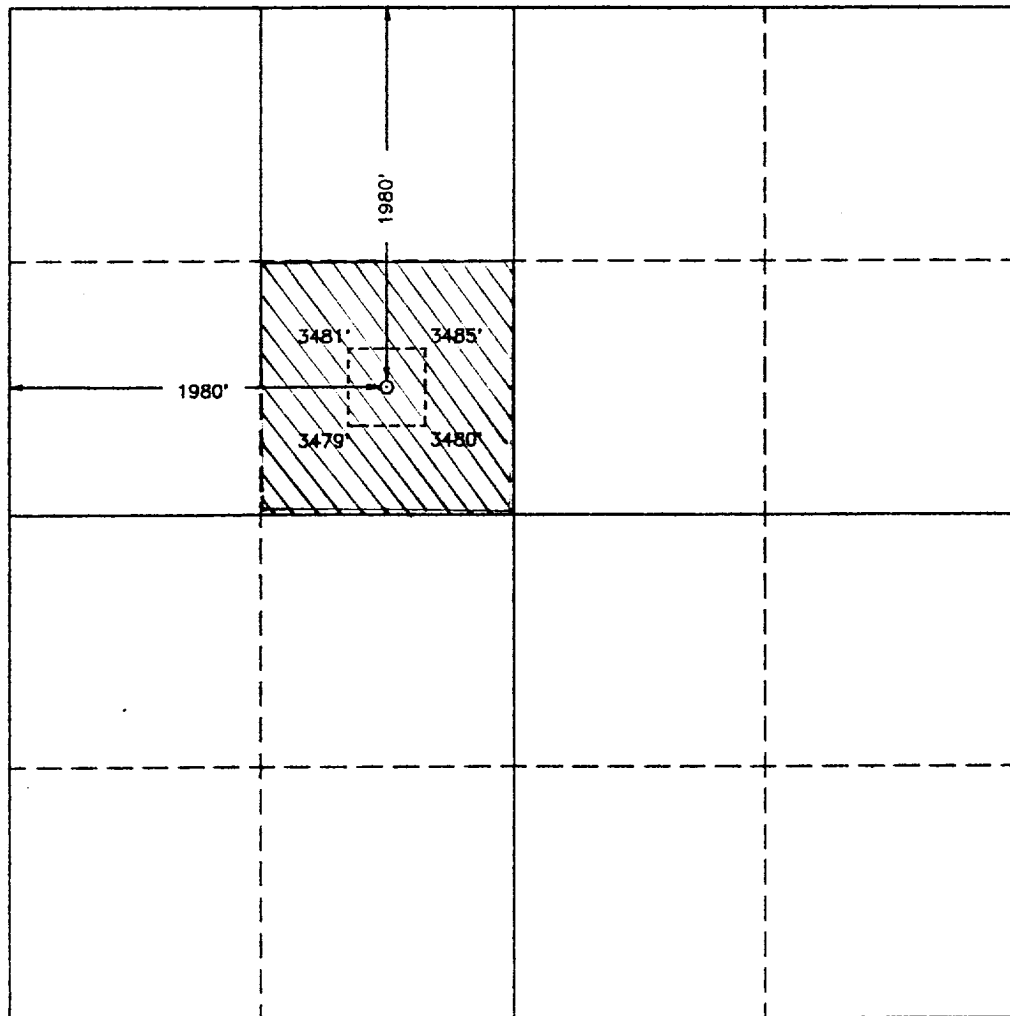

OPERATOR CERTIFICATION

I hereby certify the the information
contigned herein is true and complete to the
best of my knowledge and belief.

Signature
William R. Dannels

Printed Name
W.R. Dannels

Position
Division Drlg. Supt.

Company
Bass Enterprises Prod. Co.

Date
4-8-94

SURVEYOR CERTIFICATION

I hereby certify that the well location shown
on this plat was plotted from field notes of
actual surveys made by me or under my
supervision, and that the same is true and
correct to the best of my knowledge and
belief.

Date Surveyed
MARCH 3, 1994

Signature & Seal of
Professional Surveyor

7977

REGISTERED PROFESSIONAL SURVEYOR

Certificate No. 678
RONALD J. EIDSON, 3239
GARY L. JONES, 7977

94-11-0377

3000 PSI WP

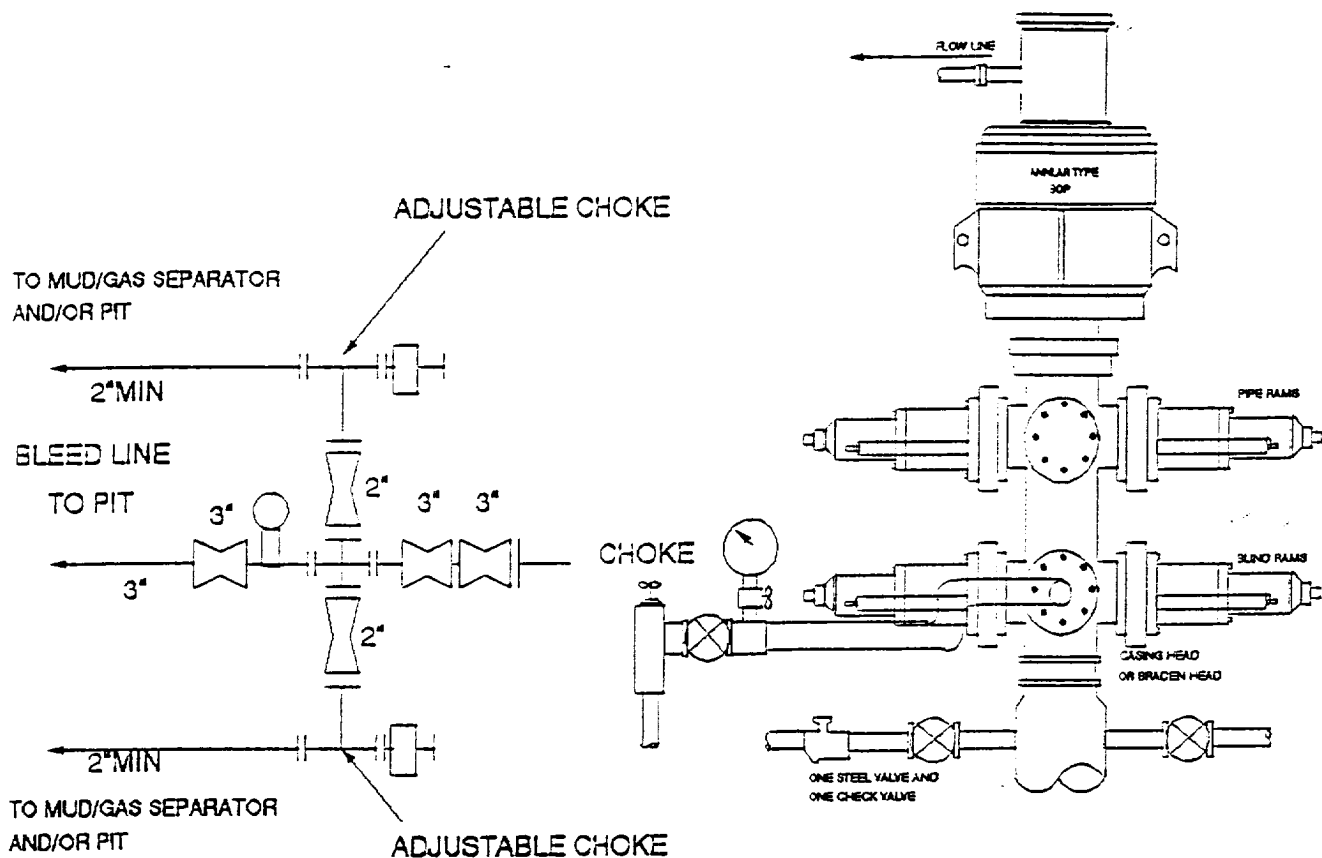

THE FOLLOWING CONSTITUTE MINIMUM BLOWOUT PREVENTER REQUIREMENTS

- A. One double gate blowout preventer with lower rams for pipe and upper rams blind, all hydraulically controlled.
- B. Opening on preventers between rams to be flanged, studded or clamped and at least two inches in diameter.
- C. All connections from operating manifold to preventers to be all steel hose or tube a minimum of one inch in diameter.
- D. The available closing pressure shall be at least 15% in excess of that required with sufficient volume to operate (close, open, and re-close) the preventers.
- E. All connections to and from preventers to have a pressure rating equivalent to that of the BOP's.
- F. Manual controls to be installed before drilling cement plug.
- G. Valve to control flow through drill pipe to be located on rig floor.
- H. Choke may be either positive or adjustable. Choke spool may be used between rams.

DIAGRAM 1