

DISTRICT I
P. O. Box 1980
Hobbs, NM 88241-1980

State of New Mexico
Energy, Minerals, and Natural Resources Department

Form C-102
Revised 02-10-94

Instructions on back

DISTRICT II
P. O. Drawer DD
Artesia, NM 88211-0719

OIL CONSERVATION DIVISION

P. O. Box 2088
Santa Fe, New Mexico 87504-2088

Submit to the Appropriate
District Office
State Lease - 4 copies
Fee Lease - 3 copies

☐ AMENDED REPORT

DISTRICT IV
P. O. Box 2088
Santa Fe, NM 87507-2088

WELL LOCATION AND ACREAGE DEDICATION PLAT

1 API Number		2 Pool Code		3 Pool Name Undesignated (Morrow)					
4 Property Code		5 Property Name TALON '22' STATE COM						6 Well Number 1	
7 OGRID No.		8 Operator Name SANTA FE ENERGY OPER. PART, L.P.						9 Elevation 2957'	
10 SURFACE LOCATION									
UL or lot no. N M	Section 22	Township 25 SOUTH	Range 28 EAST, N.M.P.M.	Lot Ida	Feet from the 660'	North/South line SOUTH	Feet from the 1980'	East/West line WEST	County EDDY
"BOTTOM HOLE LOCATION IF DIFFERENT FROM SURFACE"									
UL or lot no.	Section	Township	Range	Lot Ida	Feet from the	North/South line	Feet from the	East/West line	County
12 Dedicated Acres 640		13 Joint or Infill		14 Consolidation Code		15 Order No.			
NO ALLOWABLE WELL BE ASSIGNED TO THIS COMPLETION UNTIL ALL INTERESTS HAVE BEEN CONSOLIDATED OR A NON-STANDARD UNIT HAS BEEN APPROVED BY THE DIVISION									

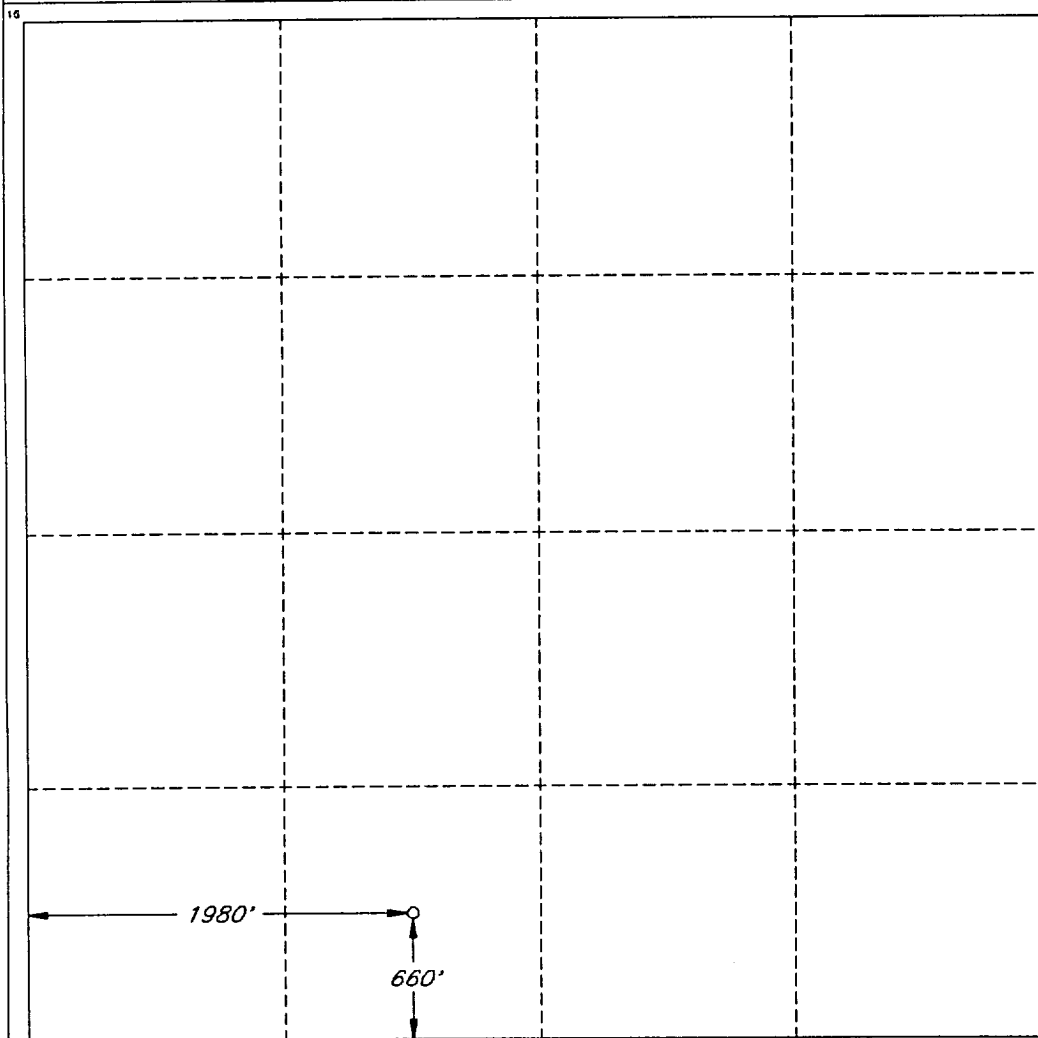

OPERATOR CERTIFICATION

I hereby certify that the information contained herein is true and complete to the best of my knowledge and belief.

Signature
James P. Phil Stinson
Printed Name
James P. "Phil" Stinson
Title
Agent for Santa Fe Energy
Date
12-22-94

SURVEYOR CERTIFICATION

I hereby certify that the well location shown on this plat was plotted from field notes of actual surveys made by me or under my supervision, and that the same is true and correct to the best of my belief.

Date of Survey
DECEMBER 14, 1994

Signature and Seal of Professional Surveyor
V. L. BEZNER
Certification No. 7920
V. L. BEZNER S.P.S. #7920
JOB #37980 L-24 SE / C.L.S.

22
Section 10

N2 NE/4 - Yates Pet, et al
SE/4 NE/4 - Yates Pet, et al
SW/4 NE/4 - Maralo

SE/4 - Maralo

SW/4 - SFE

NW/4 - SFE