

UNITED STATES
DEPARTMENT OF THE INTERIOR
BUREAU OF LAND MANAGEMENT

APPLICATION FOR PERMIT TO DRILL OR DEEPEN

1a. TYPE OF WORK

DRILL ☒

DEEPEN ☐

b. TYPE OF WELL

OIL WELL ☐

GAS WELL ☒

OTHER

SINGLE ZONE ☒

MULTIPLE ZONE ☐

2. NAME OF OPERATOR

BASS ENTERPRISES PRODUCTION CO.

3. ADDRESS AND TELEPHONE NO.

P.O. BOX 2760 MIDLAND, TX. 79702 915-683-2277

4. LOCATION OF WELL (Report location clearly and in accordance with any State requirements.)

At surface

1980' FNL & 1980' FWL, SECTION 27, T24S, R31E
At proposed prod. zone

Unit F

14. DISTANCE IN MILES AND DIRECTION FROM NEAREST TOWN OR POST OFFICE*

30 MILES SE OF CARLSBAD, N.M.

15. DISTANCE FROM PROPOSED*

LOCATION TO NEAREST
PROPERTY OR LEASE LINE, FT.

660'

FROM UNIT

933'

FROM LEASE

(Also to nearest drig. unit line, if any)

18. DISTANCE FROM PROPOSED LOCATION*
TO NEAREST WELL, DRILLING, COMPLETED,
OR APPLIED FOR, ON THIS LEASE, FT.

1300'

16. NO. OF ACRES IN LEASE

960'

17. NO. OF ACRES ASSIGNED
TO THIS WELL

320'

19. PROPOSED DEPTH

15,400'

20. ROTARY OR CABLE TOOLS

ROTARY

21. ELEVATIONS (Show whether DF, RT, GR, etc.)

3500' GR

22. APPROX. DATE WORK WILL START*

UPON APPROVAL

23. PROPOSED CASING AND CEMENTING PROGRAM

SIZE OF HOLE	GRADE SIZE OF CASING	WEIGHT PER FOOT	SETTING DEPTH	QUANTITY OF CEMENT
1 26"	20" H-40	94#	840'	1650 sx (circ to surface)
2 17-1/2"	13-3/8" N-80	68#	4400'	3200 sx (circ to surface)
3 12-1/4"	9-5/8" P-110	53.5#	12,000'	2450 sx (TOC @ 5700')
4 8-1/2" *	7-5/8" P-110	39#	14,800'	400 sx (TOC @ 11,700')
5 6-1/2"	5-1/2" S-95	20#	15,400'	80 sx (TOC @ 14,500')

1 Set +/- 100' above the salt in Rustler Anhydrite

2 Set above the T/Lamar Lime

3 Set into T/Wolfcamp

4 Set above the Middle Morrow and tied back into 9-5/8" +/- 300'.

5 Set at total depth and tied back into 7-5/8" +/- 300'.

DRILLING PROCEDURE, BOP DIAGRAMS, TOPS, AND SURFACE USE SPONS ATTACHED.

* ONLY IF REQUIRED

Certified # Z 112 327 697

RMN/WRD 08/10/95

IN ABOVE SPACE DESCRIBE PROPOSED PROGRAM: If proposal is to deepen, give data on present productive zone and proposed new productive zone. If proposal is to drill or deepen directionally, give pertinent data on subsurface locations and measured and true vertical depths. Give blowout preventer program, if any.

24.

SIGNED

William R. Dannel

TITLE

DIVISION DRILLING SUPT.

DATE 8-8-95

(This space for Federal or State office use)

PERMIT NO.

APPROVAL DATE

Application approval does not warrant or certify that the applicant holds legal or equitable title to those rights in the subject lease which would entitle the applicant to conduct operations thereon.

CONDITIONS OF APPROVAL, IF ANY:

APPROVED BY

TITLE

DATE

*See Instructions On Reverse Side

Title 18 U.S.C. Section 1001, makes it a crime for any person knowingly and willfully to make to any department or agency of the United States any false, fictitious or fraudulent statements or representations as to any matter within its jurisdiction.

DISTRICT I
P.O. Box 1980, Hobbs, NM 88240

State of New Mexico
Energy, Minerals and Natural Resources Department

Form C-102
Revised February 10, 1994
Instruction on back
Submit to Appropriate District Office
State Lease - 4 Copies
Fca Lease - 3 Copies

DISTRICT II
P.O. Drawer DD, Artesia, NM 88210

DISTRICT III
1000 Rio Brazos Rd., Aztec, NM 87410

DISTRICT IV
PO BOX 2088, SANTA FE, NM 87504-2088

OIL CONSERVATION DIVISION

P.O. Box 2088
Santa Fe, New Mexico 87504-2088

☐ AMENDED REPORT

WELL LOCATION AND ACREAGE DEDICATION PLAT

API Number 30-015-28640	Pool Code 90622	Pool Name Eddy Unders; MORROW
Property Code	Property Name POKER LAKE	Well Number 125
OGRID No. 001801	Operator Name BASS ENTERPRISES PRODUCTION CO.	Elevation 3500

Surface Location

UL or lot No. F	Section 27	Township 24 S	Range 31 E	Lot Idn	Feet from the 1980	North/South line NORTH	Feet from the 1980	East/West line WEST	County EDDY
---------------------------	----------------------	-------------------------	----------------------	---------	------------------------------	----------------------------------	------------------------------	-------------------------------	-----------------------

Bottom Hole Location If Different From Surface

UL or lot No.	Section	Township	Range	Lot Idn	Feet from the	North/South line	Feet from the	East/West line	County
Dedicated Acres 320	Joint or Infill	Consolidation Code	Order No.						

NO ALLOWABLE WILL BE ASSIGNED TO THIS COMPLETION UNTIL ALL INTERESTS HAVE BEEN CONSOLIDATED
OR A NON-STANDARD UNIT HAS BEEN APPROVED BY THE DIVISION

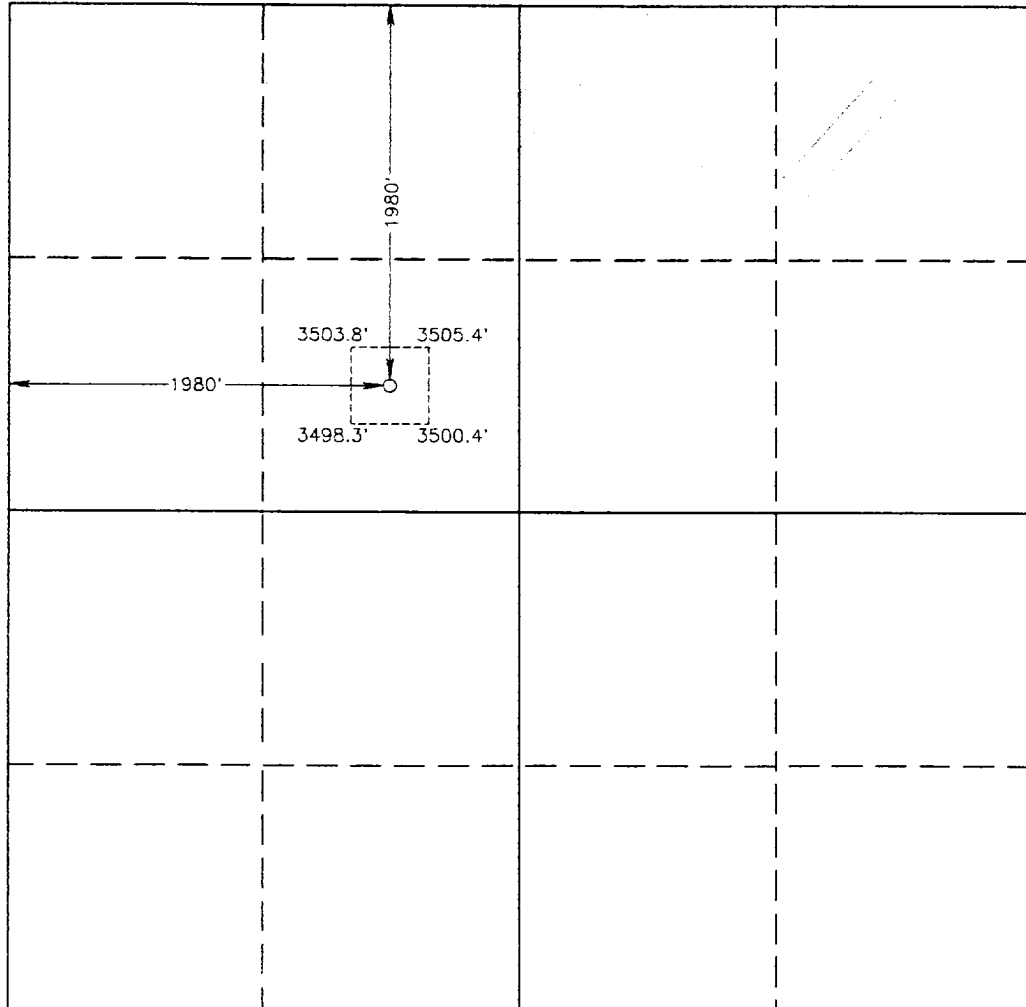
	<p>OPERATOR CERTIFICATION</p> <p>I hereby certify the the information contained herein is true and complete to the best of my knowledge and belief.</p> <p><i>William R. Dannels</i> Signature William R. Dannels Printed Name Division Drilling Supt. Title August 10, 1995 Date</p>
	<p>SURVEYOR CERTIFICATION</p> <p>I hereby certify that the well location shown on this plat was plotted from field notes of actual surveys made by me or under my supervision, and that the same is true and correct to the best of my belief.</p> <p>JULY 31, 1995</p> <p>Date Surveyed Signature & Seal of Professional Surveyor Professional Surveyor J. Eidson 8-04-95 P.O. Num. 95-1173 Certificate No. JOHN A. WEST 676 J. EIDSON 3239 EIDSON 12641</p>

5000 PSI WP

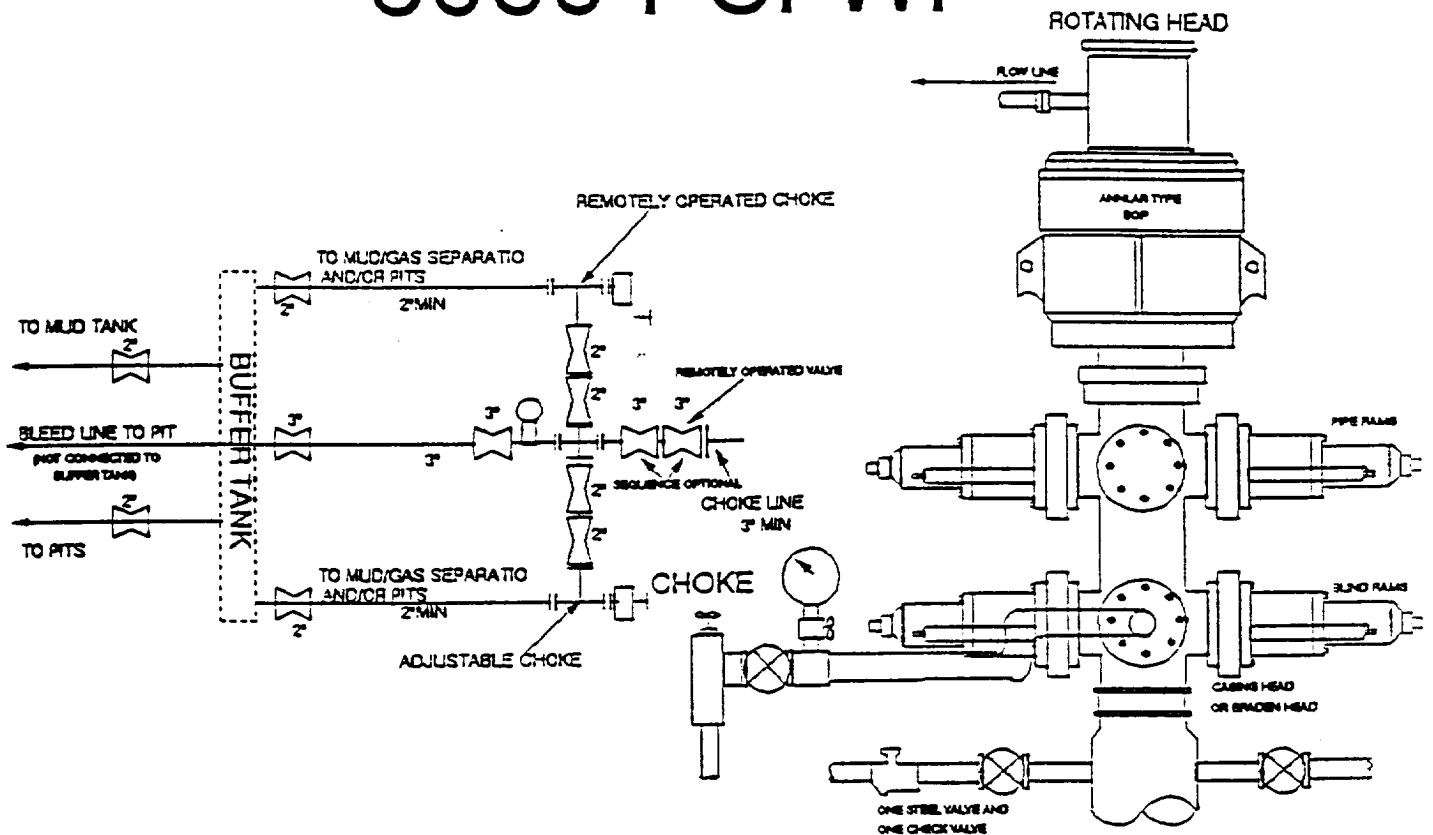

THE FOLLOWING CONSTITUTE MINIMUM BLOWOUT PREVENTER REQUIREMENTS

- A. One double gate blowout preventer with lower rams for pipe and upper rams blind, all hydraulically controlled.
- B. Opening on preventers between rams to be flanged, studded or clamped and at least two inches in diameter.
- C. All connections from operating manifold to preventers to be all steel hose or tube a minimum of one inch in diameter.
- D. The available closing pressure shall be at least 15% in excess of that required with sufficient volume to operate (close, open, and re-close) the preventers.
- E. All connections to and from preventers to have a pressure rating equivalent to that of the BOP's.
- F. Manual controls to be installed before drilling cement plug.
- G. Valve to control flow through drill pipe to be located on rig floor.
- H. All chokes will be adjustable. Choke spool may be used between rams.

10-M WP BOP WITH 10-M ANNULAR

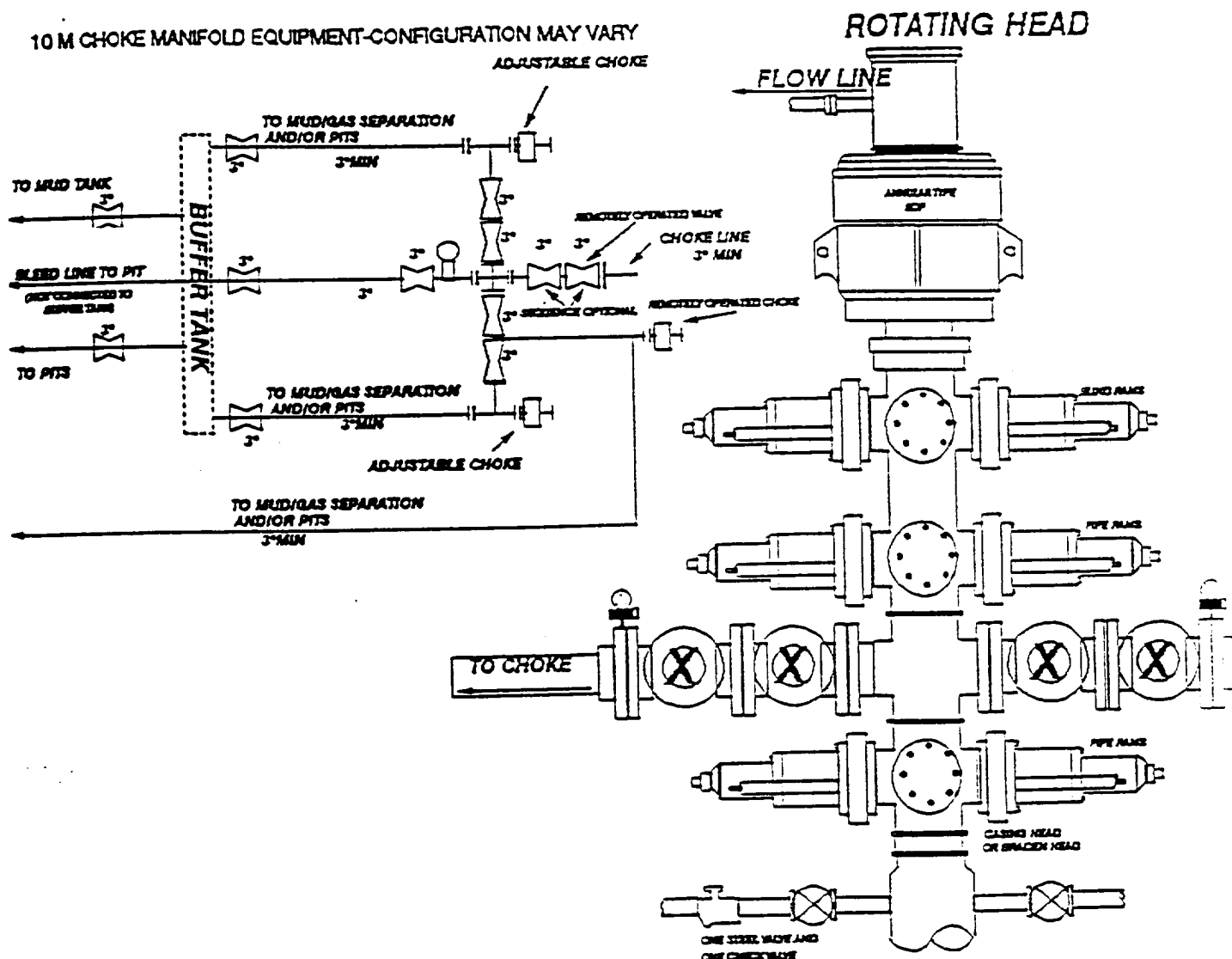

THE FOLLOWING CONSTITUTE MINIMUM BLOWOUT PREVENTER REQUIREMENTS:

- Opening between the ram to be flanged, studded, or clamped.
- All connections from operating manifolds to preventers to be all steel hose or tube a minimum of one inch diameter.
- The available closing pressure shall be at least 15% in excess of that required with sufficient volume to operate (close, open, and re-close) the preventors.
- ALL connections to and from preventer to have a pressure rating equivalent to that of the BOPs.
- Manual controls to be installed before drilling cement plug.
- Kelly cock to be installed on kelly.
- Inside blowout preventer to be available on rig floor.
- Dual operating controls: one located by drillers position and the other located a safe distance from the rig floor.
- All chokes will be adjustable.

DIAGRAM 2