

NM OIL CONS COMMISSION  
UN. D STATE SDD  
DEPARTMENT OF ARS, IN, MT 00210  
BUREAU OF LAND MANAGEMENTSUBMIT IN TRIPLICATE  
(Other instructive  
reverse side)FORM APPROVED  
OMB NO. 1004-0136  
Expires: February 28, 1995

## APPLICATION FOR PERMIT TO DRILL OR DEEPEN

## 1a. TYPE OF WORK

DRILL ☒DEEPEN ☐

## b. TYPE OF WELL

OIL  
WELL ☒GAS  
WELL ☐

OTHER

SINGLE  
ZONE ☒MULTIPLE  
ZONE ☐

## 2. NAME OF OPERATOR

Santa Fe Energy Resources, Inc.

## 3. ADDRESS AND TELEPHONE NO.

550 W. Texas, Suite 1330; Midland, Texas 79701

(915) 692-6373

## 4. LOCATION OF WELL (Report location clearly and in accordance with any State requirements.)

At surface

F 2460' FNL &amp; 2600' FWL

At proposed prod. zone

UNORTHODOX  
LOCATION:

## 14. DISTANCE IN MILES AND DIRECTION FROM NEAREST TOWN OR POST OFFICE\*

17 1/2 miles west of Carlsbad, New Mexico

## 15. DISTANCE FROM PROPOSED\*

LOCATION TO NEAREST  
PROPERTY OR LEASE LINE, FT.  
(Also to nearest drlg. unit line, if any)

2460'

## 16. NO. OF ACRES IN LEASE

1280

## 18. DISTANCE FROM PROPOSED LOCATION\*

TO NEAREST WELL, DRILLING, COMPLETED,  
OR APPLIED FOR, ON THIS LEASE, FT.

1805'

## 19. PROPOSED DEPTH

8400'

17. NO. OF ACRES ASSIGNED  
TO THIS WELL.

320

## 20. ROTARY OR CABLE TOOLS

Rotary

## 21. ELEVATIONS (Show whether DF, RT, GR, etc.)

3808 GR

Roswell Controlled Water Basin

## 22. APPROX. DATE WORK WILL START\*

November 20, 1995

## 23.

## PROPOSED CASING AND CEMENTING PROGRAM

SIZE OF HOLE	GRADE, SIZE OF CASING	WEIGHT PER FOOT	SETTING DEPTH	QUANTITY OF CEMENT
12 3/4"	K-55 9 5/8"	36.0	1200'	575 sx to circulate
8 3/4"	K-55 7"	26.0	8400'	400 sx TOC

We propose to drill to a depth sufficient to test the Cisco/Canyon formation for oil. If productive, 7" casing will be run to TD. If non-productive, the well will be plugged and abandoned in a manner consistent with Federal Regulations. Specific programs as per Onshore Oil and Gas Order No. 1 are outlined in the following attachments:

## Drilling Program

Exhibit A - Operations Plan

Exhibit B - BOP and Choke Manifold

Exhibit C - Drilling Fluid Program

Exhibit D - Auxiliary Equipment

Exhibit E - Topo Map at Location

Exhibit F - Map Showing Existing Wells

Exhibit F (A) - Plat of Location

Exhibit G - Well Site Layout

Surface Use and Operations Plan

H2S Drilling Operations Plan

Santa Fe Energy Resources, Inc. accepts all applicable terms, conditions, stipulations and restrictions concerning operations conducted on the leased land or portion thereof, as described above.

## Bond Coverage: Blanket Bond

BLM Bond File No.: MT 0750

IN ABOVE SPACE DESCRIBE PROPOSED PROGRAM: If proposal is to deepen, give data on present productive zone and proposed new productive zone. If proposal is to drill or deepen directionally, give pertinent data on subsurface locations and measured and true vertical depths. Give blowout preventer program, if any.

## 24.

SIGNED

James J. Phil Stinson

TITLE Agent for Santa Fe Energy

DATE 10-16-95

(This space for Federal or State office use)

PERMIT NO.

APPROVAL DATE

Application approval does not warrant or certify that the applicant holds legal or equitable title to those rights in the subject leasehold which entitle the applicant to conduct operations thereon.

CONDITIONS OF APPROVAL, IF ANY:

NSL#

PROVED BY

/s/ Yolanda Vega

TITLE

ASSISTANT AREA MGR

DATE

12-5-95

\*See Instructions On Reverse Side

U.S.C. Section 1001, makes it a crime for any person knowingly and willfully to make to any department or agency of the U.S. any false, fictitious or fraudulent statements or representations as to any matter within its jurisdiction.

DISTRICT I  
P. O. Box 1980  
Hobbs, NM 88241-1980

State of New Mexico  
Energy, Minerals, and Natural Resources Department

Form C-102  
Revised 02-10-94

Instructions on back

DISTRICT II  
P. O. Drawer DD  
Artesia, NM 88211-0719

OIL CONSERVATION DIVISION  
P. O. Box 2088  
Santa Fe, New Mexico 87504-2088

Submit to the Appropriate  
District Office  
State Lease - 4 copies  
Fee Lease - 3 copies

☐ AMENDED REPORT

DISTRICT III  
1000 Rio Brazos Rd.  
Aztec, NM 87410

DISTRICT IV  
P. O. Box 2088  
Santa Fe, NM 87507-2088

WELL LOCATION AND ACREAGE DEDICATION PLAT

<sup>1</sup> API Number <b>30-015-28740</b>	<sup>2</sup> Pool Code <b>15475</b>	<sup>3</sup> Pool Name <b>South Dagger Draw ; Upper Penn. (Assoc.)</b>
<sup>4</sup> Property Code	<sup>5</sup> Property Name <b>ROARING SPRINGS '14' FEDERAL COM</b>	<sup>6</sup> Well Number <b>7</b>
<sup>7</sup> OGRID No.	<sup>8</sup> Operator Name <b>SANTA FE ENERGY RESOURCES, INC.</b>	<sup>9</sup> Elevation <b>3808'</b>

<sup>10</sup> SURFACE LOCATION

UL or lot no. <b>F</b>	Section <b>14</b>	Township <b>21 SOUTH</b>	Range <b>23 EAST, N.M.P.M.</b>	Lot Ida	Feet from the <b>2460'</b>	North/South line <b>NORTH</b>	Feet from the <b>2600'</b>	East/West line <b>WEST</b>	County <b>EDDY</b>
---------------------------	----------------------	-----------------------------	-----------------------------------	---------	-------------------------------	----------------------------------	-------------------------------	-------------------------------	-----------------------

"BOTTOM HOLE LOCATION IF DIFFERENT FROM SURFACE

UL or lot no.	Section	Township	Range	Lot Ida	Feet from the	North/South line	Feet from the	East/West line	County
---------------	---------	----------	-------	---------	---------------	------------------	---------------	----------------	--------

<sup>12</sup> Dedicated Acres <b>320</b>	<sup>13</sup> Joint or Infill	<sup>14</sup> Consolidation Code	<sup>15</sup> Order No.
---	-------------------------------	----------------------------------	-------------------------

NO ALLOWABLE WELL BE ASSIGNED TO THIS COMPLETION UNTIL ALL INTERESTS HAVE BEEN  
CONSOLIDATED OR A NON-STANDARD UNIT HAS BEEN APPROVED BY THE DIVISION

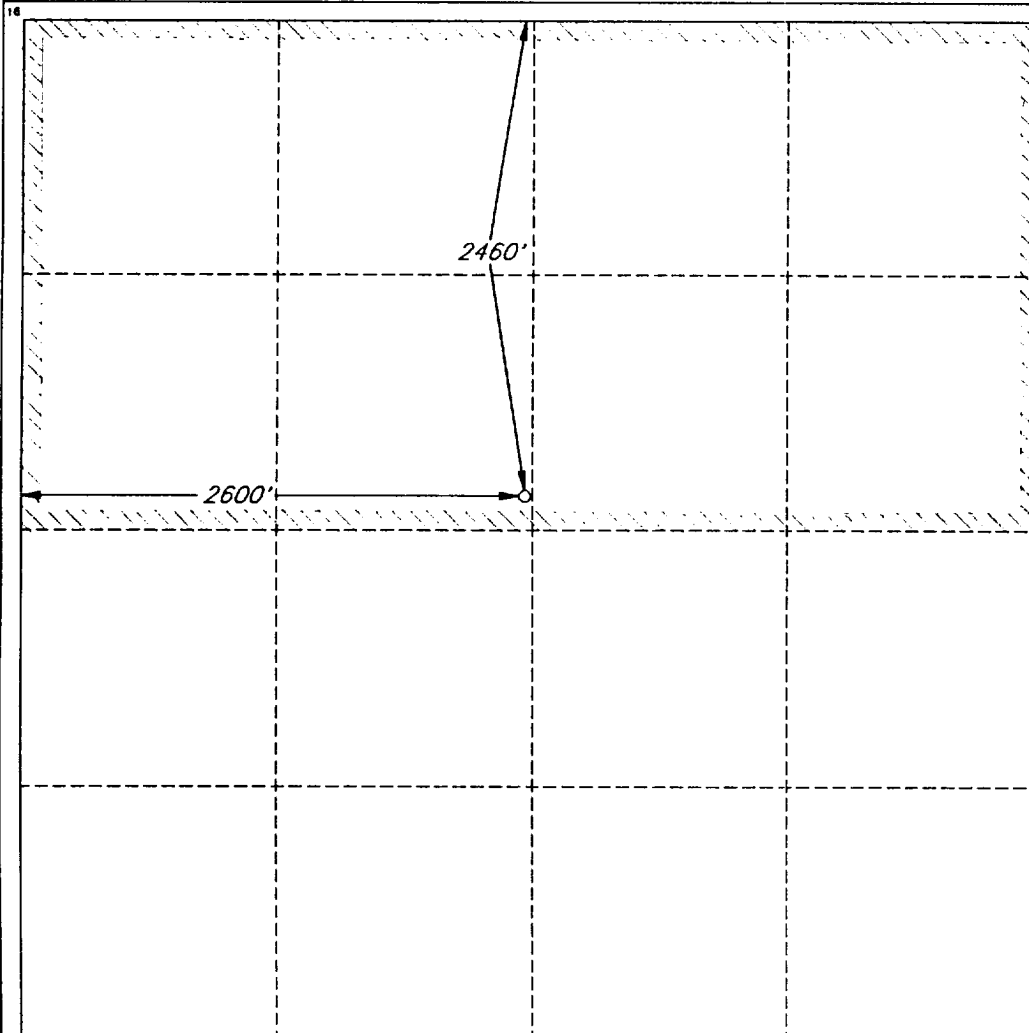

OPERATOR CERTIFICATION

I hereby certify that the information  
contained herein is true and complete  
to the best of my knowledge and belief.

Signature: *James P. "Phil" Stinson*

Printed Name  
**James P. "Phil" Stinson**

Title  
**Agent for Santa Fe Energy**

Date  
**10-16-95**

SURVEYOR CERTIFICATION

I hereby certify that the well  
location shown on this plat was  
plotted from field notes of actual  
surveys made by me or under  
my supervision, and that the  
same is true and correct to the  
best of my belief.

Date of Survey  
**SEPTEMBER 18, 1995**

Signature and Seal of  
Professional Surveyor  
*V. Lynn Bezner*  
Certifying to:  
**V. L. BEZNER, S.P.S. #7920**  
JOB #41506-48 SE / JSJ

SANTA FE ENERGY RESOURCES, INC.  
ROARING SPRINGS "14" FED COM #7  
2460' FNL & 2600' FWL  
SEC 14, T-21-S, R-23-E  
EDDY COUNTY, NEW MEXICO

