

CONSERVATION DIV
811 S. 1st ST.
ARTESIA, NM 88210-2834
UNITED STATES
DEPARTMENT OF THE INTERIOR
BUREAU OF LAND MANAGEMENT

SUBMIT IN TRIPLICATE*
(Other instructions on
reverse side)

FORM APPROVED
OMB NO. 1004-0136
Expires: February 28, 1995

APPLICATION FOR PERMIT TO DRILL OR DEEPEN

1a. TYPE OF WORK DRILL <input checked="" type="checkbox"/> DEEPEN <input type="checkbox"/>			5. LEASE DESIGNATION AND SERIAL NO. NM-30070		
b. TYPE OF WELL OIL WELL <input checked="" type="checkbox"/> GAS WELL <input type="checkbox"/> OTHER <input type="checkbox"/>			6. IF INDIAN, ALLOTTEE OR TRIBE NAME		
2. NAME OF OPERATOR Sonat Exploration Company 915-684-0400 109487			7. UNIT AGREEMENT NAME 18846		
3. ADDRESS AND TELEPHONE NO. 110 W. Louisiana, Su. 500, Midland, Texas 79701			8. FARM OR LEASE NAME, WELL NO. Lotos "12-G" Federal #1		
4. LOCATION OF WELL (Report location clearly and in accordance with any State requirements.)* At surface 660' FNL & 330' FEL of Section 12 At proposed prod. zone Same UNIT A			9. API WELL NO. 30-015-28936		
14. DISTANCE IN MILES AND DIRECTION FROM NEAREST TOWN OR POST OFFICE* 20 miles east of Loving, New Mexico			10. FIELD AND POOL, OR WILDCAT Wildcat, (Delaware/Bone Springs) Undesignated MESA VERDE		
15. DISTANCE FROM PROPOSED* LOCATION TO NEAREST PROPERTY OR LEASE LINE, FT. (Also to nearest drlg. unit line, if any) 330'			11. SEC. T., R., M., OR BLE. AND SURVEY OR AREA Sec. 12, T-24S, R31E		
16. NO. OF ACRES IN LEASE 1570.65			12. COUNTY OR PARISH 13. STATE Eddy Co. N.M.		
17. DISTANCE FROM PROPOSED* LOCATION TO NEAREST WELL, DRILLING, COMPLETED, OR APPLIED FOR, ON THIS LEASE, FT. 1st well 9,000'			14. ROTARY OR CABLE TOOLS Rotary		
21. ELEVATIONS (Show whether DF, RT, GR, etc.) 3543' Ground Level			22. APPROX. DATE WORK WILL START* 1st quarter -1996		

PROPOSED CASING AND CEMENTING PROGRAM				
SIZE OF HOLE	GRADE SIZE OF CASING	WEIGHT PER FOOT	SETTING DEPTH	QUANTITY OF CEMENT
14 3/4"	11 3/4"	42# WC-40	810' 830' ²⁶	Sufficient to circulate
11"	8 5/8"	23# M-50	4300' 4450' ²⁶	Sufficient to circulate
7 7/8"	5 1/2"	17# J-55	9,000'	2050sx

The operator proposes to drill to a depth sufficient to test the Delaware and Bone Springs for oil. Specific programs are outlined in the following attachments:

DRILLING PROGRAM
SURFACE USE AND OPERATING PLAN
EXHIBIT A - ROAD MAP
EXHIBIT B - EXISTING WELL MAP
EXHIBIT C - LOCATION AND ACREAGE DEDICATION PLAN
EXHIBIT C-1 TOPO MAP
EXHIBIT D - DRILLING AND RIG LAYOUT
EXHIBIT E - BOP EQUIPMENT

RECEIVED

APR 15 1996

OIL CON. DIV.
DIST. 2

IN ABOVE SPACE DESCRIBE PROPOSED PROGRAM: If proposal is to deepen, give data on present productive zone and proposed new productive zone. If proposal is to drill or deepen directionally, give pertinent data on subsurface locations and measured and true vertical depths. Give blowout preventer program, if any.

24. SIGNED K. Glenn Carter TITLE Sr. Drlg. and Prod. Engr. DATE 2/14/96

(This space for Federal or State office use)

PERMIT NO. _____ APPROVAL DATE _____
Application approval does not warrant or certify that the applicant holds legal or equitable title to those rights in the subject lease which would entitle the applicant to conduct operations thereon.
CONDITIONS OF APPROVAL, IF ANY:

APPROVAL SUBJECT TO
GENERAL REQUIREMENTS AND
SPECIAL STIPULATIONS
ATTACHED

APPROVED BY W. William C. Callins TITLE STATE Director DATE 4-1-96

*See Instructions On Reverse Side

DISTRICT I
P.O. Box 1980, Hobbs, NM 88241-1980

State of New Mexico
Energy, Minerals and Natural Resources Department

Form C-102
Revised February 10, 1994
Submit to Appropriate District Office
State Lease - 4 Copies
Fee Lease - 3 Copies

DISTRICT II
P.O. Drawer DD, Artesia, NM 86211-0719

DISTRICT III
1000 Rio Brazos Rd., Aztec, NM 87410

OIL CONSERVATION DIVISION

P.O. Box 2088
Santa Fe, New Mexico 87504-2088

DISTRICT IV
P.O. BOX 2088, SANTA FE, N.M. 87504-2088

☐ AMENDED REPORT

WELL LOCATION AND ACREAGE DEDICATION PLAT

API Number 30-015-28936	Pool Code 96191	Pool Name Undesignated MESA VERDE 335 Wildcat (Delaware/Bone Springs)
Property Code	Property Name LOTOS "12-G" FEDERAL	Well Number 1
OGRID No. 109487	Operator Name SONAT EXPLORATION COMPANY	Elevation 3543

Surface Location

UL or lot No.	Section	Township	Range	Lot Idn	Feet from the	North/South line	Feet from the	East/West line	County
A	12	24 S	31 E		660	NORTH	330	EAST	EDDY

Bottom Hole Location If Different From Surface

UL or lot No.	Section	Township	Range	Lot Idn	Feet from the	North/South line	Feet from the	East/West line	County
Dedicated Acres 40	Joint or Infill	Consolidation Code	Order No.						

NO ALLOWABLE WILL BE ASSIGNED TO THIS COMPLETION UNTIL ALL INTERESTS HAVE BEEN CONSOLIDATED
OR A NON-STANDARD UNIT HAS BEEN APPROVED BY THE DIVISION

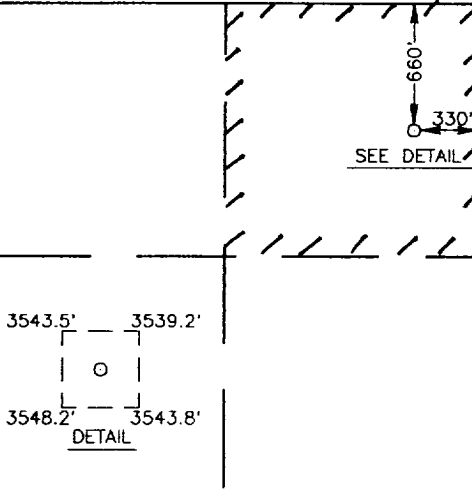
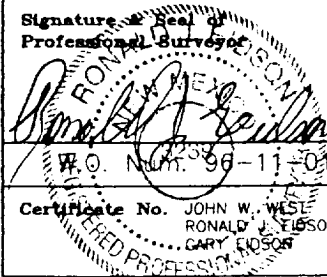
	OPERATOR CERTIFICATION I hereby certify the the information contained herein is true and complete to the best of my knowledge and belief. <u>K. Glenn Carter</u> Signature K. Glenn Carter Printed Name Sr. Drlg. & Prod. Engr. Title 2/14/96 Date
	SURVEYOR CERTIFICATION I hereby certify that the well location shown on this plat was plotted from field notes of actual surveys made by me or under my supervision, and that the same is true and correct to the best of my belief. FEBRUARY 10, 1996 Date Surveyed Signature & Seal of Professional Surveyor  2-12-96 Certificate No. JOHN W. WEST 676 RONALD J. EASON 3239 GARY EASON 12641
Exhibit "C"	

DRILLING CONTROL **CONDITION III-B 3000 PSI WP**

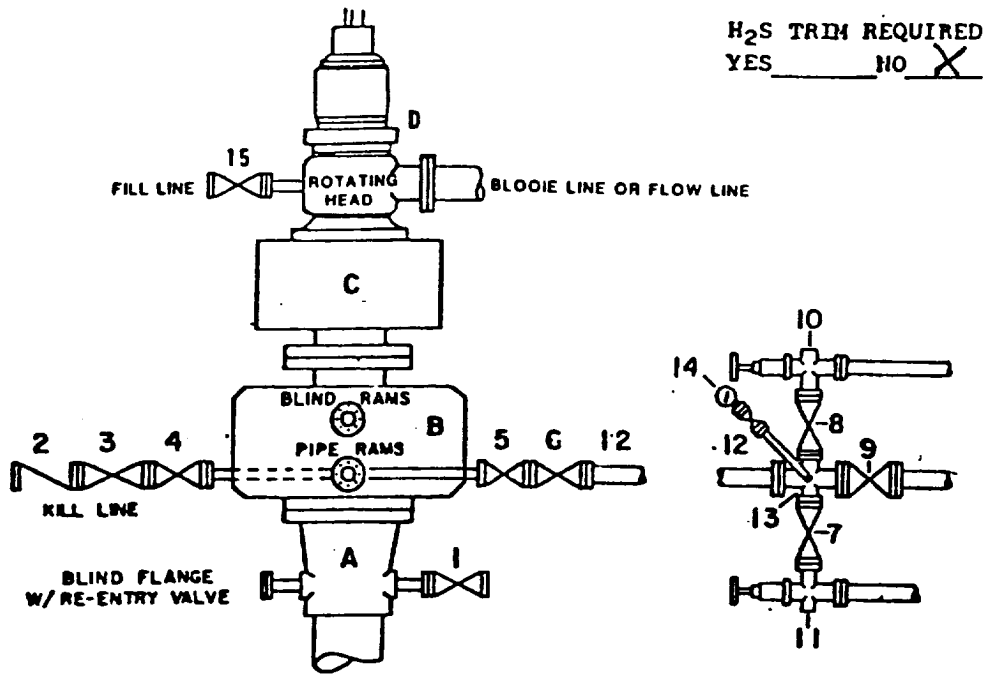

H₂S TRIM REQUIRED
 YES _____ NO X

DRILLING CONTROL

MATERIAL LIST - CONDITION III - B

- | | |
|------------|--|
| A | Wellhead |
| B | 3000# W.P. Dual ram type preventer, hydraulic operated with 1" steel, 3000# W.P. control lines (where substructure height is adequate, 2 - 3000# W.P. single ram preventers may be utilized with 3000# W.P. drilling spool with 2" minimum flanged outlet for kill line and 3" minimum flanged outlet for choke line. The drilling spool is to be installed below the single ram type preventers). |
| C | 3000# W.P. Annular Preventer with 1" steel, 3000# W.P. control lines. |
| D | Rotating Head with fill up outlet and extended Bloopie line. |
| 1,3,4,7,8, | 2" minimum 3000# W.P. flanged full opening steel gate valve, or Halliburton Lo Torc Plug valve. |
| 2 | 2" minimum 3000# W.P. back pressure valve. |
| 5,6,9 | 3" minimum 3000# W.P. flanged full opening steel gate valve, or Halliburton Lo Torc Plug valve. |
| 12 | 3" minimum Schedule 80, Grade B, seamless line pipe. |
| 13 | 2" minimum x 3" minimum 3000# W.P. flanged cross. |
| 10,11 | 2" minimum 3000# W.P. adjustable choke bodies. |
| 14 | Cameron Mud Gauge or equivalent (location optional in Choke line). |
| 15 | 2" minimum 3000# W.P. flanged or threaded full opening steel gate valve, or Halliburton Lo Torc Plug valve. |

SCALE	DATE	EST NO	DRG NO.
DRAWN BY			
CHECKED BY			
APPROVED BY			

EXHIBIT E