

UNITED STATES
DEPARTMENT OF THE INTERIOR
BUREAU OF LAND MANAGEMENT

APPLICATION FOR PERMIT TO DRILL OR DEEPEN

1a. TYPE OF WORK DRILL <input checked="" type="checkbox"/> DEEPEN <input type="checkbox"/>			5. LEASE DESIGNATION AND SERIAL NO. NM-0516006		
b. TYPE OF WELL OIL WELL <input checked="" type="checkbox"/> GAS WELL <input type="checkbox"/> OTHER <input type="checkbox"/>			6. IF INDIAN, ALLOTTEE OR TRIBE NAME		
2. NAME OF OPERATOR Pogo Producing Company 17891			7. UNIT AGREEMENT NAME 19454		
3. ADDRESS AND TELEPHONE NO. P.O. Box 10340, Midland, Texas 79702			8. FARM OR LEASE NAME, WELL NO. Midwest Federal "2" #5		
4. LOCATION OF WELL (Report location clearly and in accordance with any State requirements.) At surface 990' FNL & 330' FWL of Section 34 At proposed prod. zone Same Unit A Happy Valley Bone Springs, S.E. WILDCAT			9. API WELL NO. 30-015-29136		
14. DISTANCE IN MILES AND DIRECTION FROM NEAREST TOWN OR POST OFFICE* 3.5 miles southwest of Carlsbad, N.M.			10. FIELD AND POOL, OR WILDCAT 96605 Under (Bone Springs)		
15. DISTANCE FROM PROPOSED* LOCATION TO NEAREST PROPERTY OR LEASE LINE, FT. (Also to nearest drlg. unit line, if any) 330'			11. SEC., T., R., M., OR BLK. AND SURVEY OR AREA Sec. 34, T-22S, R-26E		
16. NO. OF ACRES IN LEASE 80			12. COUNTY OR PARISH Eddy Co.		
17. NO. OF ACRES ASSIGNED TO THIS WELL 40			13. STATE N.M.		
18. DISTANCE FROM PROPOSED LOCATION* TO NEAREST WELL, DRILLING, COMPLETED, OR APPLIED FOR, ON THIS LEASE, FT. 1st well 5300'			19. PROPOSED DEPTH 5300'		
20. ROTARY OR CABLE TOOLS Rotary			21. APPROX. DATE WORK WILL START* Upon Approval		
22. ELEVATIONS (Show whether DF, RT, GR, etc.) 3260' Ground Level			23. PROPOSED CASING AND CEMENTING PROGRAM		

SIZE OF HOLE	GRADE SIZE OF CASING	WEIGHT PER FOOT	SETTING DEPTH	QUANTITY OF CEMENT
14-3/4"	10-3/4"	32.75# H-40	350'	250 sx (circ)
9-7/8"	7-5/8"	26# J55, N80	1500'	400 sx (circ)
6-3/4"	4-1/2"	11.6# J55	5300'	1000 sx (circ)

The operator proposes to drill to a depth sufficient to test the Delaware and Bone Springs for oil. Specific programs are outlined in the following attachments:

DRILLING PROGRAM

SURFACE USE AND OPERATING PLAN

EXHIBIT A - ROAD MAP

EXHIBIT B - EXISTING WELL MAP

EXHIBIT C - LOCATION AND ACREAGE DEDICATION PLAT

EXHIBIT C-1 TOPO MAP

EXHIBIT D - DRILLING AND RIG LAYOUT

EXHIBIT E - 3M BOP EQUIPMENT

Use of Specialties and
Special Situations
AttachedNoted ID 1
NL & API
9-13-96

IN ABOVE SPACE DESCRIBE PROPOSED PROGRAM: If proposal is to deepen, give data on present productive zone and proposed new productive zone. If proposal is to drill or deepen directionally, give pertinent data on subsurface locations and measured and true vertical depths. Give blowout preventer program, if any.

24. SIGNED James M. C. Ritz TITLE Agent DATE 7/11/96
(This space for Federal or State office use)

PERMIT NO. _____ APPROVAL DATE _____

Application approval does not warrant or certify that the applicant holds legal or equitable title to those rights in the subject lease which would entitle the applicant to conduct operations thereon.
CONDITIONS OF APPROVAL, IF ANY:

APPROVED BY (OILC. SGD) RICHARD L. MANUS TITLE _____ DATE AUG 20 1996

*See Instructions On Reverse Side

DISTRICT II
P.O. Drawer DD, Artesia, NM 88211-0719

DISTRICT III
1000 Rio Brazos Rd., Aztec, NM 87410

DISTRICT IV
P.O. BOX 2088, SANTA FE, N.M. 87504-2088

OIL CONSERVATION DIVISION

P.O. Box 2088
Santa Fe, New Mexico 87504-2088

☐ AMENDED REPORT

WELL LOCATION AND ACREAGE DEDICATION PLAT

API Number 30-015-29136		Pool Code	Pool Name UNDES (BONE Springs)	
Property Code	Property Name MIDWEST FEDERAL L			Well Number 5
OGRID No. 017891	Operator Name POGO PRODUCING COMPANY			Elevation 3260

Surface Location

UL or lot No.	Section	Township	Range	Lot Idn	Feet from the	North/South line	Feet from the	East/West line	County
D	34	22 S	26 E		990	NORTH	330	WEST	EDDY

Bottom Hole Location If Different From Surface

UL or lot No.	Section	Township	Range	Lot Idn	Feet from the	North/South line	Feet from the	East/West line	County
Dedicated Acres 40	Joint or Infill	Consolidation Code	Order No.						

NO ALLOWABLE WILL BE ASSIGNED TO THIS COMPLETION UNTIL ALL INTERESTS HAVE BEEN CONSOLIDATED
OR A NON-STANDARD UNIT HAS BEEN APPROVED BY THE DIVISION

THIS SURVEY ONLY HAS BEEN APPROVED BY THE DIVISION		OPERATOR CERTIFICATION
<p style="text-align: center; margin-top: 200px;"><u>Exhibit "C"</u></p>		<p><i>I hereby certify the information contained herein is true and complete to the best of my knowledge and belief.</i></p> <p style="font-family: cursive; font-size: 1.2em;">James M.C. Ritchie, Jr.</p> <hr/> <p>Signature</p> <p style="font-family: cursive; font-size: 1.2em;">JAMES M.C. RITCHIE, JR.</p> <hr/> <p>Printed Name</p> <p style="font-weight: bold; font-size: 1.2em;">AGENT</p> <hr/> <p>Title</p> <p style="font-size: 1.2em;">7/11/96</p> <hr/> <p>Date</p>
		<p style="text-align: center; font-weight: bold;">SURVEYOR CERTIFICATION</p> <p><i>I hereby certify that the well location shown on this plat was plotted from field notes of actual surveys made by me or under my supervision, and that the same is true and correct to the best of my belief.</i></p> <p style="text-align: right; font-size: 1.2em;">JUNE 20, 1996</p>
		<p>Date Surveyed _____ CDG</p> <p>Signatures _____ Professional Surveyor _____</p>
		<div style="text-align: center;"> GARY S. EIDSON NEW MEXICO REGISTERED PROFESSIONAL ENGINEER NO. 12641 </div>
		<p style="text-align: right; font-size: 1.2em;">6-24-96</p>
		<p>Certificate No. JOHN W. WEST 676 RONALD J. EIDSON 3239 GARY S. EIDSON 12641</p>

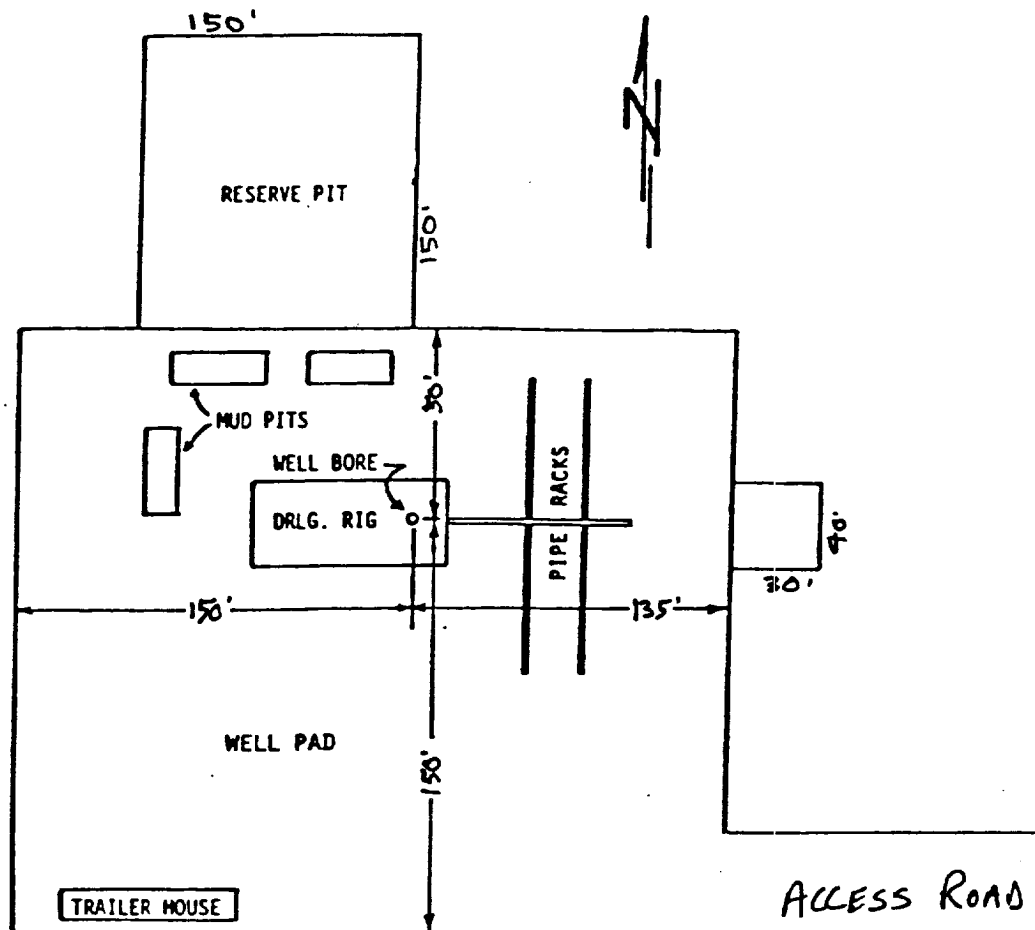
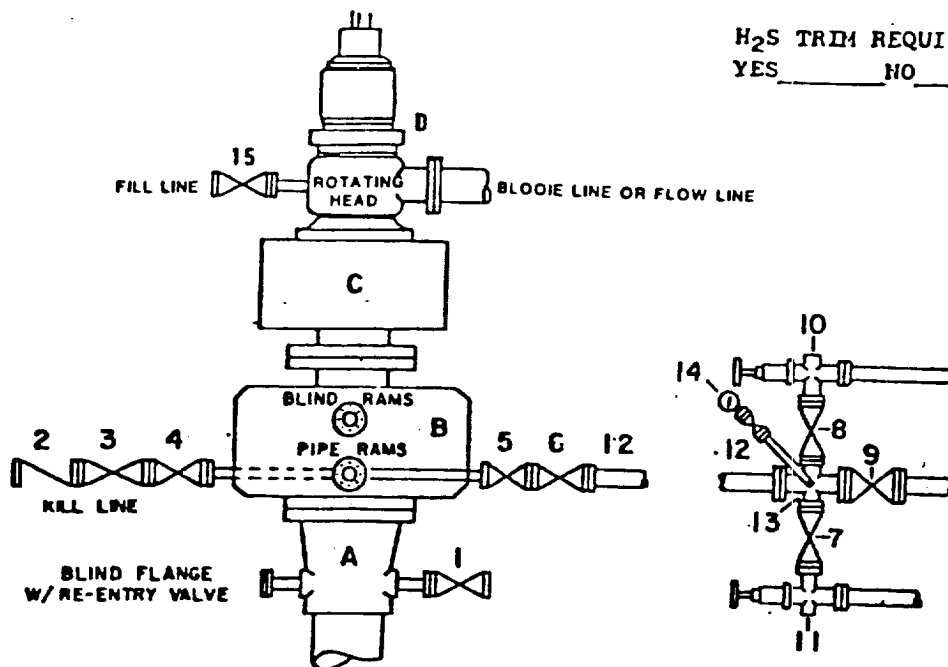

EXHIBIT "D"
Pogo Producing Company
Midwest Federal "L" #5
DRILLING RIG LAYOUT
SCALE: None

DRILLING CONTROL **CONDITION III-B 3000 PSI WP**



H₂S TRIM REQUIRED
 YES _____ NO _____

DRILLING CONTROL

MATERIAL LIST - CONDITION III - B

- | | |
|------------|---|
| A | Wellhead |
| B | 3000# W.P. Dual ram type preventer, hydraulic operated with 1" steel, 3000# W.P. control lines (where sub-structure height is adequate, 2 - 3000# W.P. single ram preventers may be utilized with 3000# W.P. drilling spool with 2" minimum flanged outlet for kill line and 3" minimum flanged outlet for choke line. The drilling spool is to be installed below the single ram type preventers). |
| C | 3000# W.P. Annular Preventer with 1" steel, 3000# W.P. control lines. |
| D | Rotating Head with fill up outlet and extended Blooie line. |
| 1,3,4,7,8, | 2" minimum 3000# W.P. flanged full opening steel gate valve, or Halliburton Lo Torc Plug valve. |
| 2 | 2" minimum 3000# W.P. back pressure valve. |
| 5,6,9 | 3" minimum 3000# W.P. flanged full opening steel gate valve, or Halliburton Lo Torc Plug valve. |
| 12 | 3" minimum Schedule 80, Grade B, seamless line pipe. |
| 13 | 2" minimum x 3" minimum 3000# W.P. flanged cross. |
| 10,11 | 2" minimum 3000# W.P. adjustable choke bodies. |
| 14 | Cameron Mud Gauge or equivalent (location optional in Choke line). |
| 15 | 2" minimum 3000# W.P. flanged or threaded full opening steel gate valve, or Halliburton Lo Torc Plug valve. |

SCALE	DATE	EST. NO.	DRG. NO.
DRAWN BY			
CHECKED BY			
APPROVED BY			

EXHIBIT E