

UNITED STATES
DEPARTMENT OF THE INTERIOR
BUREAU OF LAND MANAGEMENT
811 S. 1st ST.
ARTESIA, NM 88210

SUBMIT IN TRIPLICATE*

Form approved.

APPLICATION FOR PERMIT TO DRILL OR DEEPEN

1a. TYPE OF WORK: DRILL ☒ DEEPEN ☐
b. TYPE OF WELL: OIL WELL ☒ GAS WELL ☐ Other ☐
2. NAME OF OPERATOR: DEVON ENERGY OPERATING CORPORATION
3. ADDRESS AND TELEPHONE NO.: 20 N. BROADWAY, SUITE 1500, OKC, OK 73102 (405) 552-4560
4. LOCATION OF WELL (Report location clearly and in accordance with any State requirements):
At surface: 420' FSL & 1350' FWL
At top proposed prod. zone (SAME)
14. DISTANCE IN MILES AND DIRECTION FROM NEAREST TOWN OR POST OFFICE*: 5 miles East & .2 mile South of Loco Hills, N.M.
15. DISTANCE FROM PROPOSED LOCATION TO NEAREST PROPERTY OR LEASE LINE, FT.: 1350'
16. NO. OF ACRES IN LEASE: 1786.15
17. NO. OF ACRES ASSIGNED TO THIS WELL: 40
18. DISTANCE FROM PROPOSED LOCATION* TO NEAREST WELL, DRILLING, COMPLETED, OR APPLIED FOR, ON THIS LEASE, FT.: 400'
19. PROPOSED DEPTH: 2200'
20. ROTARY OR CABLE TOOLS*: Rotary
21. ELEVATIONS (Show whether DF, RT, GR, etc.): 3655
22. APPROX. DATE WORK WILL START*: June 30, 1996

5. LEASE DESIGNATION AND SERIAL NO.: 283429395-B
6. IF INDIAN, ALLOTTEE OR TRIBE NAME: NA
7. UNIT AGREEMENT NAME: NA
8. FARM OR LEASE NAME, WELL NO.: Turner "B" #119
9. API WELL NO.: 30-015-29241
10. FIELD AND POOL, OR WILDCAT: GRAYBURG-JACKSON
11. SEC., T., R., M., OR BLOCK AND SURVEY OR AREA: SECTION 20 - T17 S - R31 E
12. COUNTY OR PARISH: EDDY
13. STATE: NM

23. PROPOSED CASING AND CEMENTING PROGRAM

SIZE OF HOLE	GRADE, SIZE OF CASING	WEIGHT PER FOOT	SETTING DEPTH	QUANTITY OF CEMENT
12 1/4"	8 5/8" J-55	24.0#	2200' 425' (A8)	125 sk Lite cmt + 200 sk Class "C"
7 7/8"	5 1/2" J-55	15.5#	2200'	330 sk Lite cmt + 360 sk Class "H"

We plan to circulate cement to surface on all casing strings. Devon Energy Operating Corporation proposes to drill to 2200' to test the Seven Rivers formation for commercial quantities of oil. If the Seven Rivers is deemed non-commercial, the wellbore will be plugged and abandoned per Federal Regulations. Programs to adhere to onshore oil and gas regulations are outlined in the following exhibits and attachments.

Drilling Program

- Exhibits #1/1-A = Blowout Prevention Equipment
- Exhibit #2 = Location and Elevation Plat
- Exhibit #3/3-A = Road Map and Topo Map
- Exhibit #4 = Wells Within 1 Mile Radius
- Exhibit #5/5A = Production Facilities Plat
- Exhibit #6 = Rotary Rig Layout
- Exhibit #7 = Casing Design

The undersigned accepts all applicable terms, condition, stipulations and restrictions concerning operations conducted on the leased land or portions thereof, as described below:

Lease No. LC-029395-B
Legal Description: Section 20-T17S-R31E
Bond Coverage: Statewide in CO, NM, UT, & WY
BLM Bond No.: CO1151

Posted 10-1
NL & ACE
10-25-96

IN ABOVE SPACE DESCRIBE PROPOSED PROGRAM: If proposal is to deepen, give data on present productive zone and proposed new productive zone. If proposal is to drill or deepen directionally, give pertinent data on subsurface locations and measured and true vertical depths. Give blowout prevention program, if any.

SIGNED: Randy Jackson
TITLE: DISTRICT ENGINEER
DATE: 6/13/94

*(This space for Federal or State office use)

PERMIT NO. _____ APPROVAL DATE _____

Application approval does not warrant or certify that the applicant holds legal or equitable title to those rights in the subject lease which would entitle the applicant to conduct operations thereon.

CONDITIONS OF APPROVAL, IF ANY:

APPROVED BY: (ORIG. SIGNATURE) TITLE: DATE: OCT 22 1996

See Instructions On Reverse Side

Title 18 U.S.C. Section 1001, makes it a crime for any person knowingly and willfully to make to any department or agency of the United States any false, fictitious or fraudulent statements or representations as to any matter within its jurisdiction

UNITED STATES
DEPARTMENT OF THE INTERIOR
BUREAU OF LAND MANAGEMENT

OIL CONSERVATION DIV
811 S. 1st
ARTESIA, NM 86210-2834

FORM APPROVED
Budget Bureau No. 1004-0135
Expires March 31, 1993

SUNDRY NOTICES AND REPORTS ON WELLS

Do not use this form for proposals to drill or to deepen or reentry to a different reservoir.
Use "APPLICATION FOR PERMIT—" for such proposals

SUBMIT IN TRIPLICATE

1. Type of Well <input checked="" type="checkbox"/> Oil Well <input type="checkbox"/> Gas Well <input type="checkbox"/> Other
2. Name of Operator DEVON ENERGY OPERATING CORPORATION
3. Address and Telephone No. 20 NORTH BROADWAY, SUITE 1500, OKLAHOMA CITY, OKLAHOMA 73102 (405)552-4527
4. Location of Well (Footage, Sec., T., R., M., or Survey Description) 64' FNL & 1550' FWL, Sec. 29-17S-31E

5. Lease Designation and Serial No. LC-029395-B
6. If Indian, Allottee or Tribe Name N/A
7. If Unit or CA, Agreement Designation N/A
8. Well Name and No. Turner B #119
9. API Well No. 30-015
10. Field and Pool, or Exploratory Area Grayburg Jackson
11. County or Parish, State Eddy County, NM

CHECK APPROPRIATE BOX(S) TO INDICATE NATURE OF NOTICE, REPORT, OR OTHER DATA

TYPE OF SUBMISSION	TYPE OF ACTION
<input checked="" type="checkbox"/> Notice of Intent	<input type="checkbox"/> Abandonment
<input type="checkbox"/> Subsequent Report	<input type="checkbox"/> Recompletion
<input type="checkbox"/> Final Abandonment Notice	<input type="checkbox"/> Plugging Back
	<input type="checkbox"/> Casing Repair
	<input type="checkbox"/> Altering Casing
	<input checked="" type="checkbox"/> Other <u>Change location of proposed well</u>
	<input type="checkbox"/> Change of Plans
	<input type="checkbox"/> New Construction
	<input type="checkbox"/> Non-Routine Fracturing
	<input type="checkbox"/> Water Shut-Off
	<input type="checkbox"/> Conversion to Injection
	<input type="checkbox"/> Dispose Water

(Note: Report results of multiple completion on Well Completion or Recompletion Report and Log form.)

13. Describe Proposed or Completed Operations (Clearly state all pertinent details, and give pertinent dates, including estimated date of starting any proposed work. If well is directionally drilled, give subsurface locations and measured and true vertical depths for all markers and zones pertinent to this work.)*

Please change the location of the proposed well

from: 420' FSL & 1350' FWL, Sec. 20-17S-31E

to: 64' FNL & 1550' FWL, Sec. 29-17S-31E

Enclosed is a plat with the new location.

14. I hereby certify that the foregoing is true and correct

Signed Karen Byers

KAREN BYERS
Title ENGINEERING TECHNICIAN

Date 09/05/96

(This space for Federal or State office use)

Approved by [Signature]

Title Area Manager

Date OCT 22 1996

Conditions of approval, if any:

DISTRICT I
P. O. Box 1980
Hobbs, NM 88241-1980

State of New Mexico
Ener Minerals, and Natural Resources De ment

Form C-102
Revised 02-10-94

Instructions on back

DISTRICT II
P. O. Drawer DD
Artesia NM 88211-0719

Submit to the Appropriate
District Office
State Lease - 4 copies
Fee Lease - 3 copies

OIL CONSERVATION DIVISION

P. O. Box 2088
Santa Fe, New Mexico 87504-2088

☐ AMENDED REPORT

DISTRICT III
1000 Rio Brazos Rd.
Aztec, NM 87410

DISTRICT IV
P. O. Box 2088
Santa Fe, NM 87507-2088

WELL LOCATION AND ACREAGE DEDICATION PLAT

1 API Number 30-015-29241	2 Pool Code 28509	3 Pool Name Grayburg Jackson
4 Property Code 15966	5 Property Name TURNER B	6 Well Number 119
7 OGRID No. 136025	8 Operator Name DEVON ENERGY OPERATING CORPORATION	9 Elevation 3652'

10 SURFACE LOCATION

UL or lot no. C	Section 29	Township 17 SOUTH	Range 31 EAST, N.M.P.M.	Lot Ida	Feet from the 64'	North/South line NORTH	Feet from the 1550'	East/West line WEST	County EDDY
--------------------	---------------	----------------------	----------------------------	---------	----------------------	---------------------------	------------------------	------------------------	----------------

"BOTTOM HOLE LOCATION IF DIFFERENT FROM SURFACE

UL or lot no.	Section	Township	Range	Lot Ida	Feet from the	North/South line	Feet from the	East/West line	County
---------------	---------	----------	-------	---------	---------------	------------------	---------------	----------------	--------

12 Dedicated Acres 40	13 Joint or Infill	14 Consolidation Code	15 Order No.
--------------------------	--------------------	-----------------------	--------------

NO ALLOWABLE WELL BE ASSIGNED TO THIS COMPLETION UNTIL ALL INTERESTS HAVE BEEN
CONSOLIDATED OR A NON-STANDARD UNIT HAS BEEN APPROVED BY THE DIVISION

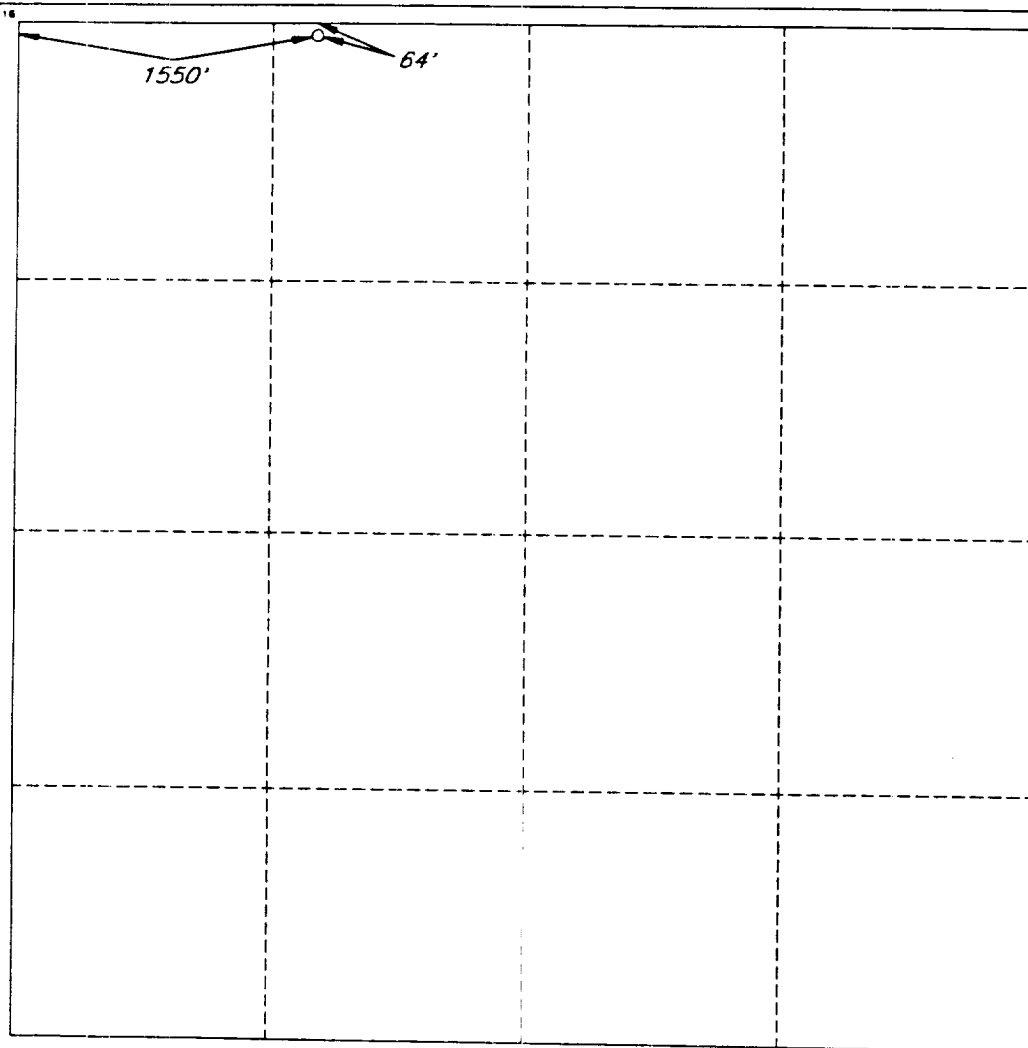

OPERATOR CERTIFICATION

I hereby certify that the information
contained herein is true and complete
to the best of my knowledge and belief.

Signature

Randy Jackson

Printed Name

Randy Jackson

Title

District Engineer

Date

9/5/96

SURVEYOR CERTIFICATION

I hereby certify that the well
location shown on this plat was
plotted from field notes of actual
surveys made by me or under
my supervision, and that the
same is true and correct to the
best of my belief.

Date of Survey

SEPTEMBER 3, 1996

Signature and Seal of
Professional Surveyor

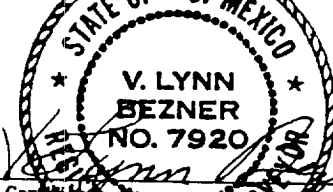

Certified

V. L. BEZNER AND SURVEYORS, #7920

JOB #47125-4-98 SW / VHB

DISTRICT I
P. O. Box 1980
Hobbs, NM 88241-1980

State of New Mexico
Energy, Minerals, and Natural Resources Department

Form C-102
Revised 02-10-94

Instructions on back

DISTRICT II
P. O. Drawer DD
Artesa, NM 88211-0719

OIL CONSERVATION DIVISION
P. O. Box 2088
Santa Fe, New Mexico 87504-2088

Submit to the Appropriate
District Office
State Lease - 4 copies
Fee Lease - 3 copies

☐ AMENDED REPORT

DISTRICT III
1000 Rio Brazos Rd.
Aztec, NM 87410

DISTRICT IV
P. O. Box 2088
Santa Fe, NM 87507-2088

WELL LOCATION AND ACREAGE DEDICATION PLAT

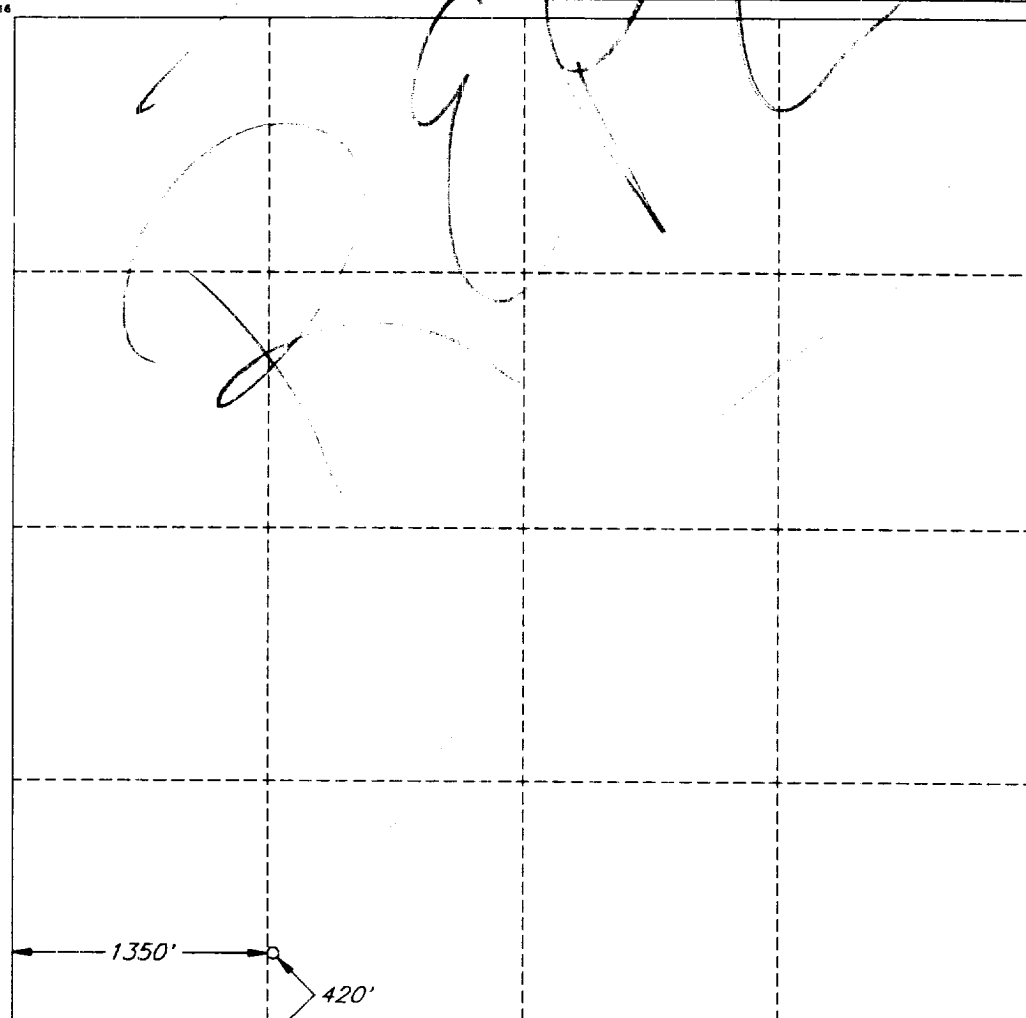
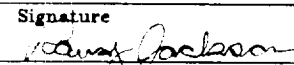
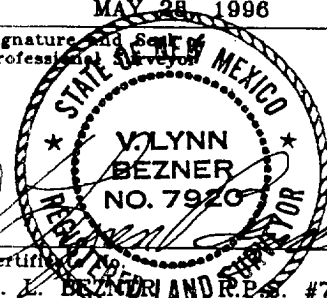
1 API Number		2 Pool Code		3 Pool Name Grayburg Jackson					
4 Property Code 15966		5 Property Name TURNER B						6 Well Number 119	
7 OGRID No. 136025		8 Operator Name DEVON ENERGY OPERATING CORPORATION						9 Elevation 3655'	
10 SURFACE LOCATION									
UL or lot no. N	Section 20	Township 17 SOUTH	Range 31 EAST, N.M.P.M.	Lot Ida	Feet from the	North/South line SOUTH	Feet from the	East/West line WEST	County EDDY
11 BOTTOM HOLE LOCATION IF DIFFERENT FROM SURFACE									
UL or lot no.	Section	Township	Range	Lot Ida	Feet from the	North/South line	Feet from the	East/West line	County
12 Dedicated Acres 40		13 Joint or Infill		14 Consolidation Code		15 Order No.			
NO ALLOWABLE WELL BE ASSIGNED TO THIS COMPLETION UNTIL ALL INTERESTS HAVE BEEN CONSOLIDATED OR A NON-STANDARD UNIT HAS BEEN APPROVED BY THE DIVISION									
						OPERATOR CERTIFICATION I hereby certify that the information contained herein is true and complete to the best of my knowledge and belief.			
						Signature 			
						Printed Name Randy Jackson			
						Title District Engineer			
						Date 6/13/96			
						SURVEYOR CERTIFICATION I hereby certify that the well location shown on this plat was plotted from field notes of actual surveys made by me or under my supervision, and that the same is true and correct to the best of my belief.			
						Date of Survey MAY 28, 1996			
						Signature and Seal of Professional Surveyor 			
						Certified by V. L. BEZNER, L.S. #7920			
JOB #45636-1-98 SW / VHB									

MINIMUM BLOWOUT PREVENTER REQUIREMENTS

3,000 psi Working Pressure

3 MWP

EXHIBIT #1

STACK REQUIREMENTS

No.	Item	Min. I.D.	Min. Nominal
1	Flowline		
2	Fill up line		2"
3	Drilling nipple		
4	Annular preventer		
5	Two single or one dual hydraulically operated rams		
6a	Drilling spool with 2" min. kill line and 3" min choke line outlets		
6b	2" min. kill line and 3" min. choke line outlets in ram. (Alternate to 6a above.)		
7	Valve Gate <input type="checkbox"/> Plug <input type="checkbox"/>	3-1/8"	
8	Gate valve—power operated	3-1/8"	
9	Line to choke manifold		3"
10	Valves Gate <input type="checkbox"/> Plug <input type="checkbox"/>	2-1/16"	
11	Check valve	2-1/16"	
12	Casing head		
13	Valve Gate <input type="checkbox"/> Plug <input type="checkbox"/>	1-13/16"	
14	Pressure gauge with needle valve		
15	Kill line to rig mud pump manifold		2"

OPTIONAL

16	Flanged valve	1-13/16"	
----	---------------	----------	--

CONFIGURATION A

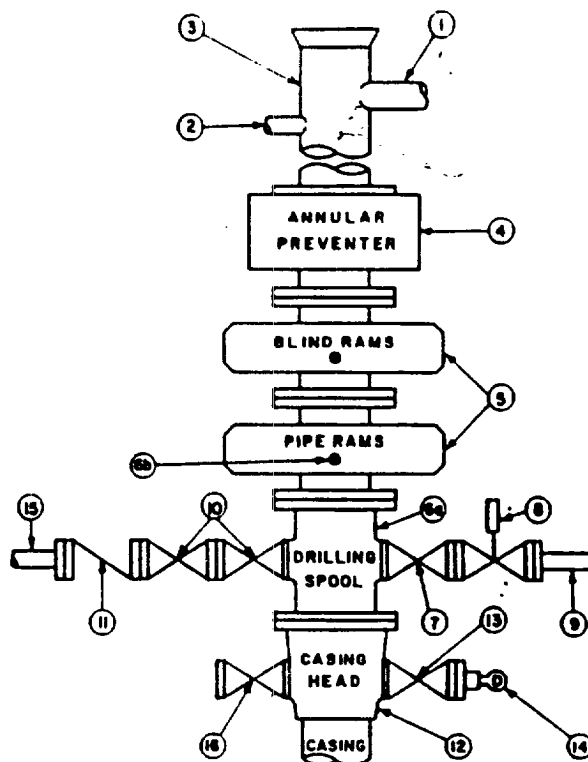

CONTRACTOR'S OPTION TO FURNISH:

1. All equipment and connections above bradenhead or casinghead. Working pressure of preventers to be 3,000 psi, minimum.
2. Automatic accumulator (80 gallon, minimum) capable of closing BOP in 30 seconds or less and, holding them closed against full rated working pressure.
3. BOP controls, to be located near drillers position.
4. Kelly equipped with Kelly cock.
5. Inside blowout preventer or its equivalent on derrick floor at all times with proper threads to fit pipe being used.
6. Kelly saver-sub equipped with rubber casing protector at all times.
7. Plug type blowout preventer tester.
8. Extra set pipe rams to fit drill pipe in use on location at all times.
9. Type RX ring gaskets in place of Type R.

MEC TO FURNISH:

1. Bradenhead or casinghead and side valves.
2. Wear bushing, if required.

GENERAL NOTES:

1. Deviations from this drawing may be made only with the express permission of MEC's Drilling Manager.
2. All connections, valves, fittings, piping, etc., subject to well or pump pressure must be flanged (suitable clamp connections acceptable) and have minimum working pressure equal to rated working pressure of preventers up through choke. Valves must be full opening and suitable for high pressure mud service.
3. Controls to be of standard design and each marked, showing opening and closing position.
4. Chokes will be positioned so as not to hamper or delay changing of choke beans. Replaceable parts for adjustable choke, other bean sizes, retainers, and choke wrenches to be conveniently located for immediate use.
5. All valves to be equipped with handwheels or handles ready for immediate use.
6. Choke lines must be suitably anchored.

7. Handwheels and extensions to be connected and ready for use.
8. Valves adjacent to drilling spool to be kept open. Use outside valves except for emergency.
9. All seamless steel control piping (3000 psi working pressure) to have flexible joints to avoid stress. Hoses will be permitted.
10. Casinghead connections shall not be used except in case of emergency.
11. Do not use kill line for routine fill-up operations.