

District I
PO Box 1980, Hobbs, NM 88241-1980
District II
811 S. 1st Street Artesia, NM 88210-1404
District III
1000 Rio Brazos Rd, Aztec, NM 87410
District IV
PO Box 2088, Santa Fe, NM 87504-2088

State of New Mexico
Energy, Minerals & Natural Resources Department
OIL CONSERVATION DIVISION
PO Box 2088
Santa Fe, NM 87504-2088

Form C-101
Revised February 10, 1994
Instructions on back
Submit to Appropriate District Office
State Lease - 6 Copies
Fee Lease - 5 Copies

☐ AMENDED REPORT

APPLICATION FOR PERMIT TO DRILL, RE-ENTER, DEEPEN, PLUGBACK, OR ADD A ZONE

Operator Name and Address Mack Energy Corporation P.O. Box 960 Artesia, NM 88211-0960		OGRID Number 013837
Property Code 006104		API Number 30-015-29329
Property Name G J West Coop Unit		Well No. 144

Surface Location

UL or lot no.	Section	Township	Range	Lot Idn	Feet from the	North/South line	Feet from the	East/West line	County
J	21	17S	29E		1650	South	2220	East	Eddy

Proposed Bottom Hole Location If Different From Surface

UL or lot No.	Section	Township	Range	Lot Idn	Feet from the	North/South line	Feet from the	East/West line	County

Proposed Pool 1

Grayburg Jackson; 7RVS-QN-GB-SA (28509)

Proposed Pool 2

Work Type Code	Well Type Code	Cable/Rotary	Lease Type Code	Ground Level Elevation
N	O	R	S	3588
Multiple	Proposed Depth	Formation	Contractor	Spud Date
No	4600'	San Andres	LaRue	1/9/96

Proposed Casing and Cement Program

Hole Size	Casing Size	Casing weight/foot	Setting Depth	Sacks of Cement	Estimated TOC
17 1/2	13 3/8	54.5#	125'	Circ	Post ID-1
12 1/4	8 5/8	24#	800'	Circ	1-3-97
7 7/8	5 1/2	17#	4600'	Sufficient to Circ	New Loc & API

Describe the proposed program. If this application is to DEEPEN or PLUG BACK give the data on the present productive zone and proposed new productive zone. Describe the blowout prevention program, if any. Use additional sheets if necessary.

Mack Energy Corporation proposes to drill to 125', run 13 3/8" casing and cement. Drill to 800', run 8 5/8" casing and cement. Drill to 4600' and test San Andres Zone, run 5 1/2" casing and cement. Put well on production.

Note: On Production string, a fluid caliber will be run, will figure cement, with 25% excess, attempt to circulate.

* WOC 18 Hours

I hereby certify that the information given above is true and complete to the best of my knowledge and belief Signature: <i>Crissa D. Carter</i>		OIL CONSERVATION DIVISION	
Printed name: Crissa D. Carter		Approval by: <i>Jim W. Green</i> BGR	
Title: Production Clerk		Title: <i>District Supervisor</i>	
Date: 12/31/96		Approval Date: 1-2-97 Expiration Date: 1-2-98	
Phone: (505)748-1288		Conditions of Approval: Attached <input type="checkbox"/>	

DISTRICT I
P.O. Box 1980, Hobbs, NM 88241-1980

DISTRICT II
P.O. Drawer DD, Artesia, NM 88211-0719

DISTRICT III
1000 Rio Brazos Rd., Aztec, NM 87410

DISTRICT IV
P.O. BOX 2088, SANTA FE, N.M. 87504-2088

State of New Mexico
Energy, Minerals and Natural Resources Department

Form C-102
Revised February 10, 1994
Submit to Appropriate District Office
State Lease - 4 Copies
Fee Lease - 3 Copies

OIL CONSERVATION DIVISION

P.O. Box 2088
Santa Fe, New Mexico 87504-2088

☐ AMENDED REPORT

WELL LOCATION AND ACREAGE DEDICATION PLAT

API Number 30-015-39329	Pool Code 28509	Pool Name Grayburg Jackson; 7RVS-QN-GB-SA
Property Code 006104	Property Name G.J. WEST Coop Unit	Well Number 144
OGRID No. 013837	Operator Name MACK ENERGY CORPORATION	Elevation 3588

Surface Location

UL or lot No. J	Section 21	Township 17 S	Range 29 E	Lot Idn	Feet from the 1650	North/South line SOUTH	Feet from the 2220	East/West line EAST	County EDDY
---------------------------	----------------------	-------------------------	----------------------	---------	------------------------------	----------------------------------	------------------------------	-------------------------------	-----------------------

Bottom Hole Location If Different From Surface

UL or lot No.	Section	Township	Range	Lot Idn	Feet from the	North/South line	Feet from the	East/West line	County
Dedicated Acres 40	Joint or Infill	Consolidation Code		Order No.					

NO ALLOWABLE WILL BE ASSIGNED TO THIS COMPLETION UNTIL ALL INTERESTS HAVE BEEN CONSOLIDATED
OR A NON-STANDARD UNIT HAS BEEN APPROVED BY THE DIVISION

	OPERATOR CERTIFICATION <i>I hereby certify the the information contained herein is true and complete to the best of my knowledge and belief.</i> Signature Crissa D. Carter Printed Name Production Clerk Title 12/31/96 Date
	SURVEYOR CERTIFICATION <i>I hereby certify that the well location shown on this plat was plotted from field notes of actual surveys made by me or under my supervision, and that the same is true and correct to the best of my belief.</i> DEC. 10, 1996 Date Surveyed Signature & Seal of Professional Surveyor 12-12-96 96-11-1634 Certificate No. JOHN W. WEST 576 RONALD J. EIDSON 3239 GARY EIDSON 12641



CONTOUR INTERVAL:
RED LAKE SE - 10'

RED LAKE SE, N.M.

**JOHN WEST ENGINEERING
HOBBS, NEW MEXICO
(505) 393-3117**

VICINITY MAP

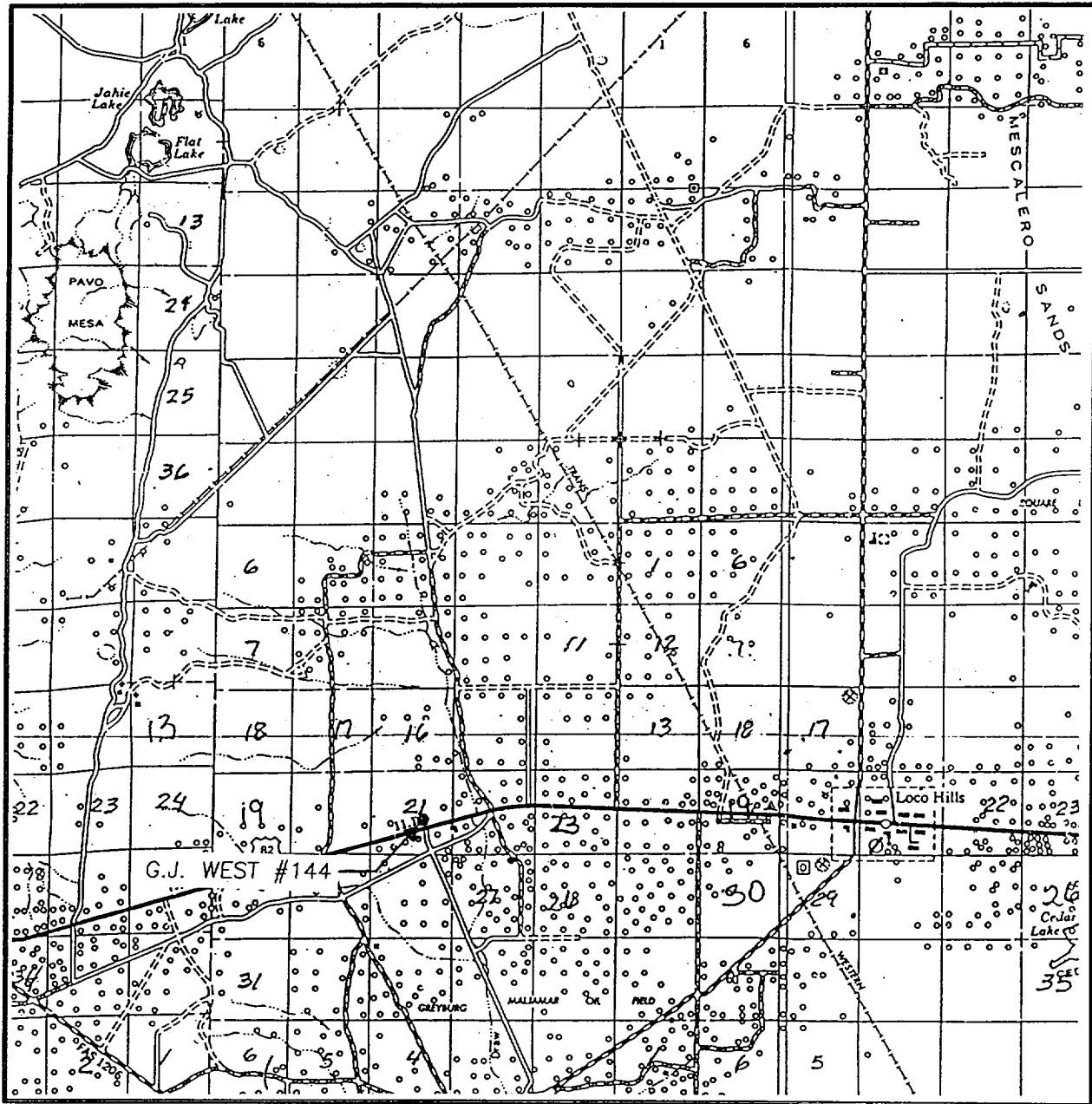

SCALE: 1" = 2 MILES

SEC. 21 TWP. 17-S RGE. 29-E

SURVEY _____ N.M.P.M.

COUNTY _____ EDDY

DESCRIPTION 1650' FSL & 2220' FEL

ELEVATION _____ 3588

OPERATOR MACK ENERGY CORPORATION

LEASE _____ G.J. WEST

**JOHN WEST ENGINEERING
HOBBS, NEW MEXICO**

(505) 393-3117