

OIL CONSERVATION DIV

811 S. 1st ST.

ARTESIA, NM 88210-2834

SUBMIT IN 1 LOCATE

FORM APPROVED  
OMB NO. 1004-0136  
Expires: February 28, 1995

UNITED STATES  
DEPARTMENT OF THE INTERIOR  
BUREAU OF LAND MANAGEMENT

APPLICATION FOR PERMIT TO DRILL OR DEEPEN

1a. TYPE OF WORK

DRILL ☒

DEEPEN ☐

b. TYPE OF WELL

OIL WELL ☒

GAS WELL ☐

OTHER

2. NAME OF OPERATOR

Enron Oil & Gas Company

7377

3. ADDRESS AND TELEPHONE NO.

P. O. Box 2267, Midland, Texas 79702

(915) 686-3714

4. LOCATION OF WELL (Report location clearly and in accordance with any State requirements.)  
At surface

2030' FSL & 2030' FWL

At proposed prod. zone  
Same

Unit K

96336

14. DISTANCE IN MILES AND DIRECTION FROM NEAREST TOWN OR POST OFFICE

48 miles west of Jal New Mexico

13. DISTANCE FROM PROPOSED

LOCATION TO NEAREST  
PROPERTY OR LEASE LINE, FT. 610  
(Also to nearest drlg. unit line, if any) 610

13. DISTANCE FROM PROPOSED LOCATION  
TO NEAREST WELL, DRILLING, COMPLETION  
OR APPLIED FOR, ON THIS LEASE, FT. 2147'

16. NO. OF ACRES IN LEASE

323.67

19. PROPOSED DEPTH

11,300

17. NO. OF ACRES ASSIGNED  
TO THIS WELL

40

20. ROTARY OR CABLE TOOLS

Rotary

21. ELEVATIONS (Show whether DF, RT, GR, etc.)

3308' GR

R-111-P Potash

22. APPROX. DATE WORK WILL START

July 31, 1996

23. PROPOSED CASING AND CEMENTING PROGRAM

SIZE OF HOLE	GRADE SIZE OF CASING	WEIGHT PER FOOT	SETTING DEPTH	QUANTITY OF CEMENT
14-3/4	11-3/4 ST&C	42#	600	290 sacks CIRCULATED
11	8-5/8 ST&C	32#	3800	1400 Prem Plus, 175 ex Cl C CIRC
7-7/8	5-1/2 LT&C	17#	11300	1500 sacks Cl H. TOC est @ 3500'

The Undersigned accepts all applicable terms, conditions, stipulations, and restrictions concerning operations conducted on leased land or portions thereof as shown below:

NM 04473

Sec 6, T23S, R31E

Wolfcamp, Bone Spring, Delaware Formations

Federal Bond # is MT 0748 with  
endorsement to New Mexico

Approved Subject to  
General Requirements and  
Special Stipulations  
Attached

IN ABOVE SPACE DESCRIBE PROPOSED PROGRAM: If proposal is to deepen, give data on present productive zone and proposed new productive zone. If proposal is to drill or deepen directionally, give pertinent data on subsurface locations and measured and true vertical depths. Give blowout preventer program, if any.

24.

SIGNATURE Betty Gildon Betty Gildon

TITLE Regulatory Analyst

DATE 7/12/96

(This space for Federal or State office use)

PERMIT NO.

APPROVAL DATE

Application approval does not warrant or certify that the applicant holds legal or equitable title to those rights in the subject lease which would entitle the applicant to conduct operations thereon.

CONDITIONS OF APPROVAL IF ANY:

APPROVED BY [Signature] TITLE Acting State Director DATE 7/12/96

\*See Instructions On Reverse Side

DISTRICT I  
P. O. Box 1980  
Hobbs, NM 88241-1980

DISTRICT II  
P. O. Drawer DD  
Artesia, NM 88211-0719

DISTRICT III  
1000 Rio Brazos Rd.  
Aztec, NM 87410

DISTRICT IV  
P. O. Box 2088  
Santa Fe, NM 87507-2088

State of New Mexico  
Energy, Minerals, and Natural Resources Department

Form C-102  
Revised 02-10-94

Instructions on back

Submit to the Appropriate  
District Office  
State Lease - 4 copies  
Fee Lease - 3 copies

OIL CONSERVATION DIVISION

P. O. Box 2088  
Santa Fe, New Mexico 87504-2088

☐ AMENDED REPORT

WELL LOCATION AND ACREAGE DEDICATION PLAT

1 API Number		2 Pool Code 50470 40295 & 96336		3 Pool Name Quahada Ridge (Delaware), Los Medanos (Bone Spring) & South Los Medanos (Wolfcamp)					
4 Property Code		5 Property Name JAMES RANCH UNIT						6 Well Number 75	
7 OGRID No. 7377		8 Operator Name ENRON OIL & GAS COMPANY						9 Elevation 3308'	
10 SURFACE LOCATION									
UL or lot no. K	Section 6	Township 23 SOUTH	Range 31 EAST, N.M.P.M.	Lot Ida	Feet from the 2030'	North/South line SOUTH	Feet from the 2030'	East/West line WEST	County EDDY
11 BOTTOM HOLE LOCATION IF DIFFERENT FROM SURFACE									
UL or lot no.	Section	Township	Range	Lot Ida	Feet from the	North/South line	Feet from the	East/West line	County
12 Dedicated Acres 40		13 Joint or Infill		14 Consolidation Code		15 Order No.			
NO ALLOWABLE WELL BE ASSIGNED TO THIS COMPLETION UNTIL ALL INTERESTS HAVE BEEN CONSOLIDATED OR A NON-STANDARD UNIT HAS BEEN APPROVED BY THE DIVISION									

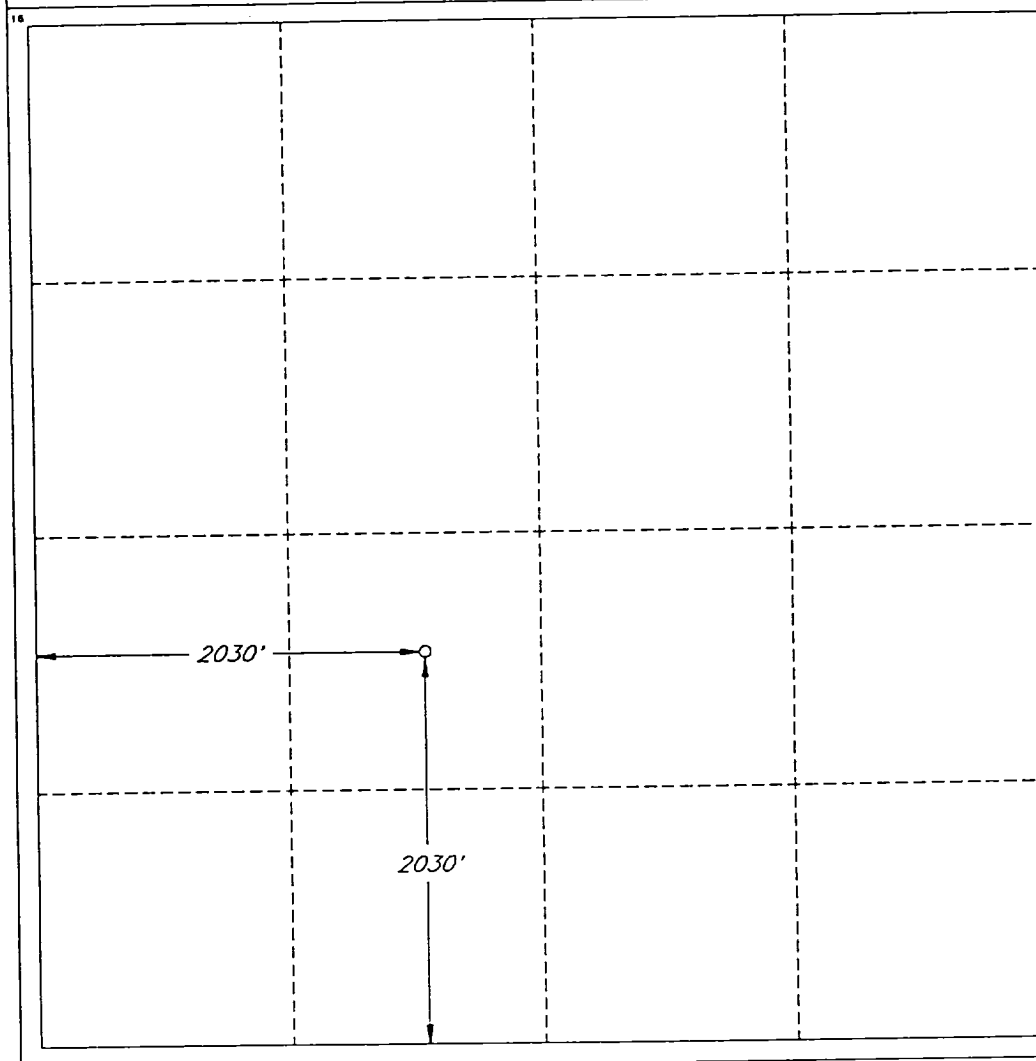

OPERATOR CERTIFICATION

I hereby certify that the information  
contained herein is true and complete  
to the best of my knowledge and belief.

Signature

Printed Name  
Betty Gildon

Title

Regulatory Analyst

Date

7/12/96

SURVEYOR CERTIFICATION

I hereby certify that the well  
location shown on this plat was  
plotted from field notes of actual  
surveys made by me or under  
my supervision, and that the  
same is true and correct to the  
best of my belief.

Date of Survey

JULY 1, 1998

Signature and Seal of  
Professional Surveyor

V. LYNN  
BEZNER  
NO. 7920

Certification No.  
V. L. BEZNER SR. P.S. #7920

JOB #46200-2 / 48 SE / V.H.B.

ENRON OIL & GAS COMPANY

James Ranch Unit #75

ATTACHMENT

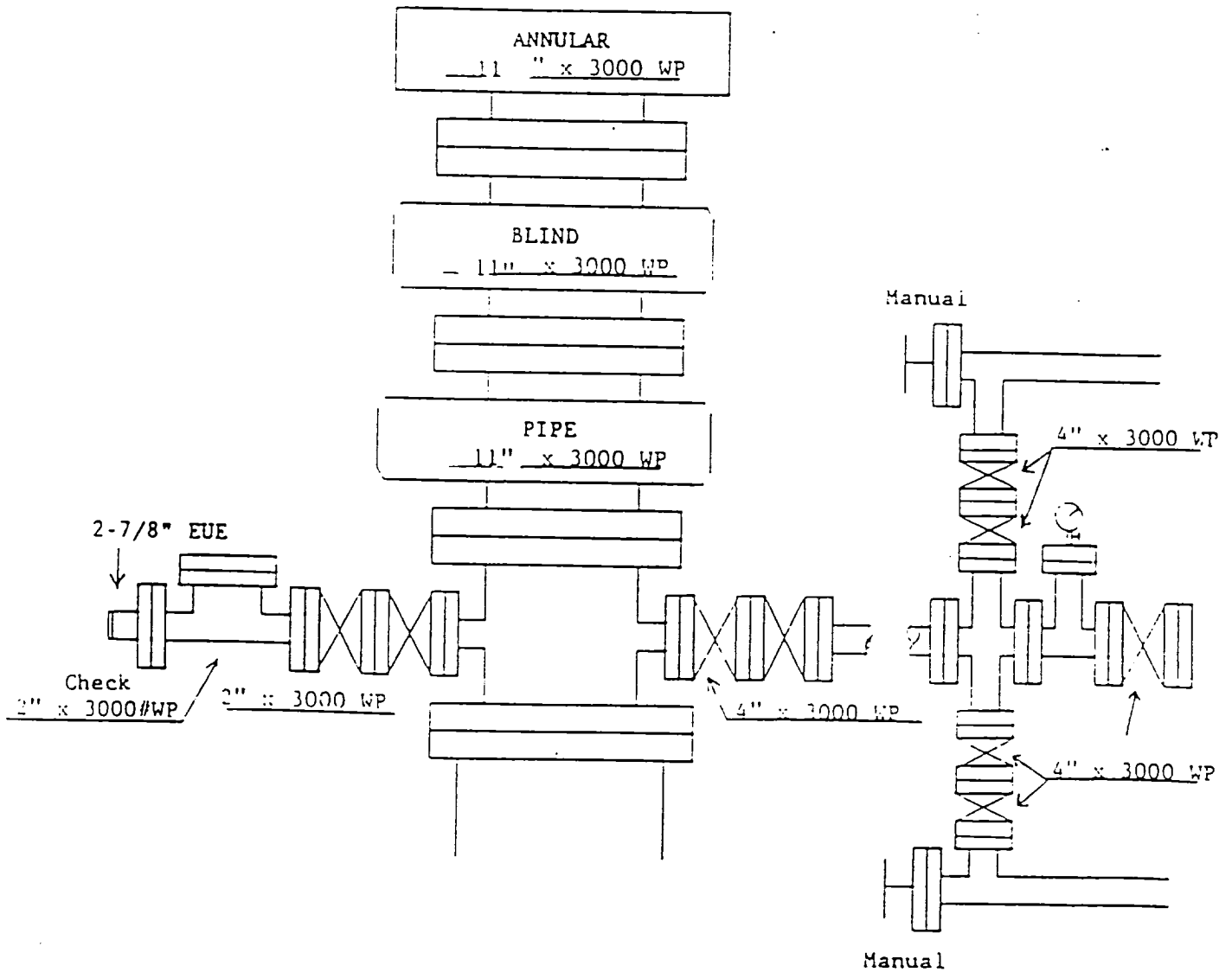

EXHIBIT #1