

UNITED STATES
DEPARTMENT OF THE INTERIOR
BUREAU OF LAND MANAGEMENT

APPLICATION FOR PERMIT TO DRILL OR DEEPEN

1. TYPE OF WORK

DRILL ☒

DEEPEN ☐

2. TYPE OF WELL

OIL
WELL ☐

GAS
WELL ☒

OTHER ☐

SINGLE
ZONE ☐

MULTIPLE
ZONE ☐

3. NAME OF OPERATOR

Enron Oil & Gas Company

4. ADDRESS AND TELEPHONE NO.

P. O. Box 2267, Midland, Texas 79702

5. LOCATION OF WELL (Report location clearly and in accordance with any State regulations.)

At surface

1650' FNL & 660' FWL

At proposed prod. zone

1650' FNL & 660' FWL

6. DISTANCE IN MILES AND DIRECTION FROM NEAREST TOWN OR POST OFFICE

5 miles SW from Loco Hills

7. DISTANCE FROM PROPOSED LOCATION TO NEAREST PROPERTY OR LEASE LINE, FT.

660

660

8. DISTANCE FROM PROPOSED LOCATION TO NEAREST WELL, DRILLING, COMPLETED, OR APPLIED FOR, ON THIS LEASE, FT.

None

9. NO. OF ACRES IN LEASE

320

10. NO. OF ACRES ASSIGNED TO THIS WELL

320

11. PROPOSED DEPTH

11950

12. ROTARY OR CABLE TOOLS

Rotary

13. ELEVATIONS (Show whether DF, RT, GR, etc.)

3514' GR

14. APPROX. DATE WORK WILL START

July 15, 1997

15. PROPOSED CASING AND CEMENT

ROSWELL CONTROLLED WATER BASIN

SIZE OF HOLE	GRADE, SIZE OF CASING	WEIGHT PER FOOT	SETTING DEPTH	QUANTITY OF CEMENT
14-3/4	11-3/4 42# H-40 A ST&C	42	650	250 sx CIRCULATED
11	8-5/8 J-55 LT&C	32	4200	1100 sx CIRCULATED
7-7/8	5-1/2 S-95 & N-80 LT&C	17	11950	735 sx TOC est at 7500'

The Undersigned accepts all applicable terms, conditions, stipulations, and restrictions concerning operations conducted on leased land or portions thereof as shown below:

NM 025614

Sec 18, T18S, R30E

Eddy County, New Mexico

Federal Bond # is MT 0748 with endorsement to New Mexico

APPROVAL SUBJECT TO
GENERAL REQUIREMENTS AND
SPECIAL STIPULATIONS
ATTACHED

BUREAU OF LAND MGMT
CARLSBAD RESOURCE AREA

RECEIVED
1997 JUN 13 A 10:51

IN ABOVE SPACE DESCRIBE PROPOSED PROGRAM: If proposal is to deepen, give data on present productive zone and proposed new productive zone. If proposal is to drill or deepen directionally, give pertinent data on subsurface locations and measured and true vertical depths. Give blowout preventer program, if any.

24.

Signed Betty Gildon Betty Gildon TITLE Regulatory Analyst

DATE 6/11/97

(This space for Federal or State office use)

PERMIT NO.

APPROVAL DATE

Application approval does not warrant or certify that the applicant holds legal or equitable title to those rights in the subject lease which would entitle the applicant to conduct operations thereon.

CONDITIONS OF APPROVAL, IF ANY:

APPROVED BY (ORIG. SGC) TONY L. PERDUE

TITLE

ADM. MINERALS

DATE

7/14/97

*See Instructions On Reverse Side

DISTRICT I
P. O. Box 1980
Hobbs, NM 88241-1980

State of New Mexico
En , Minerals, and Natural Resources L artment

Form C-102
Revised 02-10-94
Instructions on back

DISTRICT II
P. O. Drawer DD
Artesia, NM 88211-0719

OIL CONSERVATION DIVISION

DISTRICT III
1000 Rio Brazos Rd.
Aztec, NM 87410

P. O. Box 2088
Santa Fe, New Mexico 87504-2088

Submit to the Appropriate
District Office
State Lease - 4 copies
Fee Lease - 3 copies

☐ AMENDED REPORT

DISTRICT IV
P. O. Box 2088
Santa Fe, NM 87507-2088

WELL LOCATION AND ACREAGE DEDICATION PLAT

¹ API Number	² Pool Code 96053 (BS) 96070 (morrow)	³ Pool Name Wildcat Bone Spring, Morrow & Chester
⁴ Property Code	⁵ Property Name SAND TANK '18' FEDERAL COM	⁶ Well Number 1
⁷ OGRID No. 7377	⁸ Operator Name ENRON OIL & GAS COMPANY	⁹ Elevation 3514'

¹⁰ SURFACE LOCATION

UL or lot no. E	Section 18	Township 18 SOUTH	Range 30 EAST, N.M.P.M.	Lot Ida	Feet from the 1650'	North/South line NORTH	Feet from the 660'	East/West line WEST	County EDDY
--------------------	---------------	----------------------	----------------------------	---------	------------------------	---------------------------	-----------------------	------------------------	----------------

"BOTTOM HOLE LOCATION IF DIFFERENT FROM SURFACE

UL or lot no.	Section	Township	Range	Lot Ida	Feet from the	North/South line	Feet from the	East/West line	County
---------------	---------	----------	-------	---------	---------------	------------------	---------------	----------------	--------

¹² Dedicated Acres 320 w/2	¹³ Joint or Infill	¹⁴ Consolidation Code	¹⁵ Order No.
--	-------------------------------	----------------------------------	-------------------------

NO ALLOWABLE WELL BE ASSIGNED TO THIS COMPLETION UNTIL ALL INTERESTS HAVE BEEN
CONSOLIDATED OR A NON-STANDARD UNIT HAS BEEN APPROVED BY THE DIVISION

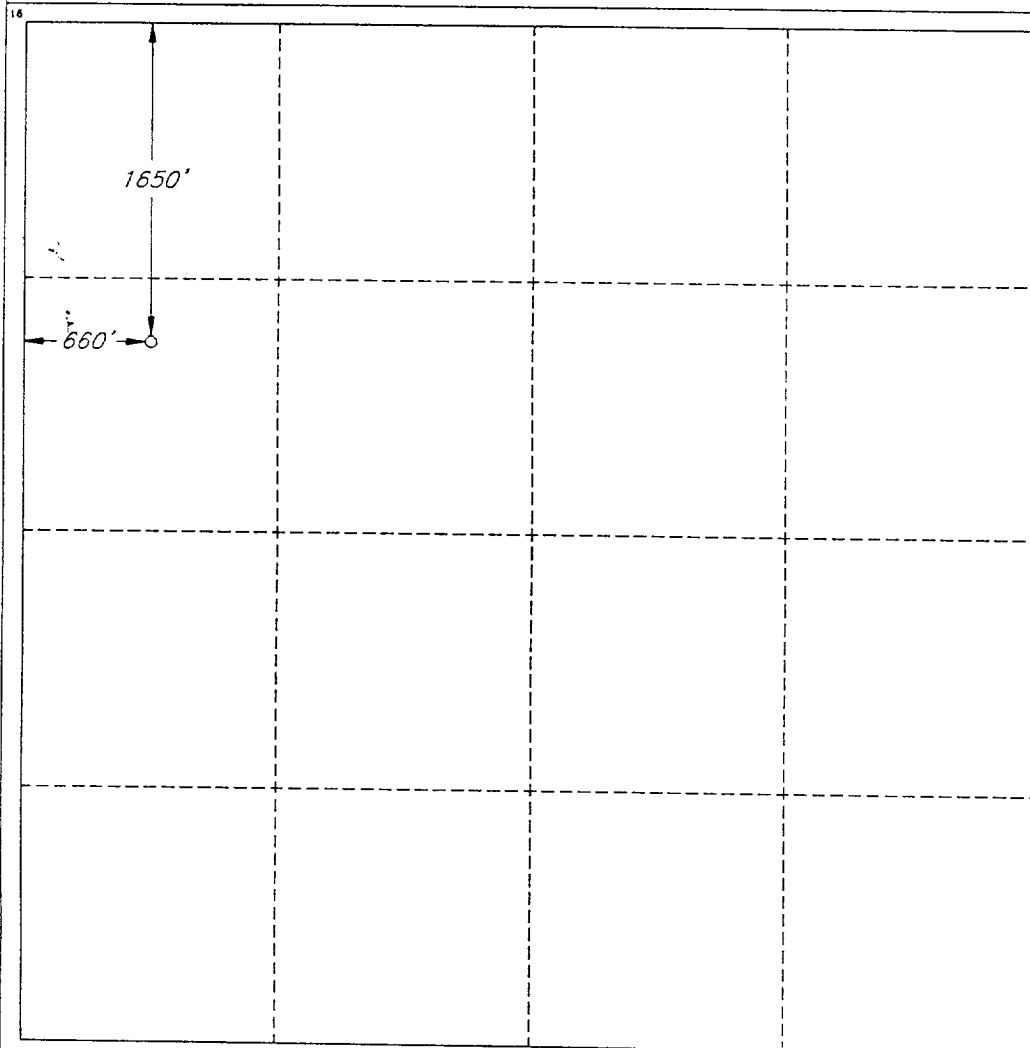

OPERATOR CERTIFICATION

I hereby certify that the information
contained herein is true and complete
to the best of my knowledge and belief.

Signature
Betty Gildon

Printed Name
Betty Gildon

Title
Regulatory Analyst

Date
6/11/97

SURVEYOR CERTIFICATION

I hereby certify that the well
location shown on this plat was
plotted from field notes of actual
surveys made by me or under
my supervision, and that the
same is true and correct to the
best of my belief.

Date of Survey
APRIL 21 1997

Signature and Seal of
Professional Surveyor

V. LYNN
BEZNER
NO. 7920

Certificate No.
V. L. BEZNER R.P.S. #7920

JOB #51309 / 99 SE / V.H.B.

ENRON OIL & GAS COMPANY

Sand Tank 18 Federal Com. #1

ATTACHMENT I

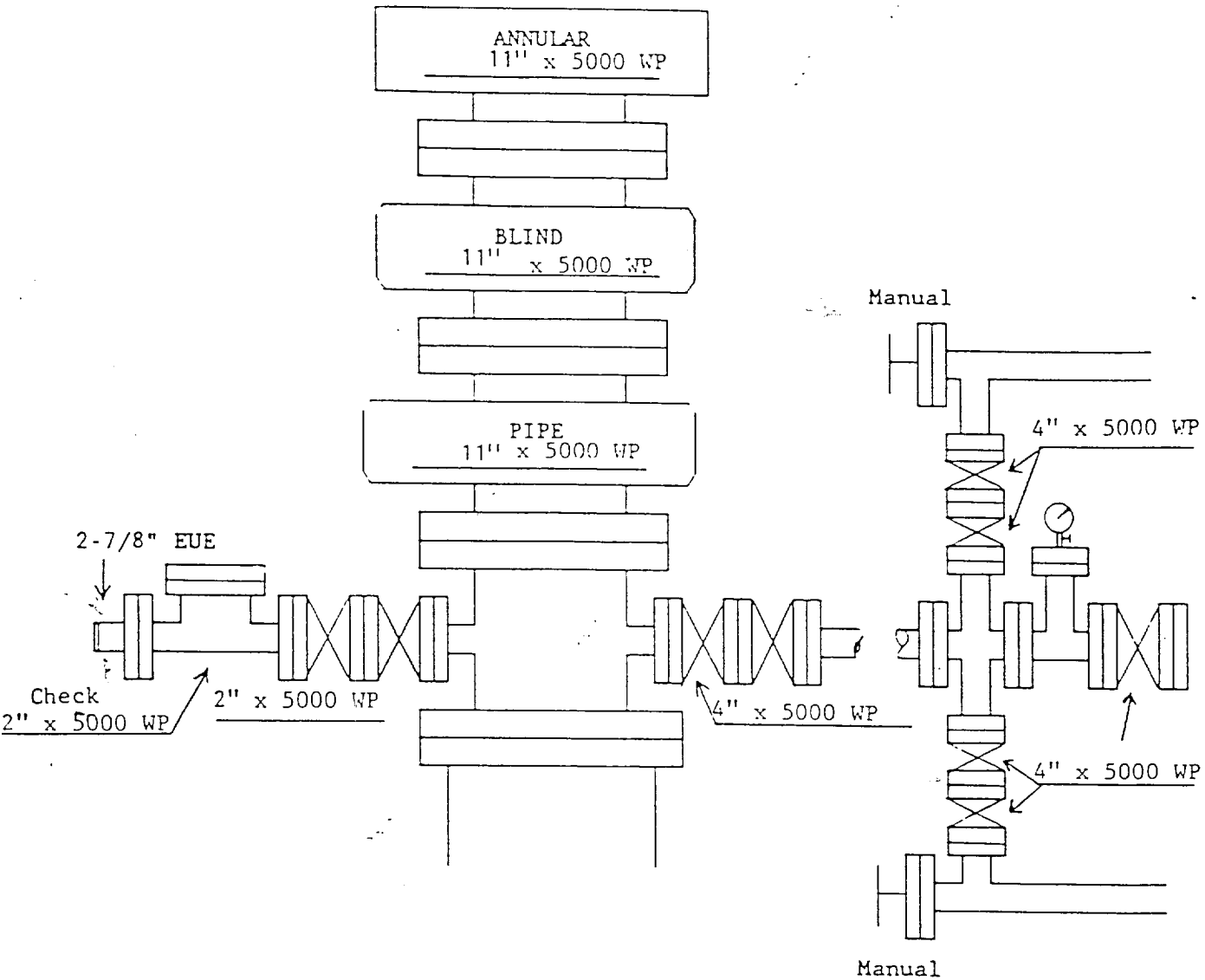

EXHIBIT #1