

DISTRICT II
P. O. Drawer DD
Artesia, NM 88211-0719

OIL CONSERVATION DIVISION
P. O. Box 2088
Santa Fe, New Mexico 87504-2088

Submit to the Appropriate
District Office
State Lease - 4 copies
Fee Lease - 3 copies

☐ AMENDED REPORT

DISTRICT III
1000 Rio Brazos Rd.
Aztec, NM 87410

DISTRICT IV
P. O. Box 2088
Santa Fe, NM 87507-2088

WELL LOCATION AND ACREAGE DEDICATION PLAT

1 API Number		2 Pool Code 84330		3 Pool Name ROSS DRAW WOLFCAMP GAS					
4 Property Code		5 Property Name BR "13" FEDERAL						6 Well Number 1	
7 OGRID No. 26485		8 Operator Name BURLINGTON RESOURCES OIL & GAS COMPANY						9 Elevation 3196'	
10 SURFACE LOCATION									
UL or lot no. E	Section 13	Township 26 SOUTH	Range 30 EAST, N.M.P.M.	Lot Ida	Feet from the 1834'	North/South line NORTH	Feet from the 665'	East/West line WEST	County EDDY.
11 BOTTOM HOLE LOCATION IF DIFFERENT FROM SURFACE									
UL or lot no. K	Section 13	Township 26 SOUTH	Range 30 EAST, N.M.P.M.	Lot Ida	Feet from the 1677	North/South line SOUTH	Feet from the 1979	East/West line WEST	County EDDY
12 Dedicated Acres 320		13 Joint or Infill		14 Consolidation Code		15 Order No.			
NO ALLOWABLE WELL BE ASSIGNED TO THIS COMPLETION UNTIL ALL INTERESTS HAVE BEEN CONSOLIDATED OR A NON-STANDARD UNIT HAS BEEN APPROVED BY THE DIVISION									

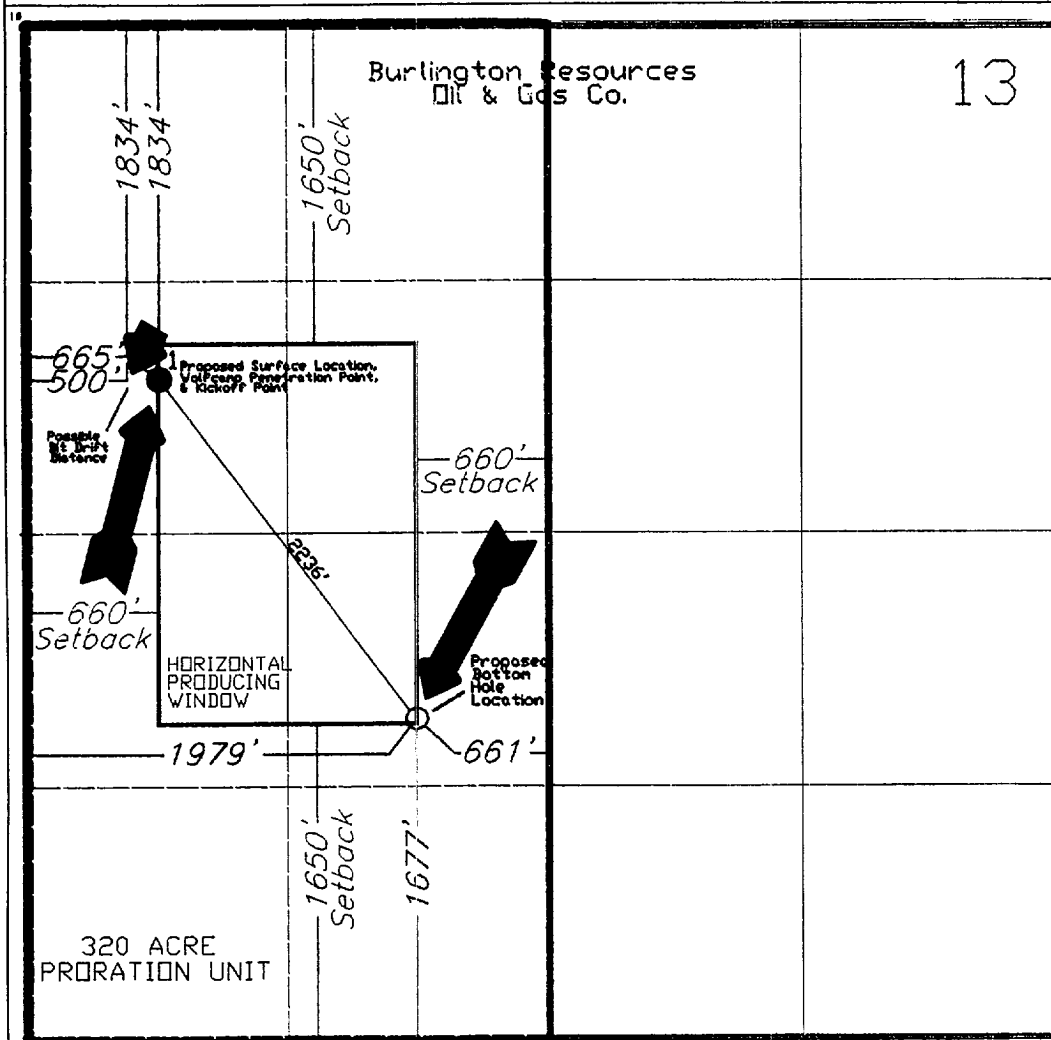

OPERATOR CERTIFICATION

I hereby certify that the information contained herein is true and complete to the best of my knowledge and belief.

Signature

Maria L. Perez

Printed Name

Maria L. Perez

Title

Regulatory Representative

Date

10-5-98

SURVEYOR CERTIFICATION

I hereby certify that the well location shown on this plat was plotted from field notes of actual surveys made by me or under my supervision, and that the same is true and correct to the best of my belief.

Date of Survey

10-5-98

Signature

Roger M. Robbins

Professional Surveyor

REGISTERED PROFESSIONAL SURVEYOR

12128

Certificate No.

ROGER M. ROBBINS P.S. #12128

JOB #60344 / 23 SE / V.H.B.