

DISTRICT I
P. O. Box 1980, Hobbs, NM 88240

DISTRICT II
P. O. Drawer DD, Artesia, NM 88210

DISTRICT III
1000 Rio Brazos Rd., Aztec, NM 87410

DISTRICT IV
P. O. Box 2088, Santa Fe, NM 87504-2088

State of New Mexico
Energy, Minerals and Natural Resources Department

Form C-102
Revised February 10, 1994
Instructions on back

OIL CONSERVATION DIVISION
PO Box 2088
Santa Fe, NM 87504-2088

Submit to Appropriate District Office

State Lease-4 copies
Fee Lease-3 copies

☐ AMENDED REPORT

WELL LOCATION AND ACREAGE DEDICATION PLAT

1 API Number		2 Pool Code		3 Pool Name Fren, Morrow					
4 Property Code		5 Property Name Texmack "36" State Com				6 Well Number 2			
7 OGRID No. 22351		8 Operator Name TEXACO EXPLORATION & PRODUCTION, INC.				9 Elevation 4064'			
10 Surface Location									
UL or lot no. N	Section 36	Township 16-S	Range 31-E	Lot Idn	Feet from the 710'	North/South line South	Feet from the 1650'	East/West line West	County Eddy
11 Bottom Hole Location if Different From Surface									
UL or lot no.	Section	Township	Range	Lot Idn	Feet from the	North/South line	Feet from the	East/West line	County
12 Dedicated Acres 320		13 Joint or Infill		14 Consolidation Code		15 Order No.			

NO ALLOWABLE WILL BE ASSIGNED TO THIS COMPLETION UNTIL ALL INTERESTS HAVE BEEN CONSOLIDATED
OR A NON-STANDARD UNIT HAS BEEN APPROVED BY THE DIVISION.

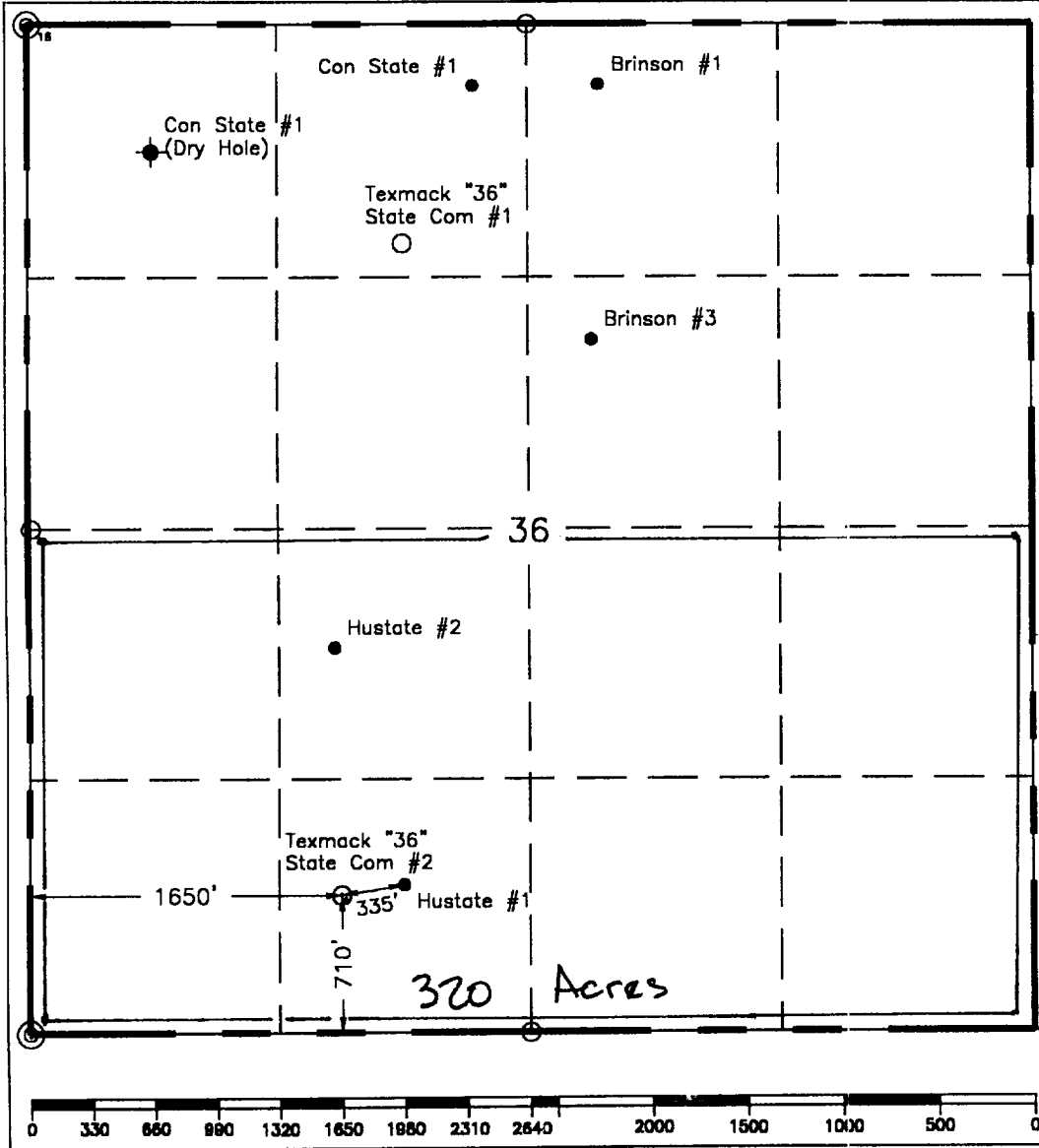

16 OPERATOR CERTIFICATION	
I hereby certify that the information contained herein is true and complete to the best of my knowledge and belief.	
Signature <i>A. Phil Ryan</i>	
Printed Name A. Phil Ryan	
Position Commission Coordinator	
Company Texaco Expl. & Prod. Inc.	
Date August 30, 1999	
17 SURVEYOR CERTIFICATION	
I hereby certify that the well location shown on this plat was plotted from field notes of actual surveys made by me or under my supervision, and that the same is true and correct to the best of my knowledge and belief.	
Date Surveyed August 25, 1999	
Signature & Seal of Professional Surveyor <i>John S. Piper</i>	
Certificate No. 7254 John S. Piper	
Sheet 1 of 1	

○ = Staked Location ● = Producing Well ● = Injection Well ◇ = Water Supply Well ★ = Plugged & Abandon Well
⊙ = Found Section Corner, 2 or 3" Iron Pipe & GLO B.C. ○ = Found 1/4 Section Corner, 1" Iron Pipe & GLO B.C.

ADDITIONAL INFORMATION ON THE LOCATION

State Plane Coordinates			
Northing 681617.77		Easting 696988.64	
Latitude 32°52'21.94"		Longitude 103°49'34.88"	
Zone	North American Datum	Combined Grid Factor	Coordinate File
East	1983	0.9997675	Skelly.cr5
Drawing File		Field Book	
Tex36_ST2		Eddy County 6, Pg. 71	