

Form 3160-3
(August 1999)

N. M. Oil Cons. Division
811 E. 1st St.
ARTESIA, NM 87003

FORM APPROVED
OMB No. 1004-0136
Expires November 30, 2000

UNITED STATES
DEPARTMENT OF THE INTERIOR
BUREAU OF LAND MANAGEMENT

APPLICATION FOR PERMIT TO DRILL OR REENTER

1a. Type of Work: <input checked="" type="checkbox"/> DRILL <input type="checkbox"/> REENTER		7. If Unit or CA Agreement, Name and No.
1b. Type of Well: <input type="checkbox"/> Oil Well <input checked="" type="checkbox"/> Gas Well <input type="checkbox"/> Other <input type="checkbox"/> Single Zone <input type="checkbox"/> Multiple Zone		8. Lease Name and Well No. <u>24415</u> Ross Draw Unit No. 23
2. Name of Operator Enron Oil & Gas Company <u>7377</u>		9. API Well No. <u>30-015-30959</u>
3a. Address P.O. Box 2267, Midland, TX 79702	3b. Phone No. (include area code) (915)686-3714	10. Field and Pool, or Exploratory Ross Draw (Wolfcamp) <u>84330</u>
4. Location of Well (Report location clearly and in accordance with any State requirements.) At surface 1,810' FSL & 660' FEL At proposed prod. Zone 1,810' FSL & 660' FEL (Unit I)		11. Sec., T., R., M., or Blk. And Survey or Area Sec 27, T26S, R30E
14. Distance in miles and direction from nearest town or post office* 15 miles SE from Malaga		12. County or Parish Eddy
15. Distance from proposed* location to nearest property or lease line, ft. 660' (Also to nearest drlg. Unit line, if any) 660'		13. State NM
16. No. of Acres in lease 640	17. Spacing Unit dedicated to this well 320	
18. Distance from proposed location* to nearest well, drilling, completed applied for, on this lease, ft. N/A	19. Proposed Depth 13,000'	20. BLM/BIA Bond No. on file MT-0748 <u>Post 2-11-00</u>
21. Elevations (Show whether DF, KDB, RT, GL, etc) GL-3040 <u>3005</u>	22. Approximate date work will start* 1/10/00	23. Estimated duration 30 days

24. Attachments

The following completed in accordance with the requirements of Onshore Oil and Gas Order No. 1, shall be attached to this form:

CARLSBAD CONTROLLED WATER BASIN

- | | |
|--|--|
| 1. Well plat certified by a registered surveyor. | 4. Bond to cover the operations unless covered by an existing bond on file (see Item 20 above) |
| 2. A Drilling Plan. | 5. Operator certification. |
| 3. A Surface Use Plan (if the location is on National Forest System Lands, the SUPO shall be filed with the appropriate Forest Service Office) | 6. Such other site specific information and/or plans as may be required by the authorized officer. |

25. Signature <u>Mike Francis</u>	Name (Printed/Typed) Mike Francis	Date 12/3/99
Title Agent		
Approved by (Signature) (ORIG. Sgd.) <u>ARMANDO A. LOPEZ</u>	Name (Printed/Typed) <u>ARMANDO A. LOPEZ</u>	Date <u>12/3/99</u>
Title <u>Acting</u> Assistant Field Manager, Lands And Minerals	Office	APPROVED FOR 1 YEAR

Application approval does not warrant or certify the applicant holds legal or equitable title to those rights in the subject lease which would entitle the applicant to conduct operations thereon.

Conditions of approval, if any, are attached

Title 18 U.S.C. Section 1001 and Title 43 U.S.C. Section 1212, make it a crime for any person knowingly and willfully to make to any department or agency of the United States any false, fictitious or fraudulent statements or representations as to any matter within its jurisdiction.

*(Instructions on reverse)

**APPROVAL SUBJECT TO
GENERAL REQUIREMENTS AND
SPECIAL STIPULATIONS
ATTACHED**



☐ AMENDED REPORT

WELL LOCATION AND ACREAGE DEDICATION PLAT

'API Number	'Pool Code	'Pool Name Ross Draw (Wolfcamp)
'Property Code	'Property Name ROSS DRAW UNIT	'Well Number 23
'OGRID No. 7377	'Operator Name ENRON OIL & GAS COMPANY	'Elevation 3005

¹⁰Surface Location

UL or lot no.	Section	Township	Range	Lot Idn	Feet from the	North/South line	Feet from the	East/West line	County
I	27	26-S	30-E		1810	SOUTH	660	EAST	EDDY

¹¹ Bottom Hole Location If Different From Surface

UL or lot no.	Section	Township	Range	Lot Idn	Feet from the	North/South line	Feet from the	East/West line	County
"Dedicated Acres 320	"Joint or Infill	"Consolidation Code		"Order No.					

NO ALLOWABLE WILL BE ASSIGNED TO THIS COMPLETION UNTIL ALL INTERESTS HAVE BEEN CONSOLIDATED
OR A NON-STANDARD UNIT HAS BEEN APPROVED BY THE DIVISION

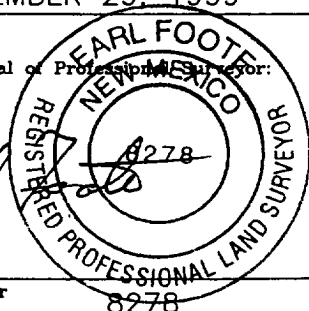
<div>16</div>					<div>17 OPERATOR CERTIFICATION</div> <div>I hereby certify that the information contained herein is true and complete to the best of my knowledge and belief.</div> <div><i>Mike Francis</i></div> <div>Signature</div> <div>Mike Francis</div> <div>Printed Name</div> <div>Agent</div> <div>Title</div> <div>12/3/99</div> <div>Date</div>	
					<div>18 SURVEYOR CERTIFICATION</div> <div>I hereby certify that the well location shown on this plat was plotted from field notes of actual surveys made by me or under my supervision, and that the same is true and correct to best of my belief.</div> <div>NOVEMBER 29, 1999</div> <div>Date of Survey</div> <div>Signature and Seal of Professional Surveyor:</div> <div><i>Earl Footen</i></div> <div></div> <div>Certificate Number</div> <div>8278</div>	

ENRON OIL & GAS COMPANY
ROSS DRAW UNIT NO. 23

LAT. = 32°00'39.286"
LONG. = 103°51'43.756"
Y = 368015.289
X = 646046.401

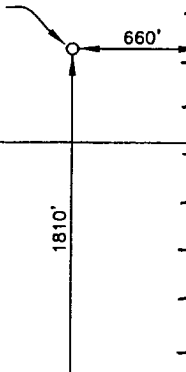

EMRON OIL & GAS COMPANY

Ross Draw Unit NO. 23

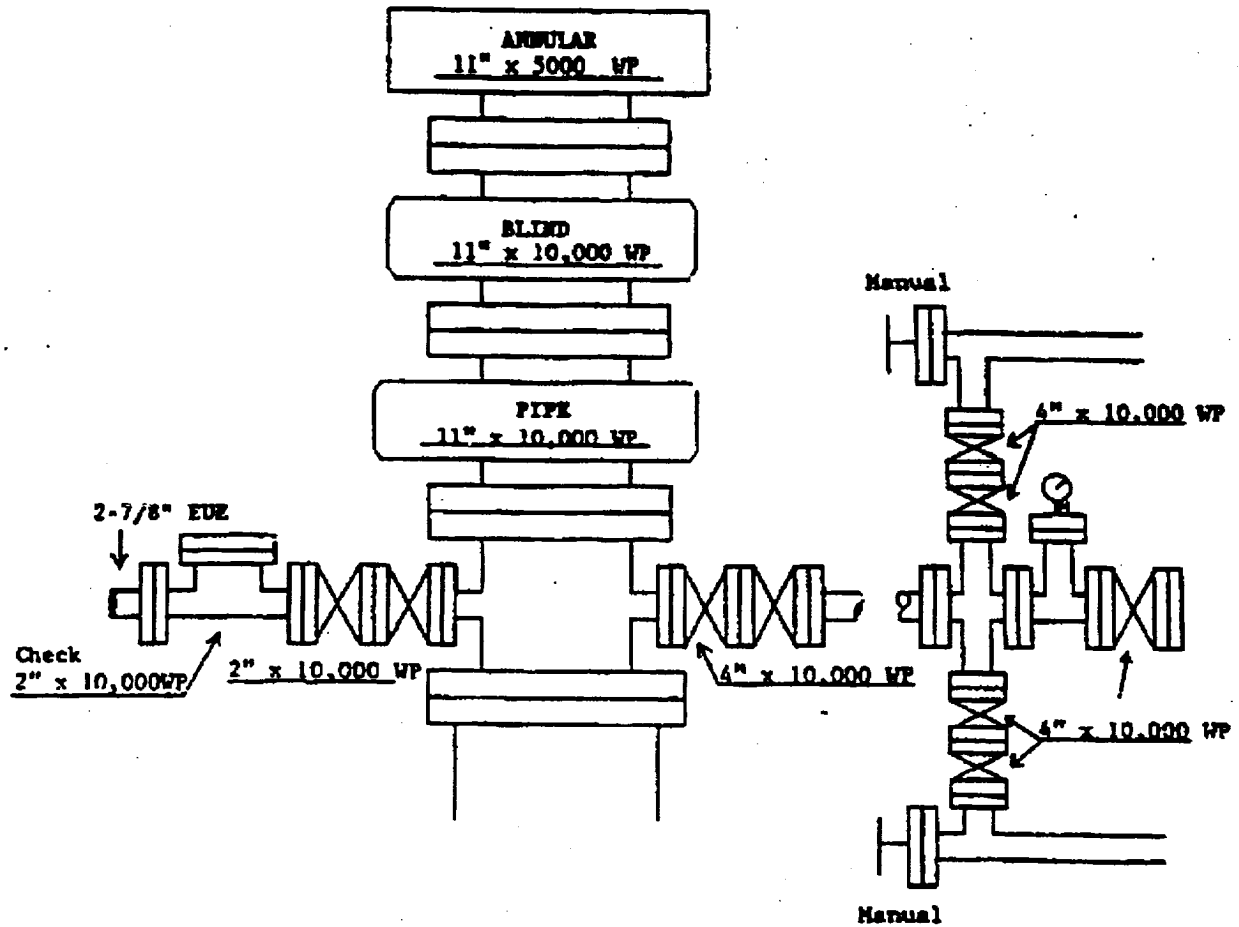

Exhibit #2

ERRON OIL & GAS COMPANY

Ross Draw Unit 23

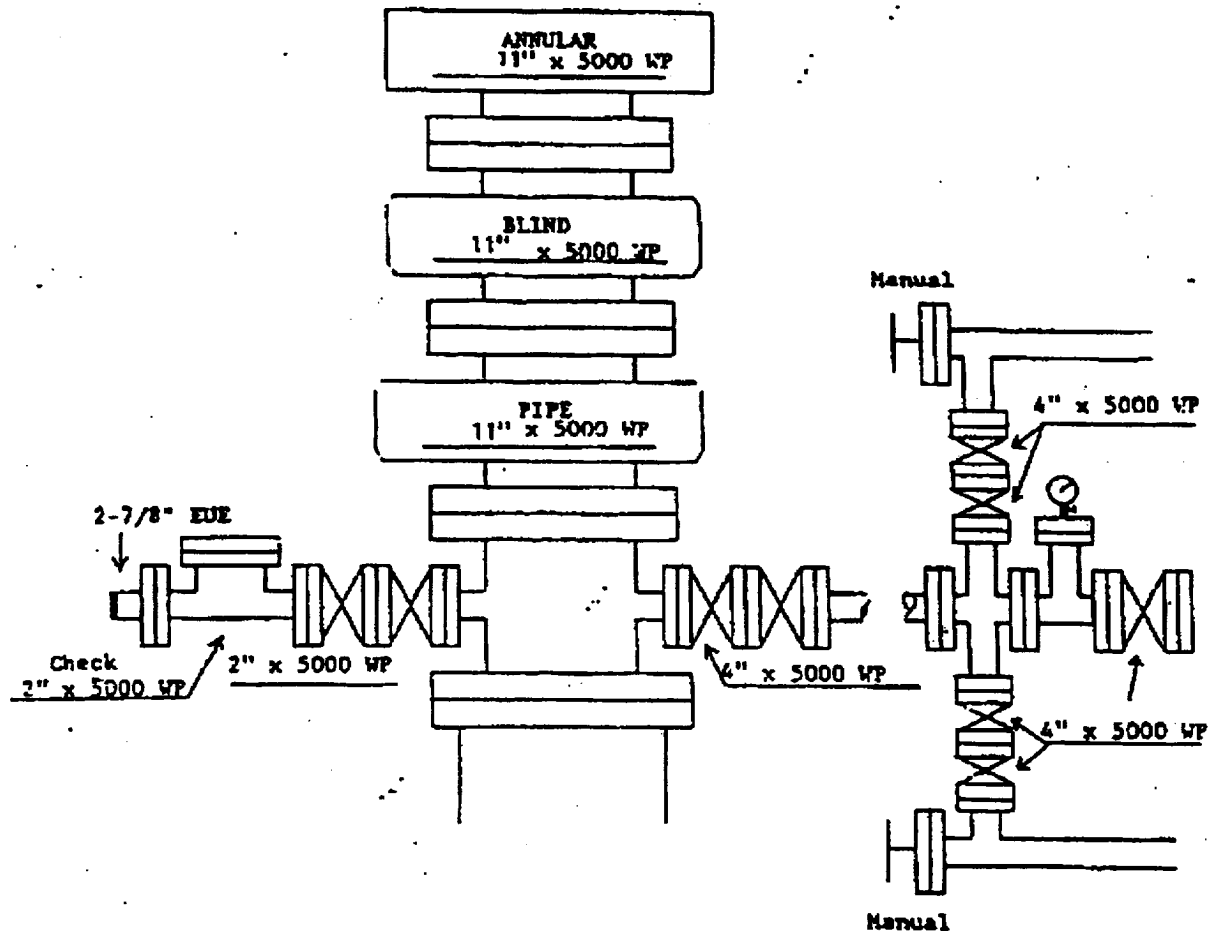

Exhibit I

DRILLING PROGRAM

ENRON OIL & GAS COMPANY
ROSS DRAW UNIT NO. 23
1,810' FSL & 660' FEL
SEC. 27, T26S, R30E
EDDY COUNTY, NM

1. GEOLOGIC NAME OF SURFACE FORMATION:

Permian

2. ESTIMATED TOPS OF IMPORTANT GEOLOGICAL MARKERS:

Delaware	3450'
Cherry Canyon	4420'
Bone Spring	7320'
First Bone Spring Sd	8250'
2 nd Bone Spring Sd	8950'
3 rd Bone Spring Sd	10180'
Wolfcamp	10550'
Wolfcamp Pay	11900'
Penn Marker	12900'

3. ESTIMATED DEPTHS OF ANTICIPATED FRESH WATER, OIL OR GAS:

Upper Permian Sands	100'	Fresh Water
Upper Penn		Gas

4. CASING PROGRAM

Hole Size	Interval	OD Casing	Weight Grade Jt.	Cond. Type
14 3/4"	0-1000'	11" WITNESS	42# H-40	ST&C
11"	0-4000'	8 5/8"	32# J-55	LT&C
7 7/8"	0-11700'	5 1/2"	17# S95/P110	L&TC
4 3/4"	0-13000'	2 7/8"	6.5# N80	

Cementing Program:

11 3/4" Surface Casing: Cement to surface with 220 sx Prem Plus, 3% Econolite, 2% Calcium Chloride, 0.25#/sx Flocele, 150 sx Prem Plus, 2% Calcium Chloride

8 5/8" Intermediate: Cement to surface with 715 sx Interfill C, .25#/sx flocele, 250 sx Premium Plus, 2% Calcium Chloride

5 1/2" Production Casing: Cement w/775 sx Premium, 3% Econolite, 5#/sx Salt, .25#/sx Flocele, 250 sx Prem 50/50 Poz mix 'A', 2% Halliburton-Gel First 2%, 0.5% Halad-322, 0.2% HR-5. This is designed to bring TOC to 3500'.

2 7/8" Casing: 100 sx Prem, 0.3% Halad-344, 0.3% Halad-413, 0.3% Super CBL, .15% SCR-100
This designed to bring TOC to 11500 +/-.

VICINITY MAP

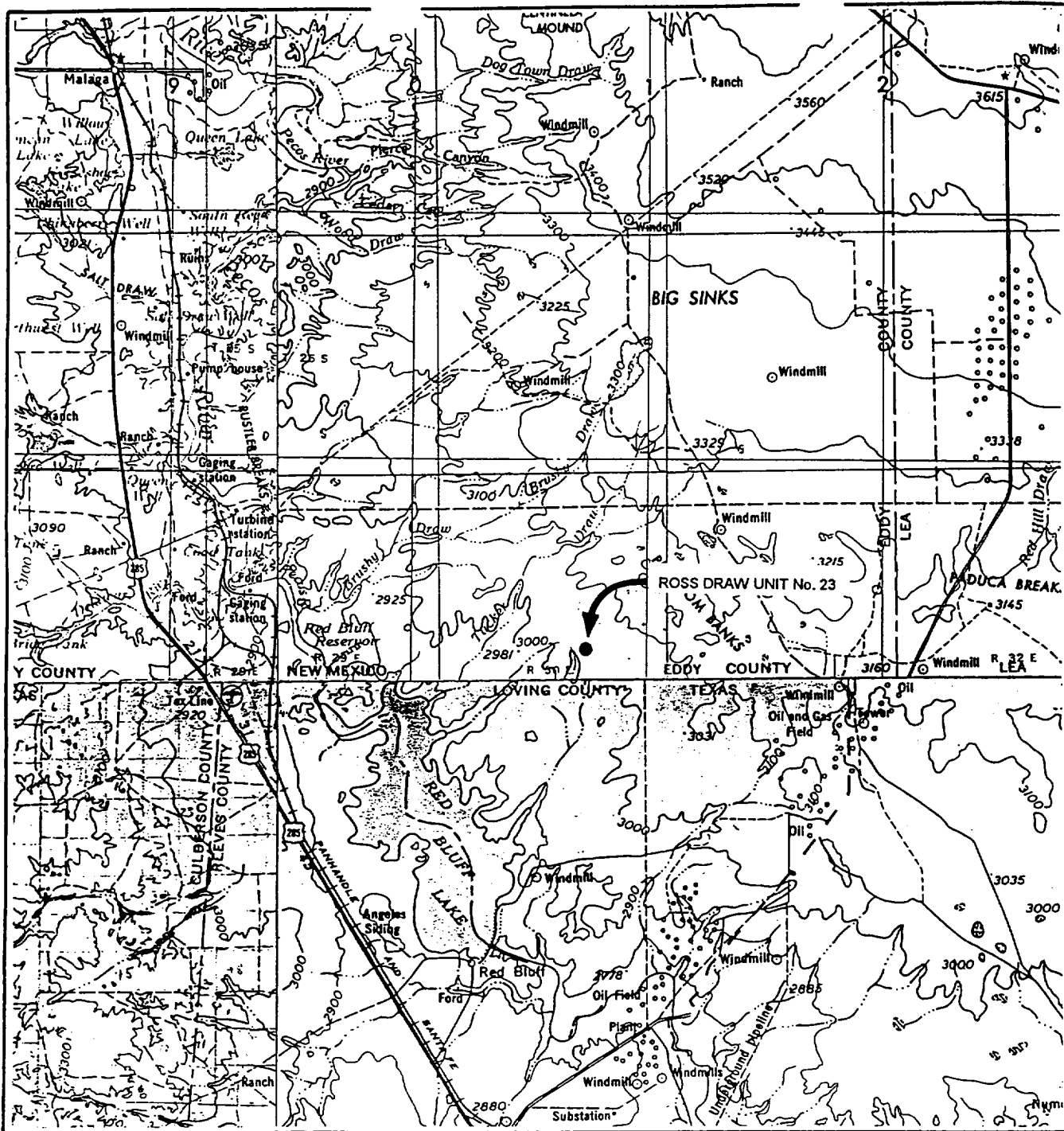

SCALE: 1" = 4 MILES

WTC 45725

SEC. 27 TWP. 26-S RGE. 30-E

SURVEY N.M.P.M

COUNTY EDDY STATE NM

DESCRIPTION 2310' FSL & 660' FEL

ELEVATION 3010'

OPERATOR ENRON OIL & GAS COMPANY

LEASE ROSS DRAW UNIT No. 23

Exhibit 3

WEST TEXAS CONSULTANTS, INC.

ENGINEERS-PLANNERS-SURVEYORS

MIDLAND, TEXAS

915-685-3800