

UNITED STATES
DEPARTMENT OF THE INTERIOR
BUREAU OF LAND MANAGEMENT

RECEIVED

FORM APPROVED
OMB No. 1004-0136
Expires November 30, 2000

APPLICATION FOR PERMIT TO DRILL OR REENTER

5. Lease Serial No.

I-149-IND-7971

6. If Indian, Allottee or Tribe Name

NAVAJO ALLOTMENT

7. If Unit or CA Agreement, Name and No.

N/A

8. Lease Name and Well No.

BUENA SUERTE 2914T

9. API Well No.

30-045-32025

10. Field and Pool, or Exploratory

BASIN FRUITLAND COAL

11. Sec., T., R., M., or Blk. and Survey or Area

029-26n-11w NMPM

12. County or Parish

SAN JUAN

13. State

NM

1a. Type of Work: ☒ DRILL☐ REENTER

070 Farmington, NM

1b. Type of Well: ☐ Oil Well ☒ Gas Well ☐ Other☒ Single Zone ☐ Multiple Zone

2. Name of Operator

ELM RIDGE RESOURCES, INC.

3a. Address P. O. BOX 189

FARMINGTON, NM 87499

3b. Phone No. (include area code)

(505) 632-3476

4. Location of Well (Report location clearly and in accordance with any State requirements. *)

At surface

690' FSL & 1945' FEL

At proposed prod. zone

SAME

14. Distance in miles and direction from nearest town or post office*

18 AIR MILES SOUTH OF BLOOMFIELD

15. Distance from proposed*

location to nearest
property or lease line, ft.
(Also to nearest drig. unit line, if any)

690'

16. No. of Acres in lease

1,560

17. Spacing Unit dedicated to this well

E2 = 320 ACRES

18. Distance from proposed location*

to nearest well, drilling, completed,
applied for, on this lease, ft.

1,396'

19. Proposed Depth

1,400'

20. BLM/BIA Bond No. on file

#886441C (BIA - NATION WIDE)

21. Elevations (Show whether DF, KDB, RT, GL, etc.)

6,175' GL

22. Approximate date work will start*

UPON APPROVAL

23. Estimated duration

2 WEEKS

24. Attachments

The following, completed in accordance with the requirements of Onshore Oil and Gas Order No.1, shall be attached to this form:

1. Well plat certified by a registered surveyor.
2. A Drilling Plan.
3. A Surface Use Plan (if the location is on National Forest System Lands, the SUPO shall be filed with the appropriate Forest Service Office).

4. Bond to cover the operations unless covered by an existing bond on file (see Item 20 above).
5. Operator certification.
6. Such other site specific information and/or plans as may be required by the authorized officer.

Comments

On site inspectors: Bryce Barlan and James Miles

ER Well #: 3647

ER Lease #: 701

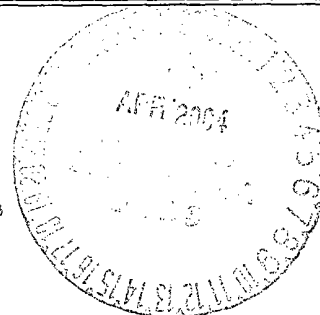
All actions and approvals are
SUBJECT TO COMPLIANCE WITH ATTACHED
"GENERAL REQUIREMENTS".This action is subject to technical and
procedural review pursuant to 43 CFR 3165.3
and appeal pursuant to 43 CFR 3165.4

cc:BLM (FIMO & OCD), Elm (D & F)

25. Signature

Name (Printed/Typed)

BRIAN WOOD

Date

12-1-03

Title

CONSULTANT

PHONE: 505 466-8120

FAX: 505 466-9682

Approved by (Signature)

David J. Mankiewicz

Name (Printed/Typed)

Date

APR 22 2004

Title

AFM

Office

FEO

Application approval does not warrant or certify the the applicant holds legal or equitable title to those rights in the subject lease which would entitle the applicant to conduct operations thereon.

Conditions of approval, if any, are attached.

Title 18 U.S.C. Section 1001 and Title 43 U.S.C. Section 1212, make it a crime for any person knowingly and willfully to make to any department or agency of the United States any false, fictitious or fraudulent statements or representations as to any matter within its jurisdiction.

NMOCD

State of New Mexico
Energy, Minerals & Mining Resources Department
OIL CONSERVATION DIVISION
2040 South Pacheco
Santa Fe, NM 87505

Form C - 102

☐ AMENDED REPORT

WELL LOCATION AND ACREAGE DEDICATION PLAT

APA Number 30-045-32025	Pool Code 71629	Pool Name BASIN FRUITLAND COAL
Property Code 27260	Property Name BUENA SUERTE 29 G	
OCRD No. 149052	Operator Name ELM RIDGE RESOURCES	
	Well Number 1KT	Elevation 6175'

Surface Location									
UL or Lot 0	Sec. 29	Twp. 26 N	Rge. 1 W.	Lot Lch.	Feet from > 690'	North/South SOUTH	Feet from > 1945'	East/West EAST	County SAN JUAN

Bottom Hole Location if Different From Surface									
UL or Lot	Sec.	Twp.	Rge.	Lot Lch.	Feet from >	North/South	Feet from >	East/West	County

Dedication 320	Joint ?	Consolidation	Order No.
--------------------------	---------	---------------	-----------

NO ALLOWABLE WILL ASSIGNED TO THIS COMPLETION UNTIL ALL INTERESTS HAVE BEEN CONSOLIDATED
OR A NON-STANDARD UNIT HAS BEEN APPROVED BY THE DIVISION

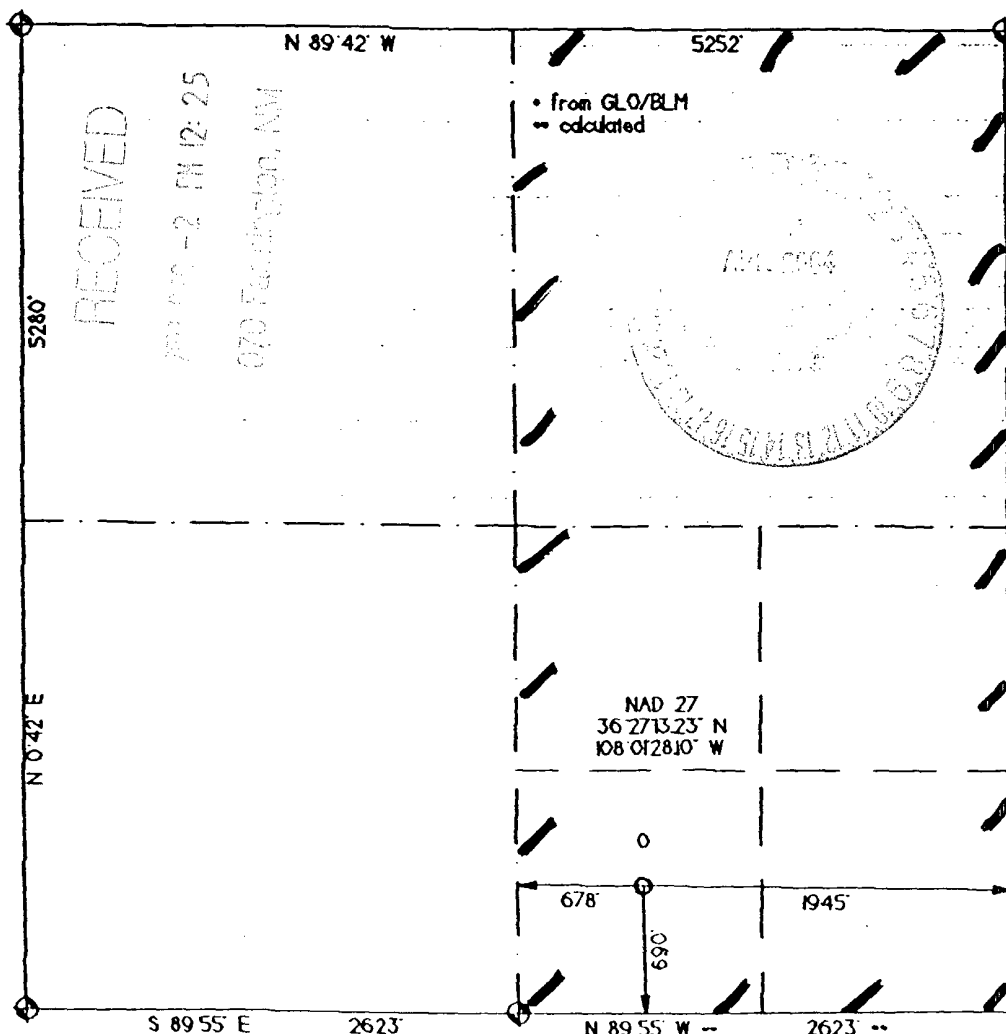

OPERATOR CERTIFICATION	
I hereby certify that the information contained herein is true and complete to the best of my knowledge and belief.	
Signature	<i>B. Wood</i>
Printed Name	BRIAN WOOD
Title	CONSULTANT
Date	DEC. 1, 2003
SURVEYOR CERTIFICATION	
I hereby certify that the well location on this plat was plotted from field notes of actual surveys made by me or under my supervision, and that the same is true and correct to the best of my belief.	
Date of Survey	
Signature and Seal of Professional Surveyor	<i>[Signature]</i>

Elm Ridge Resources, Inc.
Buena Suerte 29 #1-T
690' FSL & 1945' FEL
Sec. 29, T. 26 N., R. 11 W.
San Juan County, New Mexico

PAGE 1

Drilling Program

1. ESTIMATED FORMATION TOPS

<u>Formation Name</u>	<u>GL Depth</u>	<u>KB Depth</u>	<u>Sub Sea Elevatio</u>
Nacimiento	000'	5'	+6,175'
Fruitland Coal	1,125'	1,130'	+5,050'
Pictured Cliffs	1,275'	1,280'	+4,900'
Total Depth (TD)*	1,400'	1,405'	+4,775'

* all elevations reflect the ungraded ground level of 6,175'

2. NOTABLE ZONES

Oil & Gas Zones

Fruitland Coal

Pictured Cliffs

Water Zones

Nacimiento

Coal Zones

Fruitland

Water zones will be protected with casing, cement, and weighted mud. Fresh water encountered during drilling will be recorded by depth, cased, and cemented. Oil and gas shows will be tested for commercial potential based on the well site geologist's recommendations.

3. PRESSURE CONTROL

The exact drill rig and BOP model to be used are not yet known. (A typical 2,000 psi model is on PAGE 3.) BOP and choke manifold system will be installed and tested to 500 psi before drilling surface casing plug. It will remain in use until the well is completed or abandoned. A safety valve and sub with a full opening valve to fit the drill pipe and collars will be available on the rig floor in the open position at all times for use when kelly is not in use.

Elm Ridge Resources, Inc.
Buena Suerte 29 #1-T
690' FSL & 1945' FEL
Sec. 29, T. 26 N., R. 11 W.
San Juan County, New Mexico

PAGE 2

All BOP mechanical and pressure tests will be recorded on the driller's log. BOPs will be inspected and opened and closed at least daily to assure good mechanical working order. Inspections will be recorded on the daily drilling report. Pressure tests will be conducted before drilling out from under all casing strings which are set and cemented in place.

4. CASING & CEMENT

<u>Hole Size</u>	<u>O. D.</u>	<u>Weight (lb/ft)</u>	<u>Grade</u>	<u>Type</u>	<u>Age</u>	<u>GL Setting Depth</u>
8-5/8"	7"	20	K-55	S T & C	New	120'
6-3/4"	4-1/2"	10.5	J-55	S T & C ST	New	1,400'

Surface casing will be cemented to the surface with ≈ 35 cubic feet (≈ 30 sacks) Class B + 1/4 pound per sack cello flake + 2% CaCl_2 . Yield = 1.18 cubic feet per sack. Weight = 15.2 pounds per gallon. Volume = 100% excess. Two centralizers will be run. Thread lock guide shoe and bottom of float collar.

Production casing hole will be cleaned of rock chips by circulating $\geq 150\%$ of the hole volume with mud to the surface. Thirty-five barrels of fresh water will then be circulated. Lead with ≈ 225 cubic feet (≈ 109 sacks) of Class B with 2% metasilicate (yield = 2.06 cubic feet per sack and weight = 12.5 pounds per gallon). Tail with ≈ 130 cubic feet (≈ 110 sacks) of Class B with 2% CaCl_2 (yield = 1.18 cubic feet per sack and weight = 15.2 pounds per gallon). Total cement volume is ~~255~~ ³⁵⁵ cubic feet based on 75% excess and circulating to surface.

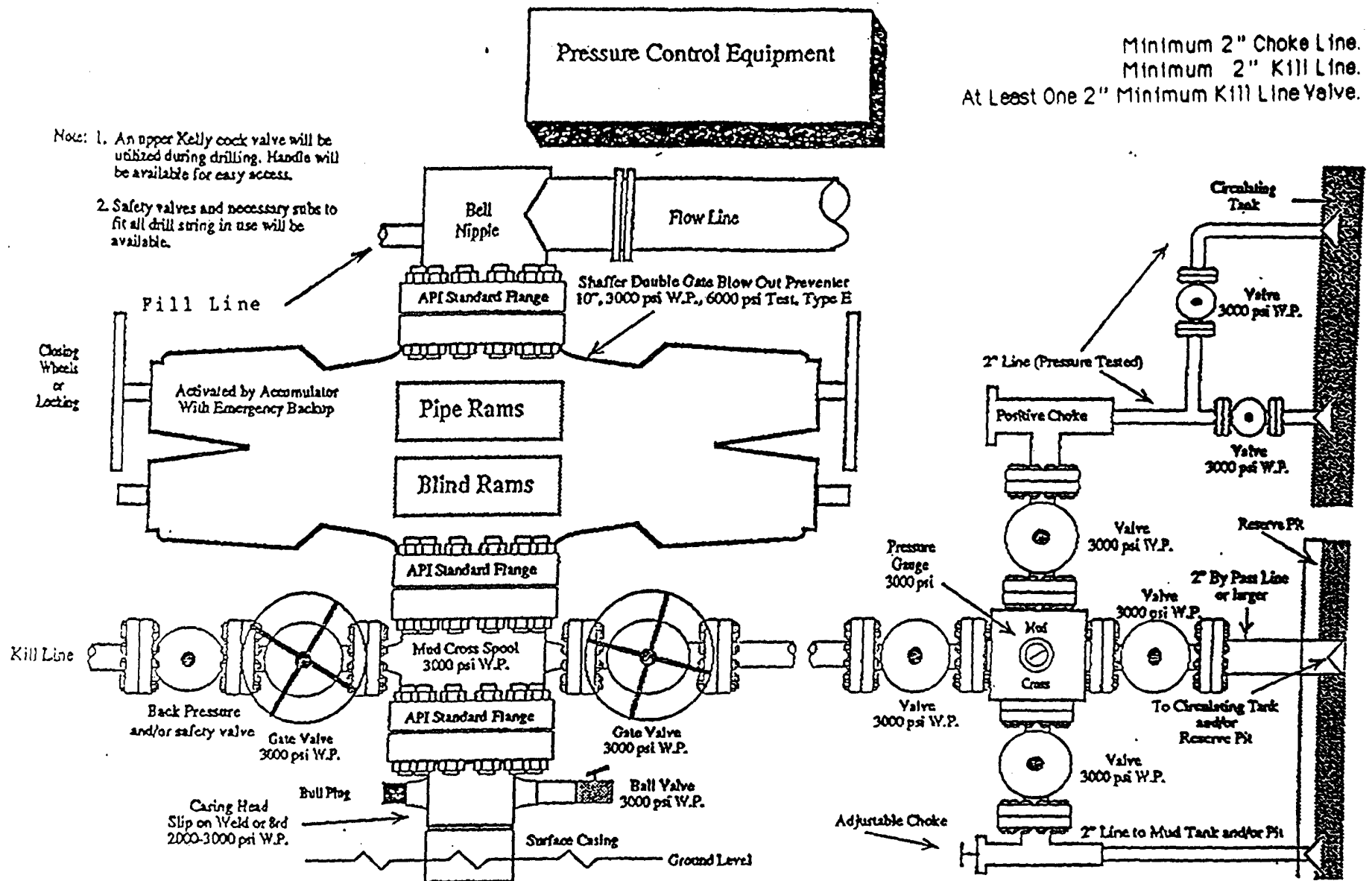

Note: This equipment is designed to meet requirements for a 2-M rating standard per 43 CFR part 3160 (amended). Proper operation and testing of equipment will be carried out per standard. 2,000 psi equipment can be substituted in the drawing to meet minimum requirements per standard.

Buena Suerte 29 # 1-T
well pad and section

