

UNITED STATES  
DEPARTMENT OF THE INTERIOR  
BUREAU OF LAND MANAGEMENT

APPLICATION FOR PERMIT TO DRILL OR REENTER

RECEIVED

6/01  
2004 MAY 32 PM 2:38

FORM APPROVED  
OMB No. 1004-0136  
Expires January 31, 2004

1a. Type of Work: <input checked="" type="checkbox"/> DRILL <input type="checkbox"/> REENTER		5. Lease Serial No. NMSF-079968
1b. Type of Well: <input type="checkbox"/> Oil Well <input checked="" type="checkbox"/> Gas Well <input type="checkbox"/> Other <input checked="" type="checkbox"/> Single Zone <input type="checkbox"/> Multiple Zone		6. If Indian, Allottee or Tribe Name N/A
2. Name of Operator Richardson Operating Company		7. If Unit or CA Agreement, Name and No. NMNM 103096
3a. Address 3100 La Plata Hwy, Farm., NM 87401	3b. Phone No. (include area code) 564-3100	8. Lease Name and Well No. WF Federal 3#3
4. Location of Well (Report location clearly and in accordance with any State requirements. *) At surface 1355' FNL & 1940' FWL At proposed prod. zone Same		9. API Well No. 30-045- 32390
14. Distance in miles and direction from nearest town or post office* 3 miles East of Kirtland, NM		10. Field and Pool, or Exploratory Fruitland Coal
15. Distance from proposed* location to nearest property or lease line, ft. (Also to nearest drig. unit line, if any) 700'	16. No. of Acres in lease 2,523.72	11. Sec., T., R., M., or Blk. and Survey or Area F Sec. 3-T29N-R14W, NMPM
17. Spacing Unit dedicated to this well W/2 318.15 Acres	18. Distance from proposed* location to nearest well, drilling, completed, applied for, on this lease, ft. 1400'	12. County or Parish San Juan
19. Proposed Depth 1050'	20. BLM/BIA Bond No. on file BLM Nationwide #158293308	13. State NM
21. Elevations (Show whether DF, KDB, RT, GL, etc.) 5445 GL	22. Approximate date work will start* Upon approval	23. Estimated duration One week
24. Attachments		

The following, completed in accordance with the requirements of Onshore Oil and Gas Order No.1, shall be attached to this form:

1. Well plat certified by a registered surveyor.
2. A Drilling Plan.
3. A Surface Use Plan (if the location is on National Forest System Lands, the SUPO shall be filed with the appropriate Forest Service Office).
4. Bond to cover the operations unless covered by an existing bond on file (see Item 20 above).
5. Operator certification.
6. Such other site specific information and/or plans as may be required by the authorized officer.

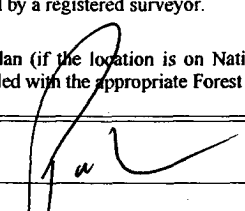
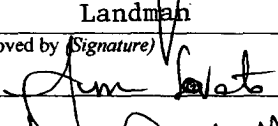
25. Signature 	Name (Printed/Typed) Paul Lehrman	Date 6-1-04
Title Landman		
Approved by (Signature) 	Name (Printed/Typed) Acting Field Manager - Minerals	Date 6/21/04
Title Acting Field Manager - Minerals	Office	

Application approval does not warrant or certify that the applicant holds legal or equitable title to those rights in the subject lease which would entitle the applicant to conduct operations thereon.

Conditions of approval, if any, are attached.

Title 18 U.S.C. Section 1001 and Title 43 U.S.C. Section 1212, make it a crime for any person knowingly and willfully to make to any department or agency of the United States any false, fictitious or fraudulent statements or representations as to any matter within its jurisdiction.

\*(Instructions on reverse)

NMOCOD

✓  
DRILLING OPERATIONS AUTHORIZED ARE  
SUBJECT TO COMPLIANCE WITH ATTACHED  
"GENERAL REQUIREMENTS".

This action is subject to technical and  
procedural review pursuant to 43 CFR 3165.3  
and appeal pursuant to 43 CFR 3165.4

State of New Mexico  
Energy, Minerals & Mining Resources Department  
OIL CONSERVATION DIVISION  
2040 South Pacheco  
Santa Fe, NM 87505

Form C - 102

☐ AMENDED REPORT

## WELL LOCATION AND ACREAGE DEDICATION PLAT

APA Number 30-045- <b>32390</b>	Pool Code 71629	Pool Name Basin Fruitland Coal
Property Code <b>25983</b>	Property Name WF FEDERAL 3	Well Number 3
GRID No. 19219	Operator Name RICHARDSON OPERATING COMPANY	Elevation 5445'

## Surface Location

UL or Lot	Sec.	Twp.	Rge.	Lot Id.	Feet from	North/South	Feet from	East/West	County
F	3	29 N	14 W.		1355'	NORTH	1940'	WEST	SAN JUAN

## Bottom Hole Location if Different From Surface

UL or Lot	Sec.	Twp.	Rge.	Lot Id.	Feet from	North/South	Feet from	East/West	County

Dedication W/2 318.15	Joint ?	Consolidation	Order No.
-----------------------------	---------	---------------	-----------

NO ALLOWABLE WELL ASSIGNED TO THIS COMPLETION UNTIL ALL INTERESTS HAVE BEEN CONSOLIDATED  
OR A NON-STANDARD UNIT HAS BEEN APPROVED BY THE DIVISION

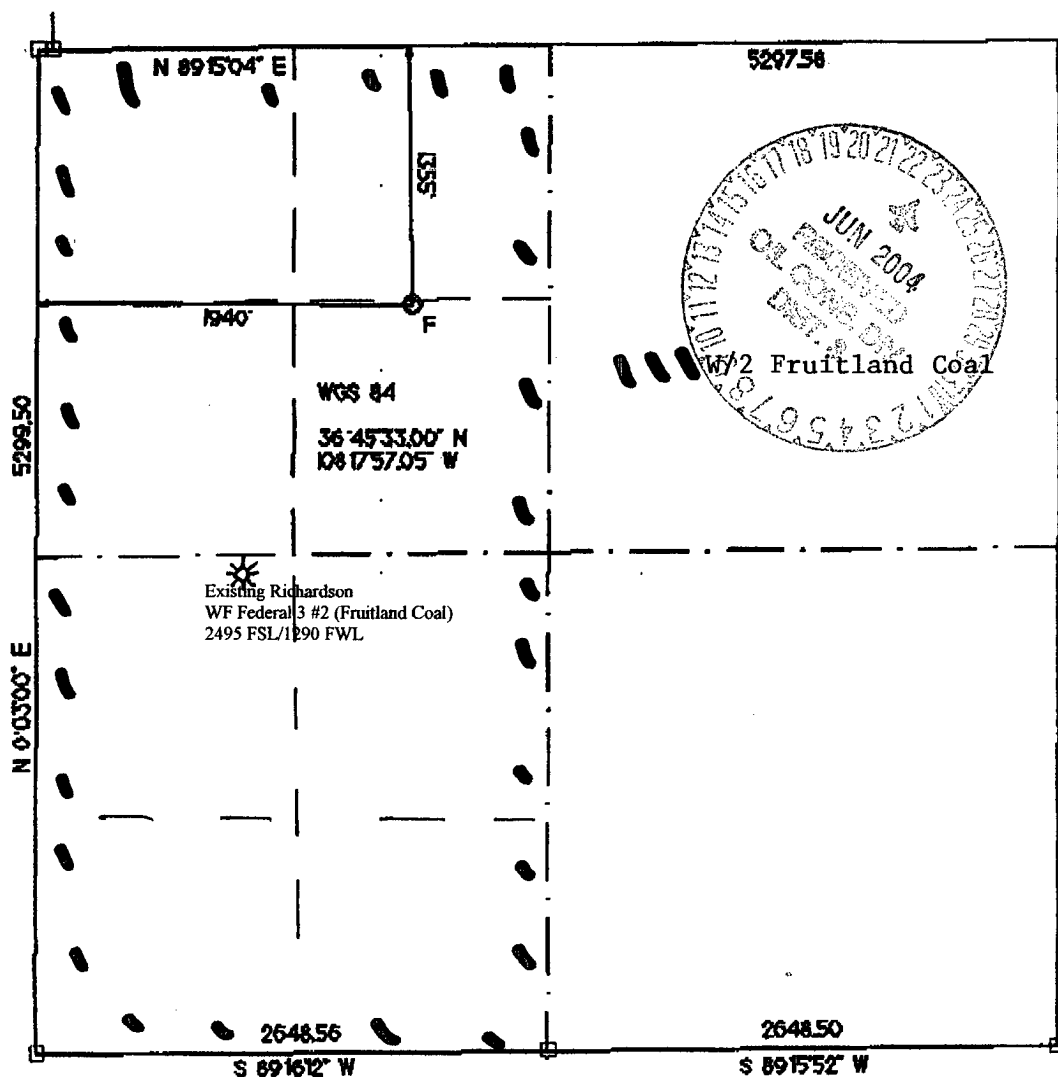

## OPERATOR CERTIFICATION

I hereby certify that the information contained herein is true and complete to the best of my knowledge and belief.

Signature

Printed Name

Paul Lehrman

Title

Landman

Date

6-1-04

## SURVEYOR CERTIFICATION

I hereby certify that the well location on this plat was plotted from field notes of actual surveys made by me or under my supervision, and that the same is true and correct to the best of my belief.

Date of Survey

5/7/04

Signature and Seal of Professional Surveyor

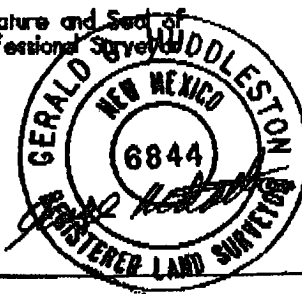

**Richardson Operating Company**  
**WF Federal 3 #3**  
**1355' FNL & 1940' FWL**  
**Section 3, T29N, R14W, NMPM**  
**San Juan County, New Mexico**

**DRILLING PROGRAM**

**1. ESTIMATED FORMATION TOPS:**

<u>Formation</u>	<u>GL Depth</u>	<u>KB Depth</u>	<u>Subsea Elevation</u>
Kirtland Shale	Surface	5'	+5,445'
Fruitland Fm	690'	695'	+4,755'
Basal Fruitland Coal	870'	875'	+4,575'
Pictured Cliffs Ss	985'	990'	+4,460'
Total Depth (TD)*	1050'	1055'	+4,395'

\*All elevations reflect the ungraded ground level of 5,445'

**2. NOTABLE ZONES:**

<u>Gas Zones</u>	<u>Water Zones</u>	<u>Coal Zones</u>
Fruitland	Fruitland Coal	Fruitland Coal
Pictured Cliffs		

Water zones will be protected with casing, cement, and water based mud. Fresh water encountered during drilling will be recorded by depth. Centralizers will be run through usable water zones to ensure that the casing is centralized through these zones. Number of centralizers will be based on API standards. A turbulizing centralizer will be run to ensure an adequate cement procedure just below the base of the lowest usable water zone. Oil and gas shows will be tested for commercial potential based on the well site representatives recommendations.

**3. PRESSURE CONTROL:**

The drilling contract has not yet been awarded, thus the exact BOP model to be used is unknown. (A typical 2,000 psi model has been attached to the end of the drilling program.) Double ram or annular system with a rotating head will be used. All ram preventers and related equipment will be hydraulically tested at nipple up and after any use under pressure to 1000 psi.

Blind rams will be hydraulically activated and checked for operational readiness each time pipe is pulled out of the hole. All checks of the BOP stack and equipment will be noted on the daily drilling report. BOP equipment will include a floor safety valve and choke manifold rated to 2000 psi. Maximum expected pressure is less than 1000 psi.

**Drilling Program**  
**Richardson Operating Company**

Page Two

**4. CASING AND CEMENTING PROGRAM:**

<u>Hole Size</u>	<u>O.D.</u>	<u>Weight (lb/ft)</u>	<u>Grade</u>	<u>Age</u>	<u>GL Setting Depth</u>
8 3/4"	7"	20	J-55	New	120'
6 1/4"	4 1/2"	10.5	J-55	New	1050'

Surface casing will be cemented to surface with  $\approx 36$  cu.ft. ( $\approx 30$  sx) Class B + 2% CaCl. Volume is based on 100% excess, yield of 1.18 cu.ft./sk, and slurry weight of 15.6 ppg. WOC = 12 hours. Pressure test surface casing to 600 psi for 30 minutes.

Production casing hole will first be cleaned of rock chips by circulating at least 150% of hole volume with drilling fluid to surface. Thirty barrels of fresh water will then be circulated. Lead with  $\approx 115$  cu.ft. ( $\approx 75$  sx) Class B with 2% metasilicate (yield = 2.06 cu.ft./sk, slurry weight = 12.5 ppg). Tail in with  $\approx 65$  cu.ft. ( $\approx 70$  sx) Class B with 2% CaCl (yield = 1.18 cu.ft./sk, weight = 15.6 ppg). Total cement volume is  $\approx 180$  cu.ft. based on 100% excess and circulating to surface.

Production casing will have 4 1/2" cement guide shoe and self fill float collar. Float will be placed one joint above the shoe. Six centralizers will be spaced every other joint starting above the shoe. Six turbolizers will be placed every other joint starting from the top of the well.

**5. MUD PROGRAM:**

Surface casing hole will be drilled with fresh water mud. Production casing hole will be drilled with a fresh water polymer mud. Weighting material will be drill solids or, if needed, barite. Maximum expected mud weight will be 8.7 ppg. Sufficient material to maintain mud properties, control lost circulation, and contain a blowout will be available at the well while drilling.

**6. CORING, TESTING, & LOGGING:**

No cores or DSTs are planned. A cased hole CNL/GR will be run from TD to surface.

**7. DOWNHOLE CONDITIONS:**

No abnormal pressures, temperatures, nor hydrogen sulfide are expected. Maximum pressure will be approximately  $\approx 520$  psi. Although no hydrogen sulfide is expected while drilling, if encountered appropriate safety measures will be instituted. After the well is in production, if hydrogen sulfide is encountered, appropriate safety measures will be instituted to ensure the safety of the public, Richardson employees, contractors, or anyone expected to work or recreate in the vicinity. This may include, but not be limited to, monitoring, flagging or other measures appropriate for the situation.

# BLOW OUT PREVENTER (B.O.P.)

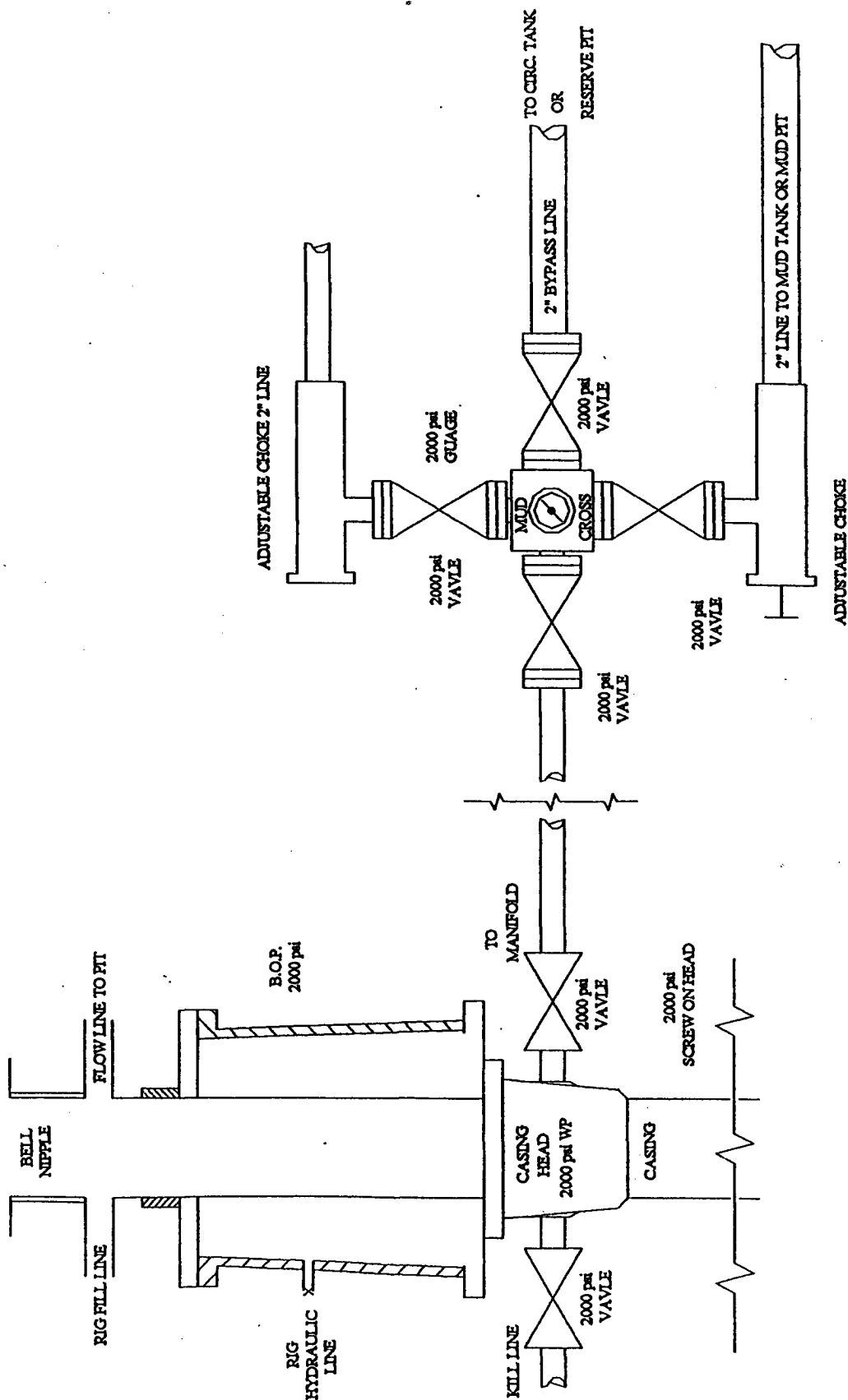

Submit 3 Copies To Appropriate District  
Office  
District I  
1625 N. French Dr., Hobbs, NM 88240  
District II  
1301 W. Grand Ave., Artesia, NM 88210  
District III  
1000 Rio Brazos Rd., Aztec, NM 87410  
District IV  
1220 S. St. Francis Dr., Santa Fe, NM  
87505

State of New Mexico  
Energy, Minerals and Natural Resources

Form C-103  
March 4, 2004

OIL CONSERVATION DIVISION  
1220 South St. Francis Dr.  
Santa Fe, NM 87505

<b>SUNDRY NOTICES AND REPORTS ON WELLS</b> (DO NOT USE THIS FORM FOR PROPOSALS TO DRILL OR TO DEEPEN OR PLUG BACK TO A DIFFERENT RESERVOIR. USE "APPLICATION FOR PERMIT" (FORM C-101) FOR SUCH PROPOSALS.)		WELL API NO. 30-045-
1. Type of Well: Oil Well <input type="checkbox"/> Gas Well <input checked="" type="checkbox"/> Other		5. Indicate Type of Lease Federal STATE <input type="checkbox"/> FEE <input type="checkbox"/> NMSE <input type="checkbox"/>
2. Name of Operator Richardson Operating Company		6. State Oil & Gas Lease No. 079968 N/A
3. Address of Operator 3100 La Plata Highway, Farmington, NM 87401		7. Lease Name or Unit Agreement Name WF Federal 3
4. Well Location Unit Letter F : 1355 feet from the North line and 1940 feet from the West line Section 3 29 N Township 14W Range NMPM San Juan County NM		8. Well Number #3
11. Elevation (Show whether DR, RKB, RT, GR, etc.) 5445 GR		9. OGRID Number 19219
		10. Pool name or Wildcat Basin Fruitland Coal

Pit or Below-grade Tank Application (For pit or below-grade tank closures, a form C-144 must be attached)

Pit Location: UL F Sect 3 Twp 29N Rng 14W Pit type Drilling Depth to Groundwater >100' Distance from nearest fresh water well >1/2 mile  
Distance from nearest surface water >1000' Below-grade Tank Location UL Sect Twp Rng ;  
feet from the line and feet from the line

12. Check Appropriate Box to Indicate Nature of Notice, Report or Other Data  
NOTICE OF INTENTION TO:

PERFORM REMEDIAL WORK ☐ PLUG AND ABANDON ☐  
TEMPORARILY ABANDON ☐ CHANGE PLANS ☐  
PULL OR ALTER CASING ☐ MULTIPLE COMPLETION ☐  
OTHER: ☐

SUBSEQUENT REPORT OF:

REMEDIAL WORK ☐ ALTERING CASING ☐  
COMMENCE DRILLING OPNS. ☐ PLUG AND ABANDONMENT ☐  
CASING TEST AND CEMENT JOB ☐  
OTHER: Pit Permit ☒

13. Describe proposed or completed operations. (Clearly state all pertinent details, and give pertinent dates, including estimated date of starting any proposed work). SEE RULE 1103. For Multiple Completions: Attach wellbore diagram of proposed completion or recompletion.

I hereby certify that the information above is true and complete to the best of my knowledge and belief. I further certify that any pit or below-grade tank has been/will be constructed or closed according to NMOCDC guidelines ☒ a general permit ☐ or an (attached) alternative OCD-approved plan ☐.

SIGNATURE TITLE Landman DATE 6-1-04

Type or print name E-mail address: plehrman@digii.net Telephone No. 564-8115

(This space for State use)

APPROVED BY TITLE DATE  
Conditions of approval, if any:

WF Federal 3 # 3  
well pad and section

