

UNITED STATES
DEPARTMENT OF THE INTERIOR
BUREAU OF LAND MANAGEMENT

APPLICATION FOR PERMIT TO DRILL OR REENTER

FORM APPROVED
OMB No. 1004-0136
Expires November 30, 2000

5. Lease Serial No.
14-20-603-2172

6. If Indian, Allottee or Tribe Name
NAVAJO

7. If Unit or CA Agreement, Name and No.
N/A

8. Lease Name and Well No.
NV HAROLD 26 #1

9. API Well No.
30-045- 31616

10. Field and Pool, or Exploratory
BA. FRUIT. COAL & W. KUTZ PC

11. Sec., T., R., M., or Blk. and Survey or Area
26-29n-14w NMPM

12. County or Parish
SAN JUAN

13. State
NM

1a. Type of Work: ☒ DRILL

☐ REENTER

1b. Type of Well: ☐ Oil Well ☒ Gas Well ☐ Other

☐ Single Zone ☒ Multiple Zone

2. Name of Operator

RICHARDSON OPERATING COMPANY

3a. Address **3100 LaPLATA HIGHWAY
FARMINGTON, NM 87401**

3b. Phone No. (include area code)
(505) 564-3100

4. Location of Well (Report location clearly and in accordance with any State requirements. *)

At surface **1895' FNL & 1670' FEL**

At proposed prod. zone **SAME**

14. Distance in miles and direction from nearest town or post office*

3 AIR MILES SW OF FARMINGTON

15. Distance from proposed*
location to nearest
property or lease line, ft.
(Also to nearest drig. unit line, if any)

1,895'

16. No. of Acres in lease

2,560

17. Spacing Unit dedicated to this well

**E2 (320 acres to Fruitland Coal)
NE4 (160 acres to Pictured Cliff)**

18. Distance from proposed location*
to nearest well, drilling, completed,
applied for, on this lease, ft.

2,010'

19. Proposed Depth

1,500'

20. BLM/BIA Bond No. on file

158-293-308

21. Elevations (Show whether DF, KDB, RT, GL, etc.)

5,660' GL

22. Approximate date work will start*

UPON APPROVAL

23. Estimated duration

2 WEEKS

24. Attachments

The following, completed in accordance with the requirements of Onshore Oil and Gas Order No.1, shall be attached to this form:

1. Well plat certified by a registered surveyor.
2. A Drilling Plan.
3. A Surface Use Plan (if the location is on National Forest System Lands, the SUPO shall be filed with the appropriate Forest Service Office).

4. Bond to cover the operations unless covered by an existing bond on file (see Item 20 above).
5. Operator certification.
6. Such other site specific information and/or plans as may be required by the authorized officer.

Comments

Shown as NV Benally 26 #1 on Notice of Staking and WF Navajo 26-1 on archaeology report.

This action is subject to technical and
procedural review pursuant to 43 CFR 3165.3
and appeal pursuant to 43 CFR 3165.4

DRILLING OPERATIONS AUTHORIZED ARE
SUBJECT TO COMPLIANCE WITH ATTACHED
"GENERAL REQUIREMENTS".

cc: BIA, BLM (&OCD), Richardson, Tribe

25. Signature

Name (Printed/Typed)

BRIAN WOOD

Date

4-2-03

Title

CONSULTANT

PHONE: 505 466-8120

FAX: 505 466-9682

Approved **David J. Mankiewicz**

Name (Printed/Typed)

Date

JUL 16 2004

Title

Office

Application approval does not warrant or certify the the applicant holds legal or equitable title to those rights in the subject lease which would entitle the applicant to conduct operations thereon.

Conditions of approval, if any, are attached.

Title 18 U.S.C. Section 1001 and Title 43 U.S.C. Section 1212, make it a crime for any person knowingly and willfully to make to any department or agency of the United States any false, fictitious or fraudulent statements or representations as to any matter within its jurisdiction.

NMOCD

State of New Mexico
Energy, Minerals & Mining Resources Department
OIL CONSERVATION DIVISION
2040 South Pacheco
Santa Fe, NM 87505

Form C - 102

☐ AMENDED REPORT

WELL LOCATION AND ACREAGE DEDICATION PLAT

APA Number 30-045-31616	Pool Code 71629 & 79680	Pool Name BASIN FRUIT. COAL & WEST KUTZ PC
Property Code 34156	Property Name NV Navajo 26	Well Number 1
OGRID No. 019219	Operator Name RICHARDSON OPERATING COMPANY	Elevation 5660.0'

Surface Location									
UL or Lot G	Sec. 26	Twp. 29. N.	Rge. 14 W.	Lot Lth.	Feet from > . 1895	North/South NORTH	Feet from > 1670.	East/West EAST	County SAN JUAN

Bottom Hole Location If Different From Surface									
UL or Lot	Sec.	Twp.	Rge.	Lot Lth.	Feet from >	North/South	Feet from >	East/West	County

Dedication	Joint ?	Consolidation	Order No.
------------	---------	---------------	-----------

NO ALLOWABLE WILL ASSIGNED TO THIS COMPLETION UNTIL ALL INTERESTS HAVE BEEN CONSOLIDATED
OR A NON-STANDARD UNIT HAS BEEN APPROVED BY THE DIVISION

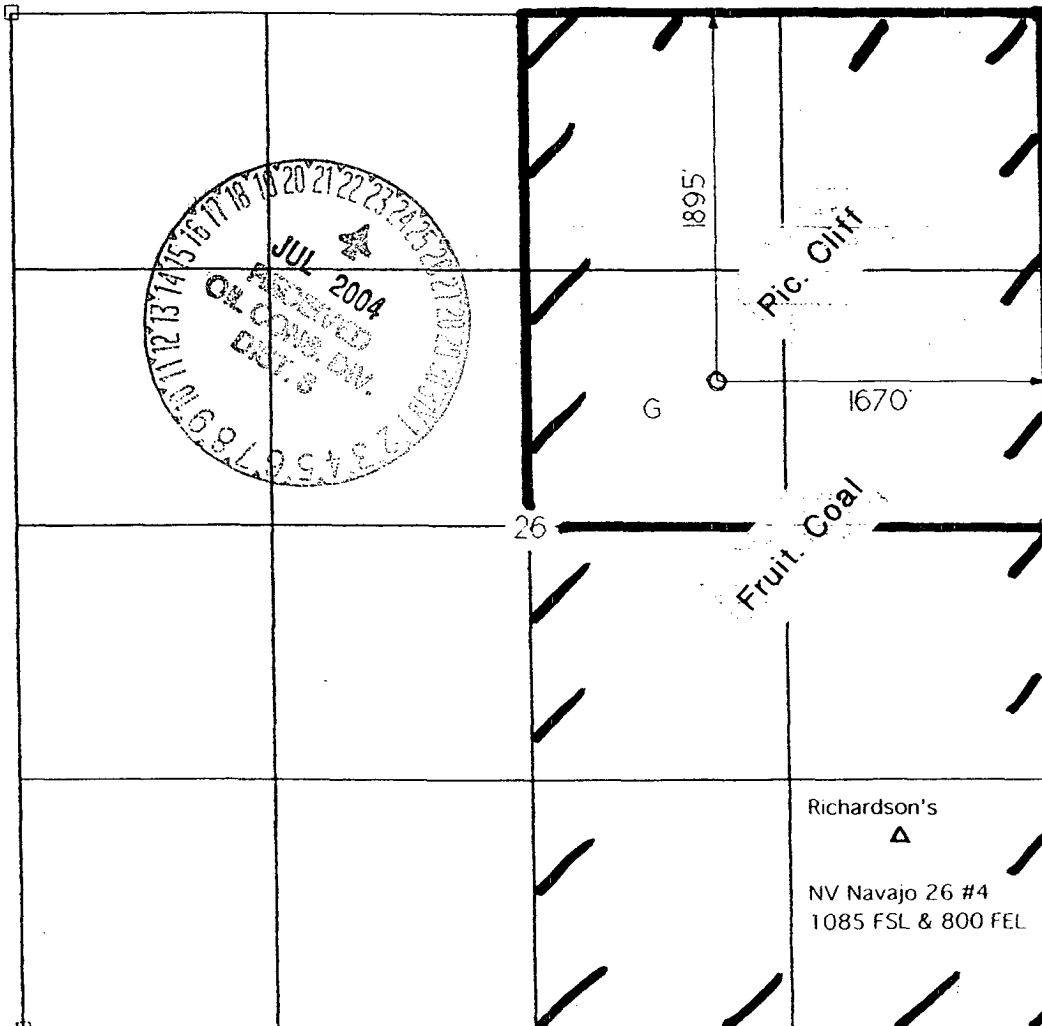

OPERATOR CERTIFICATION I hereby certify that the information contained herein is true and complete to the best of my knowledge and belief. Signature <i>B. Wood</i> Printed Name BRIAN WOOD	
Title CONSULTANT	
Date APR. 2, 2003	
SURVEYOR CERTIFICATION I hereby certify that the well location on this plat was plotted from field notes of actual surveys made by me or under my supervision, and that the same is true and correct to the best of my belief. Date of Survey	
Signature <i>[Signature]</i> Professional Surveyor 6844 REGISTERED LAND SURVEYOR	

Richardson Operating Company
NV Harold 26 #1
1895' FNL & 1670' FEL
Sec. 26, T. 29 N., R. 14 W.
San Juan County, New Mexico

PAGE 1

Drilling Program

1. ESTIMATED FORMATION TOPS

<u>Formation Name</u>	<u>GL Depth</u>	<u>KB Depth</u>	<u>Elevation</u>
Kirtland Shale	000'	5'	+5,660'
Fruitland Fm	1,150'	1,155'	+4,510'
Pictured Cliffs Ss	1,270'	1,275'	+4,390'
Lewis Shale	1,470'	1,475'	+4,190'
Total Depth (TD)*	1,500'	1,555'	+4,160'

* all elevations reflect the ungraded ground level of 5,660'

2. NOTABLE ZONES

<u>Gas Zones</u>	<u>Water Zones</u>	<u>Coal Zones</u>
Fruitland Coal	Fruitland Coal	Fruitland Coal
Pictured Cliffs		

Water zones will be protected with casing, cement, and weighted mud. Fresh water encountered during drilling will be recorded by depth, cased, and cemented. Oil and gas shows will be tested for commercial potential based on the well site geologist's recommendations.

3. PRESSURE CONTROL

The drilling contract has not yet been awarded, thus the exact BOP model to be used is not yet known. (A typical 2,000 psi model is on PAGE 3.) Double ram or annular system with a rotating head will be used. All ram preventers and related equipment will be hydraulically tested at nipple up and after any use under pressure to 1,000 psi.

Richardson Operating Company
NV Harold 26 #1
1895' FNL & 1670' FEL
Sec. 26, T. 29 N., R. 14 W.
San Juan County, New Mexico

PAGE 2

Blind rams will be hydraulically activated and checked for operational readiness each time pipe is pulled out of the hole. All checks of the BOP stack and equipment will be noted on the daily drilling report. BOP equipment will include a floor safety valve and choke manifold all rated to 2,000 psi. Maximum expected pressure is ≈ 600 psi.

4. CASING & CEMENT

<u>Hole Size</u>	<u>O. D.</u>	<u>Weight (lb/ft)</u>	<u>Grade</u>	<u>Age</u>	<u>GL Setting Depth</u>
8-3/4"	7"	20	K-55	New	120'
6-1/4"	4-1/2"	10.5	K-55	New	1,500'

Surface casing will be cemented to surface with ≈ 36 cubic feet (≈ 30 sacks) Class B + 2% CaCl_2 . Volume is based on 100% excess, yield of 1.18 cubic feet per sack, and slurry weight of 15.6 pounds per gallon. W. O. C. = 12 hours. Pressure test surface casing to 600 psi for 30 minutes.

Production casing hole will first be cleaned of rock chips by circulating at least 150% of hole volume with mud to the surface. Thirty barrels of fresh water will next be circulated. Lead with ≈ 200 cubic feet (≈ 98 sacks) Class B with 2% metasilicate (yield = 2.06 cubic feet per sack, slurry weight = 12.5 pounds per gallon). Tail with ≈ 125 cubic feet (≈ 106 sacks) of Class B with 2% CaCl_2 (yield = 1.18 cubic feet per sack, slurry weight = 15.6 pounds per gallon). Total cement volume is ≈ 325 cubic feet based on $\geq 75\%$ excess and circulating to the surface.

Production casing will have 4-1/2" cement guide shoe and self fill float collar. Float will be placed one joint above the shoe. Six centralizers will be spaced on every other joint starting above the shoe. Six turbolizers will be placed on every other joint starting from the top of the well.

NV Navajo 26 # 1
well pad and section

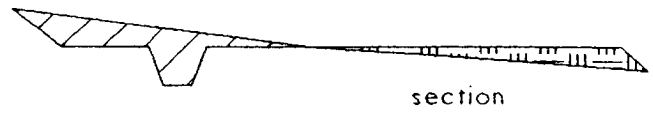
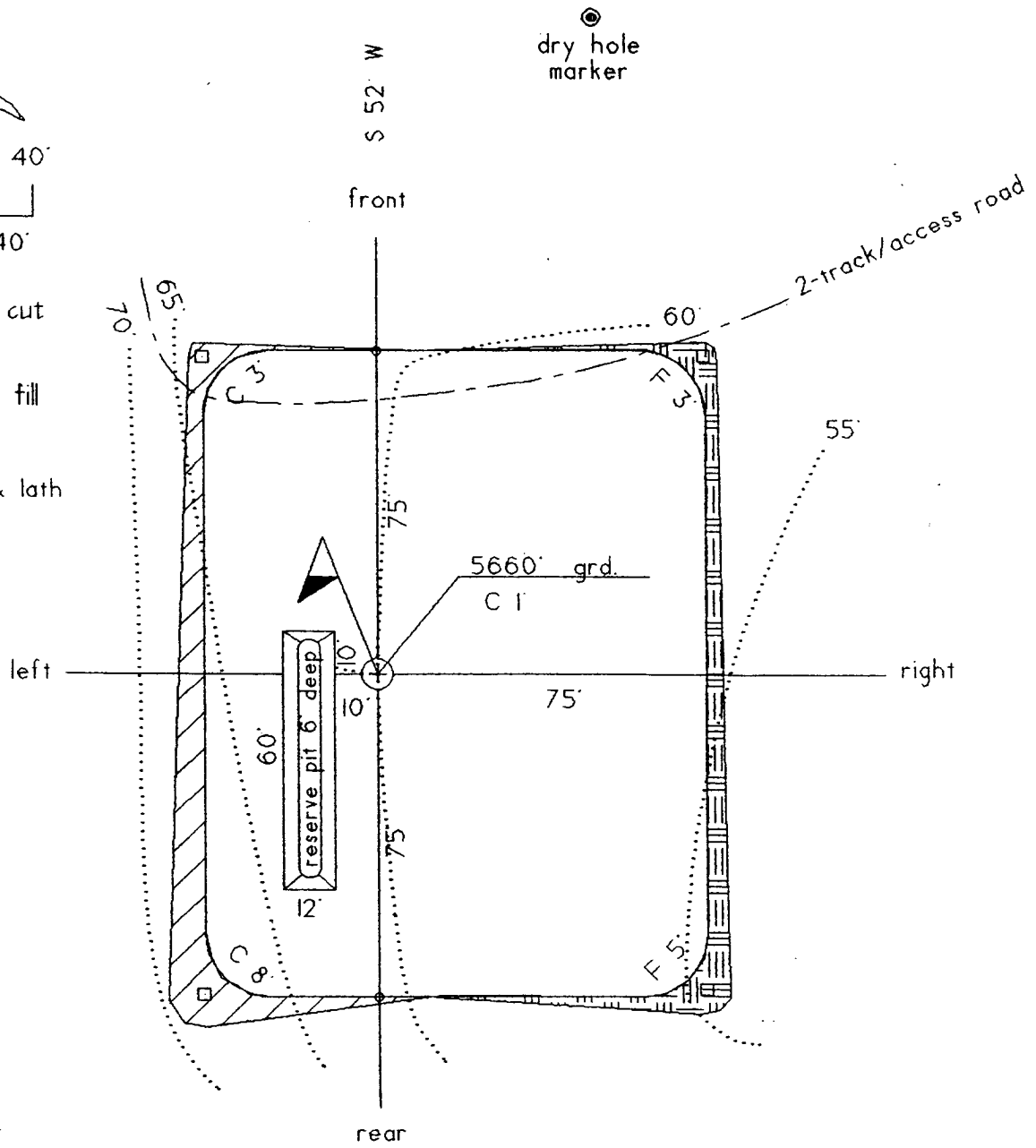
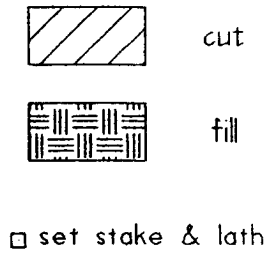
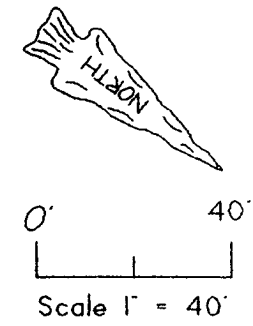

BLOW OUT PREVENTER (B.O.P.)

Notes:

1. Length of Kelly does not allow enough room for a Kelly Cock.
2. All Fittings will be screw on fitting types. (Valves, Nipples, and Ts)
3. All Fittings, this B.O.P., or equivalent, & Surface Casing will be pressure tested to 600 psi prior to drilling from surface pipe.

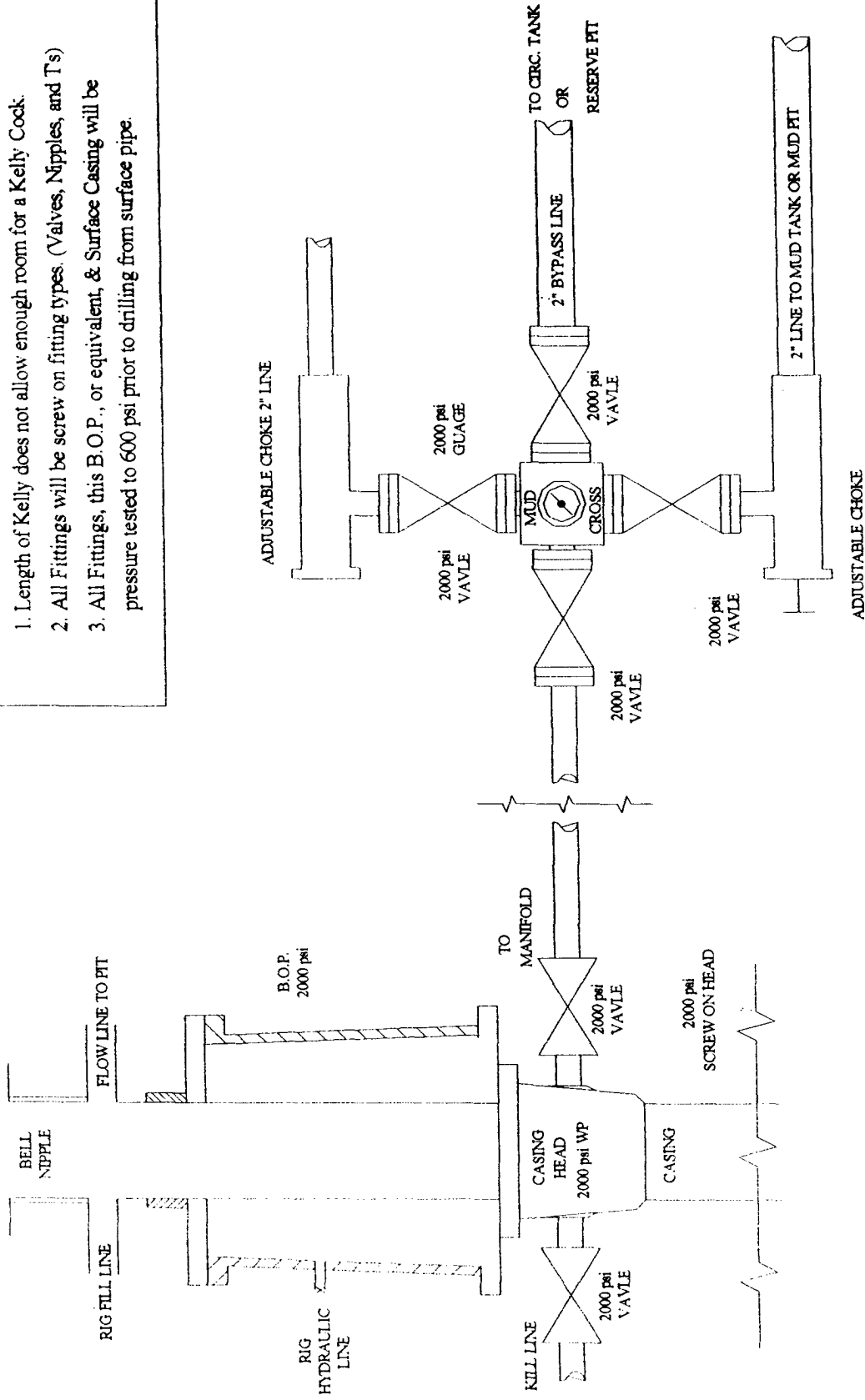

** 2000 psi Rubber hose will be used from Well Head to Manifold
& from Well Head to Kill Line.