

UNITED STATES  
DEPARTMENT OF THE INTERIOR  
BUREAU OF LAND MANAGEMENT

FORM APPROVED  
OMB No. 1004-0136  
Expires November 30, 2000

APPLICATION FOR PERMIT TO DRILL OR REENTER

5. Lease Serial No.  
SF-079289-A

6. If Indian, Allottee or Tribe Name

1a. Type of Work: ☒ DRILL ☐ REENTER

7. If Unit or CA Agreement, Name and No.

1b. Type of Well: ☐ Oil Well ☒ Gas Well ☐ Other ☐ Single Zone ☒ Multiple Zone

8. Lease Name and Well No.  
SAN JUAN 28-7 233F

2. Name of Operator  
CONOCO INC.

Contact: VICKI WESTBY  
E-Mail: Vicki.R.Westby@conoco.com

9. API Well No.  
30-039-26967

3a. Address  
10 DESTA DR., ROOM 608W  
MIDLAND, TX 79705

3b. Phone No. (include area code)  
Ph: 915.686.5799 Ext: 5799

10. Field and Pool, or Exploratory  
BLANCO MESAVERDE/BASIN DAKOTA

4. Location of Well (Report location clearly and in accordance with any State requirements.)\*

At surface NWNW 155FNL 270FWL  
At proposed prod. zone

11. Sec., T., R., M., or Blk. and Survey or Area

Sec 14 T28N R7W Mer NMP

14. Distance in miles and direction from nearest town or post office\*

12. County or Parish  
RIO ARriba

13. State  
NM

15. Distance from proposed location to nearest property or lease line, ft. (Also to nearest drig. unit line, if any)

16. No. of Acres in Lease

17. Spacing Unit dedicated to this well

320.00 N/2 OR W/2 MV

18. Distance from proposed location to nearest well, drilling, completed, applied for, on this lease, ft.

19. Proposed Depth  
7400 MD

20. BLM/BIA Bond No. on file

21. Elevations (Show whether DF, KB, RT, GL, etc.)  
6177 GL

22. Approximate date work will start

23. Estimated duration

This action is subject to technical and procedural review pursuant to 43 CFR 3165.3 and appeal pursuant to 43 CFR 3165.4

24. Attachments

DRILLING OPERATIONS AUTHORIZED ARE  
SUBJECT TO COMPLIANCE WITH ATTACHED  
"GENERAL REQUIREMENTS"

The following, completed in accordance with the requirements of Onshore Oil and Gas Order No. 1, shall be attached to this form:

1. Well plat certified by a registered surveyor.
2. A Drilling Plan.
3. A Surface Use Plan (if the location is on National Forest System Lands, the SUPO shall be filed with the appropriate Forest Service Office).

4. Bond to cover the operations unless covered by an existing bond on file (see Item 20 above).
5. Operator certification
6. Such other site specific information and/or plans as may be required by the authorized officer.

25. Signature  
(Electronic Submission)

Name (Printed/Typed)  
VICKI WESTBY

Date  
04/02/2002

Title  
AUTHORIZED SIGNATURE

Approved by (Signature)

Name (Printed/Typed)

Date

Title

Office

Application approval does not warrant or certify the applicant holds legal or equitable title to those rights in the subject lease which would entitle the applicant to conduct operations thereon.  
Conditions of approval, if any, are attached.

Title 18 U.S.C. Section 1001 and Title 43 U.S.C. Section 1212, make it a crime for any person knowingly and willfully to make to any department or agency of the United States any false, fictitious or fraudulent statements or representations as to any matter within its jurisdiction.

Additional Operator Remarks (see next page)

Electronic Submission #10185 verified by the BLM Well Information System  
For CONOCO INC., will be sent to the Farmington

\*\* DRAFT \*\* DRAFT \*\* DRAFT \*\* DRAFT \*\* DRAFT \*\* DRAFT \*\* DRAFT \*\*

NMOCD

District I  
PO Box 1980, Hobbs, NM 88241-1980

District II  
PO Drawer 00, Artesia, NM 88211-0719

District III  
1000 Rio Brazos Rd., Aztec, NM 87410

District IV  
PO Box 2088, Santa Fe, NM 87504-2088

State of New Mexico  
Energy, Minerals & Natural Resources Department

OIL CONSERVATION DIVISION  
PO Box 2088  
Santa Fe, NM 87504-2088

Form C-102

Revised February 21, 1994

Instructions on back  
Submit to Appropriate District Office  
State Lease - 4 Copies  
Fee Lease - 3 Copies

☐ AMENDED REPORT

WELL LOCATION AND ACREAGE DEDICATION PLAT

*API Number <b>30-039-26967</b>		*Pool Code 72319 / 71599	*Pool Name BLANCO MESAVERDE / BASIN DAKOTA
*Property Code <del>016600</del> <b>31739</b>		*Property Name SAN JUAN 28-7 UNIT	
*Well Number 233F			
*GRID No. 005073		*Operator Name CONOCO, INC.	
		*Elevation 6177'	

<sup>10</sup> Surface Location

UL or lot no.	Section	Township	Range	Lot Idn	Feet from the	North/South line	Feet from the	East/West line	County
D	14	28N	7W		155	NORTH	270	WEST	RIO ARriba

<sup>11</sup> Bottom Hole Location If Different From Surface

UL or lot no.	Section	Township	Range	Lot Idn	Feet from the	North/South line	Feet from the	East/West line	County

<sup>12</sup> Dedicated Acres 320.0 Acres - (N/2) <b>DK</b> <i>mp mv</i>	<sup>13</sup> Joint or Infill	<sup>14</sup> Consolidation Code	<sup>15</sup> Order No.
--------------------------------------------------------------------------------	-------------------------------	----------------------------------	-------------------------

NO ALLOWABLE WILL BE ASSIGNED TO THIS COMPLETION UNTIL ALL INTERESTS HAVE BEEN CONSOLIDATED OR A NON-STANDARD UNIT HAS BEEN APPROVED BY THE DIVISION

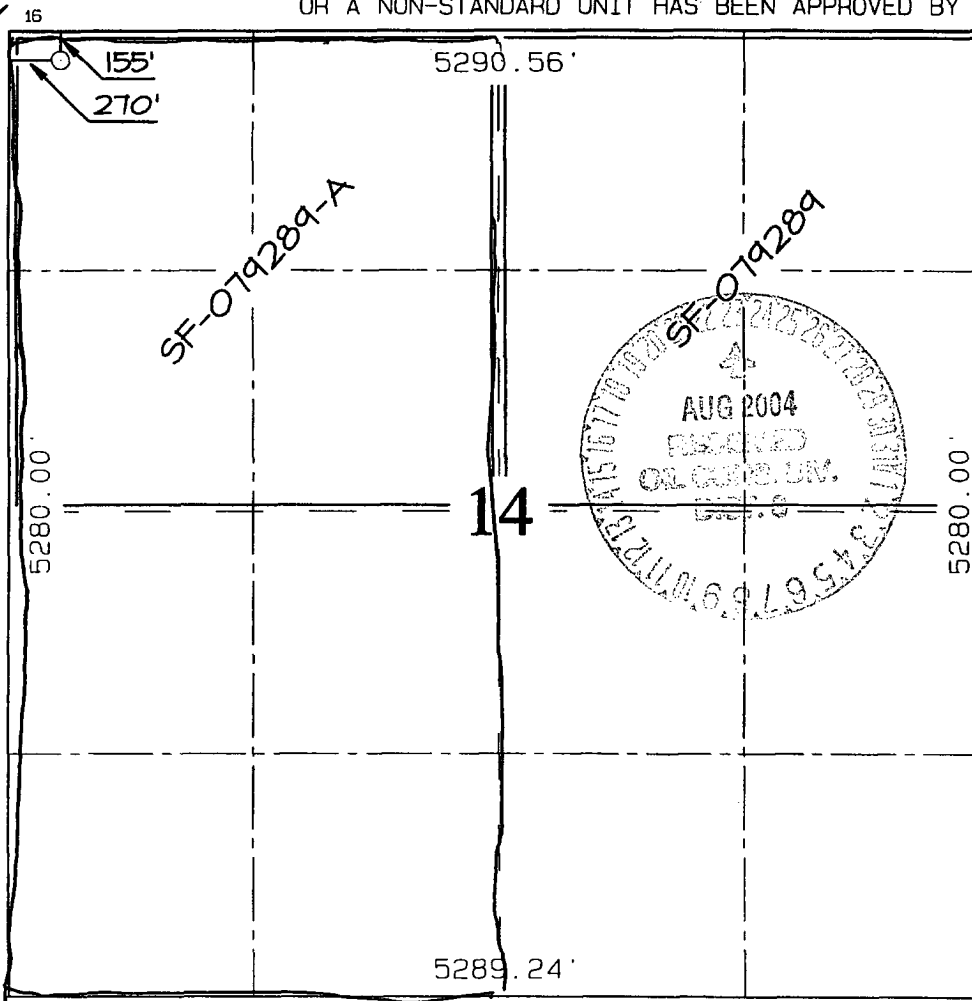

**17 OPERATOR CERTIFICATION**

I hereby certify that the information contained herein is true and complete to the best of my knowledge and belief

*Vicki Westby*  
Signature  
Vicki R. Westby

Printed Name  
Sr. Title Analyst

Title  
*March 6, 2002*  
Date

**18 SURVEYOR CERTIFICATION**

I hereby certify that the well location shown on this plat was plotted from field notes of actual surveys made by me or under my supervision, and that the same is true and correct to the best of my belief.

Survey Date: JANUARY 8, 2002

Signature and Seal of Professional Surveyor



*JASON C. EDWARDS*  
Certificate Number 15269

50' CONSTRUCTION ZONE

**\*\*SURFACE OWNER\***  
Bureau of Land  
Management

LATITUDE: 36°40'04.92"  
LONGITUDE: 107°33'01.41"  
DATUM: NAD1927

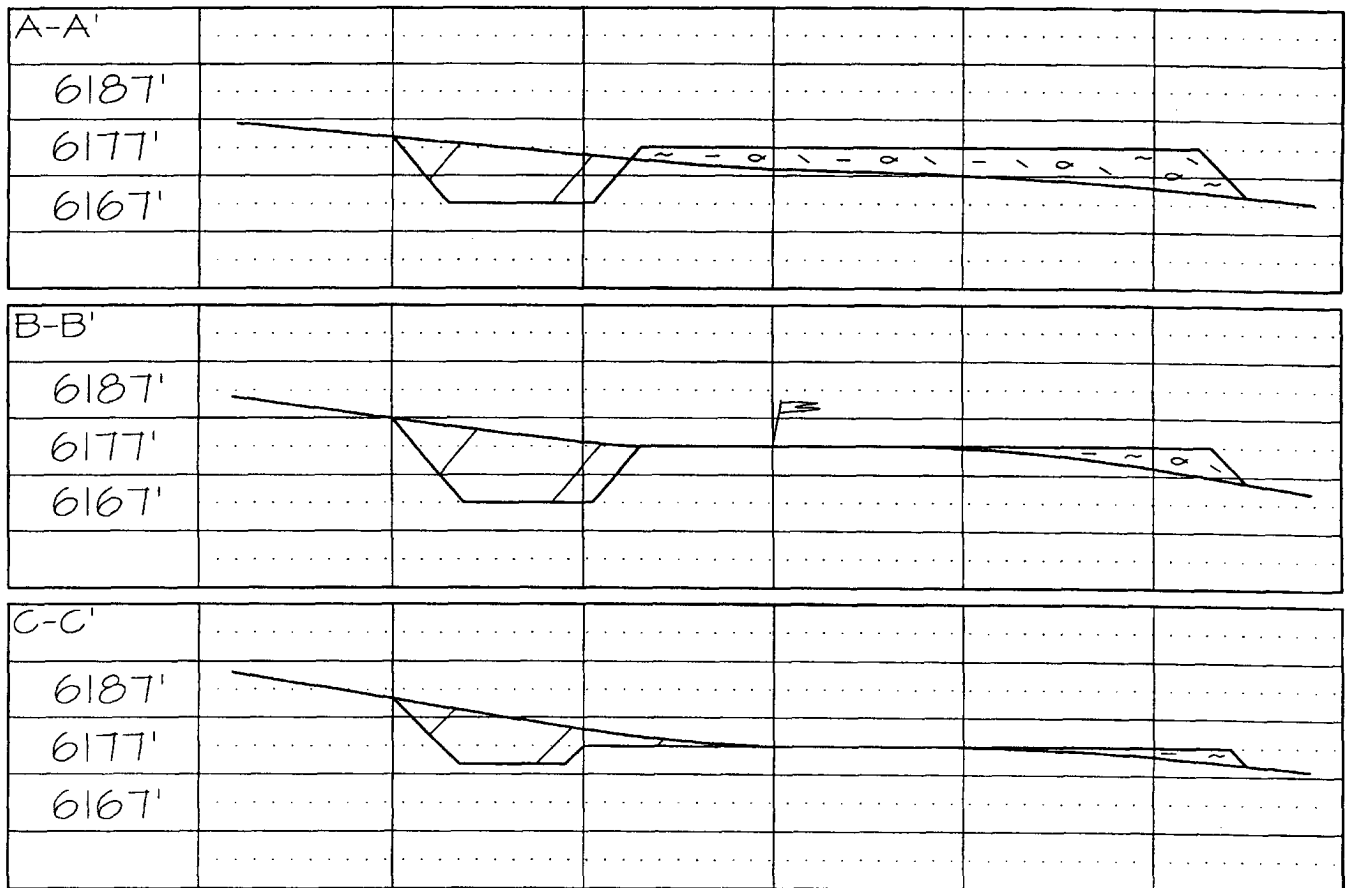

UNITED STATES  
DEPARTMENT OF THE INTERIOR  
BUREAU OF LAND MANAGEMENTFORM APPROVED  
OMB NO. 1004-0135  
Expires: November 30, 2000**SUNDRY NOTICES AND REPORTS ON WELLS**  
*Do not use this form for proposals to drill or to re-enter an  
abandoned well. Use form 3160-3 (APD) for such proposals.***SUBMIT IN TRIPLICATE - Other instructions on reverse side.**

1. Type of Well <input type="checkbox"/> Oil Well <input checked="" type="checkbox"/> Gas Well <input type="checkbox"/> Other		5. Lease Serial No. NMSF079289A
2. Name of Operator CONOCO INC		6. If Indian, Allottee or Tribe Name
3a. Address PO BOX 2197, DU 3084 HOUSTON, TX 77252-2197		7. If Unit or CA/Agreement, Name and/or No.
3b. Phone No. (include area code) Ph: 915.686.5799 Ext: 5799		8. Well Name and No. SJ 28-7 233F
4. Location of Well (Footage, Sec., T., R., M., or Survey Description) Sec 14 T28N R7W NWNW 155FNL 270FWL		9. API Well No. 30-039-26967-00-X1
		10. Field and Pool, or Exploratory BASIN DAKOTA BLANCO MESAVERDE
		11. County or Parish, and State RIO ARRIBA COUNTY, NM

**12. CHECK APPROPRIATE BOX(ES) TO INDICATE NATURE OF NOTICE, REPORT, OR OTHER DATA**

TYPE OF SUBMISSION	TYPE OF ACTION			
<input checked="" type="checkbox"/> Notice of Intent	<input type="checkbox"/> Acidize	<input type="checkbox"/> Deepen	<input type="checkbox"/> Production (Start/Resume)	<input type="checkbox"/> Water Shut-Off
<input type="checkbox"/> Subsequent Report	<input type="checkbox"/> Alter Casing	<input type="checkbox"/> Fracture Treat	<input type="checkbox"/> Reclamation	<input type="checkbox"/> Well Integrity
<input type="checkbox"/> Final Abandonment Notice	<input type="checkbox"/> Casing Repair	<input type="checkbox"/> New Construction	<input type="checkbox"/> Recomplete	<input checked="" type="checkbox"/> Other
	<input type="checkbox"/> Change Plans	<input type="checkbox"/> Plug and Abandon	<input type="checkbox"/> Temporarily Abandon	Change to Original PD
	<input type="checkbox"/> Convert to Injection	<input type="checkbox"/> Plug Back	<input type="checkbox"/> Water Disposal	

13. Describe Proposed or Completed Operation (clearly state all pertinent details, including estimated starting date of any proposed work and approximate duration thereof. If the proposal is to deepen directionally or recomplete horizontally, give subsurface locations and measured and true vertical depths of all pertinent markers and zones. Attach the Bond under which the work will be performed or provide the Bond No. on file with BLM/BIA. Required subsequent reports shall be filed within 30 days following completion of the involved operations. If the operation results in a multiple completion or recompletion in a new interval, a Form 3160-4 shall be filed once the work has been completed. Final Abandonment Notices shall be filed only after all requirements, including reclamation, have been completed, and the operator has determined that the site is ready for final inspection.)

Conoco Inc. proposes to make changes to the surface casing on the above mentioned well. The wellbore changes proposed are as follows:

Raise Permitted Surface Casing Depth to 200' as per NMOCD Minimum Required Depth for wells in San Juan Basin, NM with intermediate casing set from 3001'-5000'.

For Surface Cement change to 13.5 ppg Type III Cement + 2% bwoc Calcium Chloride + 0.25 lbs/sack Cement Slake + 3% bwoc Bentonite + 80.7% Fresh Water.

Test Surface Casing to 500 psig.

14. I hereby certify that the foregoing is true and correct.	
Electronic Submission #12927 verified by the BLM Well Information System For CONOCO INC, sent to the Farmington Committed to AFMSS for processing by Adrienne Garcia on 07/22/2002 (02AXG0376SE)	
Name (Printed/Typed) VICKI WESTBY	Title AUTHORIZED SIGNATURE
Signature (Electronic Submission)	Date 07/19/2002

**THIS SPACE FOR FEDERAL OR STATE OFFICE USE**

App: 	Title AFM	Date 8-19-04
Conditions of approval, if any, are attached. Approval of this notice does not warrant or certify that the applicant holds legal or equitable title to those rights in the subject lease which will entitle the applicant to conduct operations thereon.	Office FFO	

Title 18 U.S.C. Section 1001 and Title 43 U.S.C. Section 1212, make it a crime for any person knowingly and willfully to make to any department or agency of the United States false, fictitious or fraudulent statements or representations as to any matter within its jurisdiction.

**\*\* REVISED \*\* REVISED \*\* REVISED \*\* REVISED \*\* REVISED \*\* REVISED \*\* REVISED \*\* REVISED \*\*****NMOCD**

# PROJECT PROPOSAL - New Drill / Sidetrack



Well : SAN JUAN 28-7 233F	Lease : SAN JUAN 28-7	AFE # :		AFE \$ :
Field Name : EAST 28-7	Rig :	State : NM	County : RIO ARRIBA	API # :
Geoscientist : Glaser, Terry J	Phone : (281) 293 - 6538	Prod. Engineer : Moody, Craig E.		Phone : (281) 293 - 6559
Res. Engineer : Valvatne, Christine K.	Phone :	Proj. Field Lead : Bergman, Pat W.		Phone : (281) 293 - 6517

## Primary Objective (Zones) :

Pool	Pool Name
FRR	BASIN DAKOTA (PRORATED GAS)
RON	BLANCO MESAVERDE (PRORATED GAS)

*"Air Drilled"*

## Surface Location :

Latitude : 36.668033	Longitude : -107.5504	X :	Y :	Section : 14	Survey : 28N	Abstract : 7W
Footage X : 270 FWL	Footage Y : 155 FNL	Elevation: 6177 (FT)				

## Bottom Hole Location :

Latitude :	Longitude :	X :	Y :	Section :	Survey :	Abstract :
Location Type : Year Round	Start Date (Est.) :	Completion Date :		Date In Operation :		

Formation Data : Assume KB = 6190 Units = FT

Formation Call & Casing Points	Depth (TVD In Ft)	SS (Ft)	Depletion	BHP (PSIG)	BHT	Remarks
OJAM	2052	4138	■			Possible water flows - <i>Surface casing 9 5/8" 36" J-55 set @ 250</i>
KRLD	2170	4020	■			
FRLD	2665	3525	■			Possible gas
PCCF	2915	3275	■			
LEWS	3315	2875	■			7", 20 ppf, J-55, STC Casing. Circulate cement to surface.
Intermediate Casing	3415	2775	■			7", 20 ppf, J-55, STC Casing. Circulate cement to surface.
CHRA	3850	2340	■			
CLFH	4560	1630	■	1300		Gas; possibly wet
MENF	4725	1465	■			Gas
PTLK	5095	1095	■			Gas
MNCS	5345	845	■			
GLLP	6365	-175	■			
GRHN	7050	-860	■			Gas possible, highly fractured
TWLS	7150	-960	■			Gas
CBBO	7270	-1080	■			Gas
Total Depth	7400	-1210	■	3000		4 1/2", 10.5 ppf, J-55, STC casing. Circulate cement a minimum of 100' inside the previous casing string. No open hole logs. Cased hole TDT with GR to surface.

# PROJECT PROPOSAL - New Drill / Sidetrack



--	--	--	--	--	--	--

## Logging Program :

Intermediate Logs :

☐ Log only if show   ☐ GR / ILD   ☐ Triple Combo

TD Logs :

☐ Triple Combo   ☐ Dipmeter   ☐ RFT   ☐ Sonic   ☐ VSP   ☒ TDT

Additional Information :

Logging company to provide a sketch with all lengths, OD's & ID's of all tools prior to running in the hole.

Cased hole TDT with GR to surface.

Comments :



Well: San Juan 28-7 233F  
County: San Juan  
Area: East 28-1  
Rig: Key Rig 43

Company: Conoco, Inc.  
Engineer: Mr. Tom Schaefer  
Date: 27-Mar-02

**Surface Casing:**

	139	sx	Type III Cement + 2%bwoc Calcium Chloride + 0.25 lbs/sk Cello Flake + 59.2% H2O
	<i>Circulate cement</i>		
Slurry Weight:	14.5	ppg	
Slurry Yield	1.41	cf/sk	
Amount of Mix Water	6.67	gps	
Pump Time	2:30		
Compressives			
8 hrs @ 80 F	800	psi	
24 hrs @ 80 F	2150	psi	
48 hrs @ 80 F	3625	psi	

**Intermediate Casing:**

	529	sx	Premium Lite Cement + 2% bwoc Calcium Chloride + 0.25 lbs/sc Cello Flake + 8% bwoc Bentonite + 115.5% H2O		
	<i>Circulate cement</i>				
Slurry 1	89	sx	Type III Cement + 2% bwoc Calcium Chloride + 0.25 lbs/sk Cello Flake + 59.2% H2O		
<b>Slurry 1</b>			<b>Slurry 2</b>		
Slurry Weight:	12.1	ppg	Slurry Weight:	14.5	ppg
Slurry Yield	2.23	cf/sk	Slurry Yield	1.41	cf/sk
Amount of Mix Water	12.05	gps	Amount of Mix Water	6.67	gps
Pump Time	3:00		Pump Time	2:15	
Compressives			Compressives		
8 hrs @ 80 F		psi	8 hrs @ 80 F	800	psi
24 hrs @ 80 F	250	psi	24 hrs @ 80 F	2150	psi
48 hrs @ 80 F	525	psi	48 hrs @ 80 F	3625	psi

**Production Casing:**

	361	sx	Premium Lite High Strength + 0.25 lbs/sk Cello Flake + .2% bwoc CD-32 + 0.65% bwoc FL-62 + 105.4% H2O
Slurry Weight:	12.5	ppg	
Slurry Yield	2.02	cf/sk	
Amount of Mix Water	11	gps	
Pump Time	3:00		
Compressives			
8 hrs @ 140 F		psi	
24 hrs @ 140 F	1600	psi	
48 hrs @ 140 F	2000	psi	

THIS SECTION, OR ANY PART THEREOF, MAY BE PLACED OUTSIDE OF SUB-STRUCTURE, IF DESIRED. USE LOW RADIUS BENDS. PIPE USED FOR EXTENSION SHOULD BE SHOP MADE WITH NO REAMED CONNECTIONS AND PRESSURE TESTED INITIALLY TO SAME TEST PRESSURE AS THE CHOKER MANIFOLD.

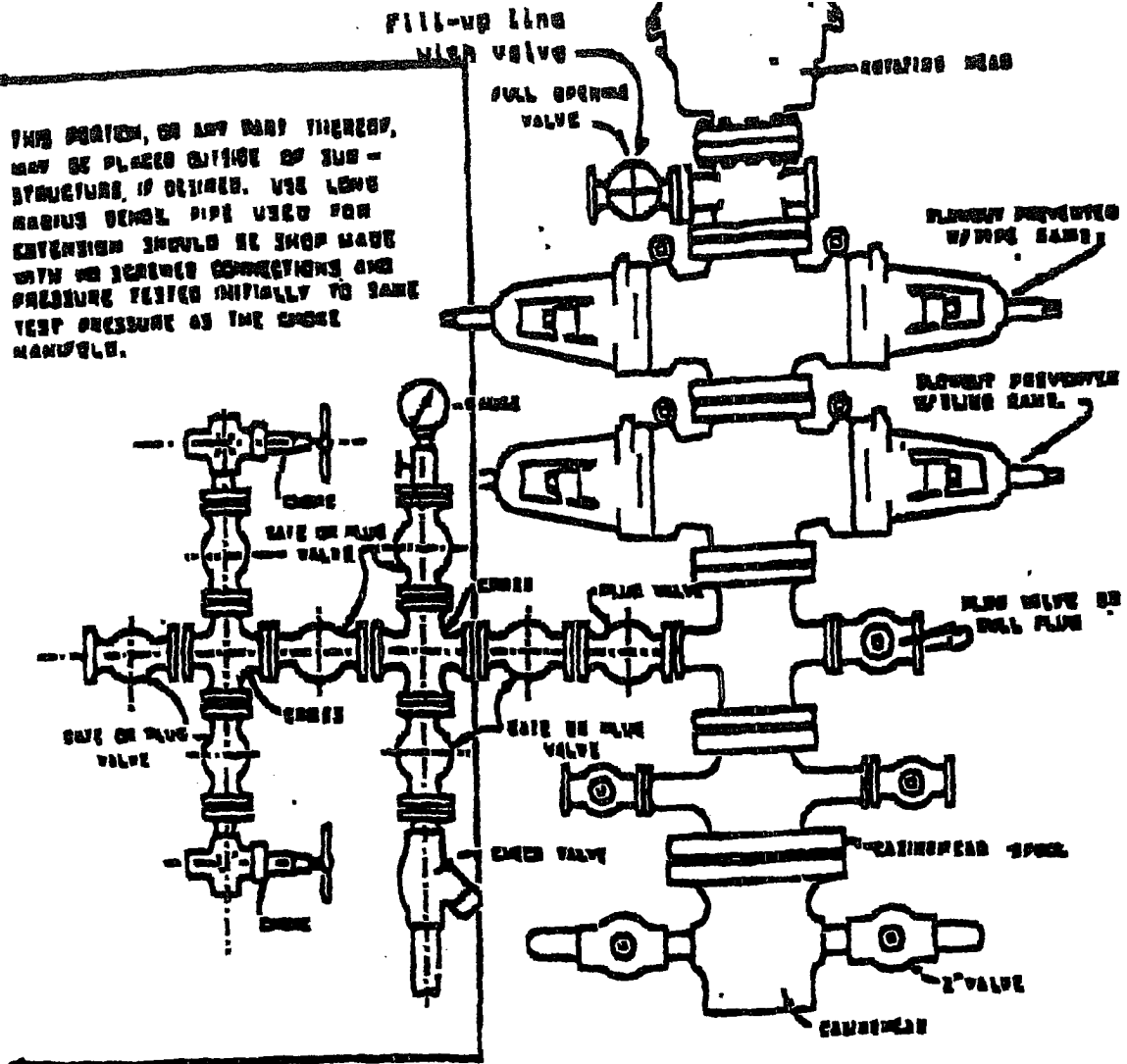

### BLOWOUT PREVENTER HOOKUP

Drilling contractors used in the San Juan Basing supply 3000 psi equipment, but cannot provide annular preventors because of sub-structure limitations. Maximum anticipated surface pressures for this well will not exceed the working pressure of the proposed BOP system. Please see the attached BOP diagram details 2000 psi equipment according to Onshore Order No. 2 even though the equipment will test to 3000 psi. The 2000 psi system allows deletion of the annular preventor and fulfills your requirements (note diagram No. 1). In addition, the following equipment will comprise the 2000 psi system:

1. Two rams with one blind and one pipe ram.
2. Kill line (2 inch maximum).
3. One kill line valve.
4. One choke line valve.
5. Two chokes (reference diagram No. 1).
6. Upper kelly cock valve with handle.
7. Safety valve and subs to fit all drill strings in use.
8. Two-inch minimum choke line.
9. Pressure gauge on choke manifold.
10. Fill-up line above the upper most preventor.
11. Rotating head.



# Cathodic Protection System Description

<b>Anode Bed Type</b>	Deep Well	
<b>Hole Size</b>	8"	
<b>Hole Depth</b>	200' - 500'	As required to place anodes below moisture and in low resistance strata.
<b>Surface Casing</b>	8" Diam., $\geq$ 20' Length. Cemented In Annular Space	When needed, casing will be installed at an adequate depth to control ground water flow. Casing will extend a minimum of 2' above grade, be surrounded by a concrete pad, and sealed with a PVC cap. Steel casing will be substituted when boulders are encountered.
<b>Vent Pipe</b>	1" Diam. PVC	Vent pipe will extend from bottom of hole, through top of casing cap, and sealed with a 1" perforated PVC cap.
<b>Type Of Anodes</b>	Cast Iron Or Graphite	
<b>Number Of Anodes</b>	8 - 20	Sufficient quantity to achieve a total anode bed resistance of $< 1$ ohm and a design life $\geq$ 20 years.
<b>Anode Bed Backfill</b>	Lorasco SW Calcined Petroleum Coke Breeze	Installed from bottom of hole to 10' above top anode.
<b>Anode Junction Box</b>	8 - 20 Circuit Fiberglass Or Metal	Sealed to prevent insect & rodent intrusion.
<b>Current Splitter Box</b>	2 - 5 Circuit Metal	Sealed to prevent insect & rodent intrusion.
<b>DC / AC Cable</b>	DC: #2, #4, #6, #8 Stranded Copper (One Size Or Any Combination Of) With High Molecular Weight Polyethylene (HMWPE) Insulation.  AC: #8 Stranded Copper HMWPE	18" depth in typical situation, 24" depth in roadway, & 36" depth in arroyos and streams. EXCEPTION: If trenching is in extremely hard substratum, depth will be 8 - 12" with cable installed in conduit. Installed above foreign pipelines if 1' clearance is available. If not, installed under foreign pipeline with 1' clearance (AC cable always installed under foreign pipeline in conduit).
<b>Power Source</b>	1) Rectifier 2) Solar Power Unit 3) Thermoelectric Generator	Choice of power source depending on availability of AC & other economic factors.
<b>External Painting</b>	Color to be selected according to BLM specifications.	Paint applied to any surface equipment associated with the CP system which can reasonably be painted.