

Submit 5 Copies to Appropriate District Office
District I
1625 N. French Dr., Hobbs, NM 88240
District II
1301 W. Grand Ave., Artesia, NM 88210
District III
1000 Rio Brazos Rd., Aztec, NM 87410
District IV
1220 S. St. Francis Dr., Santa Fe, NM 87505

State of New Mexico
Energy, Minerals and Natural Resources

Form C-103
May 27, 2004

OIL CONSERVATION DIVISION
1220 South St. Francis Dr.
Santa Fe, NM 87505

WELL API NO. 30-045-30532
5. Indicate Type of Lease STATE <input type="checkbox"/> FEE <input type="checkbox"/>
6. State Oil & Gas Lease No. N/A
7. Lease Name or Unit Agreement Name Campbell
8. Well Number 26-2
9. OGRID Number 025773
10. Pool name or Wildcat West Kutz Gallup

SUNDRY NOTICES AND REPORTS ON WELLS
(DO NOT USE THIS FORM FOR PROPOSALS TO DRILL OR TO DEEPEN OR PLUG BACK TO A DIFFERENT RESERVOIR. USE "APPLICATION FOR PERMIT" (FORM C-101) FOR SUCH PROPOSALS.)

1. Type of Well: Oil Well ☐ Gas Well ☒ Other

2. Name of Operator
Dominion Oklahoma Texas Exploration & Production, Inc.

3. Address of Operator
P.O. Box 370, Carlsbad, New Mexico 88221

4. Well Location

Unit Letter A : 990 feet from the North line and 990 feet from the East line
Section 26 Township 27N Range 12W NMPM County San Juan

11. Elevation (Show whether DR, RKB, RT, GR, etc.)
5937 ungraded

Pit or Below-grade Tank Application ☒ or Closure ☐

Pit type Reserve Depth to Groundwater 600' Distance from nearest fresh water well 1500'+ Distance from nearest surface water 5 miles

Pit Liner Thickness: 12 mil Below-Grade Tank: Volume _____ bbls; Construction Material Soil

12. Check Appropriate Box to Indicate Nature of Notice, Report or Other Data

NOTICE OF INTENTION TO:

PERFORM REMEDIAL WORK ☐ PLUG AND ABANDON ☐
TEMPORARILY ABANDON ☐ CHANGE PLANS ☐
PULL OR ALTER CASING ☐ MULTIPLE COMPL ☐

OTHER: Permit Reserve pit construction ☒

SUBSEQUENT REPORT OF:

REMEDIAL WORK ☐ ALTERING CASING ☐
COMMENCE DRILLING OPNS. ☐ P AND A ☐
CASING/CEMENT JOB ☐

OTHER: ☐

13. Describe proposed or completed operations. (Clearly state all pertinent details, and give pertinent dates, including estimated date of starting any proposed work). SEE RULE 1103. For Multiple Completions: Attach wellbore diagram of proposed completion or recompletion.

Reserve Pit shown on attached schematic



I hereby certify that the information above is true and complete to the best of my knowledge and belief. I further certify that any pit or below-grade tank has been/will be constructed or closed according to NMOCD guidelines ☐, a general permit ☐ or an (attached) alternative OCD-approved plan ☐.

SIGNATURE Gene Simer TITLE District Operations Manager DATE 9-20-04

Type or print name Gene Simer
For State Use Only

E-mail address:

Telephone No. (505) 885-1313

APPROVED BY: Denny Furt TITLE SENIOR OIL & GAS INSPECTOR, DIST. 9 DATE SEP 21 2004

Conditions of Approval (if any):

Location Layout for Gary Nail Drilling Rig

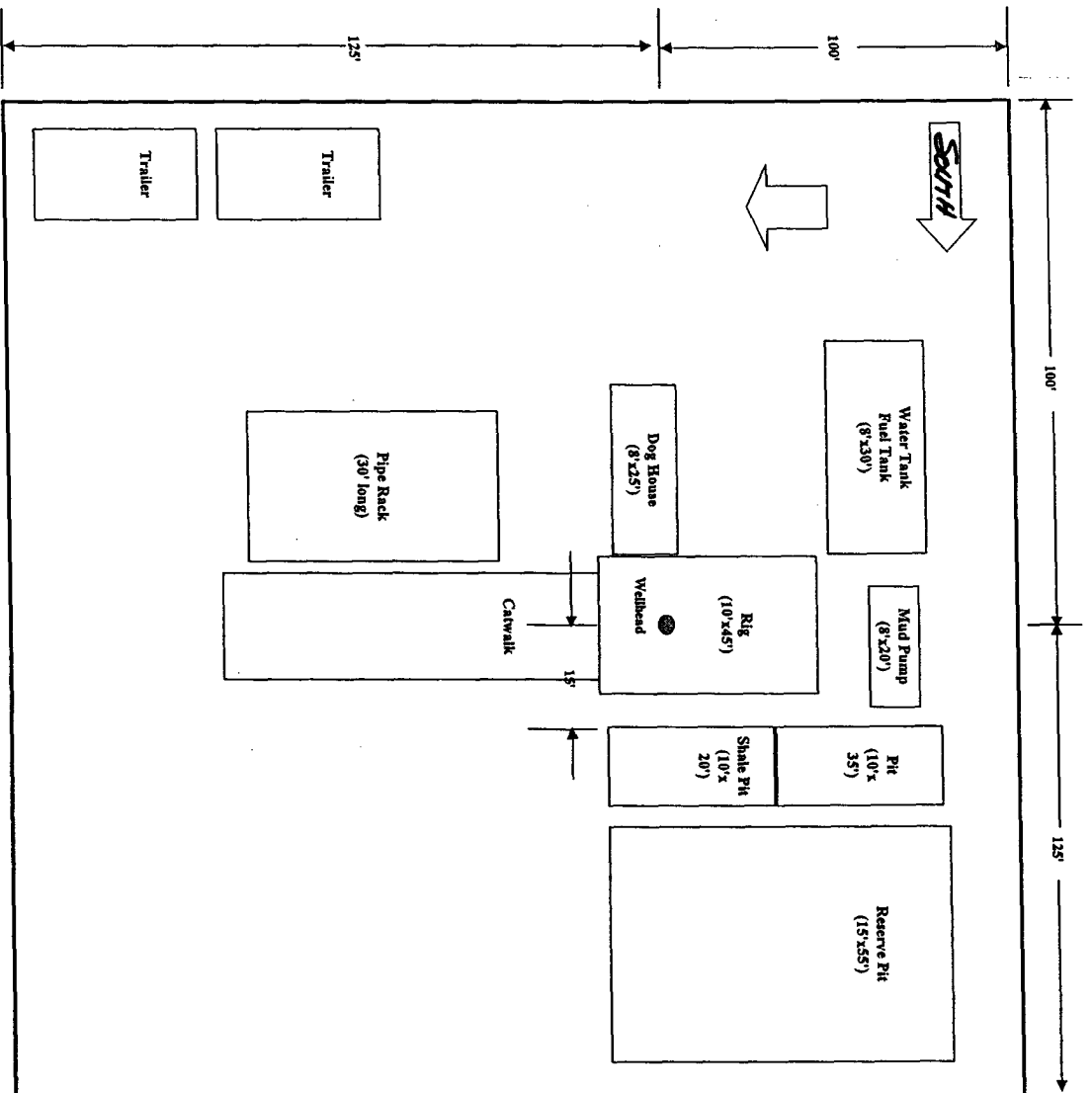

Wellhead to East Location Boundary

- 15 to shale pit
- 10 shale pit
- 10 between pits
- 15 Reserve Pit
- 10 extra
- 10 extra
- 70 Minimum distance

Wellhead to South Location Boundary

- 20 Floor & pipe racks
- 35 V-door & cartwalk
- 40 Traffic access
- 95 Minimum distance

Wellhead to West Location Boundary

- 5 Work floor
- 5 rig to water tank
- 30 Water tank
- 50 Access & trailers
- 90 Minimum distance

Wellhead to North Location Boundary

- 50 Reserve has 5'
- 40 Access to Pit / Water / Fuel tanks
- 90 Minimum distance