

DISTRICT II
811 South First St., Artesia, NM 88210-2835

OIL CONSERVATION DIVISION

2040 S. Pacheco
Santa Fe, New Mexico 87505-6429

APPROVAL PROCESS:

☒ Administrative ☐ Hearing

DISTRICT III
1000 Rio Brazos Rd, Aztec, NM 87410-1693

APPLICATION FOR DOWNHOLE COMMINGLING

EXISTING WELLBORE

☒ YES ☐ NO

REDWOLF PRODUCTION, INC.		P.O. BOX 5382		FARMINGTON, NM 87499	
Operator		Address			
CROCKETT		NO. 1		N-25-T26N-R12W	
Lease		Well No.		Unit Ltr. - Sec - Twp - Rge	
				SAN JUAN	
				County	
Spacing Unit Lease Types: (check 1 or more)					
OGRID NO. 018973 Property Code 23356 API NO. 30-045-29604 Federal <input checked="" type="checkbox"/> State <input type="checkbox"/> (and/or) Fee <input type="checkbox"/>					

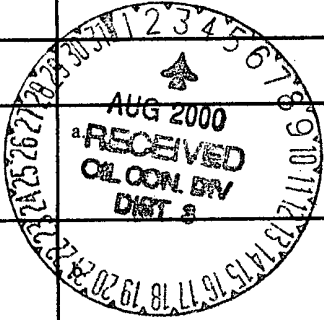
The following facts are submitted in support of downhole commingling:	Upper Zone	Intermediate Zone	Lower Zone
1. Pool Name and Pool Code	Basin Fruitland Coal 71629		WAW Pictured Cliffs 87190
2. Top and Bottom of Pay Section (Perforations)	1210' - 1230'		1238' - 1243'
3. Type of Production (Oil or Gas)	Gas		Gas
4. Method of Production (Flowing or Artificial Lift)	Pumping		Pumping
5. Bottomhole Pressure Oil Zones - Artificial Lift: Estimated Current Gas & Oil - Flowing: Measured Current All Gas Zones: Estimated Or Measured Original	a. (Current) 250 EST. b. (Original) 450 EST.		a. 250 EST. b. 450 EST.
6. Oil Gravity (° API) or Gas BTU Content	1027		1027
7. Producing or Shut-In?	SI		SI
Production Marginal? (yes or no)	YES		YES
• If Shut-In, give date and oil/gas/water rates of last production Note: For new zones with no production history, applicant shall be required to attach production estimates and supporting data • If Producing, give date and oil/gas/water rates of recent test (within 90 days)	Date: 7/20/00 Rates: 75 MCFD 1 BWPD	Date: Rates:	Date: 6/20/00 Rates: 50 MCFD 1 BWPD
8. Fixed Percentage Allocation Formula - % for each zone	Oil: _____ Gas: 60 %	Oil: _____ Gas: _____	Oil: _____ Gas: 40 %

9. If allocation formula is based upon something other than current or past production, or is based upon some other method, submit attachments with supporting data and/or explaining method and providing rate projections or other required data.
10. Are all working, overriding, and royalty interests identical in all commingled zones? ☒ Yes ☐ No
If not, have all working, overriding, and royalty interests been notified by certified mail? ☐ Yes ☐ No
Have all offset operators been given written notice of the proposed downhole commingling? ☒ Yes ☐ No
11. Will cross-flow occur? ☐ Yes ☒ No If yes, are fluids compatible, will the formations not be damaged, will any cross-flowed production be recovered, and will the allocation formula be reliable. ☐ Yes ☐ No (If No, attach explanation)
12. Are all produced fluids from all commingled zones compatible with each other? ☒ Yes ☐ No
13. Will the value of production be decreased by commingling? ☐ Yes ☒ No (If Yes, attach explanation)
14. If this well is on, or communitized with, state or federal lands, either the Commissioner of Public Lands or the United States Bureau of Land Management has been notified in writing of this application. ☒ Yes ☐ No
15. NMOC Reference Cases for Rule 303(D) Exceptions: ORDER NO(S) _____
16. ATTACHMENTS:
- * C-102 for each zone to be commingled showing its spacing unit and acreage dedication.
 - * Production curve for each zone for at least one year. (If not available, attach explanation.)
 - * For zones with no production history, estimated production rates and supporting data.
 - * Data to support allocation method or formula.
 - * Notification list of all offset operators.
 - * Notification list of working, overriding, and royalty interests for uncommon interest cases.
 - * Any additional statements, data, or documents required to support commingling.

I hereby certify that the information above is true and complete to the best of my knowledge and belief.

SIGNATURE Dana L. Delventhal TITLE Vice President DATE 7/28/00
TYPE OR PRINT NAME DANA L. DELVENTHAL TELEPHONE NO. (505) 326-4125

DISTRICT II
P.O. Drawer DD, Artesia, N.M. 88211-0710

DISTRICT III
1000 Rio Grande Rd., Artesia, N.M. 87410

DISTRICT IV
PO Box 2088, Santa Fe, NM 87504-2088

OIL CONSERVATION DIVISION
P.O. Box 2088
Santa Fe, NM 87504-2088

Revised February 21, 1964
Instructions on back
Submit to Appropriate District Office
State Lease - 4 Copies
Fee Lease - 3 Copies

☐ AMENDED REPORT

200 JUN -7 PM 12:22

WELL LOCATION AND ACREAGE DEDICATION PLAT

*API Number 30-045-29604		*Pool Code 71629/87190	*Pool Name Basin Fruitland Coal / SAND, PC
*Property Code 23356	*Property Name CROCKETT		*Well Number 1
*OGED No. 018973	*Operator Name REDWOLF PRODUCTION, INC.		*Elevation 6197

¹⁰ Surface Location

UL or lot no. N	Section 25	Township 26N	Range 12W	Lot Idn	Feet from the 990	North/South line SOUTH	Feet from the 1650	East/West line WEST	County SAN JUAN
--------------------	---------------	-----------------	--------------	---------	----------------------	---------------------------	-----------------------	------------------------	--------------------

¹¹ Bottom Hole Location If Different From Surface

UL or lot no.	Section	Township	Range	Lot Idn	Feet from the	North/South line	Feet from the	East/West line	County
---------------	---------	----------	-------	---------	---------------	------------------	---------------	----------------	--------

¹² Dedicated Acres 320/160	¹³ Joint or Infill N	¹⁴ Consolidation Code	¹⁵ Order No.
--	------------------------------------	----------------------------------	-------------------------

NO ALLOWABLE WILL BE ASSIGNED TO THIS COMPLETION UNTIL ALL INTERESTS HAVE BEEN CONSOLIDATED
OR A NON-STANDARD UNIT HAS BEEN APPROVED BY THE DIVISION

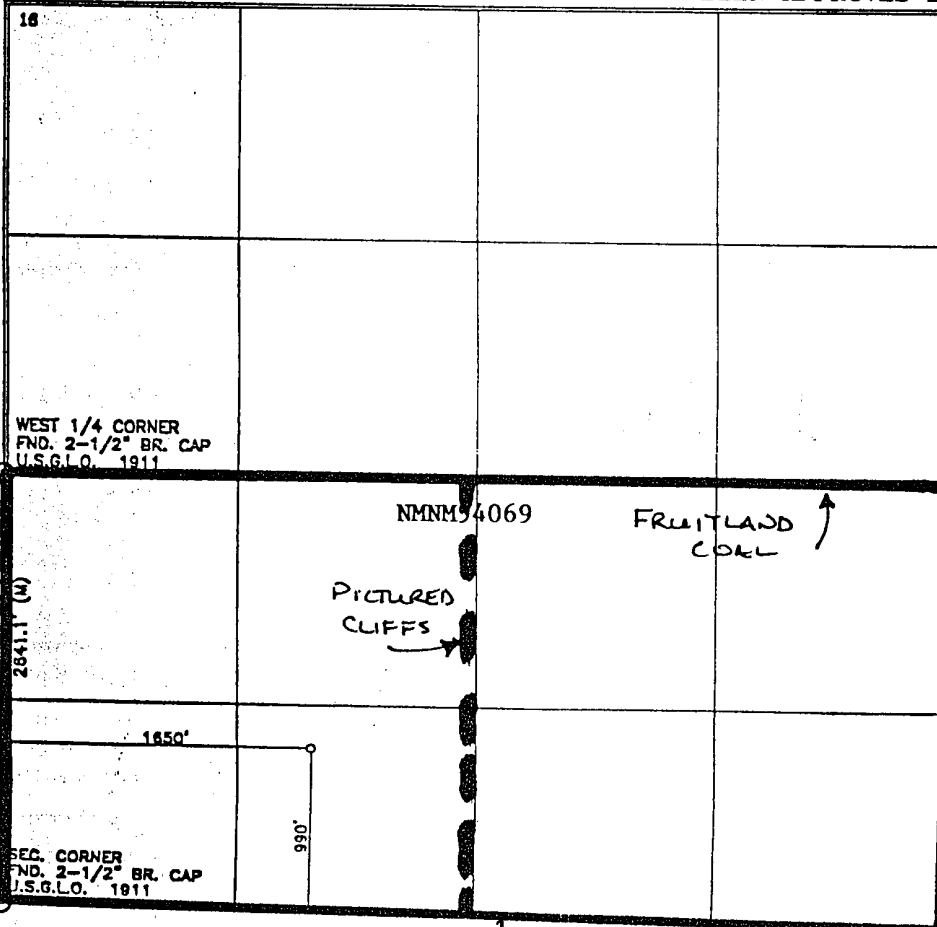

¹⁷ OPERATOR CERTIFICATION

I hereby certify that the information contained herein is true and complete to the best of my knowledge and belief.

~~CONFIDENTIAL~~

Bruce E. Delventhal
Signature
Bruce E. Delventhal
Printed Name
President
Title
June 3, 1997
Date

¹⁸ SURVEYOR CERTIFICATION

I hereby certify that the well location shown on this plat was plotted from field notes of actual surveys made by me or under my supervision, and that the same are correct to the best of my belief.

Date of Survey
Signature and Seal of Registered Professional Land Surveyor
ROY A. RUSH
NEW MEXICO
8894
REGISTERED PROFESSIONAL LAND SURVEYOR
8894
Certificate Number