

UNITED STATES
DEPARTMENT OF THE INTERIOR
BUREAU OF LAND MANAGEMENT

APPLICATION FOR PERMIT TO DRILL OR DEEPEN

1a. TYPE OF WORK

DRILL ☒DEEPEN ☐

b. TYPE OF WELL

OIL
WELL ☐GAS
WELL ☒OTHER ☐SINGLE
ZONE ☒MULTIPLE
ZONE ☐

2. NAME OF OPERATOR

Richardson Operating Co. (303) 830-8000

3. ADDRESS AND TELEPHONE NO.

1700 Lincoln St., Suite 1700, Denver, Co. 80203

4. LOCATION OF WELL (Report location clearly and in accordance with any State requirements.)*

At surface

240' FNL & 1940' FWL

At proposed prod. zone Same

14. DISTANCE IN MILES AND DIRECTION FROM NEAREST TOWN OR POST OFFICE*

5 air miles SW of Farmington

15. DISTANCE FROM PROPOSED*

LOCATION TO NEAREST

PROPERTY OR LEASE LINE, FT.
(Also to nearest drlg. unit line, if any)

240'

16. NO. OF ACRES IN LEASE

1,440

17. NO. OF ACRES ASSIGNED
TO THIS WELL

160 NW

18. DISTANCE FROM PROPOSED LOCATION*
TO NEAREST WELL, DRILLING, COMPLETED,
OR APPLIED FOR, ON THIS LEASE, FT.

210'

19. PROPOSED DEPTH

1,200'

20. ROTARY OR CABLE TOOLS

Rotary

21. ELEVATIONS (Show whether DF, RT, GR, etc.)

5,600' ungraded

22. APPROX. DATE WORK WILL START*

Upon Approval

23.

PROPOSED CASING AND CEMENTING PROGRAM

SIZE OF HOLE	GRADE, SIZE OF CASING	WEIGHT PER FOOT	SETTING DEPTH	QUANTITY OF CEMENT
8-3/4"	K-55 7"	20	120'	~36 cu. ft. & to surface
6-1/4"	K-55 4-1/2"	10.5	1,200'	~220 cu. ft. & to surface

This action is subject to technical and
procedural review pursuant to 43 CFR 3165.3,
and appeal pursuant to 43 CFR 3165.4.DRILLING OPERATIONS AUTHORIZED ARE
SUBJECT TO COMPLIANCE WITH ATTACHED
"GENERAL REQUIREMENTS"

cc: BIA, BLM, Kenson, NAPI, OCD (via BLM), Tribe, Van Blaricom

IN ABOVE SPACE DESCRIBE PROPOSED PROGRAM: If proposal is to deepen, give data on present productive zone and proposed new productive zone. If proposal is to drill or deepen directionally, give pertinent data on subsurface locations and measured and true vertical depths. Give blowout preventer program, if any.

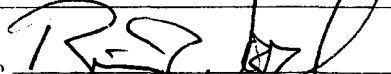
24.  Consultant (505) 466-8120 3-14-02

SIGNED

TITLE

DATE

(This space for Federal or State office use)

PERMIT NO.

APPROVAL DATE

Application approval does not warrant or certify that the applicant holds legal or equitable title to those rights in the subject lease which would entitle the applicant to conduct operations thereon.
CONDITIONS OF APPROVAL, IF ANY:

APPROVED BY

TITLE

DATE

10-13-04

*See Instructions On Reverse Side

NMOCD

Title 18 U.S.C. Section 1001, makes it a crime for any person knowingly and willfully to make to any department or agency of the United States any false, fictitious or fraudulent statements or representations as to any matter within its jurisdiction.

State of New Mexico
Energy, Minerals & Mining Resources Department
OIL CONSERVATION DIVISION
2040 South Pacheco
Santa Fe, NM 87505

Form C - 102

☐ AMENDED REPORT

WELL LOCATION AND ACREAGE DEDICATION PLAT

APA Number 3006531038	Pool Code 79680	Pool Name WEST KUTZ PC EXT.
Property Code 34360	Property Name NV NAVAJO 28	Well Number 2
OGRID No. 019219	Operator Name RICHARDSON OPERATING COMPANY	Elevation 5600'

Surface Location									
UL or Lot C	Sec. 28	Twp. 29 N.	Rge. 14 W.	Lot Idn.	Feet from 240'	North/South NORTH	Feet from 1940'	East/West WEST	County SAN JUAN

Bottom Hole Location If Different From Surface									
UL or Lot	Sec.	Twp.	Rge.	Lot Idn.	Feet from	North/South	Feet from	East/West	County

Dedication	Joint ?	Consolidation	Order No. NSL-4783
------------	---------	---------------	------------------------------

NO ALLOWABLE WILL ASSIGNED TO THIS COMPLETION UNTIL ALL INTERESTS HAVE BEEN CONSOLIDATED
OR A NON-STANDARD UNIT HAS BEEN APPROVED BY THE DIVISION

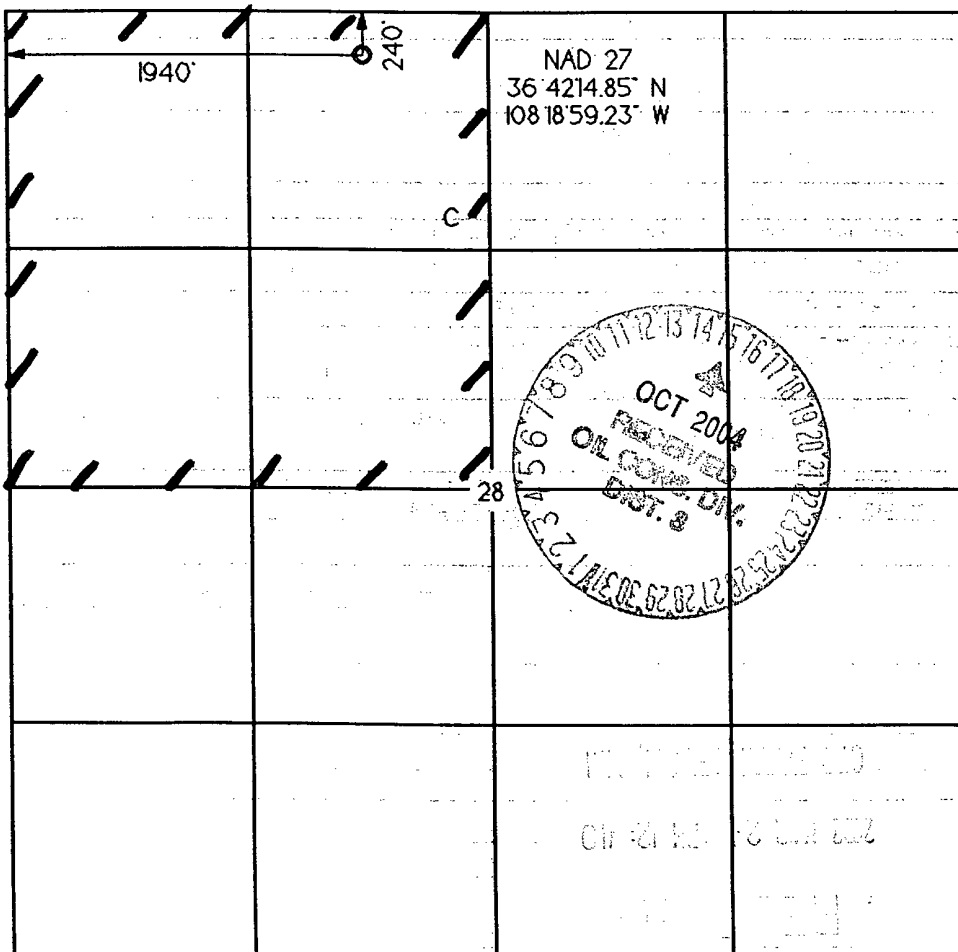

OPERATOR CERTIFICATION I hereby certify that the information contained herein is true and complete to the best of my knowledge and belief. Signature <i>Brian Wood</i> Printed Name BRIAN WOOD Title CONSULTANT Date MAR. 14, 2002	
SURVEYOR CERTIFICATION I hereby certify that the well location on this plat was plotted from field notes of actual surveys made by me or under my supervision, and that the same is true and correct to the best of my belief. Date of Survey 01-17-02 Signature and Seal of Professional Surveyor 	

Navajo 28 # 2
well pad and section

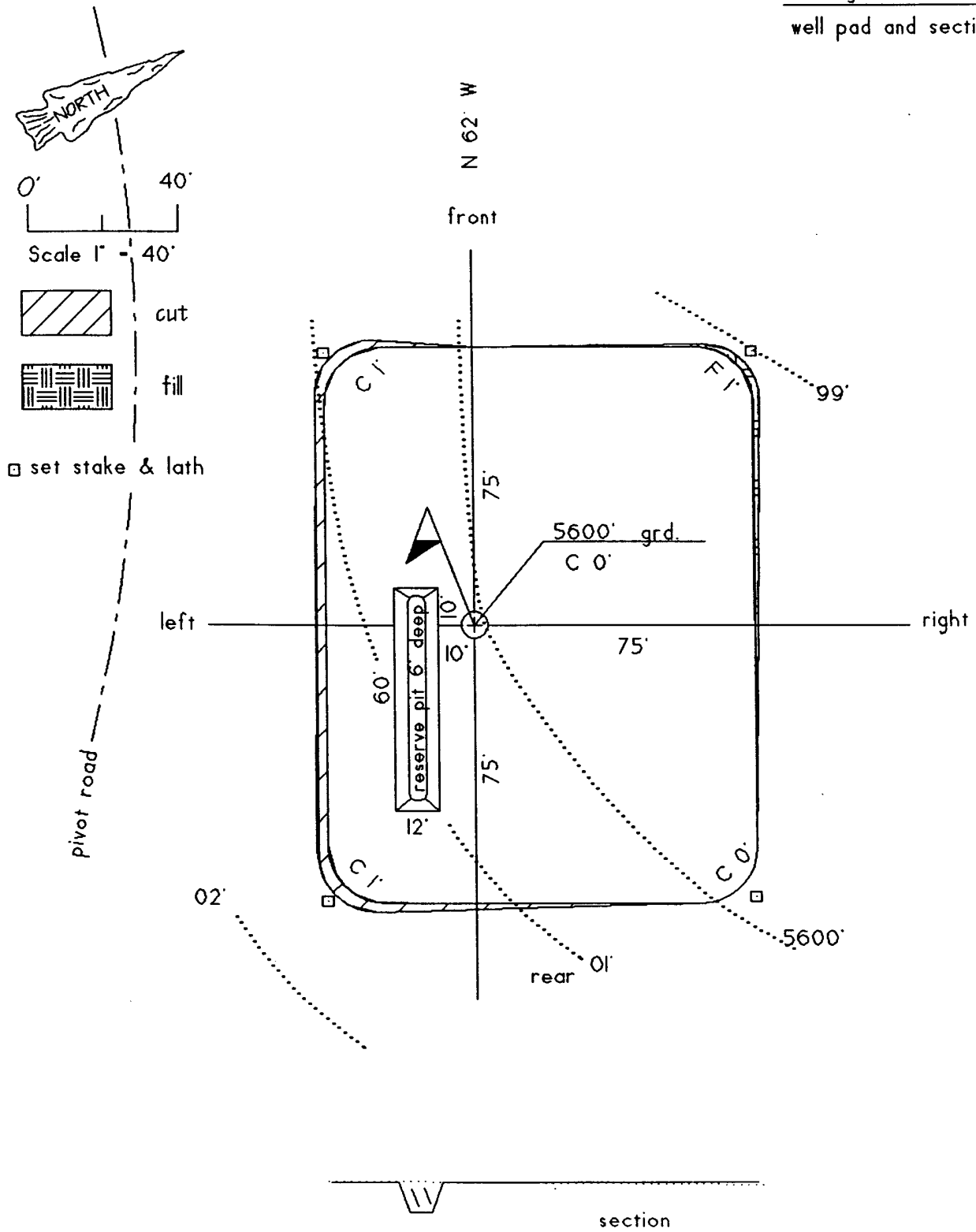

Richardson Operating Co.
Navajo 28 #2
240' FNL & 1940' FWL
Sec. 28, T. 29 N., R. 14 W.
San Juan County, New Mexico

PAGE 1

Drilling Program

1. ESTIMATED FORMATION TOPS

<u>Formation Name</u>	<u>GL Depth</u>	<u>KB Depth</u>	<u>Elevation</u>
Kirtland Shale	000'	5'	+5,600'
Fruitland	655'	670'	+4,945'
Pictured Cliffs Ss	995'	1,000'	+4,605'
Total Depth (TD)*	1,200'	1,205'	+4,400'

* all elevations reflect the ungraded ground level of 5,600'

2. NOTABLE ZONES

<u>Gas Zones</u>	<u>Water Zones</u>	<u>Coal Zones</u>
Fruitland (655')	Fruitland (655')	Fruitland (655')
Pictured Cliffs (1,200')		

Water zones will be protected with casing, cement, and weighted mud. Fresh water encountered during drilling will be recorded by depth, cased, and cemented. Oil and gas shows will be tested for commercial potential based on the well site geologist's recommendations.

3. PRESSURE CONTROL

The drilling contract has not yet been awarded, thus the exact BOP model to be used is not yet known. (A typical 2,000 psi model is on PAGE 3.) Double ram or annular system with a rotating head will be used. All ram preventers and related equipment will be hydraulically tested at nipple up and after any use under pressure to 1000 psi.

Richardson Operating Co.
Navajo 28 #2
240' FNL & 1940' FWL
Sec. 28, T. 29 N., R. 14 W.
San Juan County, New Mexico

PAGE 2

Blind rams will be hydraulically activated and checked for operational readiness each time pipe is pulled out of the hole. All checks of the BOP stack and equipment will be noted on the daily drilling report. BOP equipment will include a kelly cock, floor safety valve, and choke manifold all rated to 2000 psi. Maximum expected pressure is \approx 350 psi.

4. CASING & CEMENT

<u>Hole Size</u>	<u>O. D.</u>	<u>Weight (lb/ft)</u>	<u>Grade</u>	<u>Age</u>	<u>GL Setting Depth</u>
8-3/4"	7"	20	K-55	New	120'
6-1/4"	4-1/2"	10.5	K-55	New	1,200'

Surface casing will be cemented to surface with \approx 36 cu. ft. (\approx 30 sx) Class B + 2% CaCl_2 . Volume is based on 100% excess, yield of 1.18 cu. ft./sk, and slurry weight of 15.6 PPG. WOC = 12 hours. Pressure test surface casing to 600 psi for 30 minutes.

Production casing hole will first be cleaned of rock chips by circulating at least 150% of hole volume with mud to the surface. Thirty barrels of fresh water will next be circulated. Lead with \approx 135 cu. ft. (\approx 65 sx) of Class B with 2% metasilicate (yield = 2.06 cu. ft./sk, slurry weight = 12.5 PPG). Tail with \approx 100 cu. ft. (\approx 85 sx) of Class B with 2% CaCl_2 (yield = 1.18 cu. ft./sk, slurry weight = 15.6 PPG). Total cement volume is \approx 220 cu. ft. based on 75% excess and circulating to surface.

Production casing will have 4-1/2" cement guide shoe and self fill float collar. Float will be placed one joint above the shoe. Five centralizers will be spaced on every other joint starting above the shoe. Five turbolizers will be placed on every other joint starting from the top of the well.

BLOW OUT PREVENTOR (B.O.P.)

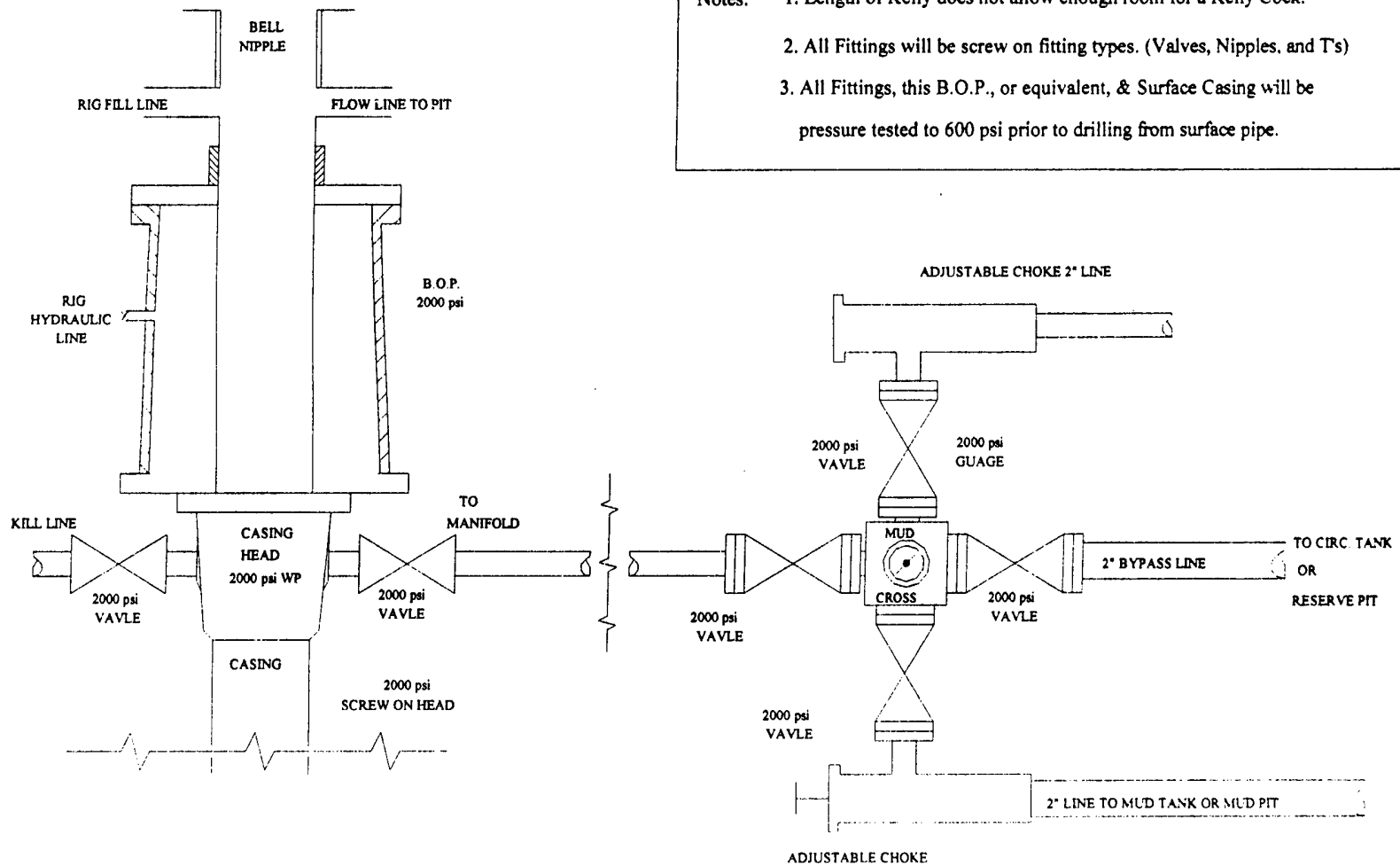

- Notes:
1. Length of Kelly does not allow enough room for a Kelly Cock.
 2. All Fittings will be screw on fitting types. (Valves, Nipples, and Ts)
 3. All Fittings, this B.O.P., or equivalent, & Surface Casing will be pressure tested to 600 psi prior to drilling from surface pipe.

** 2000 psi Rubber hose will be used from Well Head to Manifold
& from Well Head to Kill Line.