

UNITED STATES
DEPARTMENT OF THE INTERIOR
BUREAU OF LAND MANAGEMENT

APPLICATION FOR PERMIT TO DRILL, DEEPEN, OR PLUG BACK

1a. Type of Work DRILL	5. Lease Number 2004 SEP 1 PM 1 16 No-014227 Unit Reporting Number
1b. Type of Well GAS	6. If Indian, All. or Tribe RECEIVED 070 FARMINGTON NM
2. Operator BURLINGTON RESOURCES Oil & Gas Company	7. Unit Agreement Name San Juan 32-9 Unit
3. Address & Phone No. of Operator PO Box 4289, Farmington, NM 87499 (505) 326-9700	8. Farm or Lease Name San Juan 32-9 Unit 9. Well Number #300S
4. Location of Well 365' FSL, 585' FEL Latitude 36° 59.5833'N, Longitude 107° 50.7040'W	10. Field, Pool, Wildcat Basin Fruitland Coal 11. Sec., Twn, Rge, Mer. (NMPM) Sec. 11, T32N, R10W API # 30-045-32562
14. Distance in Miles from Nearest Town 20 miles to the intersection of Hwy 550 and Hwy 173 in Aztec, NM	12. County San Juan ✓ 13. State NM
15. Distance from Proposed Location to Nearest Property or Lease Line 365'	
16. Acres in Lease	17. Acres Assigned to Well All 328.3
18. Distance from Proposed Location to Nearest Well, Drig, Compl, or Applied for on this Lease 1500'	
19. Proposed Depth 3572'	20. Rotary or Cable Tools Rotary
21. Elevations (DF, FT, GR, Etc.) 6740' GR	22. Approx. Date Work will Start
23. Proposed Casing and Cementing Program See Operations Plan attached	
24. Authorized by: <u>Tammy Jones</u> Regulatory Compliance Specialist	Date <u>9-1-04</u>

PERMIT NO.

APPROVAL DATE

APPROVED BY Charles P. [Signature]

TITLE Acting AFM

DATE 11/4/04

Archaeological Report attached

Threatened and Endangered Species Report attached

NOTE: This format is issued in lieu of U.S. BLM Form 3160-3

Title 18 U.S.C. Section 1001, makes it a crime for any person knowingly and willfully to make to any department or agency of the United States any false, fictitious or fraudulent statements or presentations as to any matter within its jurisdiction.

This action is subject to technical and procedural review pursuant to 43 CFR 3165.3 and appeal pursuant to 43 CFR 3165.4

NMOC

DRILLING OPERATIONS AUTHORIZED ARE
SUBJECT TO COMPLIANCE WITH ATTACHED
"GENERAL REQUIREMENTS".

District I
PO Box 1980, Hobbs, NM 88241-1980

State of New Mexico
Energy, Minerals & Natural Resources Department

Form C-102
Revised February 21, 1994

District II
PO Drawer DD, Artesia, NM 88211-0719

Instructions on back
Submit to Appropriate District Office
State Lease - 4 Copies
Fee Lease - 3 Copies

District III
1000 Rio Brazos Rd., Aztec, NM 87410

OIL CONSERVATION DIVISION
PO Box 2088
Santa Fe, NM 87504-2088

District IV
PO Box 2088, Santa Fe, NM 87504-2088

☐ AMENDED REPORT

2004 SEP 1 PM 1 21

WELL LOCATION AND ACREAGE DEDICATION PLAT

API Number 30-039045-32562		Pool Code 71629	Pool Name 070 FARMINGTON NM Basin Fruitland Coal	
Property Code 7473	Property Name SAN JUAN 32-9 UNIT			Well Number 300S
GRID No. 14538	Operator Name BURLINGTON RESOURCES OIL & GAS COMPANY, LP			Elevation 6740'

¹⁰ Surface Location

UL or lot no.	Section	Township	Range	Lot Idn	Feet from the	North/South line	Feet from the	East/West line	County
P	11	32N	10W		365	SOUTH	585	EAST	SAN JUAN

¹¹ Bottom Hole Location If Different From Surface

UL or lot no.	Section	Township	Range	Lot Idn	Feet from the	North/South line	Feet from the	East/West line	County

¹² Dedicated Acres All 328.3	¹³ Joint or Infill	¹⁴ Consolidation Code	¹⁵ Order No.
--	-------------------------------	----------------------------------	-------------------------

NO ALLOWABLE WILL BE ASSIGNED TO THIS COMPLETION UNTIL ALL INTERESTS HAVE BEEN CONSOLIDATED
OR A NON-STANDARD UNIT HAS BEEN APPROVED BY THE DIVISION

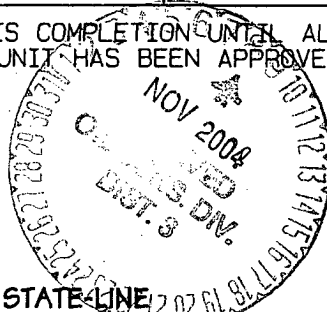

COLORADO / NEW MEXICO STATE LINE

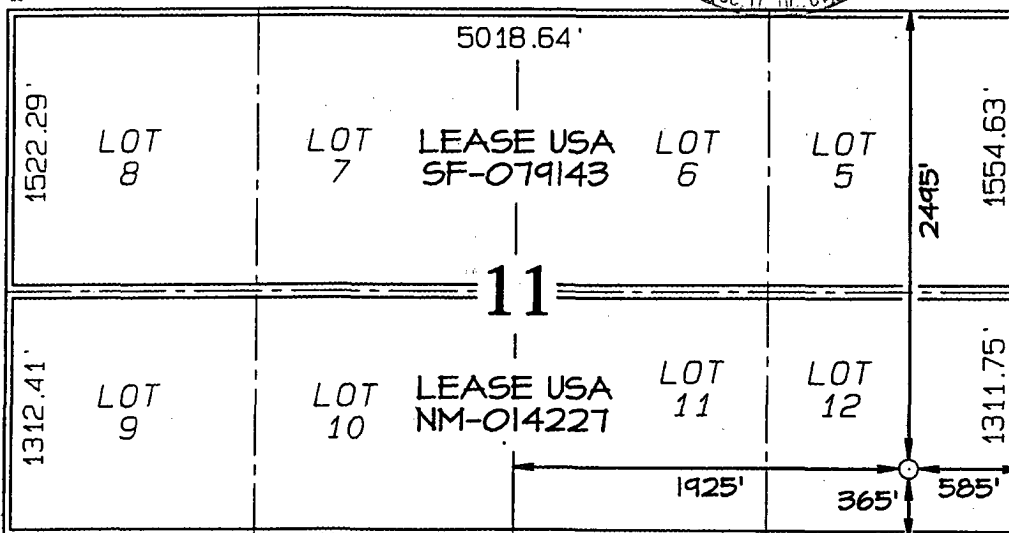

LAT: 36°59.5833' N
LONG: 107°50.7040' W
DATUM NAD27

¹⁷ OPERATOR CERTIFICATION

I hereby certify that the information contained herein is true and complete to the best of my knowledge and belief

Signature
Tammy Jones

Tammy Jones

Printed Name

Regulatory Specialist

Title

9-1-04

Date

¹⁸ SURVEYOR CERTIFICATION

I hereby certify that the well location shown on this plat was plotted from field notes of actual surveys made by me or under my supervision, and that the same is true and correct to the best of my belief.

Date of Survey: MAY 25, 2004

Signature and Seal of Professional Surveyor



JASON C. EDWARDS

Certificate Number 15269

District I
1625 N. French Dr., Hobbs, NM 88240
District II
1301 W. Grand Ave., Artesia, NM 88210
District III
1000 Rio Brazos Rd., Aztec, NM 87410
District IV
1220 S. St. Francis Dr., Santa Fe, NM
87505

OIL CONSERVATION DIVISION
1220 South St. Francis Dr.
Santa Fe, NM 87505

2004 SEP 1 PM 1

WELL API NO.
5. Indicate Type of Lease STATE <input type="checkbox"/> FEE <input type="checkbox"/>
6. State Oil & Gas Lease No. NMNM-014227
7. Lease Name or Unit Agreement Name San Juan 32-9 Unit
8. Well Number 300S
9. OGRID Number 14538
10. Pool name or Wildcat Basin Fruitland Coal

SUNDRY NOTICES AND REPORTS ON WELLS
(DO NOT USE THIS FORM FOR PROPOSALS TO DRILL OR TO DEEPEN OR PLUG BACK TO A
DIFFERENT RESERVOIR. USE "APPLICATION FOR PERMIT" (FORM C-101) FOR SUCH PROPOSALS.)

1. Type of Well:
Oil Well ☐ Gas Well ☒ Other

2. Name of Operator
Burlington Resources Oil & Gas Company LP

3. Address of Operator
3401 E. 30th Street, Farmington, NM 87402

4. Well Location
Unit Letter P : 365 feet from the South line and 585 feet from the East line
Section 11 Township 32N Range 10W NMPM San Juan County, NM

11. Elevation (Show whether DR, RKB, RT, GR, etc.)

Pit or Below-grade Tank Application (For pit or below-grade tank closures, a form C-144 must be attached)

Pit Location: UL P Sect 11 Twp 32N Rng 10W Pit type New Depth to Groundwater <50' Distance from nearest fresh water well >1000'

Distance from nearest surface water >1000' Below-grade Tank Location UL Sect Twp Rng ;
feet from the line and feet from the line

12. Check Appropriate Box to Indicate Nature of Notice, Report or Other Data
NOTICE OF INTENTION TO:

PERFORM REMEDIAL WORK ☐ PLUG AND ABANDON ☐
TEMPORARILY ABANDON ☐ CHANGE PLANS ☐
PULL OR ALTER CASING ☐ MULTIPLE COMPLETION ☐
OTHER: New Drill Pit ☒

SUBSEQUENT REPORT OF:

REMEDIAL WORK ☐ ALTERING CASING ☐
COMMENCE DRILLING OPNS. ☐ PLUG AND ABANDONMENT ☐
CASING TEST AND CEMENT JOB ☐
OTHER: ☐

13. Describe proposed or completed operations. (Clearly state all pertinent details, and give pertinent dates, including estimated date of starting any proposed work). SEE RULE 1103. For Multiple Completions: Attach wellbore diagram of proposed completion or recompletion.

Burlington Resources proposes to construct a new drill pit. The new drill pit will be a lined pit as detailed in Burlington's general pit plan dated April 26, 2004 on file at the NMOCD office. Burlington Resources anticipates closing the pit according to the general pit dated August 2, 2004 on file at the NMOCD office.

I hereby certify that the information above is true and complete to the best of my knowledge and belief. I further certify that any pit or below-grade tank has been/will be constructed or closed according to NMOCD guidelines ☐, a general permit ☒ or an (attached) alternative OCD-approved plan ☐.

SIGNATURE Tammy Jones TITLE Regulatory Specialist DATE 9/1/04

Type or print name Tammy Jones E-mail address: tjones3@br-inc.com Telephone No. 326-9700

(This space for State use)

APPROVED BY [Signature] TITLE DEPUTY OIL & GAS INSPECTOR, DIST. 33 DATE NOV - 8 2004

Conditions of approval, if any:

LATITUDE: 36°59'35"
LONGITUDE: 107°50'42"
DATUM: NAD1927

Note: Contractor should call One-Call for location of any marked or unmarked buried pipelines or cables on well pad and/or access road at least two (2) working days prior to construction

OPERATIONS PLAN

Well Name: San Juan 32-9 Unit #300S

Location: 365' FSL, 585' FEL, Sec 11, T-32-N, R-10-W
San Juan County, NM

Latitude 36° 59.5833'N, Longitude 107° 50.7040'W

Formation: Basin Fruitland Coal

Total Depth: 3572

Burlington Resources is requesting a sump on this well.

Logging Program: See San Juan 32-9 Unit Master Operations Plan

Mud Program: See San Juan 32-9 Unit Master Operations Plan

Casing Program (as listed, the equivalent, or better):

Hole Size	Depth Interval	Csg	Wt.	Grade	Cement	
12 1/4	0' - 120	9.625"	32.3#	H-40	113	cu.ft
8 3/4	0' - 3223	7"	20.0#	J-55	721	cu.ft
6 1/4	3183 - 3572	5 1/2"	15.5#	J-55	uncemented	

Tubing Program: See San Juan 32-9 Unit Master Operations Plan

- * The Fruitland Coal formation will be completed.
- * All 328.1 acres of Section 11 are dedicated to the Fruitland Coal formation in this well.
- * Gas is dedicated.

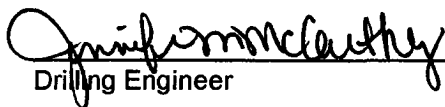
Drilling Engineer

8-29-04
Date

MULTI-POINT SURFACE USE PLAN

San Juan 32-9 Unit #300S

- * Anticipated pipeline facilities as shown on the attached plat from Burlington Resources Gathering Inc.
- * A new access road will be required of approximately 50'.
- * Water Supply will be from Graves Attebury Ditch located in NW/4 Section 4, T-31-N, R-10-W, New Mexico.
- * Surface ownership: Bureau of Land Management
- * Cut trees.
- * Stock top soil.
- * Slopes are 3:1.
- * On corners #2 & #3, drain both ways
- * On Corners #2 & #6, step down outlet
- * Archaeological Resources: See Archaeological Survey technical report # 2004-66 from Aztec Archaeology.

Regulatory Specialist

BURLINGTON RESOURCES

SAN JUAN DIVISION

October 6, 2004

(Certified Mail – Return Receipt Requested)

Re: San Juan 32-9 Unit #300S
Basin Fruitland Coal
365'FSL, 585'FEL Section 11, T-32-N, R-10-W
San Juan County, New Mexico

To the Affected Persons:

Burlington Resources Oil & Gas Company LP is submitting the enclosed Application for Permit to Drill to the appropriate regulatory agency(s) for approval. This well is located inside the High Productivity Area of the Basin-Fruitland Coal Pool as indicated on the attached plat. Notice is being made pursuant to New Mexico Oil Conservation Commission Order R-8768-F dated July 17, 2003.

The affected parties have twenty (20) days from receipt of this notice in which to file with the District Office of the New Mexico Oil Conservation Division written objection to the proposed Application for Permit to Drill.

Sincerely,



Tammy Jones
Regulatory Specialist

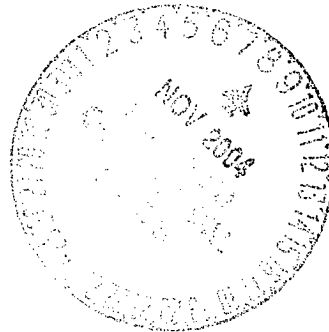

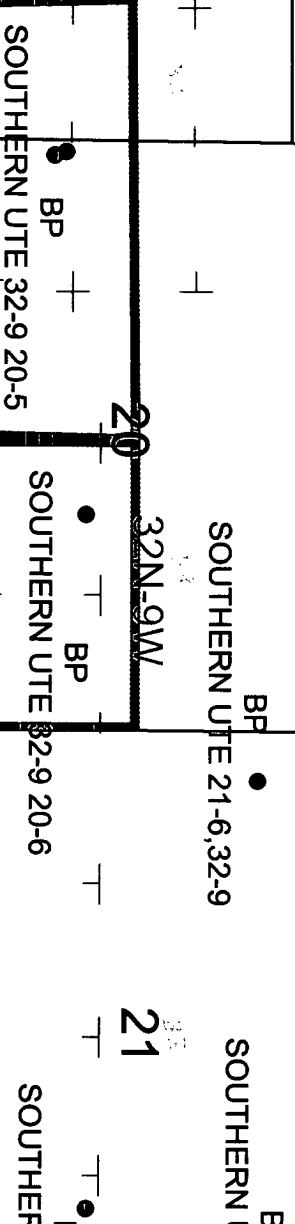

Prepared By: mlb Date: 10/5/2004
File Number: Revised Date: 10/5/2004
File Name: C:\Documents\Project\2PA.S.1.324 UNIT 2003\2PA.S.1.324 UNIT 2003.mxd

2. Article Number

7110 6605 9550 0009 7304

1. Article Addressed to:

BOLACK MINERALS CO
ATTN TOMMY BOLACK
3901 BLOOMFIELD HWY
RT 3 BOX 47
FARMINGTON, NM 87401

10/6/2004 9:27 AM

Code: 32-9: 289S,293S,294S,295S,300S - HPA

COMPLETE THIS SECTION ON DELIVERY**A. Signature****X**☐ Agent
☐ Addressee**B. Received by (Printed Name)****C. Date of Delivery****D. Is delivery address different from item 1?** ☐ Yes
If YES enter delivery address below: ☐ No**3. Service Type**☒ **Certified****4. Restricted Delivery? (Extra Fee)**☐ Yes

PS Form 3811

Domestic Return Receipt

2. Article Number

7110 6605 9550 0009 7380

1. Article Addressed to:

T H MCELVAIN OIL & GAS LTD
PARTNERSHIP
1050 17TH ST STE 1800
DENVER, CO 80265

10/6/2004 9:27 AM

Code: 32-9: 289S,293S,294S 295S,300S - HPA

COMPLETE THIS SECTION ON DELIVERY**A. Signature****X**☐ Agent
☐ Addressee**B. Received by (Printed Name)****C. Date of Delivery**

OCT 12 2004

D. Is delivery address different from item 1? ☐ Yes
If YES enter delivery address below: ☐ No**3. Service Type**☒ **Certified****4. Restricted Delivery? (Extra Fee)**☐ Yes

PS Form 3811

Domestic Return Receipt

2. Article Number

7110 6605 9550 0009 7373

1. Article Addressed to:

PHILLIPS-SAN JUAN PARTNERS
C/O CONOCOPHILLIPS
ATTN CHIEF LANDMAN SAN JUAN/ROCKIES
PO BOX 2197
HOUSTON, TX 77252-2197

10/6/2004 9:27 AM

Code: 32-9: 289S,293S,294S,295S,300S - HPA

COMPLETE THIS SECTION ON DELIVERY**A. Signature****X**☐ Agent
☐ Addressee**B. Received by (Printed Name)****C. Date of Delivery****D. Is delivery address different from item 1?** ☐ Yes
If YES enter delivery address below: ☐ No**3. Service Type**☒ **Certified****4. Restricted Delivery? (Extra Fee)**☐ Yes

PS Form 3811

Domestic Return Receipt

2. Article Number		COMPLETE THIS SECTION ON DELIVERY	
 7110 6605 9590 0009 7364		A. Signature <input checked="" type="checkbox"/> Agent <input type="checkbox"/> Addressee X <i>Bob Valderan</i>	
1. Article Addressed to: JRP SAN JUAN LP ATTN JAMES M RAYMOND MGR PO BOX 291445 KERRVILLE, TX 78029-1445 10/6/2004 9:27 AM		B. Received by (Printed Name) <i>Bob Valderan</i>	
		C. Date of Delivery <i>10-13-04</i>	
		D. Is delivery address different from item 1? <input type="checkbox"/> Yes If YES enter delivery address below: <input checked="" type="checkbox"/> No	
		3. Service Type <input checked="" type="checkbox"/> Certified	
		4. Restricted Delivery? (Extra Fee) <input type="checkbox"/> Yes	

PS Form 3811

Domestic Return Receipt

2. Article Number		COMPLETE THIS SECTION ON DELIVERY	
 7110 6605 9590 0009 7359		A. Signature <input checked="" type="checkbox"/> Agent <input type="checkbox"/> Addressee X <i>John S Brown Jr</i>	
1. Article Addressed to: JOHN S BROWN JR 7301 BURNET RD STE 102-122 AUSTIN, TX 78757-2248 10/6/2004 9:27 AM		B. Received by (Printed Name) <i>JOHN S BROWN JR</i>	
		C. Date of Delivery <i>10/6/04</i>	
		D. Is delivery address different from item 1? <input type="checkbox"/> Yes If YES enter delivery address below: <input type="checkbox"/> No	
		3. Service Type <input checked="" type="checkbox"/> Certified	
		4. Restricted Delivery? (Extra Fee) <input type="checkbox"/> Yes	

PS Form 3811

Domestic Return Receipt

2. Article Number		COMPLETE THIS SECTION ON DELIVERY	
 7110 6605 9590 0009 7342		A. Signature <input checked="" type="checkbox"/> Agent <input type="checkbox"/> Addressee X <i>Barbara Nelms</i>	
1. Article Addressed to: FOUR STAR OIL & GAS COMPANY ATTN BARBARA NELMS PO BOX 36366 HOUSTON, TX 77236 10/6/2004 9:27 AM		B. Received by (Printed Name) <i>Barbara Nelms</i>	
		C. Date of Delivery <i>10/6/04</i>	
		D. Is delivery address different from item 1? <input type="checkbox"/> Yes If YES enter delivery address below: <input type="checkbox"/> No	
		3. Service Type <input checked="" type="checkbox"/> Certified	
		4. Restricted Delivery? (Extra Fee) <input type="checkbox"/> Yes	

Form 3811

Domestic Return Receipt

2. Article Number		COMPLETE THIS SECTION ON DELIVERY	
 7110 6605 9540 0009 7335		A. Signature <input checked="" type="checkbox"/> <i>Hartfield</i> <input type="checkbox"/> Agent <input type="checkbox"/> Addressee	B. Received by (Printed Name) <i>Hartfield</i>
1. Article Addressed to: DEVON ENERGY PRODUCTION CO LP ATTN LAND DEPT 20 N BROADWAY STE 1500 OKLAHOMA CITY, OK 73102 10/6/2004 9:27 AM		C. Date of Delivery	D. Is delivery address different from item 1? <input type="checkbox"/> Yes If YES enter delivery address below: <input type="checkbox"/> No
		3. Service Type <input checked="" type="checkbox"/> Certified	4. Restricted Delivery? (Extra Fee) <input type="checkbox"/> Yes
Code: 32-9: 289S,293S,294S,295S,300S - HPA			

PS Form 3811

Domestic Return Receipt

2. Article Number		COMPLETE THIS SECTION ON DELIVERY	
 7110 6605 9540 0009 7328		A. Signature <input checked="" type="checkbox"/> <i>R. Tillman</i> <input type="checkbox"/> Agent <input type="checkbox"/> Addressee	B. Received by (Printed Name) <i>R. Tillman</i>
1. Article Addressed to: CONOCOPHILLIPS COMPANY ATTN CHIEF LANDMAN SAN JUAN/ROCKIES PO BOX 2197 HOUSTON, TX 77252-2197 10/6/2004 9:27 AM		C. Date of Delivery	D. Is delivery address different from item 1? <input type="checkbox"/> Yes If YES enter delivery address below: <input type="checkbox"/> No
		3. Service Type <input checked="" type="checkbox"/> Certified	4. Restricted Delivery? (Extra Fee) <input type="checkbox"/> Yes
Code: 32-9: 289S,293S,294S,295S,300S - HPA			

PS Form 3811

Domestic Return Receipt

2. Article Number		COMPLETE THIS SECTION ON DELIVERY	
 7110 6605 9540 0009 7311		A. Signature <input checked="" type="checkbox"/> <i>Bryan Anderson</i> <input type="checkbox"/> Agent <input type="checkbox"/> Addressee	B. Received by (Printed Name) <i>Bryan Anderson</i>
1. Article Addressed to: BP AMERICA PRODUCTION COMPANY ATTN BRYAN ANDERSON OSO ENGINEER SAN JUAN BU WEST LAKE 1 ROOM 19-114 501 WESTLAKE PARK BLVD HOUSTON, TX 77079 10/6/2004 9:27 AM		C. Date of Delivery	D. Is delivery address different from item 1? <input type="checkbox"/> Yes If YES enter delivery address below: <input type="checkbox"/> No
		3. Service Type <input checked="" type="checkbox"/> Certified	4. Restricted Delivery? (Extra Fee) <input type="checkbox"/> Yes
Code: 32-9: 289S,293S,294S,295S,300S - HPA			

PS Form 3811

Domestic Return Receipt

2. Article Number



7110 6605 9590 0009 7397

1. Article Addressed to:

WILLIAMS PRODUCTION COMPANY
ONE WILLIAMS CENTER
PO BOX 3102 MS25-3

TULSA, OK 74101

10/6/2004 9:27 AM

Code: 32-9: 289S,293S,294S,295S,300S - HPA

COMPLETE THIS SECTION ON DELIVERY

A. Signature

X

☐ Agent☐ Addressee

B. Received by (Printed Name)

C. Date of Delivery

D. Is delivery address different from item 1? ☐ Yes
If YES enter delivery address below: ☐ No

3. Service Type



Certified

4. Restricted Delivery? (Extra Fee)



Yes

PS Form 3811

Domestic Return Receipt

2. Article Number



7110 6605 9590 0009 7410

1. Article Addressed to:

COLEMAN OIL & GAS INCORPORATED
PO DRAWER 3337
FARMINGTON, NM 87499-3337

10/6/2004 9:46 AM

COMPLETE THIS SECTION ON DELIVERY

A. Signature

X

☐ Agent☐ Addressee

B. Received by (Printed Name)

C. Date of Delivery

D. Is delivery address different from item 1? ☐ Yes
If YES enter delivery address below: ☐ No

3. Service Type



Certified

4. Restricted Delivery? (Extra Fee)



Yes

File: S132-9 UNIT 289S & 295S - HPA

PS Form 3811

Domestic Return Receipt

7110 6605 9590 0009 7397

RETURN RECEIPT SERVICE	POSTAGE	\$0.37	POSTMARK OR DATE
	RESTRICTED DELIVERY FEE	\$0.00	
	CERTIFIED MAIL	\$2.10	
	RETURN RECEIPT FEE	\$1.75	
SENT TO:	TOTAL POSTAGE AND FEES	\$4.22	

Code: 32-9: 289S,293S,294S,295S,300S - HPA

WILLIAMS PRODUCTION COMPANY
ONE WILLIAMS CENTER
PO BOX 3102 MS25-3
TULSA, OK 74101

PS FORM 3800 10/6/2004 9:27 AM



RECEIPT FOR CERTIFIED MAIL
NO INSURANCE COVERAGE PROVIDED
NOT FOR INTERNATIONAL MAIL
(SEE OTHER SIDE)