

State of New Mexico

Energy, Minerals and Natural Resources

OIL CONSERVATION DIVISION

1220 South St. Francis Dr.

Santa Fe, NM 87505

Form C-103

May 27, 2004

SUNDRY NOTICES AND REPORTS ON WELLS (DO NOT USE THIS FORM FOR PROPOSALS TO DRILL OR TO DEEPEN OR PLUG BACK TO A DIFFERENT RESERVOIR. USE "APPLICATION FOR PERMIT" (FORM C-101) FOR SUCH PROPOSALS.)		WELL API NO. 30-045-31794
1. Type of Well: Oil Well <input type="checkbox"/> Gas Well <input checked="" type="checkbox"/> Other <input type="checkbox"/>		5. Indicate Type of Lease STATE <input type="checkbox"/> FEE <input type="checkbox"/>
2. Name of Operator BURLINGTON RESOURCES OIL & GAS COMPANY LP		6. State Oil & Gas Lease No. Federal Lease - NMSF-078311
3. Address of Operator 3401 E. 30TH STREET, FARMINGTON, NM 87402		7. Lease Name or Unit Agreement Name Cundiff #100
4. Well Location Unit Letter A : 955' feet from the North line and 855' feet from the East line Section 19 Township 32N Range 12W NMPM County San Juan		8. Well Number 14538
11. Elevation (Show whether DR, RKB, RT, GR, etc.)		9. OGRID Number Basin Fruitland Coal
10. Pool name or Wildcat Basin Fruitland Coal		
12. Check Appropriate Box to Indicate Nature of Notice, Report or Other Data NOTICE OF INTENTION TO: PERFORM REMEDIAL WORK <input type="checkbox"/> PLUG AND ABANDON <input type="checkbox"/> TEMPORARILY ABANDON <input type="checkbox"/> CHANGE PLANS <input type="checkbox"/> PULL OR ALTER CASING <input type="checkbox"/> MULTIPLE COMPL <input type="checkbox"/> OTHER: New Drill Pit - Amended Report <input checked="" type="checkbox"/>		
SUBSEQUENT REPORT OF: REMEDIAL WORK <input type="checkbox"/> ALTERING CASING <input type="checkbox"/> COMMENCE DRILLING OPNS. <input type="checkbox"/> P AND A <input type="checkbox"/> CASING/CEMENT JOB <input type="checkbox"/> OTHER: <input type="checkbox"/>		
13. Describe proposed or completed operations. (Clearly state all pertinent details, and give pertinent dates, including estimated date of starting any proposed work). SEE RULE 1103. For Multiple Completions: Attach wellbore diagram of proposed completion or recompletion.		

Fit or Below-grade Tank Application

or Closure

Pit type **New Drill** Depth to Groundwater **<50'** Distance from nearest fresh water well **>1000'** Distance from nearest surface water **>1000'**
 Pit Liner Thickness: **12** mil Below-Grade Tank: Volume **bbbs;** Construction Material

New Drill, Lined:

Burlington Resources proposes to construct a new drilling pit and an associated vent/flare pit. Based on Burlington's interpretation of the Ecosphere's risk ranking criteria, the new drilling pit will be a lined pit as detailed in Burlington's Revised Drilling / Workover Pit Construction / Operation Procedures dated November 11, 2004 on file at the NMOCD office. A portion of the vent/flare pit will be designed to manage fluids and that portion will be lined as per the risk ranking criteria. Burlington Resources anticipates closing these pits according to the Drilling / Workover Pit Closure Procedure dated August 2, 2004 on file at the NMOCD office.

I hereby certify that the information above is true and complete to the best of my knowledge and belief. I further certify that any pit or below-grade tank has been/will be constructed or closed according to NMOCD guidelines ☐, a general permit ☒ or an (attached) alternative OCD-approved plan ☐.

SIGNATURE Patsy Clugston TITLE **Sr. Regulatory Specialist** DATE **1/10/2005**

Type or print name **Patsy Clugston** E-mail address: **pclugston@br-inc.com** Telephone No. **505-326-9518**

For State Use Only

APPROVED BY Denny Zent TITLE **DEPUTY OIL & GAS INSPECTOR, DIST. 88** DATE **JAN 11 2005**

Conditions of Approval (if any):

BURLINGTON RESOURCES OIL & GAS COMPANY LP
CUNDIFF No. 100, 955 FNL 855 FEL
SECTION 19, T-32-N, R-12-W, N.M.P.M., SAN JUAN COUNTY, NEW MEXICO
GROUND ELEVATION: 5902, DATE: JANUARY 7, 2005

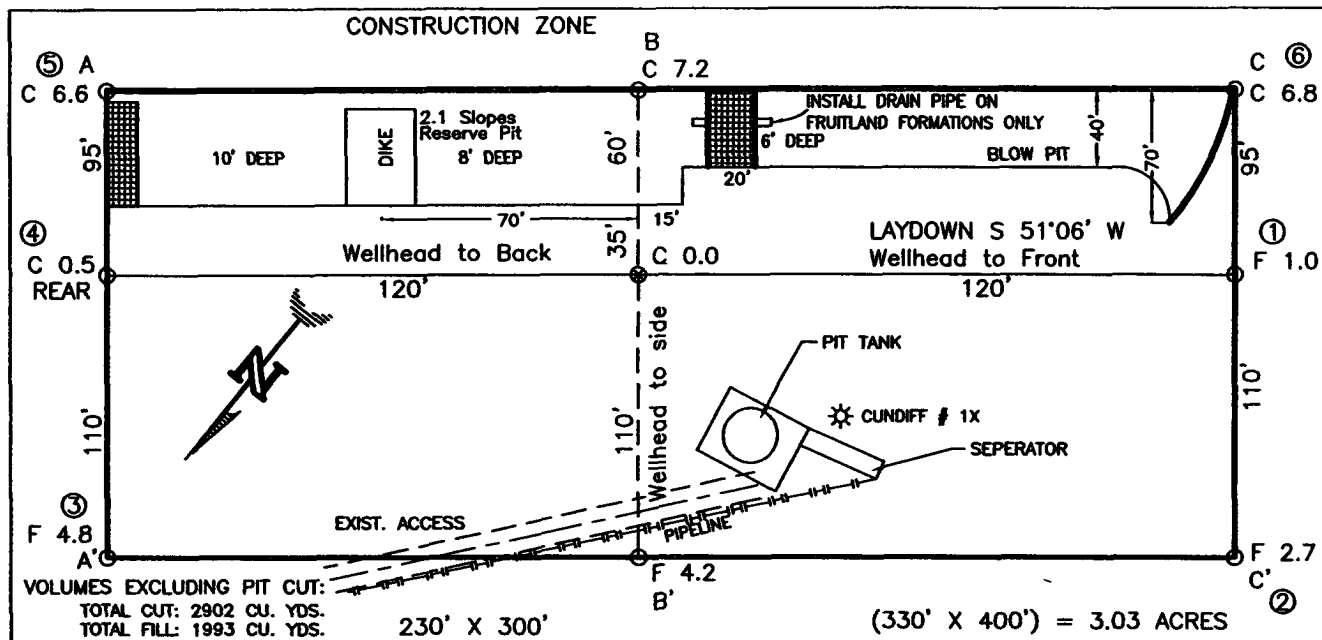

RESERVE PIT DIKE: TO BE 8' ABOVE DEEP SIDE (OVERFLOW - 3' WIDE AND 1' ABOVE SHALLOW SIDE).
 BLOW PIT: OVERFLOW PIPE HALFWAY BETWEEN TOP AND BOTTOM AND TO EXTEND OVER PLASTIC LINER AND INTO BLOW PIT.

NOTE: DAGGETT ENTERPRISES, INC. IS NOT LIABLE FOR UNDERGROUND UTILITIES OR PIPELINES. NEW MEXICO ONE CALL TO BE NOTIFIED 48 HOURS PRIOR TO EXCAVATION OR CONSTRUCTION.

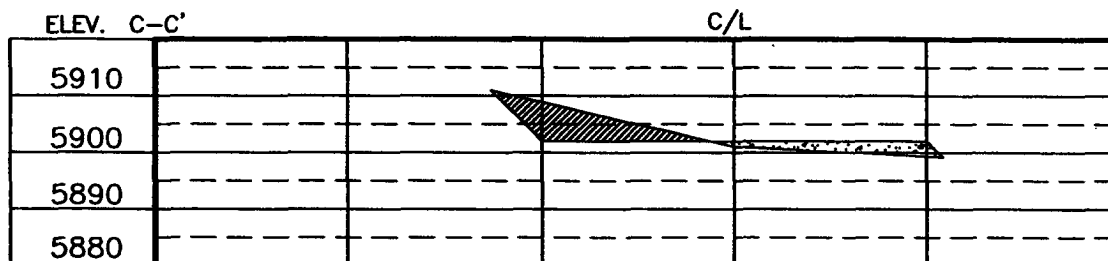
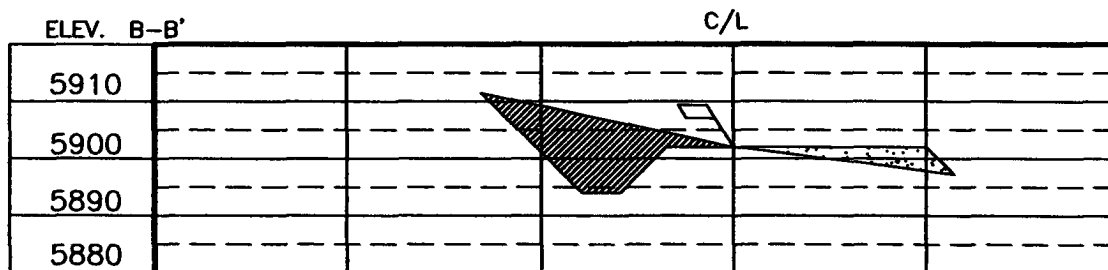
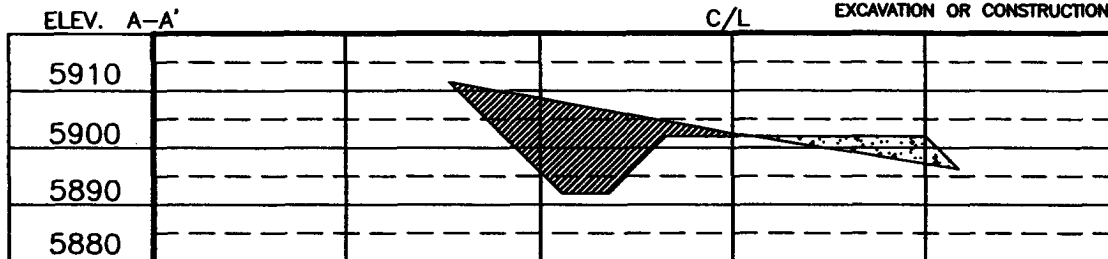

NOTE: CONTRACTOR SHOULD CALL ONE-CALL FOR LOCATION OF ANY MARKED OR UNMARKED BURIED PIPELINES OR CABLES ON WELL PAD AND OR ACCESS ROAD AT LEAST TWO (2) WORKING DAYS PRIOR TO CONSTRUCTION.

REVISION	DATE	REVISION	DATE
01/07/05	01/07/05	01/07/05	01/07/05
02/07/05	02/07/05	02/07/05	02/07/05

Daggett Enterprises, Inc.
 Surveying and Oil Field Services
 P. O. Box 15088 • Farmington, NM 87401
 Phone (505) 328-1772 • Fax (505) 328-8019
 NEW MEXICO L.S. No. 14831
 DAWSON BR. A.G. COPIES BR428CFB
 DATE 02/07/05