

**UNITED STATES
DEPARTMENT OF THE INTERIOR
BUREAU OF LAND MANAGEMENT**

Sundry Notices and Reports on Wells

2005 JAN 10 10 12 53

1. Type of Well
GAS

2. Name of Operator

BURLINGTON

RESOURCES OIL & GAS COMPANY LP

3. Address & Phone No. of Operator

PO Box 4289, Farmington, NM 87499 (505) 326-9700

4. Location of Well, Footage, Sec., T, R, M

Sec., T--N, R--W, NMPM

Unit A (NENE) 955' FNL & 855' FEL, Sec. 19, T-32-N, R-12-W, NMPM

5. Lease Number
NMSF0783116. If Indian, All. or
Tribe Name

7. Unit Agreement Name

8. Well Name & Number

Cundiff #100

9. API Well No.

30-045-31794

10. Field and Pool

Basin Fruitland Coal

11. County and State

San Juan Co, NM

12. CHECK APPROPRIATE BOX TO INDICATE NATURE OF NOTICE, REPORT, OTHER DATA

Type of Submission

☒ Notice of Intent☐ Subsequent Report☐ Final Abandonment

Type of Action

☐ Abandonment☐ Recompletion☐ Plugging☐ Casing Repair☐ Altering Casing☒ Other - Moved location (same Qtr/Qtr)☐ Change of Plans☐ New Construction☐ Non-Routine Fracturing☐ Water Shut off☐ Conversion to Injection

13. Describe Proposed or Completed Operations

The location has moved on the subject well. The old footages were Unit A (NENE) 1000' FNL & 930' FEL, Section 19, T32N, R12W. The new footages will be Unit A (NENE), 955' FNL & 855' FEL, Section 19, T32N, R12W. This is a twinned location & Energen, the Operator of the twinned location requested the move for safety reasons. See attached plat.

No new surface disturbance !!

14. I hereby certify that the foregoing is true and correct.

Signed

Patsy Clugston

Patsy Clugston

Title Sr. Regulatory Specialist

Date 1/10/05

(This space for Federal or State Office use)

APPROVED BY

Blue Press

Title

EPS

Date

1/10/05

CONDITION OF APPROVAL, if any:

NMOC

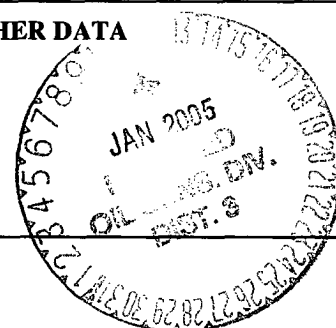

DISTRICT I
1625 N. French Dr., Hobbs, N.M. 88240

DISTRICT II
1301 W. Grand Ave., Artesia, N.M. 88210

DISTRICT III
1000 Rio Brazos Rd., Aztec, N.M. 87410

DISTRICT IV
1220 South St. Francis Dr., Santa Fe, NM 87505

State of New Mexico
Energy, Minerals & Natural Resources Department

OIL CONSERVATION DIVISION

1220 South St. Francis Dr.
Santa Fe, NM 87505

Form C-102
Revised June 10, 2003

Submit to Appropriate District Office
State Lease - 4 Copies
Fee Lease - 3 Copies

☐ AMENDED REPORT

WELL LOCATION AND ACREAGE DEDICATION PLAT

*API Number 30-034-31794		*Pool Code 71629	*Pool Name Basin Fruitland Coal
*Property Code 6938	*Property Name CUNDIFF		*Well Number 100
*OGRID No. 14538	*Operator Name BURLINGTON RESOURCES OIL & GAS COMPANY LP		*Elevation 5902'

¹⁰ Surface Location

UL or lot no.	Section	Township	Range	Lot Idn	Feet from the	North/South line	Feet from the	East/West line	County
A	19	32-N	12-W		955	NORTH	855	EAST	SAN JUAN

¹¹ Bottom Hole Location If Different From Surface

UL or lot no.	Section	Township	Range	Lot Idn	Feet from the	North/South line	Feet from the	East/West line	County
A									
Dedicated Acres 317.36 N/2			Joint or Infill		Consolidation Code		Order No.		

NO ALLOWABLE WILL BE ASSIGNED TO THIS COMPLETION UNTIL ALL INTERESTS HAVE BEEN CONSOLIDATED
OR A NON-STANDARD UNIT HAS BEEN APPROVED BY THE DIVISION

16

LOT 1 USA SF-078311	FD 3 1/4" BLM BC. 1952 N 88-46-24 W 2720.4' (M) LAT. 36°58.5681' N. (NAD 27) LONG. 108°07.7572 W. (NAD 27)	FD 3 1/4" BLM BC. 1952 955' 855'
LOT 2 USA SF-078311	USA SF-078311	USA SF-078311 S 01-39-57 W 2634.5' (M)
LOT 3		FD 3 1/4" BLM BC. 1952
LOT 4		

17 OPERATOR CERTIFICATION

I hereby certify that the information contained herein is true and complete to the best of my knowledge and belief.

Patsy Clugston
Signature

Patsy Clugston
Printed Name

Sr. Regulatory Specialist
Title

1-10-05
Date

18 SURVEYOR CERTIFICATION

I hereby certify that the well location shown on this plat was plotted from field notes of actual surveys made by me or under my supervision, and that the same is true and correct to the best of my knowledge and belief.

JOHN A. VUKONICH
NEW MEXICO
REGISTERED PROFESSIONAL SURVEYOR
14831
2005

Signature and Seal of Professional Surveyor

Certificate Number

108°09.000' W

108°08.000' W

NAD27 108°07.000' W

BURLINGTON RESOURCES OIL & GAS COMPANY LP

CUNDIFF No. 100

955 FNL 855 FEL

NE1/4 NE1/4 SEC. 19, T-32-N, R-12-W, N.M.P.M.,

SAN JUAN COUNTY, NEW MEXICO

APD MAP

NO NEW ACCESS

CUNDIFF No. 100

LAT. 36.58.5681 N. (NAD27)

LONG. 108.07.7572 W (NAD27)

EXISTING ACCESS

Gas Well-5933

108°09.000' W

108°08.000' W

NAD27 108°07.000' W

0 1000 FEET 0 500 1000 METERS

Map created with TOPO!® ©2002 National Geographic (www.nationalgeographic.com/topo)

BURLINGTON RESOURCES OIL & GAS COMPANY LP
CUNDIFF No. 100, 955 FNL 855 FEL
SECTION 19, T-32-N, R-12-W, N.M.P.M., SAN JUAN COUNTY, NEW MEXICO
GROUND ELEVATION: 5902, DATE: JANUARY 7, 2005

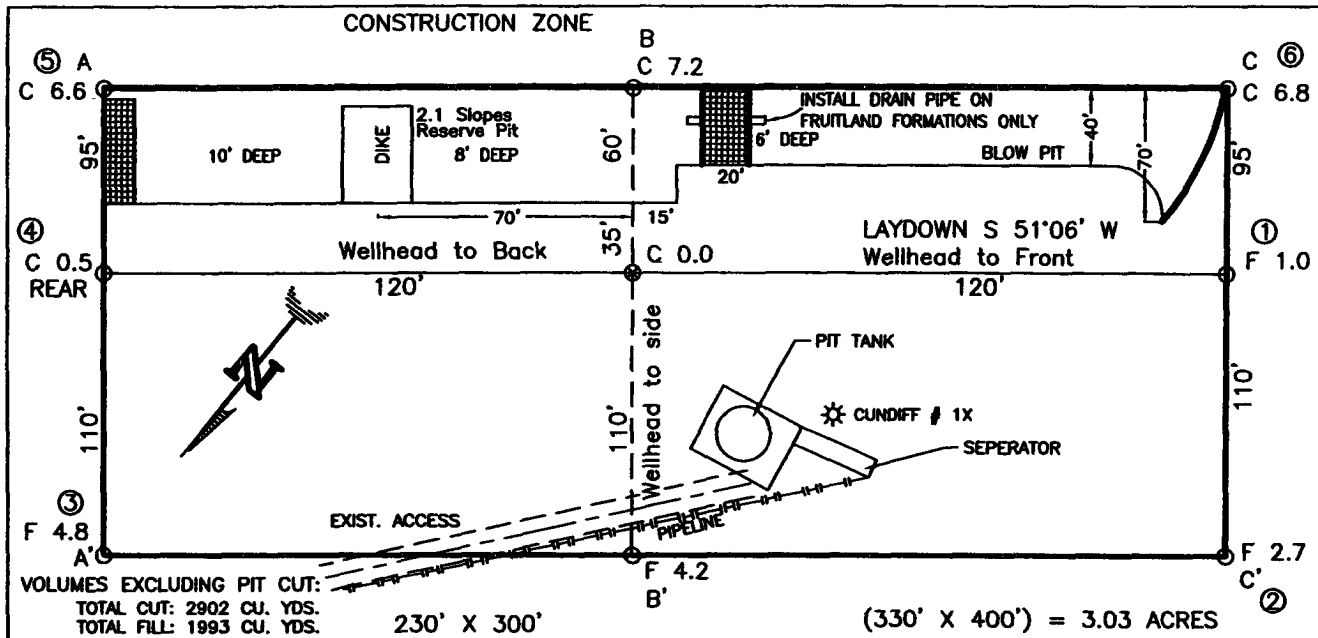

RESERVE PIT DIKE: TO BE 8' ABOVE DEEP SIDE (OVERFLOW - 3' WIDE AND 1' ABOVE SHALLOW SIDE).
 BLOW PIT: OVERFLOW PIPE HALFWAY BETWEEN TOP AND BOTTOM AND TO EXTEND OVER PLASTIC LINER AND INTO BLOW PIT.

NOTE: DAGGETT ENTERPRISES, INC. IS NOT LIABLE FOR UNDERGROUND UTILITIES OR PIPELINES. NEW MEXICO ONE CALL TO BE NOTIFIED 48 HOURS PRIOR TO EXCAVATION OR CONSTRUCTION.

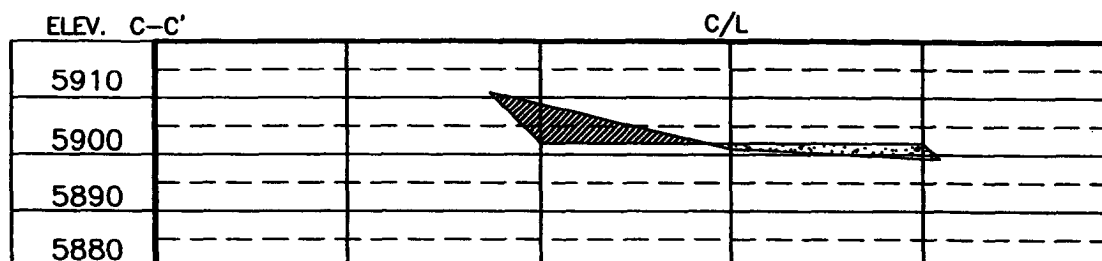
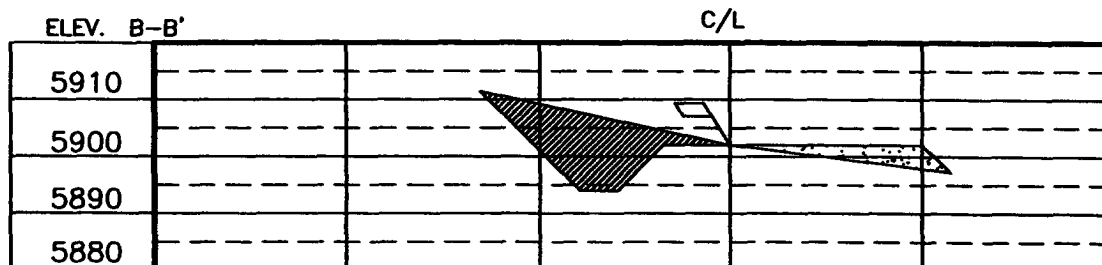
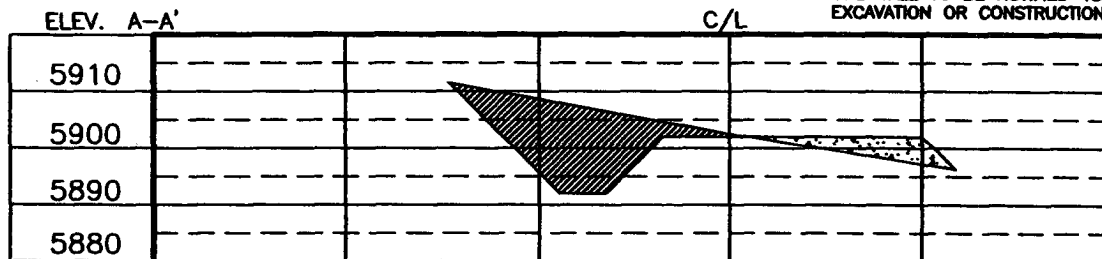

NOTE: CONTRACTOR SHOULD CALL ONE-CALL FOR LOCATION OF ANY MARKED OR UNMARKED BURIED PIPELINES OR CABLES ON WELL PAD AND OR ACCESS ROAD AT LEAST TWO (2) WORKING DAYS PRIOR TO CONSTRUCTION.

REVISION	DATE	BY	REASON
01/07/05	01/07/05	B.L.	RELAY
02/07/03	02/07/03	A.G.	RELAY

Daggett Enterprises, Inc.
 Surveying and Oil Field Services
 P. O. Box 15088 • Farmington, NM 87401
 Phone (505) 326-1772 • Fax (505) 326-6019
 NEW MEXICO L.S. No. 14831
 GCS/LE BR423C7B
 DATE: 02/07/03

DRW: BT A.G.
 ROW: BR423

Directions from the Post Office in La PLATA, NM to

Burlington Resources Oil & Gas Company LP – CUNDIFF #100

955' FNL & 855' FEL, Section 19, T-32-N, R-12-W, N.M.P.M., San Juan County, New Mexico

From the Post Office in La Plata, New Mexico

Take Highway 170 North 1.9 miles.

Turn right on Highway 574 and go easterly 5.6 miles.

Turn left and go northerly on C.R. 1350 (Hartley Springs Ranches) 3.9 miles.

Stay left and go northwesterly 0.4 miles.

Turn right and go northerly 0.1 miles.

Take left fork and go northwesterly 0.6 miles.

Turn right and go northerly 0.4 miles.

Turn left and go southwesterly 2.1 miles.

Turn right and go westerly 0.1 miles

Turn left at the meter house and go 0.1 mile to new location at existing Cundiff No. 1X.