

UNITED STATES
DEPARTMENT OF THE INTERIOR
BUREAU OF LAND MANAGEMENTFORM APPROVED
OMB NO. 1004-0135
Expires: November 30, 2000**SUNDRY NOTICES AND REPORTS ON WELLS**
*Do not use this form for proposals to drill or to re-enter an abandoned well. Use form 3160-3 (APD) for such proposals.***SUBMIT IN TRIPLICATE - Other instructions on reverse side.**

1. Type of Well <input type="checkbox"/> Oil Well <input checked="" type="checkbox"/> Gas Well <input type="checkbox"/> Other		5. Lease Serial No. JIC-69
2. Name of Operator XTO ENERGY INC.		6. If Indian, Allottee or Tribe Name JICARILLA TRIBE
3a. Address 2700 FARMINGTON AVE BLDG K #1 FARMINGTON, NM 87401		7. If Unit or CA/Agreement, Name and/or No.
3b. Phone No. (include area code) Ph: 505-324-1090 Fx: 505-564-6700		8. Well Name and No. APACHE FEDERAL #11E
4. Location of Well (Footage, Sec., T., R., M., or Survey Description) Sec 8 T24N R05W NWSW 1850FSL 790FWL		9. API Well No. 30-039-22673
		10. Field and Pool, or Exploratory BASIN DK / BALLARD PC
		11. County or Parish, and State RIO ARRIBA COUNTY, NM

12. CHECK APPROPRIATE BOX(ES) TO INDICATE NATURE OF NOTICE, REPORT, OR OTHER DATA

TYPE OF SUBMISSION	TYPE OF ACTION
<input checked="" type="checkbox"/> Notice of Intent	<input type="checkbox"/> Acidize <input type="checkbox"/> Deepen <input type="checkbox"/> Production (Start/Resume) <input type="checkbox"/> Water Shut-Off
<input type="checkbox"/> Subsequent Report	<input type="checkbox"/> Alter Casing <input type="checkbox"/> Fracture Treat <input type="checkbox"/> Reclamation <input type="checkbox"/> Well Integrity
<input type="checkbox"/> Final Abandonment Notice	<input type="checkbox"/> Casing Repair <input type="checkbox"/> New Construction <input type="checkbox"/> Recomplete <input checked="" type="checkbox"/> Other
	<input type="checkbox"/> Change Plans <input type="checkbox"/> Plug and Abandon <input type="checkbox"/> Temporarily Abandon <input type="checkbox"/> Subsurface Commingling
	<input type="checkbox"/> Convert to Injection <input type="checkbox"/> Plug Back <input type="checkbox"/> Water Disposal

13. Describe Proposed or Completed Operation (clearly state all pertinent details, including estimated starting date of any proposed work and approximate duration thereof. If the proposal is to deepen directionally or recompleate horizontally, give subsurface locations and measured and true vertical depths of all pertinent markers and zones. Attach the Bond under which the work will be performed or provide the Bond No. on file with BLM/BIA. Required subsequent reports shall be filed within 30 days following completion of the involved operations. If the operation results in a multiple completion or recompleation in a new interval, a Form 3160-4 shall be filed once testing has been completed. Final Abandonment Notices shall be filed only after all requirements, including reclamation, have been completed, and the operator has determined that the site is ready for final inspection.)

XTO Energy Inc. requests approval to downhole commingle production from the Ballard Pictured Cliffs (71439) and the Basin Dakota (71599). XTO Energy Inc. intends to recompleate this well in the PC. The DK is producing. XTO Energy Inc. will downhole commingle these pools upon completion of the Pictured Cliffs. Attached as supporting documentation are the 9-section EUR's used for production allocations and the C103 sundry to the NMOCD regarding the DHC application. Based upon the 9-section EUR's for the Basin Dakota & Ballard Pictured Cliffs, XTO Energy Inc. proposes production allocations as follows:

Basin Dakota (71599): 100% Oil 100% Water 70% Gas
Ballard Pictured Cliffs (71439): 0% Oil 0% Water 30% Gas

Both of these pools are included in the NMOCD pre-approved pool combinations for downhole

DHC 1750 A2

14. I hereby certify that the foregoing is true and correct.	
Electronic Submission #52893 verified by the BLM Well Information System For XTO ENERGY INC., sent to the Farmington Committed to AFMSS for processing by ANGIE MEDINA-JONES on 01/12/2005 ()	
Name (Printed/Typed) KELLY K SMALL	Title DRILLING ASSISTANT
Signature (Electronic Submission)	Date 01/11/2005

THIS SPACE FOR FEDERAL OR STATE OFFICE USE

Approved By <i>[Signature]</i>	Title Division of Multi-Resources	Date FEB 11 2005
Conditions of approval, if any, are attached. Approval of this notice does not warrant or certify that the applicant holds legal or equitable title to those rights in the subject lease which would entitle the applicant to conduct operations thereon.		Office

Title 18 U.S.C. Section 1001 and Title 43 U.S.C. Section 1212, make it a crime for any person knowingly and willfully to make to any department or agency of the United States any false, fictitious or fraudulent statements or representations as to any matter within its jurisdiction.

**** OPERATOR-SUBMITTED ** OPERATOR-SUBMITTED ** OPERATOR-SUBMITTED ****

Additional data for EC transaction #52893 that would not fit on the form

32. Additional remarks, continued

commingling in the San Juan Basin. The NMOCD has been notified of our intent to downhole commingle. Ownership in this well's pools is identical in the wellbore, therefore, no notification was necessary to owners. Downhole commingling will offer an economic method of production while protecting against reservoir damage, waste of reserved and violation of correlative rights.



2700 Farmington Ave, K-1 Farmington, NM 87401
Phone: (505) 324-1090 FAX: (505) 564-6700

January 11, 2005

Mr. Steve Hayden
New Mexico Oil Conservation Division
1000 Rio Brazos Road
Aztec, New Mexico 87410

Subject: Request for Exception to Rule 303C Downhole commingling
Apache Federal #11E- 1,850' FSL & 790' FWL
Basin Dakota (71599) & Ballard Pictured Cliffs (71439)
Rio Arriba County, NM

Dear Mr. Chavez:

XTO Energy Inc. requests administrative approval for an exception to Rule 303-C to permit the downhole commingling of production in the aforementioned well from the Basin Dakota and Ballard Pictured Cliffs. We have included for your reference an NMOCD Form C103, a Federal form 3160-5 and plats for the Basin Dakota & Ballard Pictured Cliffs

The Apache Federal #11E is in the process of being re-completed by XTO Energy Inc. It is proposed to downhole commingle both zones upon completion of the Pictured Cliffs. Based on production analysis of wells located in a nine section surrounding area, the following allocations are proposed:

Basin Dakota (71599)	Oil 100%	Gas 70%
Ballard Pictured Cliffs (71439)	Oil 0%	Gas 30 %

The ownership (WI, MRI & ORRI) of these pools are identical in this wellbore. Downhole commingling in this manner will offer an economic method of production while protecting against reservoir damage, waste of reserves and violation of correlative rights. Should you require any additional information please contact me at (505) 324-1090.

Sincerely,

A handwritten signature in cursive script that reads 'Kelly K. Small'.

Kelly K. Small
Drilling Assistant

Encl (2)
xc: FTW land
Well file

Submit 3 Copies To Appropriate District
Office
District I
1625 N. French Dr., Hobbs, NM 88240
District II
1301 W. Grand Ave., Artesia, NM 88210
District III
1000 Rio Brazos Rd., Aztec, NM 87410
District IV
1220 S. St. Francis Dr., Santa Fe, NM
87505

State of New Mexico
Energy, Minerals and Natural Resources

Form C-103
May 27, 2004

OIL CONSERVATION DIVISION
1220 South St. Francis Dr.
Santa Fe, NM 87505

WELL API NO. 30-039-22673
5. Indicate Type of Lease STATE <input type="checkbox"/> FEE <input type="checkbox"/>
6. State Oil & Gas Lease No. JIC-69
7. Lease Name or Unit Agreement Name APACHE FEDERAL
8. Well Number #11E
9. OGRID Number 167067
10. Pool name : BASIN DAKOTA / BALLARD PICTURED CLIFFS

SUNDRY NOTICES AND REPORTS ON WELLS (DO NOT USE THIS FORM FOR PROPOSALS TO DRILL OR TO DEEPEN OR PLUG BACK TO A DIFFERENT RESERVOIR. USE "APPLICATION FOR PERMIT" (FORM C-101) FOR SUCH PROPOSALS.)	
1. Type of Well: Oil Well <input type="checkbox"/> Gas Well <input checked="" type="checkbox"/> Other	
2. Name of Operator XTO ENERGY INC.	
3. Address of Operator 2700 FARMINGTON AVE, SUITE K-1, FARMINGTON, NM 87401	
4. Well Location Unit Letter <u>L</u> : <u>1,850</u> feet from the <u>SOUTH</u> line and <u>790'</u> feet from the <u>WEST</u> line Section <u>08</u> Township <u>24N</u> Range <u>5W</u> NMPM County <u>RIO ARRIBA</u>	
11. Elevation (Show whether DR, RKB, RT, GR, etc.) 6,484' GL	
Pit or Below-grade Tank Application <input type="checkbox"/> or Closure <input type="checkbox"/>	
Pit type _____ Depth to Groundwater _____ Distance from nearest fresh water well _____ Distance from nearest surface water _____	
Pit Liner Thickness: _____ mil Below-Grade Tank: Volume _____ bbls; Construction Material _____	

12. Check Appropriate Box to Indicate Nature of Notice, Report or Other Data

NOTICE OF INTENTION TO:		SUBSEQUENT REPORT OF:	
PERFORM REMEDIAL WORK <input type="checkbox"/>	PLUG AND ABANDON <input type="checkbox"/>	REMEDIAL WORK <input type="checkbox"/>	ALTERING CASING <input type="checkbox"/>
TEMPORARILY ABANDON <input type="checkbox"/>	CHANGE PLANS <input type="checkbox"/>	COMMENCE DRILLING OPNS. <input type="checkbox"/>	P AND A <input type="checkbox"/>
PULL OR ALTER CASING <input type="checkbox"/>	MULTIPLE COMPL <input type="checkbox"/>	CASING/CEMENT JOB <input type="checkbox"/>	
OTHER: DOWNHOLE COMMINGLE <input checked="" type="checkbox"/>		OTHER: <input type="checkbox"/>	

13. Describe proposed or completed operations. (Clearly state all pertinent details, and give pertinent dates, including estimated date of starting any proposed work). SEE RULE 1103. For Multiple Completions: Attach wellbore diagram of proposed completion or recompletion.

XTO Energy Inc. requests approval for an exception to Rule 303-C to permit downhole commingling of production from the Ballard Pictured Cliffs (71439) and the Basin Dakota (71599) pools in the Apache Federal #11E. XTO intends to recomplete this well in the PC and the DK is producing. XTO will downhole commingle these pools upon completion of the Pictured Cliffs. Both zones are included in the pre-approved pools established by Division Order R-11363. Based on production analysis of wells located in a nine section surrounding area the following allocation was determined:

Basin Dakota	100% Oil	100% Water	70% Gas
Ballard Pictured Cliffs	0% Oil	0% Water	30% Gas

Both pools have common interest owners. Commingling both zones will not reduce the ultimate recovery of either pool. Downhole commingling will improve recovery of liquids, eliminate redundant surface equipment and maximize productivity. BLM has been notified of intent to DHC with filing of Form 3160-5.

I hereby certify that the information above is true and complete to the best of my knowledge and belief. I further certify that any pit or below-grade tank has been/will be constructed or closed according to NMOC guidelines ☐, a general permit ☐ or an (attached) alternative OCD-approved plan ☐.

SIGNATURE Kelly K. Small TITLE DRILLING ASSISTANT DATE 01/10/05
Type or print name KELLY K. SMALL E-mail address: kelly_small@xtoenergy.com Telephone No. 505-324-1090
For State Use Only

APPROVED BY: _____ TITLE _____ DATE _____
Conditions of Approval (if any): _____

District I
1625 N. French Dr., Hobbs, NM 88240

District II
811 South First, Artesia, NM 88210

District III
1000 Rio Brazos Rd., Aztec, NM 87410

District IV
1220 S. St. Francis Dr., Santa Fe, NM 87505

State of New Mexico
Energy, Minerals & Natural Resources Department

Form C-102
Revised August 15, 2000

OIL CONSERVATION DIVISION
1220 South St. Francis Dr.
Santa Fe, NM 87505

Submit to Appropriate District Office
State Lease - 4 Copies
Fee Lease - 3 Copies

WELL LOCATION AND ACREAGE DEDICATION PLAT

☐ AMENDED
REPORT

¹ API Number 30-039-22673		² Pool Code 71599		³ Pool Name BASIN DAKOTA	
⁴ Property Code		⁵ Property Name APACHE FEDERAL			⁶ Well Number 11E
⁷ OGRID No. 167067		⁸ Operator Name XTO Energy, Inc.			⁹ Elevation 6,484 GL

¹⁰ Surface Location

UL or lot no.	Section	Township	Range	Lot Idn	Feet from the	North/South line	Feet from the	East/West line	County
L	08	24N	05W		1,850'	SOUTH	790'	WEST	RIO ARriba

¹¹ Bottom Hole Location If Different From Surface

UL or lot no.	Section	Township	Range	Lot Idn	Feet from the	North/South line	Feet from the	East/West line	County

¹² Dedicated Acres S/2 320	¹³ Joint or Infill	¹⁴ Consolidation Code	¹⁵ Order No.

NO ALLOWABLE WILL BE ASSIGNED TO THIS COMPLETION UNTIL ALL INTERESTS HAVE BEEN CONSOLIDATED OR A NON-STANDARD UNIT HAS BEEN APPROVED BY THE DIVISION

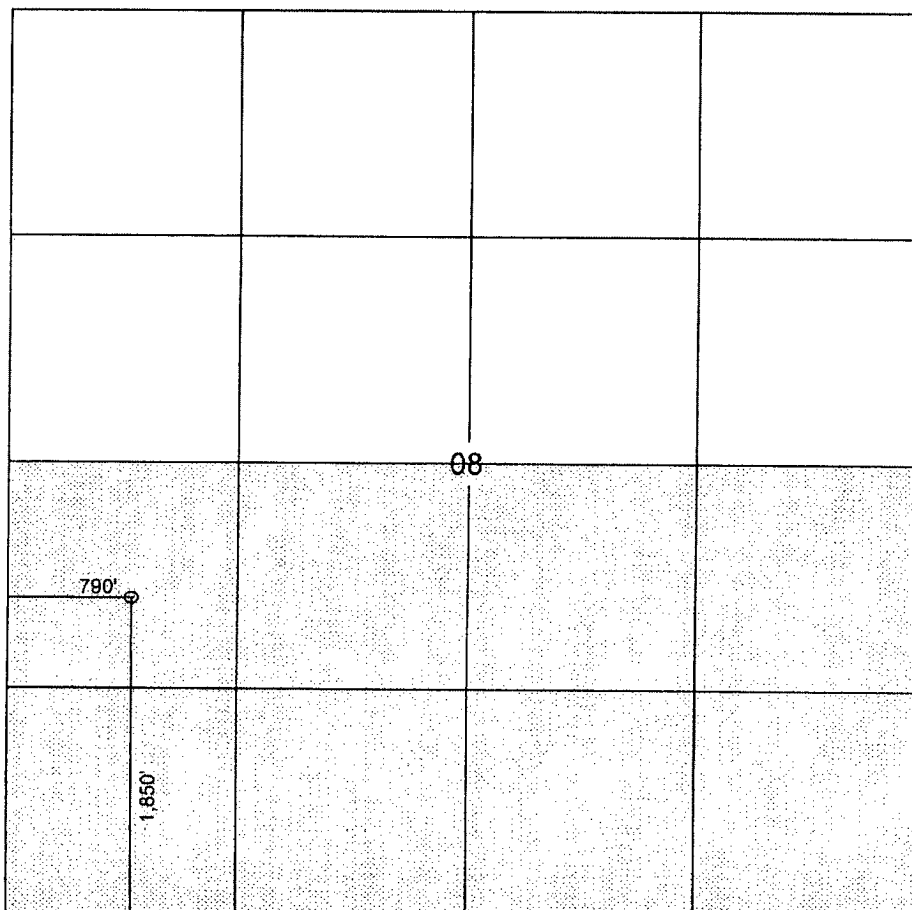

OPERATOR CERTIFICATION
I hereby certify that the information contained herein is true and complete to the best of my knowledge and belief

Kelly H Small
Signature

KELLY SMALL
Printed Name

DRILLING ASSISTANT
Title

JANUARY 10, 2005
Date

SURVEYOR CERTIFICATION

I hereby certify that the well location shown on this plat was plotted from field notes of actual surveys made by me or under my supervision, and that the same is true and correct to the best of my belief.

FEBRUARY 18, 1981

Date of Survey

Signature and Seal of Professional Surveyor:
Original signed by James P. Lease

1463

Certificate Number

District I
1625 N. French Dr., Hobbs, NM 88240
District II
811 South First, Artesia, NM 88210
District III
1000 Rio Brazos Rd., Aztec, NM 87410
District IV
1220 S. St. Francis Dr., Santa Fe, NM 87505

State of New Mexico
Energy, Minerals & Natural Resources Department

Form C-102
Revised August 15, 2000

OIL CONSERVATION DIVISION
1220 South St. Francis Dr.
Santa Fe, NM 87505

Submit to Appropriate District Office
State Lease - 4 Copies
Fee Lease - 3 Copies

WELL LOCATION AND ACREAGE DEDICATION PLAT

AMENDED
REPORT

¹ API Number 30-039-22673	² Pool Code 71439	³ Pool Name BALLARD PICTURED CLIFFS
⁴ Property Code	⁵ Property Name APACHE FEDERAL	⁶ Well Number 11E
⁷ OGRID No. 167067	⁸ Operator Name XTO Energy, Inc.	⁹ Elevation 6,484 GL

¹⁰ Surface Location

UL or lot no. L	Section 08	Township 24N	Range 05W	Lot Idn	Feet from the 1,850'	North/South line SOUTH	Feet from the 790'	East/West line WEST	County RIO ARriba
---------------------------	----------------------	------------------------	---------------------	---------	--------------------------------	----------------------------------	------------------------------	-------------------------------	-----------------------------

¹¹ Bottom Hole Location If Different From Surface

UL or lot no.	Section	Township	Range	Lot Idn	Feet from the	North/South line	Feet from the	East/West line	County
---------------	---------	----------	-------	---------	---------------	------------------	---------------	----------------	--------

¹² Dedicated Acres SW/4 160	¹³ Joint or Infill	¹⁴ Consolidation Code	¹⁵ Order No.
--	-------------------------------	----------------------------------	-------------------------

NO ALLOWABLE WILL BE ASSIGNED TO THIS COMPLETION UNTIL ALL INTERESTS HAVE BEEN CONSOLIDATED OR A NON-STANDARD UNIT HAS BEEN APPROVED BY THE DIVISION

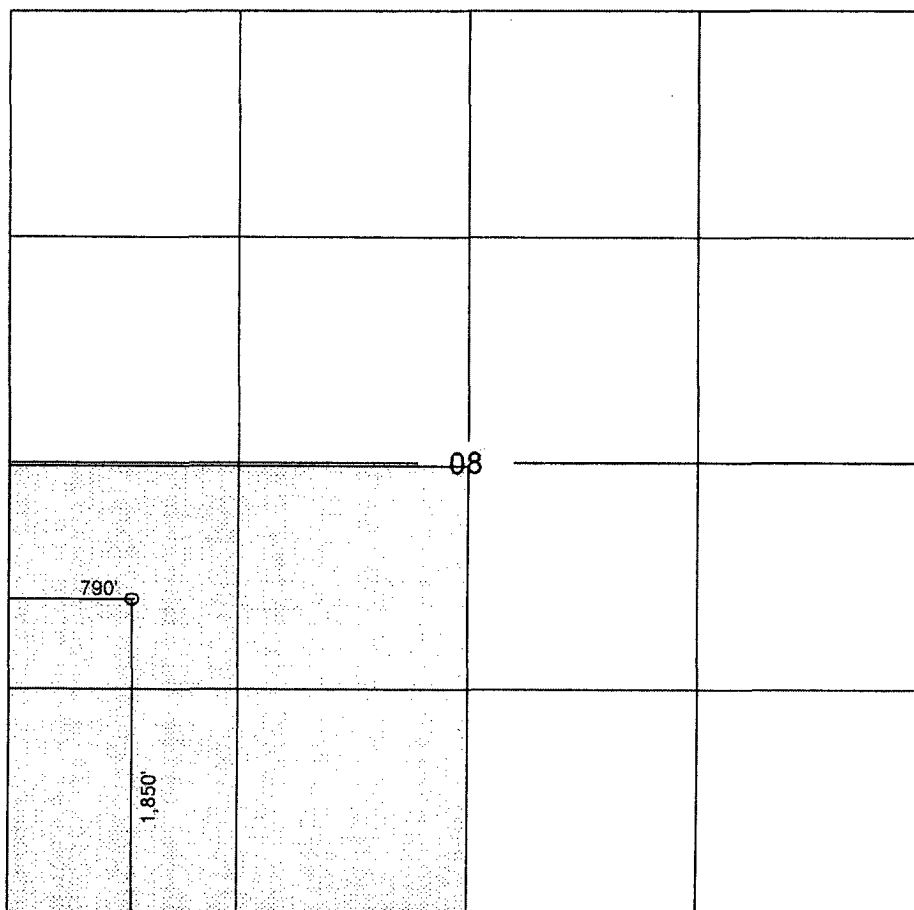

OPERATOR CERTIFICATION

I hereby certify that the information contained herein is true and complete to the best of my knowledge and belief

Kelly H Small
Signature

KELLY SMALL
Printed Name

DRILLING ASSISTANT
Title

JANUARY 10, 2005
Date

SURVEYOR CERTIFICATION

I hereby certify that the well location shown on this plat was plotted from field notes of actual surveys made by me or under my supervision, and that the same is true and correct to the best of my belief.

FEBRUARY 18, 1981

Date of Survey

Signature and Seal of Professional Surveyor:
Original signed by James P. Lease

1463
Certificate Number

Apache Pool
Jack Frost #11E **9 Section EUR's**
Section 8 24N 5W

Well Name	No	Operator	Sec	Unit	Tw	Rng	Field	Producing Zone	Gas Cumt (mmcf)	Oil Cumt (mbo)	Gas EUR (mmcf)	Oil EUR (mbo)
JICARILLA	1	ELM RIDGE EXPLORATION COMPANY	4		24N	5W	BASIN	DAKOTA	409	5	409	5
JICARILLA	1E	ELM RIDGE RESOURCES INCORPORATED	4		24N	5W	BASIN	DAKOTA	234	2	667	4
JICARILLA	1R	ELM RIDGE RESOURCES INCORPORATED	4		24N	5W	BASIN	DAKOTA	270	2	708	7
JICARILLA N	1	UNION TEXAS PETROLEUM CORPORATION	4	K	24N	5W	BASIN	DAKOTA	934	10	934	10
JICARILLA B	3	FOUR STAR OIL & GAS COMPANY	5		24N	5W	BASIN	DAKOTA	219	0	263	0
JICARILLA B	23	FOUR STAR OIL & GAS COMPANY	5	P	24N	5W	BASIN	DAKOTA	2,142	14	2,448	15
JICARILLA B	3E	FOUR STAR OIL & GAS COMPANY	5	N	24N	5W	BASIN	DAKOTA	1,220	12	1,817	13
JICARILLA B	23E	FOUR STAR OIL & GAS COMPANY	5		24N	5W	BASIN	DAKOTA	813	7	1,085	9
JICARILLA B	24	FOUR STAR OIL & GAS COMPANY	6	P	24N	5W	BASIN	DAKOTA	302	9	367	11
JICARILLA B	22	FOUR STAR OIL & GAS COMPANY	6		24N	5W	BASIN	DAKOTA	1,120	4	1,354	4
JICARILLA B	15	GULF OIL CORPORATION	7	D	24N	5W	BASIN	DAKOTA	279	1	279	1
APACHE FEDERAL	13	XTO ENERGY INCORPORATED	7	J	24N	5W	BASIN	DAKOTA	3,773	42	4,054	44
APACHE FEDERAL	13E	XTO ENERGY INCORPORATED	7	K	24N	5W	BASIN	DAKOTA	748	4	1,029	5
APACHE	15E	ELM RIDGE RESOURCES INCORPORATED	7	C	24N	5W	BASIN	DAKOTA	532	8	1,288	15
APACHE	15R	ELM RIDGE RESOURCES INCORPORATED	7	G	24N	5W	BASIN	DAKOTA	277	7	616	12
APACHE FEDERAL	8	XTO ENERGY INCORPORATED	8	D	24N	5W	BASIN	DAKOTA	1,820	26	2,101	28
APACHE FEDERAL	11	XTO ENERGY INCORPORATED	8	J	24N	5W	BASIN	DAKOTA	2,252	11	2,355	11
APACHE FEDERAL	8E	XTO ENERGY INCORPORATED	8	A	24N	5W	BASIN	DAKOTA	352	2	407	3
APACHE FEDERAL	11E	XTO ENERGY INCORPORATED	8	L	24N	5W	BASIN	DAKOTA	688	2	998	3
NORTHEAST HAYNES	1E	CONOCOPHILLIPS COMPANY	9	O	24N	5W	BASIN	DAKOTA	688	6	688	6
JICARILLA L	4	UNION TEXAS PETROLEUM CORPORATION	9	G	24N	5W	BASIN	DAKOTA	907	13	907	13
NORTHEAST HAYNES	1	CONOCOPHILLIPS COMPANY	9	L	24N	5W	BASIN	DAKOTA	2,158	21	2,391	21
NORTHEAST HAYNES	3E	CONOCOPHILLIPS COMPANY	16	L	24N	5W	BASIN	DAKOTA	780	5	1,131	5
NORTHEAST HAYNES	2	CONOCOPHILLIPS COMPANY	16	D	24N	5W	BASIN	DAKOTA	2,144	21	2,183	21
NORTHEAST HAYNES	3	CONOCOPHILLIPS COMPANY	16	P	24N	5W	BASIN	DAKOTA	2,841	16	3,054	16
NORTHEAST HAYNES	2E	CONOCOPHILLIPS COMPANY	16	G	24N	5W	BASIN	DAKOTA	901	6	1,085	6
APACHE FEDERAL	9	XTO ENERGY INCORPORATED	17	D	24N	5W	BASIN	DAKOTA	1,711	13	1,711	13
APACHE FEDERAL	12F	ELM RIDGE RESOURCES INCORPORATED	17	L	24N	5W	BASIN	DAKOTA	301	10	825	25
APACHE FEDERAL	12	FLOYD OIL COMPANY	17	J	24N	5W	BASIN	DAKOTA	2,426	26	2,426	26
ER APACHE	1	ELM RIDGE RESOURCES INCORPORATED	17	G	24N	5W	BASIN	DAKOTA	266	16	712	24
APACHE FEDERAL	12E	ELM RIDGE RESOURCES INCORPORATED	17	M	24N	5W	BASIN	DAKOTA	227	0	227	0
APACHE	12R	ELM RIDGE RESOURCES INCORPORATED	17	P	24N	5W	BASIN	DAKOTA	166	21	599	33
APACHE FEDERAL	10	XTO ENERGY INCORPORATED	18	J	24N	5W	BASIN	DAKOTA	1,247	11	1,247	11
APACHE FEDERAL	14	XTO ENERGY INCORPORATED	18		24N	5W	BASIN	DAKOTA	1,530	19	1,662	20

APACHE FEDERAL	10E	XTO ENERGY INCORPORATED	18	N	24N	5W	BASIN	DAKOTA	499	1	651	1
APACHE	2	ELM RIDGE RESOURCES INCORPORATED	18	B	24N	5W	BASIN	DAKOTA	335	4	762	5
Average									1,042	10	1,262	12
JICARILLA B	1	FOUR STAR OIL & GAS COMPANY	6		24N	5W	BALLARD	PICTURED CLIFF	446	0	479	0
JICARILLA B	27	FOUR STAR OIL & GAS COMPANY	6	O	24N	5W	BALLARD	PICTURED CLIFF	134	0	139	0
JICARILLA B	25	FOUR STAR OIL & GAS COMPANY	6		24N	5W	BALLARD	PICTURED CLIFF	223	0	301	0
APACHE FEDERAL	4	XTO ENERGY INCORPORATED	7		24N	5W	BALLARD	PICTURED CLIFF	420	0	470	0
APACHE FEDERAL	6	XTO ENERGY INCORPORATED	7	G	24N	5W	BALLARD	PICTURED CLIFF	1,202	0	1,425	0
APACHE FEDERAL	15	XTO ENERGY INCORPORATED	7		24N	5W	BALLARD	PICTURED CLIFF	278	0	409	0
APACHE FEDERAL	2	XTO ENERGY INCORPORATED	8	M	24N	5W	BALLARD	PICTURED CLIFF	469	0	581	0
NORTHEAST HAYNES	12	CONOCOPHILLIPS COMPANY	16	O	24N	5W	BALLARD	PICTURED CLIFF	469	0	549	0
JICARILLA BR A	2	CONOCOPHILLIPS COMPANY	16	M	24N	5W	BALLARD	PICTURED CLIFF	585	0	585	0
APACHE FEDERAL	7	XTO ENERGY INCORPORATED	17	G	24N	5W	BALLARD	PICTURED CLIFF	199	0	213	0
APACHE FEDERAL	1	XTO ENERGY INCORPORATED	17	N	24N	5W	BALLARD	PICTURED CLIFF	673	0	704	0
APACHE FEDERAL	5	XTO ENERGY INCORPORATED	18	H	24N	5W	BALLARD	PICTURED CLIFF	439	0	509	0
Average									461	0	530	0

Dakota
Pictured Cliffs

Gas Curr	Oil CUM	Gas EUR	Oil EUR
(mmcf)	(mbo)	(mmcf)	(mbo)
1,042	10	1,262	12
461	0	530	0

% Oil % Water % Gas
Dakota 100 100 70
Pictured Cliffs 0 0 30