

Henry B. Foster
District I
P.O. Box 1980, Hobbs, NM
DEPUTY OIL & GAS INSPECTOR
District II
P.O. Drawer DD, Artesia, NM 88221
District III
1000 Rio Brazos Rd, Aztec, NM 87410
MAR 28 1997

State of New Mexico
Energy, Minerals and Natural Resources Department

SUBMIT 1 COPY TO
APPROPRIATE
DISTRICT OFFICE
AND 1 COPY TO
SANTA FE OFFICE

OIL CONSERVATION DIVISION

2040 South Pacheco Street
Santa Fe, New Mexico 87505

Approval **PIT REMEDIATION AND CLOSURE REPORT**

Operator: PNM Gas Services (Amoco) **Telephone:** 324-3764

Address: 603 W. Elm Street Farmington, NM 87401

Facility or Well Name: Kutz Federal #12

Location: Unit: M Sec. 21 T. 28 N R. 10 W County San Juan

Pit Type: Separator ☐ Dehydrator ☒ Other _____

Land Type: BLM ☒ State ☐ Fee ☐ Other _____

Pit Location: Pit dimensions: length 15 width 15 depth 3

(Attach diagram) Reference: wellhead ☒ other _____

Footage from reference: 90'

Direction from reference: 10 Degrees ☒ East North ☒
of
☐ West South ☐

Depth to Ground Water:

Less than 50 feet	(20 points)	
50 feet to 99 feet	(10 points)	
Greater than 100 feet	(0 points)	<u>0</u>

(Vertical distance from contaminants to seasonal high water elevation of ground water)

Wellhead Protection Area:

(Less than 200 feet from a private domestic water source, or; less than 1,000 feet from all other water sources)

Yes (20 points)
No (0 points) 0

Distance to Surface Water:

(Horizontal distance to perennial lakes, ponds, rivers, streams, creeks, irrigation canals and ditches)

Less than 200 feet	(20 points)	
200 feet to 1,000 feet	(10 points)	
Greater than 1,000 feet	(0 points)	<u>0</u>

RANKING SCORE (TOTAL POINTS) : 0

RECEIVED
JAN 24 1997
OIL CON. DIV.
DIST. 3

Date Remediation Started:

10/7/96

Date Completed:

10/7/96

Remediation Method:

Excavation

☒

Approx. Cubic Yard

130

(Check all appropriate sections)

Landfarmed

☒

Amount Landfarmed (cubic yds)

130

Other

Remediation Location:

Onsite

☒

Offsite

(i.e., landfarmed onsite, name and location of offsite facility)

Backfill Material Location:

General Description of Remedial Action:

Excavated contaminated to pit size of 28'x25'x5' and landfarmed soil onsite within a bermed area at a depth of 6" to 12". Soil was aerated by plowing/disking until soil met regulatory levels.

Ground Water Encountered:

No



Yes



Depth

Final Pit Closure Sampling:

Sample Location

4 pt composite- Pit Bottom (4 Side Walls Composite Attached)

(if multiple samples, attach sample result and diagram of sample locations and depths.)

Sample depth

5'

Sample date

10/7/96

Sample time

10:30:00 AM

Sample Results

Benzene (ppm)

0.1281

Total BTEX (ppm)

9.0428

Field headspace (ppm)

TPH

27.4

Method

8015A

Vertical Extent (ft)

Risk Assessment form attached

Yes



No



Ground Water Sample:

Yes



No



(If yes, attach sample results)

I HEREBY CERTIFY THAT THE INFORMATION ABOVE IS TRUE AND COMPLETE TO THE BEST OF MY KNOWLEDGE AND MY BELIEF

DATE

January 22, 1997

SIGNATURE



PRINTED NAME
AND TITLEDenver Bearden
Administrator III

Kutz Federal # 12
Amoco Production Company
Sec. 21, 28N, 10W, 4th "M"

10-7-96

10° E of N

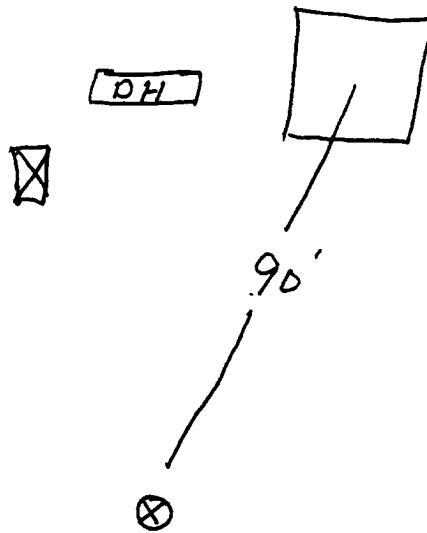
Start of Excavation:



Excavated pit: 28' x 25' x 5' = 130 yds.

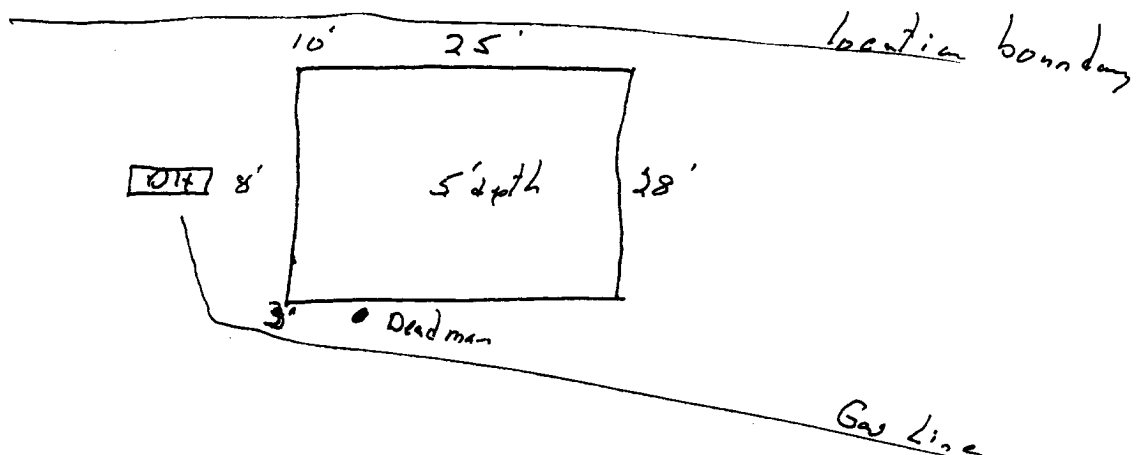

OFF: (505) 325-5667



LAB: (505) 325-1556

Diesel Range Organics

Attn: *Denver Bearden*
Company: *PNM Gas Services*
Address: *603 W. Elm*
City, State: *Farmington, NM 87401*

Date: *11-Oct-96*
COC No.: *5073*
Sample No. *12474*
Job No. *2-1000*

Project Name: ***PNM Gas Services - Kutz Federal #12***
Project Location: ***9610071015; 4pt. Composite, Walls, 4'***
Sampled by: GC Date: *7-Oct-96* Time: *10:15*
Analyzed by: BV Date: *11-Oct-96*
Sample Matrix: *Soil*

Laboratory Analysis

<i>Parameter</i>	<i>Result</i>	<i>Unit of Measure</i>	<i>Detection Limit</i>	<i>Unit of Measure</i>
<i>Diesel Range Organics (C10 - C28)</i>	<i><5.0</i>	<i>mg/kg</i>	<i>5.0</i>	<i>mg/kg</i>

Quality Assurance Report

DRO QC No.: *0489-QC*

Calibration Check

<i>Parameter</i>	<i>Method Blank</i>	<i>Unit of Measure</i>	<i>True Value</i>	<i>Analyzed Value</i>	<i>% Diff</i>	<i>Limit</i>
<i>Diesel Range (C10 - C28)</i>	<i><5.0</i>	<i>ppm</i>	<i>100</i>	<i>108</i>	<i>8.5</i>	<i>15%</i>

Matrix Spike

<i>Parameter</i>	<i>1 - Percent Recovered</i>	<i>2 - Percent Recovered</i>	<i>Limit</i>	<i>%RSD</i>	<i>Limit</i>
<i>Diesel Range (C10-C28)</i>	<i>105</i>	<i>114</i>	<i>(70-130)</i>	<i>6</i>	<i>20%</i>

Method - SW-846 EPA Method 8015A mod. - Nonhalogenated Volatile Hydrocarbons by Gas Chromatography

Approved by: *Dan G*

Date: *10/17/96*

OFF: (505) 325-5667



LAB: (505) 325-1556

AROMATIC VOLATILE ORGANICS

Attn: *Denver Bearden*
Company: *PNM Gas Services*
Address: *603 W. Elm*
City, State: *Farmington, NM 87401*

Date: *11-Oct-96*
COC No.: *5073*
Sample No.: *12474*
Job No.: *2-1000*

Project Name: *PNM Gas Services - Kutz Federal #12*
Project Location: *9610071015; 4pt. Composite, Walls, 4'*
Sampled by: *GC* Date: *7-Oct-96* Time: *10:15*
Analyzed by: *DC* Date: *11-Oct-96*
Sample Matrix: *Soil*

Laboratory Analysis

Parameter	Result	Unit of Measure	Detection Limit	Unit of Measure
Benzene	0.9	ug/kg	0.2	ug/kg
Toluene	4.0	ug/kg	0.2	ug/kg
Ethylbenzene	<0.2	ug/kg	0.2	ug/kg
m,p-Xylene	8.8	ug/kg	0.2	ug/kg
o-Xylene	3.0	ug/kg	0.2	ug/kg
TOTAL		16.6		ug/kg

Method - SW-846 EPA Method 8020 Aromatic Volatile Organics by Gas Chromatography

Approved by: *[Signature]*
Date: *10/14/96*

P.O. BOX 2606 • FARMINGTON, NM 87499

- TECHNOLOGY BLENDING INDUSTRY WITH THE ENVIRONMENT -

OFF: (505) 325-5667



LAB: (505) 325-1556

Diesel Range Organics

Attn: *Denver Bearden*
Company: *PNM Gas Services*
Address: *603 W. Elm*
City, State: *Farmington, NM 87401*

Date: *11-Oct-96*
COC No.: *5073*
Sample No. *12476*
Job No. *2-1000*

Project Name: *PNM Gas Services - Kutz Federal #12*
Project Location: *9610071030; Bottom, 5'*
Sampled by: *GC* Date: *7-Oct-96* Time: *10:30*
Analyzed by: *BV* Date: *11-Oct-96*
Sample Matrix: *Soil*

Laboratory Analysis

<i>Parameter</i>	<i>Result</i>	<i>Unit of Measure</i>	<i>Detection Limit</i>	<i>Unit of Measure</i>
<i>Diesel Range Organics (C10 - C28)</i>	<i>27.4</i>	<i>mg/kg</i>	<i>5.0</i>	<i>mg/kg</i>

Quality Assurance Report

DRO QC No.: *0489-QC*

Calibration Check

<i>Parameter</i>	<i>Method Blank</i>	<i>Unit of Measure</i>	<i>True Value</i>	<i>Analyzed Value</i>	<i>% Diff</i>	<i>Limit</i>
<i>Diesel Range (C10 - C28)</i>	<i>< 5.0</i>	<i>ppm</i>	<i>100</i>	<i>108</i>	<i>8.5</i>	<i>15%</i>

Matrix Spike

<i>Parameter</i>	<i>1 - Percent Recovered</i>	<i>2 - Percent Recovered</i>	<i>Limit</i>	<i>%RSD</i>	<i>Limit</i>
<i>Diesel Range (C10-C28)</i>	<i>105</i>	<i>114</i>	<i>(70-130)</i>	<i>6</i>	<i>20%</i>

Method - SW-846 EPA Method 8015A mod. - Nonhalogenated Volatile Hydrocarbons by Gas Chromatography

Approved by: *[Signature]*

Date: *10/14/96*

P.O. BOX 2606 • FARMINGTON, NM 87499

- TECHNOLOGY BLENDING INDUSTRY WITH THE ENVIRONMENT -

OFF: (505) 325-5667



LAB: (505) 325-1556

AROMATIC VOLATILE ORGANICS

Attn: *Denver Bearden*
Company: *PNM Gas Services*
Address: *603 W. Elm*
City, State: *Farmington, NM 87401*

Date: 14-Oct-96
COC No.: 5073
Sample No. 12476
Job No. 2-1000

Project Name: *PNM Gas Services - Kutz Federal #12*

Project Location: *9610071030; Bottom, 5'*

Sampled by: GC Date: 7-Oct-96 Time: 10:30

Analyzed by: DC Date: 14-Oct-96

Sample Matrix: *Soil*

Laboratory Analysis

Parameter	Result	Unit of Measure	Detection Limit	Unit of Measure
<i>Benzene</i>	128.1	ug/kg	0.2	ug/kg
<i>Toluene</i>	789.3	ug/kg	0.2	ug/kg
<i>Ethylbenzene</i>	575.9	ug/kg	0.2	ug/kg
<i>m,p-Xylene</i>	6190.9	ug/kg	0.2	ug/kg
<i>o-Xylene</i>	1358.6	ug/kg	0.2	ug/kg
	TOTAL	9042.8		ug/kg

Method - SW-846 EPA Method 8020 Aromatic Volatile Organics by Gas Chromatography

Approved by: 
Date: 10/14/96

P.O. BOX 2606 • FARMINGTON, NM 87499

- TECHNOLOGY BLENDING INDUSTRY WITH THE ENVIRONMENT -

Kutz Federal # 12
Amoco
Sec. 21, 28N, 10W

11-12-96

Land farm: On location

Composite sample # 961112 1010

Soil vapo, headspace PID reading = 19.1 ppm

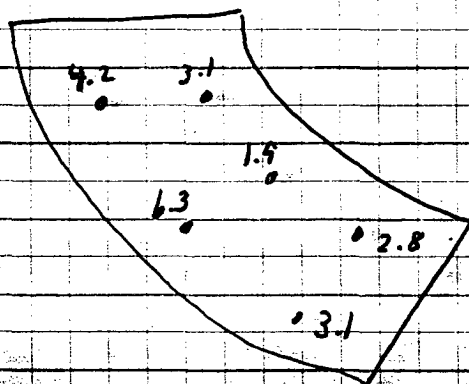

2"-12" depth

OFF: (505) 325-5667



LAB: (505) 325-1556

Diesel Range Organics

Attn: *Denver Bearden*
 Company: *PNM Gas Services*
 Address: *603 W. Elm*
 City, State: *Farmington, NM 87401*

Date: *14-Nov-96*
 COC No.: *5123*
 Sample No. *12846*
 Job No. *2-1000*

Project Name: *PNM Gas Services - Kutz Federal #12 Landfarm*
 Project Location: *9611121110; 6pt. Composite, 2"-12" depth*
 Sampled by: *GC* Date: *12-Nov-96* Time: *11:10*
 Analyzed by: *DC/HR* Date: *13-Nov-96*
 Sample Matrix: *Soil*

Laboratory Analysis

<i>Parameter</i>	<i>Result</i>	<i>Unit of Measure</i>	<i>Detection Limit</i>	<i>Unit of Measure</i>
<i>Diesel Range Organics (C10 - C28)</i>	<i><5.0</i>	<i>mg/kg</i>	<i>5.0</i>	<i>mg/kg</i>

Quality Assurance ReportDRO QC No.: *0512-QC****Calibration Check***

<i>Parameter</i>	<i>Method Blank</i>	<i>Unit of Measure</i>	<i>True Value</i>	<i>Analyzed Value</i>	<i>% Diff</i>	<i>Limit</i>
<i>Diesel Range (C10 - C28)</i>	<i><5.0</i>	<i>ppm</i>	<i>100</i>	<i>100</i>	<i>0.5</i>	<i>15%</i>

Matrix Spike

<i>Parameter</i>	<i>1- Percent Recovered</i>	<i>2 - Percent Recovered</i>	<i>Limit</i>	<i>%RSD</i>	<i>Limit</i>
<i>Diesel Range (C10-C28)</i>	<i>100</i>	<i>104</i>	<i>(70-130)</i>	<i>3</i>	<i>20%</i>

Method - SW-846 EPA Method 8015A mod. - Nonhalogenated Volatile Hydrocarbons by Gas ChromatographyApproved by: Date: *11/14/96*

P.O. BOX 2606 • FARMINGTON, NM 87499

- TECHNOLOGY BLENDING INDUSTRY WITH THE ENVIRONMENT -