

1625 N. French Dr., Hobbs, NM 88240
 District II
 1301 W. Grand Avenue, Artesia, NM 88210
 District III
 1000 Rio Brazos Road, Aztec, NM 87410
 District IV
 1220 S. St. Francis Dr., Santa Fe, NM 87505

State of New Mexico
 Energy Minerals and Natural Resources

Form C-144
 June 1, 2004

Oil Conservation Division
 1220 South St. Francis Dr.
 Santa Fe, NM 87505

For drilling and production facilities, submit to appropriate NMOCD District Office.
 For downstream facilities, submit to Santa Fe office

Pit or Below-Grade Tank Registration or Closure

Is pit or below-grade tank covered by a "general plan"? Yes No
 Type of action: Registration of a pit or below-grade tank Closure of a pit or below-grade tank

Operator: ConocoPhillips Company Telephone: (505)599-3419 e-mail address: Juanita.F.farrell@conocophillips.com
 Address: 5525 Highway 64 Farmington, NM 87401
 Facility or well name: SAN JUAN 30-5 UNIT 88M API#: 30-039-27087 U/l or Qtr/Qtr E Sec 18 T 30N R 5W
 County: RIO ARRIBA Latitude _____ Longitude _____ NAD: 1927 1983 Surface Owner Federal State Private Indian

Pit	Below-grade tank	
Type: Drilling <input checked="" type="checkbox"/> Production <input type="checkbox"/> Disposal <input type="checkbox"/> Workover <input type="checkbox"/> Emergency <input type="checkbox"/> Lined <input checked="" type="checkbox"/> Unlined <input type="checkbox"/> Liner type: Synthetic <input checked="" type="checkbox"/> Thickness <u>12</u> mil Clay <input type="checkbox"/> Pit Volume _____ bbl	Volume: _____ bbl Type of fluid: _____ Construction material: _____ Double-walled, with leak detection? Yes <input type="checkbox"/> If not, explain why not. _____	
Depth to ground water (vertical distance from bottom of pit to seasonal high water elevation of ground water.)	Less than 50 feet 50 feet or more, but less than 100 feet 100 feet or more	(20 points) (10 points) (0 points)
Wellhead protection area: (Less than 200 feet from a private domestic water source, or less than 1000 feet from all other water sources.)	Yes No	(20 points) (0 points)
Distance to surface water: (horizontal distance to all wetlands, playas, irrigation canals, ditches, and perennial and ephemeral watercourses.)	Less than 200 feet 200 feet or more, but less than 1000 feet 1000 feet or more	(20 points) (10 points) (0 points)
	Ranking Score (Total Points)	

If this is a pit closure: (1) attach a diagram of the facility showing the pit's relationship to other equipment and tanks. (2) Indicate disposal location: (check the onsite box if you are burying in place) onsite offsite If offsite, name of facility _____ (3) Attach a general description of remedial action taken including remediation start date and end date. (4) Groundwater encountered: No Yes If yes, show depth below ground surface _____ ft. and attach sample results. (5) Attach soil sample results and a diagram of sample locations and excavations.

Additional Comments:
 This drill pit was closed on 11/16/2004 in accordance with Rule 50 and as per the November 1, 2004 Guidelines
 GW: 50 - 100' WHP: > 1000' SW: > 1000'

I hereby certify that the information above is true and complete to the best of my knowledge and belief. I further certify that the above-described pit or below-grade tank has been/will be constructed or closed according to NMOCD guidelines , a general permit , or an (attached) alternative OCD-approved plan .
 Date: 03/18/2005

Printed Name/Title Juanita Farrell Regulatory Analyst Signature Juanita Farrell

Your certification and NMOCD approval of this application/closure does not relieve the operator of liability should the contents of the pit or tank contaminate ground water or otherwise endanger public health or the environment. Nor does it relieve the operator of its responsibility for compliance with any other federal, state, or local laws and/or regulations.

Approval: DEPUTY OIL & GAS INSPECTOR, DIST. 30 Signature Denny Farrell Date: MAR 23 2005

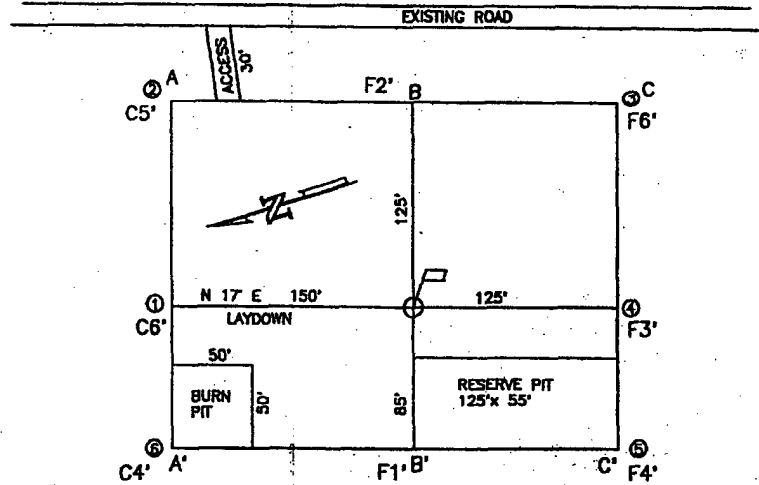

A-A' ELEVATION C/L

6379				
6369				
6359				
6349				
6339				

B-B' C/L

6379				
6369				
6359				
6349				
6339				

C-C' C/L

6379				
6369				
6359				
6349				
6339				

COMPANY: PHILLIPS PETROLEUM CO.

LEASE: SAN JUAN 30-5 UNIT NO. 88M

FOOTAGE: 2110 FNL 1072 FWL UNIT E

SEC. 18 TWN. 30 N RNG. 5 W N.M.P.M.

COUNTY: RIO ARRIBA STATE: N.M.

ELEVATION: 6359

LATITUDE: 36-48-49

LONGITUDE: 107-24-12

PHILLIPS PETROLEUM CO.
FARMINGTON, NEW MEXICO

66

SURVEYED: 3/14/01	REV. DATE:	APP. BY:
DRAWN BY: K.REA	DATE DRAWN: 3/18/01	FILE NAME: UF128

UNITED FIELD SERVICES INC.

P.O. BOX 3681
FARMINGTON, NM 87489
OFFICE: (505)334-0408