

District I
1625 N. French Dr., Hobbs, NM 88240
District II
1301 W. Grand Avenue, Artesia, NM 88210
District III
1000 Rio Brazos Road, Aztec, NM 87410
District IV
1220 S. St. Francis Dr., Santa Fe, NM 87505

State of New Mexico
Energy Minerals and Natural Resources

Form C-144
June 1, 2004

Oil Conservation Division
1220 South St. Francis Dr.
Santa Fe, NM 87505

For drilling and production facilities, submit to appropriate NMOCD District Office.
For downstream facilities, submit to Santa Fe office

Pit or Below-Grade Tank Registration or Closure

Is pit or below-grade tank covered by a "general plan"? Yes ☐ No ☒

Type of action: Registration of a pit or below-grade tank ☐ Closure of a pit or below-grade tank ☒

Operator: <u>ConocoPhillips Company</u> Telephone: <u>(505)599-3419</u> e-mail address: <u>juanita.r.farrell@conocophillips.com</u>		
Address: <u>5525 Highway 64 Farmington, NM 87401</u>		
Facility or well name: <u>SAN JUAN 30-5 UNIT 218A</u> API#: <u>30-039-27768</u> U/I or Qtr/Qtr <u>O</u> Sec <u>17</u> T <u>30N</u> R <u>5W</u>		
County: <u>RIO ARRIBA</u> Latitude _____ Longitude _____ NAD: 1927 <input type="checkbox"/> 1983 <input type="checkbox"/> Surface Owner Federal <input type="checkbox"/> State <input type="checkbox"/> Private <input checked="" type="checkbox"/> Indian <input type="checkbox"/>		
Pit Type: Drilling <input checked="" type="checkbox"/> Production <input type="checkbox"/> Disposal <input type="checkbox"/> Workover <input type="checkbox"/> Emergency <input type="checkbox"/> Lined <input checked="" type="checkbox"/> Unlined <input type="checkbox"/> Liner type: Synthetic <input checked="" type="checkbox"/> Thickness <u>12</u> mil Clay <input type="checkbox"/> Pit Volume _____ bbl	Below-grade tank Volume: _____ bbl Type of fluid: _____ Construction material: _____ Double-walled, with leak detection? Yes <input type="checkbox"/> If not, explain why not. _____	
Depth to ground water (vertical distance from bottom of pit to seasonal high water elevation of ground water.)	Less than 50 feet	(20 points)
	50 feet or more, but less than 100 feet	(10 points)
	100 feet or more	(0 points)
Wellhead protection area: (Less than 200 feet from a private domestic water source, or less than 1000 feet from all other water sources.)	Yes	(20 points)
	No	(0 points)
Distance to surface water: (horizontal distance to all wetlands, playas, irrigation canals, ditches, and perennial and ephemeral watercourses.)	Less than 200 feet	(20 points)
	200 feet or more, but less than 1000 feet	(10 points)
	1000 feet or more	(0 points)
Ranking Score (Total Points)		

If this is a pit closure: (1) attach a diagram of the facility showing the pit's relationship to other equipment and tanks. (2) Indicate disposal location: (check the onsite box if you are burying in place) onsite ☒ offsite ☐ If offsite, name of facility _____ (3) Attach a general description of remedial action taken including remediation start date and end date. (4) Groundwater encountered: No ☒ Yes ☐ If yes, show depth below ground surface _____ ft. and attach sample results. (5) Attach soil sample results and a diagram of sample locations and excavations.

Additional Comments:
This drill pit was closed on 11/29/2004 in accordance with Rule 50 and as per the November 1, 2004 Guidelines
GW: 50 - 100' WHP: > 1000' SW: > 1000'

I hereby certify that the information above is true and complete to the best of my knowledge and belief. I further certify that the above-described pit or below-grade tank has been/will be constructed or closed according to NMOCD guidelines <input checked="" type="checkbox"/> , a general permit <input type="checkbox"/> , or an (attached) alternative OCD-approved plan <input type="checkbox"/> .		
Date: <u>03/18/2005</u>		
Printed Name/Title: <u>Juanita Farrell</u>	Regulatory Analyst	Signature: <u>Juanita Farrell</u>
Your certification and NMOCD approval of this application/closure does not relieve the operator of liability should the contents of the pit or tank contaminate ground water or otherwise endanger public health or the environment. Nor does it relieve the operator of its responsibility for compliance with any other federal, state, or local laws and/or regulations.		
Approval: <u>DEPUTY OIL & GAS INSPECTOR, DIST. #3</u>	Signature: <u>Denny Farrell</u>	Date: <u>MAR 23 2005</u>

CONOCOPHILLIPS COMPANY SAN JUAN 30-5 UNIT #218A
 1200' FSL & 1400' FEL, SECTION 17, T30N, R5W, NMMP
 RIO ARriba COUNTY, NEW MEXICO, ELEVATION: 6361

50' CONSTRUCTION ZONE

LATITUDE: 36.80861° N
 LONGITUDE: 107.37639° W
 DATUM: WGS84

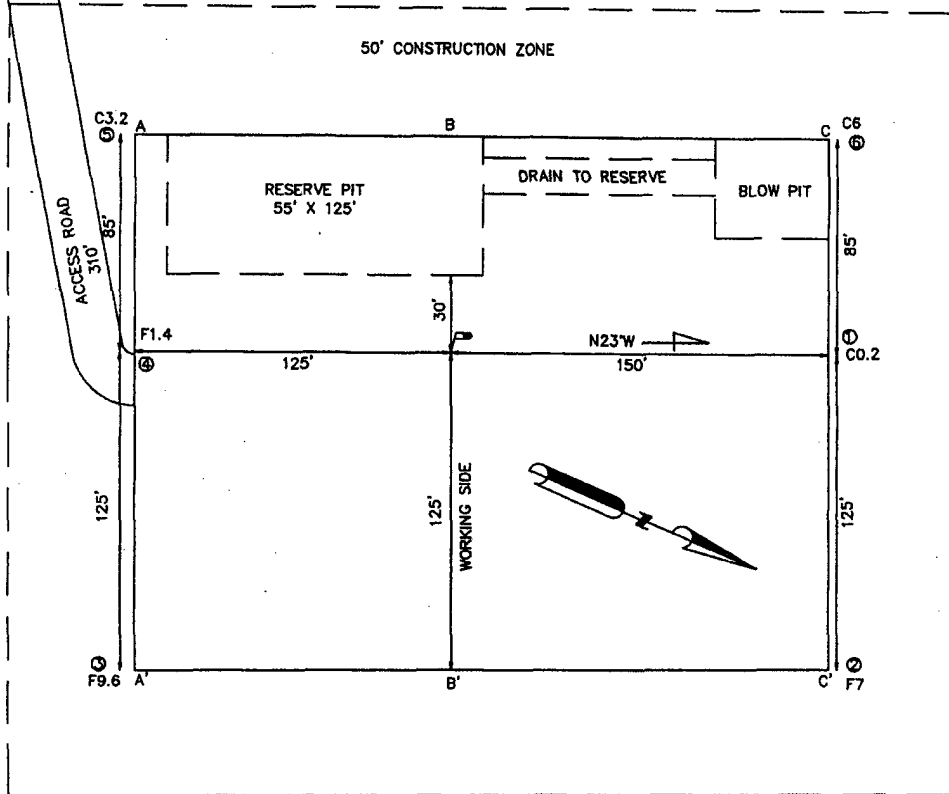

PLAT NOTE:

SURFACE OWNER
 ARMONDO ESPINOSO

