

**UNITED STATES
DEPARTMENT OF THE INTERIOR
BUREAU OF LAND MANAGEMENT**

RECEIVED

AUG 17 2011

Sundry Notices and Reports on Wells

Farmington Field Office
Bureau of Land Management

1. Type of Well
GAS

2. Name of Operator
BURLINGTON
RESOURCES OIL & GAS COMPANY LP

3. Address & Phone No. of Operator

PO Box 4289, Farmington, NM 87499 (505) 326-9700

4. Location of Well, Footage, Sec., T, R, M

Unit A (NENE), 785' FNL & 900' FEL, Section 22, T27N, R4W, NMPM

5. Lease Number
NMSF-080674

6. If Indian, All. or
Tribe Name

7. Unit Agreement Name
San Juan 27-4 Unit

8. Well Name & Number
San Juan 27-4 Unit 143B

9. API Well No.

30-039-30327

10. Field and Pool
Blanco MV

11. County and State
Rio Arriba, NM

12. CHECK APPROPRIATE BOX TO INDICATE NATURE OF NOTICE, REPORT, OTHER DATA

Type of Submission

☐ Notice of Intent

☒ Subsequent Report

☐ Final Abandonment

Type of Action

☐ Abandonment

☐ Recompletion

☐ Plugging

☐ Casing Repair

☐ Altering Casing

☐ Change of Plans

☐ New Construction

☐ Non-Routine Fracturing

☐ Water Shut off

☐ Conversion to Injection

☒ Other - ☐ Cathodic

13. Describe Proposed or Completed Operations

Attached is a drawing for the placement of the cathodic ground, rectifier and cable for the subject well.

14. I hereby certify that the foregoing is true and correct.

Signed Denise Journey Denise Journey

Title: Staff Regulatory Technician

Date 8-16-11

(This space for Federal or State Office use)

APPROVED BY _____ Title _____

Date _____

CONDITION OF APPROVAL, if any:

Title 18 U.S.C. Section 1001, makes it a crime for any person knowingly and willfully to make any department or agency of the United States any false, fictitious or fraudulent statements or representations as to any matter within its jurisdiction

ACCEPTED FOR RECORD

AUG 18 2011

NMOCD

**FARMINGTON FIELD OFFICE
BY MR**

PC



TECHNICAL SERVICES
A CORROSION COMPANY

CATHODIC PROTECTION PLAN FOR NEW WELLS

WELL NAME SJ 27-4 #143B LEGALS 22-27-4 COUNTY B. Ariz.

PURPOSED C.P. SYSTYEM: Drill G.B. and set cathode in horizontal casing. Run approx 850' of #8 poly. cable from cath to wellhead

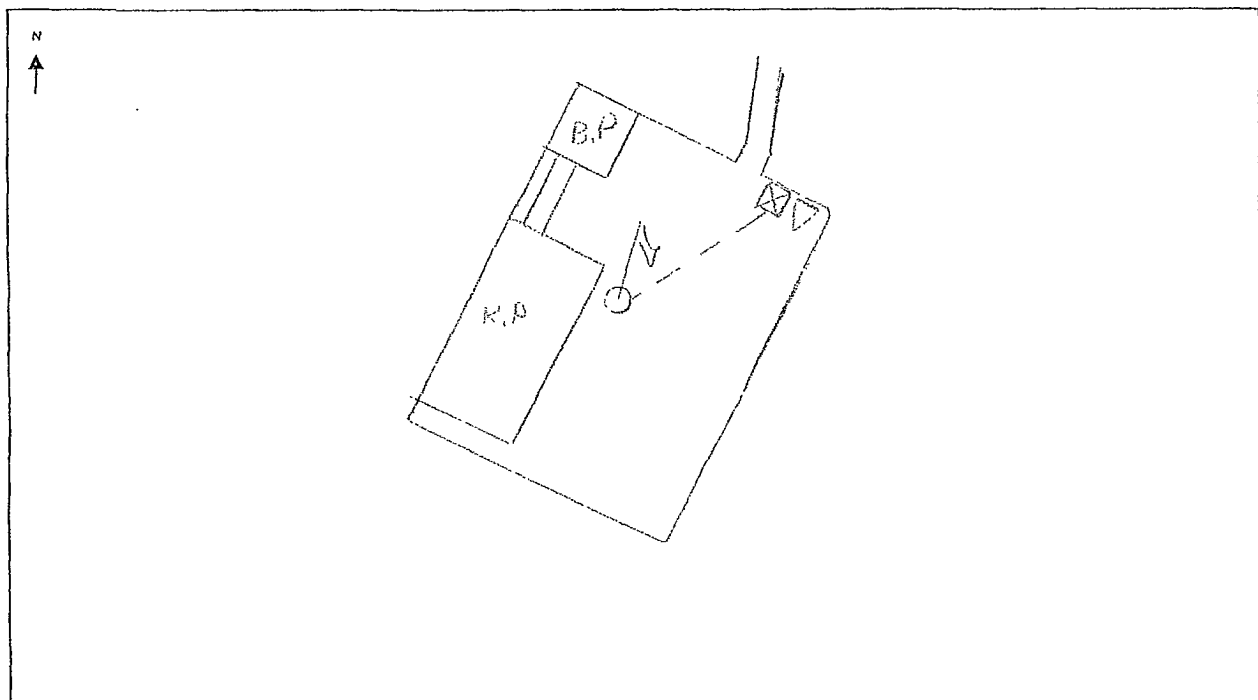

EXISTING WELLHEAD	METER HOUSE	G.B.	POWER SOURCE	CABLE	NEW WELL	OVERHEAD A.C.

COMMENTS: _____

NEAREST POWER SOURCE N/A DISTANCE: _____

PIPELINES IN AREA: N/A

TECHNICIAN: Wick Cepinaga DATE: 11/21/2000