

District I
1625 N. French Dr., Hobbs, NM 88240
District II
1301 W. Grand Avenue, Artesia, NM 88210
District III
1000 Rio Brazos Road, Aztec, NM 87410
District IV
1220 S. St. Francis Dr., Santa Fe, NM 87505

State of New Mexico
Energy Minerals and Natural Resources

Form C-144
June 1, 2004

Oil Conservation Division
1220 South St. Francis Dr.
Santa Fe, NM 87505

For drilling and production facilities, submit to appropriate NMOC District Office.
For downstream facilities, submit to Santa Fe office

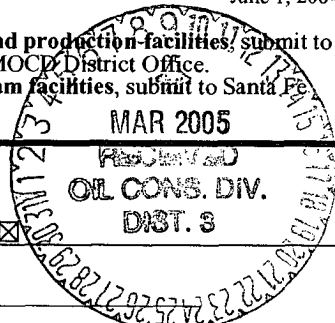

Pit or Below-Grade Tank Registration or Closure

Is pit or below-grade tank covered by a "general plan"? Yes ☐ No ☐

Type of action: Registration of a pit or below-grade tank ☐ Closure of a pit or below-grade tank ☒

Operator: Pure Resources **HEC** Telephone: 970-259-1374 e-mail address: _____
Address: 463 Turner Drive Facility or well name: State 16-1E API #: 30045242980000 U/L or Qtr/Qtr SW/NE Sec 16 T 26N R 7W
County: San Juan Latitude _____ Longitude _____ NAD: 1927 ☐ 1983 ☐
Surface Owner: Federal ☐ State ☐ Private ☒ Indian ☐

Pit

Type: Drilling ☐ Production ☐ Disposal ☒

Workover ☐ Emergency ☐

Lined ☐ Unlined ☒

Liner type: Synthetic ☐ Thickness _____ mil Clay ☐

Pit Volume _____ bbl

Below-grade tank

Volume: _____ bbl Type of fluid: _____

Construction material: _____

Double-walled, with leak detection? Yes ☐ If not, explain why not. _____

Depth to ground water (vertical distance from bottom of pit to seasonal high water elevation of ground water.)

Less than 50 feet

(20 points)

50 feet or more, but less than 100 feet

(10 points)

100 feet or more X

(0 points) 0

Wellhead protection area: (Less than 200 feet from a private domestic water source, or less than 1000 feet from all other water sources.)

Yes

(20 points)

No

X

(0 points) 0

Distance to surface water: (horizontal distance to all wetlands, playas, irrigation canals, ditches, and perennial and ephemeral watercourses.)

Less than 200 feet

(20 points)

200 feet or more, but less than 1000 feet

(10 points)

1000 feet or more X

(0 points) 0

Ranking Score (Total Points)

0

If this is a pit closure: (1) Attach a diagram of the facility showing the pit's relationship to other equipment and tanks. (2) Indicate disposal location: (check the onsite box if you are burying in place) onsite ☐ offsite ☒ If offsite, name of facility: Industrial Ecosystems Inc. (3) Attach a general description of remedial action taken including remediation start date and end date. (4) Groundwater encountered: No ☒ Yes ☐ If yes, show depth below ground surface _____ ft. and attach sample results. (5) Attach soil sample results and a diagram of sample locations and excavations.

Additional Comments: Separator Pit

I hereby certify that the information above is true and complete to the best of my knowledge and belief. I further certify that the above-described pit or below-grade tank has been/will be constructed or closed according to NMOC guidelines ☒, a general permit ☐, or an (attached) alternative OCD-approved plan ☐.

Date: 3/3/05

Printed Name/Title John Hagstrom as Agent for Pure Resources

Signature [Signature]

Your certification and NMOC approval of this application/closure does not relieve the operator of liability should the contents of the pit or tank contaminate ground water or otherwise endanger public health or the environment. Nor does it relieve the operator of its responsibility for compliance with any other federal, state, or local laws and/or regulations.

Approval: DEPUTY OIL & GAS INSPECTOR, DIST. 3

Printed Name/Title _____

Signature [Signature]

Date: MAR - 9 2005



February 28, 2005

SMA Project: 5114698

RE: Remedial activities for Pit Closure at the State **16-1E**. SW/NE, Sec. 16, T 26N, R 7W, Dakota, San Juan County NM. State Lease LG 3571. API 30045242980000.

On February 1, 2005, excavation of the unlined separator pit at the State 16-1E began. The dimensions of the unlined pit were approximately 15X15X1 feet. Remedial excavation was needed based on laboratory analysis of a previous characterization sample, collected and analyzed for Diesel Range Organics (DRO), Gasoline Range Organics (GRO), and BTEX, on November 2, 2004. The analysis showed results of:

November 2, 2004	DRO ppm	GRO ppm	BTEX ppm
Separator Center Pit Bottom	1620	31.8	4040

BDL: Below Detection Limits

No sidewall sample was collected as the pit was only one (1) foot in depth. The pit was excavated using a backhoe. The excavated soils were lightly stained, with a hydrocarbon odor to a depth of approximately three feet below ground surface (bgs). The soil type was poorly graded sand extending from ground surface to the vertical extent of the excavation. The extent of the excavation was approximately 15X15X6 feet. On February 1, 2005, a soil sample was collected from the center pit bottom, and a four-point composite soil sample was collected from the sidewalls for field analysis by PID. Both the center pit bottom sample showed a PID reading of 0 units, and the sidewall composite showed a PID reading of 0 units. Soil samples for closure were collected for laboratory analysis. A double wall steel tank pit was installed in the excavation. The excavation was then backfilled using clean native soils. 30 cubic yards of soil were excavated from the pit and properly disposed of at Industrial Ecosystems Inc., #81 CR 3520 Aztec, NM 87410. Backfilling was completed on February 2, 2005. The backfill was wheel compacted and mounded against future settling. The laboratory analysis of the closure samples collected on February 1, 2005 showed hydrocarbon levels of:

February 3, 2005	DRO ppm	GRO ppm	BTEX ppm
4 Point Sidewall	BDL	BDL	BDL
Center Pit Bottom	BDL	BDL	BDL

BDL: Below Detection Limits

Based on the laboratory analysis, on behalf of our client, Pure Resources, SMA requests closure for this pit. Groundwater was not encountered.

Respectfully submitted,

John Hagstrom
Environmental Technician
Souder, Miller and Associates

Tel. (505) 325-5667

Fax (505) 327-1496

P. O. BOX 2606 • FARMINGTON, NM 87499

-TECHNOLOGY BLENDING INDUSTRY WITH THE ENVIRONMENT-

SUBJECT STOTE 16-1E

PROJECT 5114688

PAGE 1

CLIENT PUNE RESOURCES

DATE 11/2/2009

BY

N 25 W SEC 11, T 24 N, R 7 W 163571

CHECKED

BY JAL

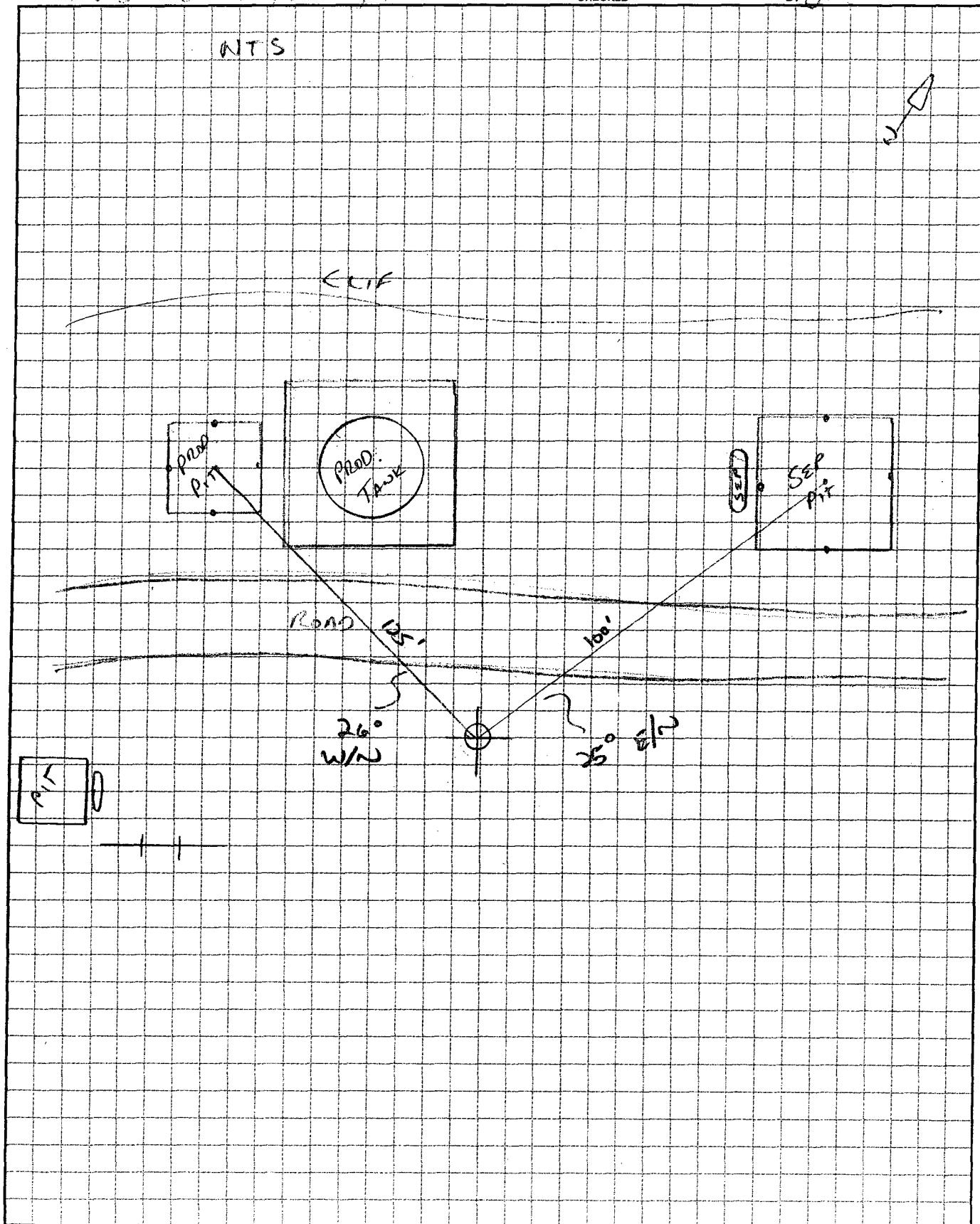

612 E. Murray Drive
Farmington, NM 87499

Off: (505) 327-1072
FAX: (505) 327-1496

iiná bá

P.O. Box 3788
Shiprock, NM 87420

Off: (505) 368-4065

ANALYTICAL REPORT

Date: 17-Nov-04

CLIENT: Souder, Miller & Associates
Work Order: 0411005
Project: 5114698 State 16-1 E
Lab ID: 0411005-002A

Client Sample Info: STATE 16-1 E
Client Sample ID: Sep. Pit CP
Collection Date: 11/2/2004 9:15:00 AM
Matrix: SOIL

Parameter	Result	PQL	Qual	Units	DF	Date Analyzed
DIESEL RANGE ORGANICS		SW8015B		Analyst: JEM		
T/R Hydrocarbons: C10-C28	1620	25.0		mg/Kg	1	11/4/2004
Surr: o-Terphenyl	107	57-136		%REC	1	11/4/2004
GASOLINE RANGE ORGANICS		SW8015B		Analyst: JEM		
T/R Hydrocarbons: C6-C10	31.8	4.50		mg/Kg	25	11/4/2004
Surr: Trifluorotoluene	112	84-149		%REC	25	11/4/2004
AROMATIC VOLATILES BY GC/PID		SW8021B		Analyst: JEM		
Benzene	ND	25		µg/Kg	25	11/10/2004
Ethylbenzene	200	25		µg/Kg	25	11/10/2004
m,p-Xylene	1200	50		µg/Kg	25	11/10/2004
o-Xylene	340	25		µg/Kg	25	11/10/2004
Toluene	2300	50		µg/Kg	25	11/10/2004
Surr: 1,4-Difluorobenzene	83.2	75-110		%REC	25	11/10/2004
Surr: 4-Bromochlorobenzene	94.2	40-135		%REC	25	11/10/2004
Surr: Fluorobenzene	87.3	69-110		%REC	25	11/10/2004

Qualifiers: ND - Not Detected at the Practical Quantitation Limit
J - Analyte detected below Practical Quantitation Limit
B - Analyte detected in the associated Method Blank
H - Parameter exceeded Maximum Allowable Holding Time
S - Spike Recovery outside accepted recovery limits
R - RPD outside accepted precision limits
E - Value above Upper Quantitation Limit - UQL

Page 2 of 2

MAINTAINING HARMONY BETWEEN MAN AND HIS ENVIRONMENT

612 E. Murray Drive
Farmington, NM 87499

Off: (505) 327-1072

FAX: (505) 327-1496

ANALYTICAL REPORT

iiná bá

P.O. Box 3788
Shiprock, NM 87420

Off: (505) 368-4065

Date: 11-Feb-05

CLIENT: Souder, Miller & Associates
Work Order: 0502004
Project: STATE 16-1E Pure Resources/5114698
Lab ID: 0502004-001A

Client Sample Info: STATE 16-1E Pure Resources
Client Sample ID: SEP PIT SW 4PT COMP.
Collection Date: 2/1/2005 11:00:00 AM
Matrix: SOIL

Parameter	Result	PQL	Qual	Units	DF	Date Analyzed
GASOLINE RANGE ORGANICS		SW8015B		Analyst: JEM		
T/R Hydrocarbons: C6-C10	ND	4.50		mg/Kg	25	2/2/2005
Surr: Trifluorotoluene	90.6	84-149		%REC	25	2/2/2005
AROMATIC VOLATILES BY GC/PID		SW8021B		Analyst: JEM		
Benzene	ND	25		µg/Kg	25	2/3/2005
Ethylbenzene	ND	25		µg/Kg	25	2/3/2005
m,p-Xylene	ND	50		µg/Kg	25	2/3/2005
Methyl tert-Butyl Ether	ND	250		µg/Kg	25	2/3/2005
o-Xylene	ND	25		µg/Kg	25	2/3/2005
Toluene	ND	50		µg/Kg	25	2/3/2005
Surr: 1,4-Difluorobenzene	86.0	75-110		%REC	25	2/3/2005
Surr: 4-Bromochlorobenzene	99.0	40-135		%REC	25	2/3/2005
Surr: Fluorobenzene	76.6	69-110		%REC	25	2/3/2005

Qualifiers:
ND - Not Detected at the Practical Quantitation Limit
J - Analyte detected below Practical Quantitation Limit
B - Analyte detected in the associated Method Blank
H - Parameter exceeded Maximum Allowable Holding Time

S - Spike Recovery outside accepted recovery limits
R - RPD outside accepted precision limits
E - Value above Upper Quantitation Limit - UQL

612 E. Murray Drive
Farmington, NM 87499

Off: (505) 327-1072

FAX: (505) 327-1496

ANALYTICAL REPORT

iiná bá

P.O. Box 3788
Shiprock, NM 87420

Off: (505) 368-4065

Date: 11-Feb-05

CLIENT: Souder, Miller & Associates
Work Order: 0502004
Project: STATE 16-1E Pure Resources/5114698
Lab ID: 0502004-002A

Client Sample Info: STATE 16-1E Pure Resources
Client Sample ID: SEP PIT CP
Collection Date: 2/1/2005 11:00:00 AM
Matrix: SOIL

Parameter	Result	PQL	Qual	Units	DF	Date Analyzed
GASOLINE RANGE ORGANICS		SW8015B			Analyst: JEM	
T/R Hydrocarbons: C6-C10	ND	4.50		mg/Kg	25	2/2/2005
Surr: Trifluorotoluene	90.4	84-149		%REC	25	2/2/2005
AROMATIC VOLATILES BY GC/PID		SW8021B			Analyst: JEM	
Benzene	ND	25		µg/Kg	25	2/3/2005
Ethylbenzene	ND	25		µg/Kg	25	2/3/2005
m,p-Xylene	ND	50		µg/Kg	25	2/3/2005
Methyl tert-Butyl Ether	ND	250		µg/Kg	25	2/3/2005
o-Xylene	ND	25		µg/Kg	25	2/3/2005
Toluene	ND	50		µg/Kg	25	2/3/2005
Surr: 1,4-Difluorobenzene	87.1	75-110		%REC	25	2/3/2005
Surr: 4-Bromochlorobenzene	111	40-135		%REC	25	2/3/2005
Surr: Fluorobenzene	77.3	69-110		%REC	25	2/3/2005

Qualifiers:

ND - Not Detected at the Practical Quantitation Limit

J - Analyte detected below Practical Quantitation Limit

B - Analyte detected in the associated Method Blank

H - Parameter exceeded Maximum Allowable Holding Time

S - Spike Recovery outside accepted recovery limits

R - RPD outside accepted precision limits

E - Value above Upper Quantitation Limit - UQL

Page 2 of 4