

District I
1625 N. French Dr., Hobbs, NM 88240
District II
1331 W. Grand Avenue, Artesia, NM 88210
District III
1000 Rio Brazos Road, Aztec, NM 87410
District IV
1220 S. St. Francis Dr., Santa Fe, NM 87505

State of New Mexico
Energy Minerals and Natural Resources
Department
Oil Conservation Division
1220 South St. Francis Dr.
Santa Fe, NM 87505

Form C-144 CLEZ
July 21, 2008

For closed-loop systems that only use above ground steel tanks or haul-off bins and propose to implement waste removal for closure, submit to the appropriate NMOCD District Office.

3352

Closed-Loop System Permit or Closure Plan Application

(that only use above ground steel tanks or haul-off bins and propose to implement waste removal for closure)

Type of action: Permit ☒ Closure

Instructions: Please submit one application (Form C-144 CLEZ) per individual closed-loop system request. For any application request other than for a closed-loop system that only use above ground steel tanks or haul-off bins and propose to implement waste removal for closure, please submit a Form C-144. Please be advised that approval of this request does not relieve the operator of liability should operations result in pollution of surface water, ground water or the environment. Nor does approval relieve the operator of its responsibility to comply with any other applicable governmental authority's rules, regulations or ordinances.

Operator: <u>Energen Resources Corporation</u>		OGRID #: <u>162928</u>	RCVD APR 3 '09
Address: <u>2010 Afton Place, Farmington, NM 87401</u>		OIL CONS. DIV.	
Facility or well name: <u>Rowley #1</u>		DIST. 3	
API Number: <u>30-045-06697</u>		OCD Permit Number: _____	
U/L or Qtr/Qtr: <u>NW/4</u>	Section: <u>08</u>	Township: <u>27N</u>	Range: <u>10W</u> County: <u>San Juan</u>
Center of Proposed Design: Latitude <u>36.59229</u>		Longitude <u>107.92396</u>	NAD: <input type="checkbox"/> 1927 <input checked="" type="checkbox"/> 1983
Surface Owner: <input checked="" type="checkbox"/> Federal <input type="checkbox"/> State <input type="checkbox"/> Private <input type="checkbox"/> Tribal Trust or Indian Allotment			

<input checked="" type="checkbox"/> Closed-loop System: Subsection H of 19.15.17.11 NMAC	
Operation: <input type="checkbox"/> Drilling a new well <input type="checkbox"/> Workover or Drilling (Applies to activities which require prior approval of a permit or notice of intent) <input checked="" type="checkbox"/> P&A	
<input checked="" type="checkbox"/> Above Ground Steel Tanks or <input type="checkbox"/> Haul-off Bins	

Signs: Subsection C of 19.15.17.11 NMAC		RCVD MAY 13 '09 OIL CONS. DIV. DIST. 3
<input type="checkbox"/> 12"x 24", 2" lettering, providing Operator's name, site location, and emergency telephone numbers		
<input checked="" type="checkbox"/> Signed in compliance with 19.15.3.103 NMAC		

4 Closed-loop Systems Permit Application Attachment Checklist: Subsection B of 19.15.17.9 NMAC	
Instructions: Each of the following items must be attached to the application. Please indicate, by a check mark in the box, that the documents are attached.	
<input checked="" type="checkbox"/> Design Plan - based upon the appropriate requirements of 19.15.17.11 NMAC	
<input checked="" type="checkbox"/> Operating and Maintenance Plan - based upon the appropriate requirements of 19.15.17.12 NMAC	
<input checked="" type="checkbox"/> Closure Plan (Please complete Box 5) - based upon the appropriate requirements of Subsection C of 19.15.17.9 NMAC and 19.15.17.13 NMAC	
<input type="checkbox"/> Previously Approved Design (attach copy of design)	API Number: _____
<input type="checkbox"/> Previously Approved Operating and Maintenance Plan	API Number: _____

5 Waste Removal Closure For Closed-loop Systems That Utilize Above Ground Steel Tanks or Haul-off Bins Only: (19.15.17.13.D NMAC)	
Instructions: Please identify the facility or facilities for the disposal of liquids, drilling fluids and drill cuttings. Use attachment if more than two facilities are required.	
Disposal Facility Name: <u>Envirotech</u>	Disposal Facility Permit Number: <u>NM-1-0011</u>
Disposal Facility Name: <u>Aqua Moss Pretty Lady #1</u>	Disposal Facility Permit Number: <u>30-045-30922</u>
Will any of the proposed closed-loop system operations and associated activities occur on or in areas that will not be used for future service and operations? <input type="checkbox"/> Yes (If yes, please provide the information below) <input checked="" type="checkbox"/> No	
Required for impacted areas which will not be used for future service and operations:	
<input type="checkbox"/> Soil Backfill and Cover Design Specifications - based upon the appropriate requirements of Subsection H of 19.15.17.13 NMAC	
<input type="checkbox"/> Re-vegetation Plan - based upon the appropriate requirements of Subsection I of 19.15.17.13 NMAC	
<input type="checkbox"/> Site Reclamation Plan - based upon the appropriate requirements of Subsection G of 19.15.17.13 NMAC	

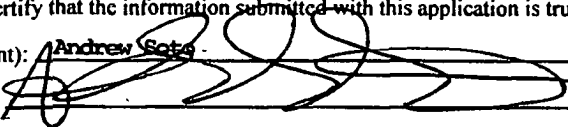
6 Operator Application Certification:	
I hereby certify that the information submitted with this application is true, accurate and complete to the best of my knowledge and belief.	
Name (Print): <u>Andrew Soto</u>	Title: <u>District Engineer</u>
Signature: 	Date: <u>3/31/09</u>
e-mail address: <u>asoto@energen.com</u>	Telephone: <u>505.324.4143</u>

4

7

OCD Approval:

☒ Permit Application (including closure plan)☒ Closure Plan (only)

OCD Representative Signature:

Brandon Bell

Approval Date:

10/06/2011

Title:

Environ/Spec

OCD Permit Number:

Compliance Officer

8

Closure Report (required within 60 days of closure completion): Subsection K of 19.15.17.13 NMAC*Instructions: Operators are required to obtain an approved closure plan prior to implementing any closure activities and submitting the closure report. The closure report is required to be submitted to the division within 60 days of the completion of the closure activities. Please do not complete this section of the form until an approved closure plan has been obtained and the closure activities have been completed.*☒ Closure Completion Date:4-29-09

9

Closure Report Regarding Waste Removal Closure For Closed-loop Systems That Utilize Above Ground Steel Tanks or Haul-off Bins Only:*Instructions: Please indentify the facility or facilities for where the liquids, drilling fluids and drill cuttings were disposed. Use attachment if more than two facilities were utilized.*

Disposal Facility Name:

Enviro tech

Disposal Facility Permit Number:

NM-1-0011

Disposal Facility Name:

Aqua Moss Pretty Lady #1

Disposal Facility Permit Number:

30-045-30922

Were the closed-loop system operations and associated activities performed on or in areas that will not be used for future service and operations?

☐ Yes (If yes, please demonstrate compliance to the items below) ☒ No*Required for impacted areas which will not be used for future service and operations:*

- ☐ Site Reclamation (Photo Documentation)
- ☐ Soil Backfilling and Cover Installation
- ☐ Re-vegetation Application Rates and Seeding Technique

10

Operator Closure Certification:

I hereby certify that the information and attachments submitted with this closure report is true, accurate and complete to the best of my knowledge and belief. I also certify that the closure complies with all applicable closure requirements and conditions specified in the approved closure plan.

Name (Print):

Andres Soto

Title:

District Engr

Signature:

[Signature]

Date:

5-7-09

e-mail address:

asoto@energen.com

Telephone:

325-6800

Closed-loop Design Plan:

Our closed loop system will not entail a drying pad, temporary pit, below grade tank or sump. It will entail an above ground tank suitable for holding the cuttings and fluids for rig operations. The tank will be of sufficient volume to maintain a safe free board between disposal of the liquids and solids from rig operations.

- 1) Fencing is not required for an above ground closed-loop system.
- 2) It will be signed in compliance with 19.15.3.103 NMAC.
- 3) A frac tank will be on location to store fresh water.

Closed-loop Operating and Maintenance Plan:

The closed-loop tank will be operated and maintained; to contain liquids and solids, to aid in the prevention of contamination of fresh water sources, in order to protect public health and the environment. To attain this goal the following steps will be followed:

- 1) The liquids will be vacuumed out and disposed of at the Agua Moss Pretty Lady #1 facility (Disposal API Number 30-045-30922). Solids in the closed-loop tank will be vacuumed out and disposed of at Envirotech (Permit Number NM-01-0011) on a periodic basis to prevent over topping.
- 2) No hazardous waste, miscellaneous solid waste or debris will be discharged into or stored in the tank. Only fluids or cuttings used or generated by rig operations will be placed or stored in the tank.
- 3) The division district office will be notified within 48 hours of the discovery of compromised integrity of the closed-loop tank. Upon the discovery of the compromised tank, repairs will be enacted immediately.
- 4) All of the above operations will be inspected and a log will be signed and dated. During rig operations the inspection will be daily.

Closed-loop Closure Plan:

The closed loop tank will be closed in accordance with 19.15.17.13. This will be done by transporting cuttings and all remaining sludge to Envirotech (Permit Number NM-01-0011) following rig operations. All remaining liquids will be transported and disposed of in the Agua Moss Pretty Lady #1 facility (Disposal API number 30-045-30922). The tanks will be removed from the location as part of the rig move. At time of well abandonment, the site will be reclaimed and re-vegetated to pre-existing conditions when possible.

COMPANY El Paso Natural Gas Company

Well Name & No. Rowley No. 1

Lease No. SF077875

Location 1650 from the North line 990 from the West line

Being in the SW⁴ of the NW⁴

Sec. 8, T27N., R10W., N.M.P.M., San Juan County, New Mexico

Ground Elevation 6074.77

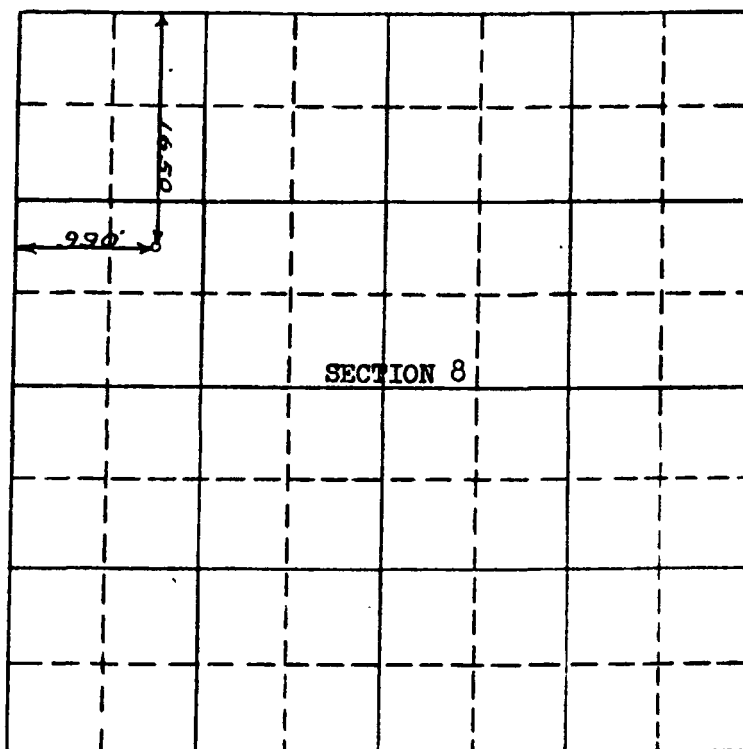

RECEIVED
NOV 10 1952
U. S. GEOLOGICAL SURVEY
FARMINGTON, N. M.

N

Scale -- 4 inches equals 1 mile

Surveyed January 4, 19 52

This is to certify that the above plat was prepared from field notes of actual surveys made by me or under my supervision and that the same are true and correct to the best of my knowledge and belief.

C. O. Walker
Registered Professional
Engineer and Land Surveyor.

Seal:

Farmington, New Mexico