

RECEIVED

**UNITED STATES
DEPARTMENT OF THE INTERIOR
BUREAU OF LAND MANAGEMENT**

JAN 05 2012

Sundry Notices and Reports on Wells

Farmington Field Office
Bureau of Land Management1. Type of Well
GAS5. Lease Number
SF-0808546. If Indian, All. or
Tribe Name

2. Name of Operator

7. Unit Agreement Name
San Juan 32-8 Unit**ConocoPhillips**

3. Address & Phone No. of Operator

8. Well Name & Number
San Juan 32-8 Unit 15N

PO Box 4289, Farmington, NM 87499 (505) 326-9700

9. API Well No.

30-045-35170

4. Location of Well, Footage, Sec., T, R, M

10. Field and Pool
Blanco MV/Basin DK

Unit L (NWSW), 1375' FSL & 836' FWL, Section 24, T31N, R8W, NMPM

Unit K (NESW), 1889' FSL & 1880' FWL, Section 24, T31N, R8W, NMPM

11. County and State
San Juan, NM**12. CHECK APPROPRIATE BOX TO INDICATE NATURE OF NOTICE, REPORT, OTHER DATA**

Type of Submission

Type of Action

☐ Notice of Intent☐ Abandonment☐ Change of Plans☒ Other — Cathodic☒ Subsequent Report☐ Recompletion☐ New Construction☐ Plugging☐ Non-Routine Fracturing☐ Casing Repair☐ Water Shut off☒ Final Abandonment☐ Altering Casing☐ Conversion to Injection

RCVD JAN 11 '12

OIL CONS. DIV.

DIST. 3

13. Describe Proposed or Completed Operations

Attached is a drawing for the placement of the cathodic ground, rectifier and cable for the subject well.

ACCEPTED FOR RECORD

JAN 06 2012

FARMINGTON FIELD OFFICE
BY [Signature]**14. I hereby certify that the foregoing is true and correct.**

Signed

[Signature]

Denise Journey

Title Staff Regulatory TechnicianDate 1/4/2012

(This space for Federal or State Office use)

APPROVED BY _____ Title _____ Date _____

CONDITION OF APPROVAL, if any:

Title 18 U.S.C. Section 1001, makes it a crime for any person knowingly and willfully to make any department or agency of the United States any false, fictitious or fraudulent statements or representations as to any matter within its jurisdiction

NMOCD A

San Juan 32-8 #15N

Section 24, T31N, R08W, N.M.P.M., San Juan County, NM

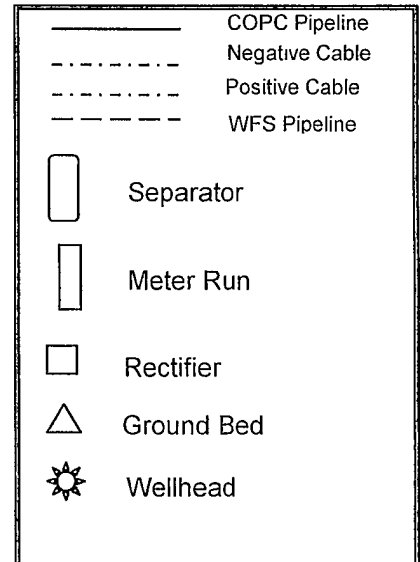
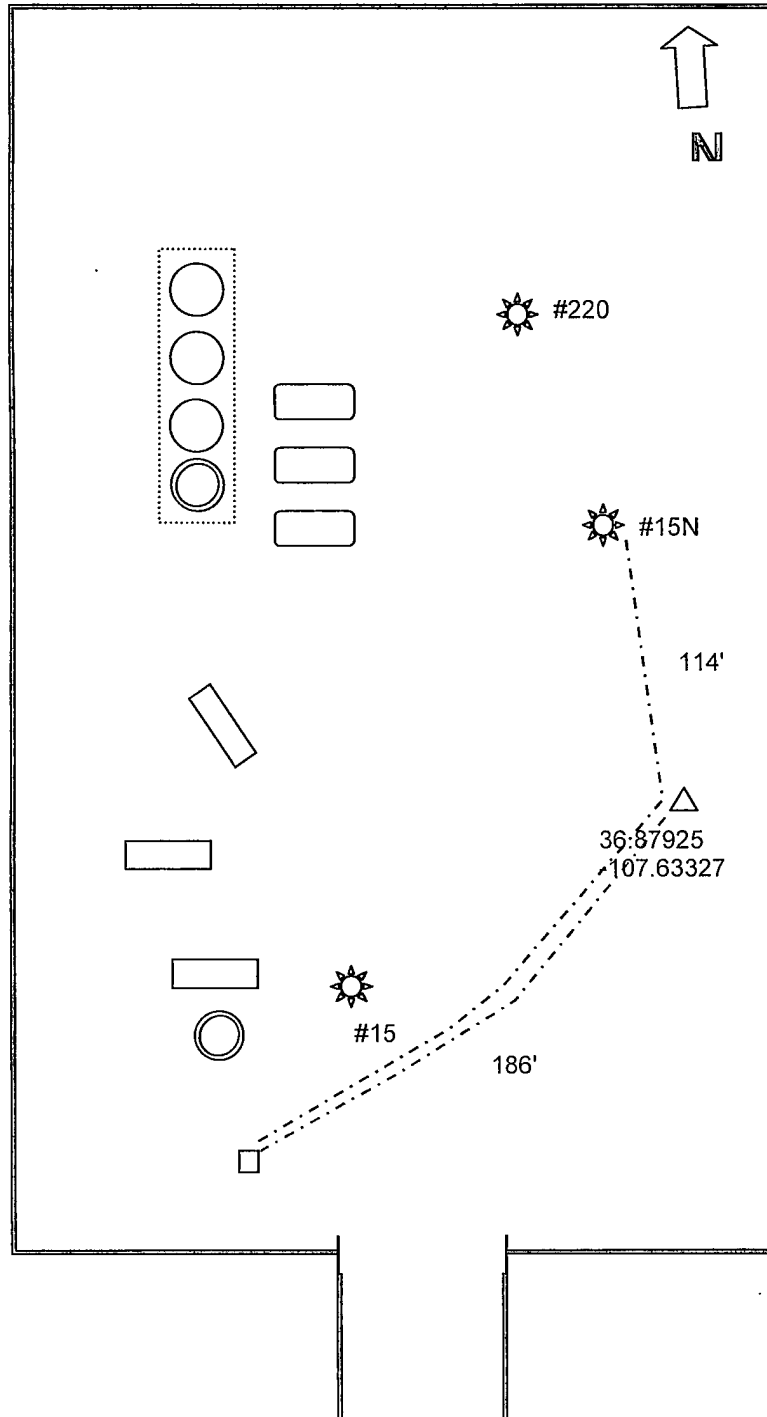

Drill ground bed approximately 114 south of #15N wellhead at staked location. Replace rectifier located on 32-8 #15 location with a 4016 3-lug rectifier and connect to ground bed and #15N wellhead. Reconnect old ground bed, #15 and #220 wellheads. Repair cables as required.

#15N Cables:

Negative: 300'

Positive: 186'

Total Ditch: 300'