

District I
1625 N French Dr, Hobbs, NM 88240
District II
1301 W Grand Avenue, Artesia, NM 88210
District III
1000 Rio Brazos Road, Aztec, NM 87410
District IV
1220 S St Francis Dr, Santa Fe, NM 87505

State of New Mexico
Energy Minerals and Natural Resources
Department
Oil Conservation Division
1220 South St. Francis Dr.
Santa Fe, NM 87505

Form C-144
July 21, 2008

For temporary pits, closed-loop systems, and below-grade tanks, submit to the appropriate NMOCD District Office
For permanent pits and exceptions submit to the Santa Fe Environmental Bureau office and provide a copy to the appropriate NMOCD District Office.

29605

Pit, Closed-Loop System, Below-Grade Tank, or
Proposed Alternative Method Permit or Closure Plan Application

Type of action: ☐ Permit of a pit, closed-loop system, below-grade tank, or proposed alternative method
☒ Closure of a pit, closed-loop system, below-grade tank, or proposed alternative method
☐ Modification to an existing permit
☒ Closure plan only submitted for an existing permitted or non-permitted pit, closed-loop system, below-grade tank, or proposed alternative method

Instructions: Please submit one application (Form C-144) per individual pit, closed-loop system, below-grade tank or alternative request

Please be advised that approval of this request does not relieve the operator of liability should operations result in pollution of surface water, ground water or the environment. Nor does approval relieve the operator of its responsibility to comply with any other applicable governmental authority's rules, regulations or ordinances.

1.
Operator: Williams Operating Co, LLC OGRID #: 120782
Address: PO Box 640 / 721 S Main Aztec, NM 87410
Facility or well name: Rosa Unit #377A
API Number: 3003929925 OCD Permit Number: _____
U/L or Qtr/Qtr F Section 26 Township 31N Range 5W County Rio Arriba
Center of Proposed Design. Latitude 36.87262N Longitude -107.33406W NAD: ☐ 1927 ☒ 1983
Surface Owner. ☒ Federal ☐ State ☐ Private ☐ Tribal Trust or Indian Allotment

2.
☒ **Pit:** Subsection F or G of 19.15.17.11 NMAC
Temporary: ☒ Drilling ☐ Workover
☐ Permanent ☐ Emergency ☐ Cavitation ☐ P&A
☐ Lined ☒ Unlined Liner type. Thickness _____ mil ☐ LLDPE ☐ HDPE ☐ PVC ☐ Other _____
☐ String-Reinforced
Liner Seams: ☐ Welded ☒ Factory ☐ Other _____ Volume: 20,000 bbl Dimensions: L 140 W 10 H 12



3.
☐ **Closed-loop System:** Subsection H of 19.15.17.11 NMAC
Type of Operation: ☐ P&A ☐ Drilling a new well ☐ Workover or Drilling (Applies to activities which require prior approval of a permit or notice of intent)
☐ Drying Pad ☐ Above Ground Steel Tanks ☐ Haul-off Bins ☐ Other _____
☐ Lined ☐ Unlined Liner type Thickness _____ mil ☐ LLDPE ☐ HDPE ☐ PVC ☐ Other _____
Liner Seams ☐ Welded ☐ Factory ☐ Other _____

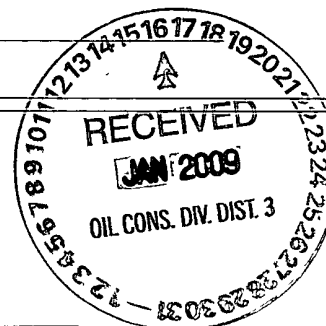

4.
☐ **Below-grade tank:** Subsection I of 19.15.17.11 NMAC
Volume: _____ bbl Type of fluid _____
Tank Construction material: _____
☐ Secondary containment with leak detection ☐ Visible sidewalls, liner, 6-inch lift and automatic overflow shut-off
☐ Visible sidewalls and liner ☐ Visible sidewalls only ☐ Other _____
Liner type. Thickness _____ mil ☐ HDPE ☐ PVC ☐ Other _____

5.
☐ **Alternative Method:**
Submittal of an exception request is required. Exceptions must be submitted to the Santa Fe Environmental Bureau office for consideration of approval.

6.

Fencing: Subsection D of 19.15.17.11 NMAC (*Applies to permanent pits, temporary pits, and below-grade tanks*)

- ☐ Chain link, six feet in height, two strands of barbed wire at top (*Required if located within 1000 feet of a permanent residence, school, hospital, institution or church*)
- ☐ Four foot height, four strands of barbed wire evenly spaced between one and four feet
- ☒ Alternate. Please specify ___ per BLM APD Specifications ___

7.

Netting: Subsection E of 19 15 17.11 NMAC (*Applies to permanent pits and permanent open top tanks*)

- ☐ Screen ☐ Netting ☐ Other _____
- ☐ Monthly inspections (If netting or screening is not physically feasible)

8.

Signs: Subsection C of 19 15.17.11 NMAC

- ☐ 12"x 24", 2" lettering, providing Operator's name, site location, and emergency telephone numbers
- ☒ Signed in compliance with 19.15.3.103 NMAC

9.

Administrative Approvals and Exceptions:

Justifications and/or demonstrations of equivalency are required. Please refer to 19 15.17 NMAC for guidance

Please check a box if one or more of the following is requested, if not leave blank:

- ☒ Administrative approval(s) Requests must be submitted to the appropriate division district or the Santa Fe Environmental Bureau office for consideration of approval.
- ☐ Exception(s): Requests must be submitted to the Santa Fe Environmental Bureau office for consideration of approval.

10.

Siting Criteria (regarding permitting): 19.15.17 10 NMAC

Instructions: The applicant must demonstrate compliance for each siting criteria below in the application. Recommendations of acceptable source material are provided below. Requests regarding changes to certain siting criteria may require administrative approval from the appropriate district office or may be considered an exception which must be submitted to the Santa Fe Environmental Bureau office for consideration of approval. Applicant must attach justification for request. Please refer to 19.15.17.10 NMAC for guidance. Siting criteria does not apply to drying pads or above-grade tanks associated with a closed-loop system.

Ground water is less than 50 feet below the bottom of the temporary pit, permanent pit, or below-grade tank - NM Office of the State Engineer - iWATERS database search; USGS; Data obtained from nearby wells	<input type="checkbox"/> Yes <input type="checkbox"/> No
Within 300 feet of a continuously flowing watercourse, or 200 feet of any other significant watercourse or lakebed, sinkhole, or playa lake (measured from the ordinary high-water mark). - Topographic map; Visual inspection (certification) of the proposed site	<input type="checkbox"/> Yes <input type="checkbox"/> No
Within 300 feet from a permanent residence, school, hospital, institution, or church in existence at the time of initial application (<i>Applies to temporary, emergency, or cavitation pits and below-grade tanks</i>) - Visual inspection (certification) of the proposed site, Aerial photo, Satellite image	<input type="checkbox"/> Yes <input type="checkbox"/> No <input type="checkbox"/> NA
Within 1000 feet from a permanent residence, school, hospital, institution, or church in existence at the time of initial application (<i>Applies to permanent pits</i>) - Visual inspection (certification) of the proposed site; Aerial photo; Satellite image	<input type="checkbox"/> Yes <input type="checkbox"/> No <input type="checkbox"/> NA
Within 500 horizontal feet of a private, domestic fresh water well or spring that less than five households use for domestic or stock watering purposes, or within 1000 horizontal feet of any other fresh water well or spring, in existence at the time of initial application. - NM Office of the State Engineer - iWATERS database search; Visual inspection (certification) of the proposed site	<input type="checkbox"/> Yes <input type="checkbox"/> No
Within incorporated municipal boundaries or within a defined municipal fresh water well field covered under a municipal ordinance adopted pursuant to NMSA 1978, Section 3-27-3, as amended - Written confirmation or verification from the municipality; Written approval obtained from the municipality	<input type="checkbox"/> Yes <input type="checkbox"/> No
Within 500 feet of a wetland - US Fish and Wildlife Wetland Identification map; Topographic map; Visual inspection (certification) of the proposed site	<input type="checkbox"/> Yes <input type="checkbox"/> No
Within the area overlying a subsurface mine. - Written confirmation or verification or map from the NM EMNRD-Mining and Mineral Division	<input type="checkbox"/> Yes <input type="checkbox"/> No
Within an unstable area. - Engineering measures incorporated into the design; NM Bureau of Geology & Mineral Resources; USGS, NM Geological Society, Topographic map	<input type="checkbox"/> Yes <input type="checkbox"/> No
Within a 100-year floodplain. - FEMA map	<input type="checkbox"/> Yes <input type="checkbox"/> No

11.

Temporary Pits, Emergency Pits, and Below-grade Tanks Permit Application Attachment Checklist: Subsection B of 19.15.17.9 NMAC**Instructions:** Each of the following items must be attached to the application. Please indicate, by a check mark in the box, that the documents are attached.

- ☐ Hydrogeologic Report (Below-grade Tanks) - based upon the requirements of Paragraph (4) of Subsection B of 19.15.17.9 NMAC
☐ Hydrogeologic Data (Temporary and Emergency Pits) - based upon the requirements of Paragraph (2) of Subsection B of 19.15.17.9 NMAC
☐ Siting Criteria Compliance Demonstrations - based upon the appropriate requirements of 19.15.17.10 NMAC
☐ Design Plan - based upon the appropriate requirements of 19.15.17.11 NMAC
☐ Operating and Maintenance Plan - based upon the appropriate requirements of 19.15.17.12 NMAC
☐ Closure Plan (Please complete Boxes 14 through 18, if applicable) - based upon the appropriate requirements of Subsection C of 19.15.17.9 NMAC and 19.15.17.13 NMAC
☐ Previously Approved Design (attach copy of design) API Number: _____ or Permit Number: _____

12.

Closed-loop Systems Permit Application Attachment Checklist: Subsection B of 19.15.17.9 NMAC**Instructions:** Each of the following items must be attached to the application. Please indicate, by a check mark in the box, that the documents are attached.

- ☐ Geologic and Hydrogeologic Data (only for on-site closure) - based upon the requirements of Paragraph (3) of Subsection B of 19.15.17.9
☐ Siting Criteria Compliance Demonstrations (only for on-site closure) - based upon the appropriate requirements of 19.15.17.10 NMAC
☐ Design Plan - based upon the appropriate requirements of 19.15.17.11 NMAC
☐ Operating and Maintenance Plan - based upon the appropriate requirements of 19.15.17.12 NMAC
☐ Closure Plan (Please complete Boxes 14 through 18, if applicable) - based upon the appropriate requirements of Subsection C of 19.15.17.9 NMAC and 19.15.17.13 NMAC
☐ Previously Approved Design (attach copy of design) API Number: _____
☐ Previously Approved Operating and Maintenance Plan API Number: _____ (Applies only to closed-loop system that use above ground steel tanks or haul-off bins and propose to implement waste removal for closure)

13.

Permanent Pits Permit Application Checklist: Subsection B of 19.15.17.9 NMAC**Instructions:** Each of the following items must be attached to the application. Please indicate, by a check mark in the box, that the documents are attached.

- ☐ Hydrogeologic Report - based upon the requirements of Paragraph (1) of Subsection B of 19.15.17.9 NMAC
☐ Siting Criteria Compliance Demonstrations - based upon the appropriate requirements of 19.15.17.10 NMAC
☐ Climatological Factors Assessment
☐ Certified Engineering Design Plans - based upon the appropriate requirements of 19.15.17.11 NMAC
☐ Dike Protection and Structural Integrity Design - based upon the appropriate requirements of 19.15.17.11 NMAC
☐ Leak Detection Design - based upon the appropriate requirements of 19.15.17.11 NMAC
☐ Liner Specifications and Compatibility Assessment - based upon the appropriate requirements of 19.15.17.11 NMAC
☐ Quality Control/Quality Assurance Construction and Installation Plan
☐ Operating and Maintenance Plan - based upon the appropriate requirements of 19.15.17.12 NMAC
☐ Freeboard and Overtopping Prevention Plan - based upon the appropriate requirements of 19.15.17.11 NMAC
☐ Nuisance or Hazardous Odors, including H₂S, Prevention Plan
☐ Emergency Response Plan
☐ Oil Field Waste Stream Characterization
☐ Monitoring and Inspection Plan
☐ Erosion Control Plan
☐ Closure Plan - based upon the appropriate requirements of Subsection C of 19.15.17.9 NMAC and 19.15.17.13 NMAC

14.

Proposed Closure: 19.15.17.13 NMAC**Instructions:** Please complete the applicable boxes, Boxes 14 through 18, in regards to the proposed closure plan.

- Type. ☒ Drilling ☐ Workover ☐ Emergency ☐ Cavitation ☐ P&A ☐ Permanent Pit ☐ Below-grade Tank ☐ Closed-loop System
☐ Alternative
 Proposed Closure Method. ☐ Waste Excavation and Removal
☐ Waste Removal (Closed-loop systems only)
☒ On-site Closure Method (Only for temporary pits and closed-loop systems)
☒ In-place Burial ☐ On-site Trench Burial
☐ Alternative Closure Method (Exceptions must be submitted to the Santa Fe Environmental Bureau for consideration)

15.

Waste Excavation and Removal Closure Plan Checklist: (19.15.17.13 NMAC) **Instructions:** Each of the following items must be attached to the closure plan. Please indicate, by a check mark in the box, that the documents are attached.

- ☐ Protocols and Procedures - based upon the appropriate requirements of 19.15.17.13 NMAC
☐ Confirmation Sampling Plan (if applicable) - based upon the appropriate requirements of Subsection F of 19.15.17.13 NMAC
☐ Disposal Facility Name and Permit Number (for liquids, drilling fluids and drill cuttings)
☐ Soil Backfill and Cover Design Specifications - based upon the appropriate requirements of Subsection H of 19.15.17.13 NMAC
☐ Re-vegetation Plan - based upon the appropriate requirements of Subsection I of 19.15.17.13 NMAC
☐ Site Reclamation Plan - based upon the appropriate requirements of Subsection G of 19.15.17.13 NMAC

16.

Waste Removal Closure For Closed-loop Systems That Utilize Above Ground Steel Tanks or Haul-off Bins Only: (19.15.17.13.D NMAC)

Instructions: Please identify the facility or facilities for the disposal of liquids, drilling fluids and drill cuttings. Use attachment if more than two facilities are required.

Disposal Facility Name _____ Disposal Facility Permit Number: _____

Disposal Facility Name: _____ Disposal Facility Permit Number: _____

Will any of the proposed closed-loop system operations and associated activities occur on or in areas that *will not* be used for future service and operations?

☐ Yes (If yes, please provide the information below) ☐ No

Required for impacted areas which will not be used for future service and operations

☐ Soil Backfill and Cover Design Specifications - based upon the appropriate requirements of Subsection H of 19.15.17.13 NMAC

☐ Re-vegetation Plan - based upon the appropriate requirements of Subsection I of 19.15.17.13 NMAC

☐ Site Reclamation Plan - based upon the appropriate requirements of Subsection G of 19.15.17.13 NMAC

17.

Siting Criteria (regarding on-site closure methods only): 19.15.17.10 NMAC

Instructions: Each siting criteria requires a demonstration of compliance in the closure plan. Recommendations of acceptable source material are provided below. Requests regarding changes to certain siting criteria may require administrative approval from the appropriate district office or may be considered an exception which must be submitted to the Santa Fe Environmental Bureau office for consideration of approval. Justifications and/or demonstrations of equivalency are required. Please refer to 19.15.17.10 NMAC for guidance.

Ground water is less than 50 feet below the bottom of the buried waste.

- NM Office of the State Engineer - iWATERS database search; USGS, Data obtained from nearby wells

☐ Yes ☐ No
☐ NA

Ground water is between 50 and 100 feet below the bottom of the buried waste

- NM Office of the State Engineer - iWATERS database search, USGS, Data obtained from nearby wells

☐ Yes ☐ No
☐ NA

Ground water is more than 100 feet below the bottom of the buried waste.

- NM Office of the State Engineer - iWATERS database search, USGS; Data obtained from nearby wells

☐ Yes ☐ No
☐ NA

Within 300 feet of a continuously flowing watercourse, or 200 feet of any other significant watercourse or lakebed, sinkhole, or playa lake (measured from the ordinary high-water mark).

- Topographic map; Visual inspection (certification) of the proposed site

☐ Yes ☐ No

Within 300 feet from a permanent residence, school, hospital, institution, or church in existence at the time of initial application

- Visual inspection (certification) of the proposed site; Aerial photo; Satellite image

☐ Yes ☐ No

Within 500 horizontal feet of a private, domestic fresh water well or spring that less than five households use for domestic or stock watering purposes, or within 1000 horizontal feet of any other fresh water well or spring, in existence at the time of initial application.

- NM Office of the State Engineer - iWATERS database, Visual inspection (certification) of the proposed site

☐ Yes ☐ No

Within incorporated municipal boundaries or within a defined municipal fresh water well field covered under a municipal ordinance adopted pursuant to NMSA 1978, Section 3-27-3, as amended.

- Written confirmation or verification from the municipality; Written approval obtained from the municipality

☐ Yes ☐ No

Within 500 feet of a wetland.

- US Fish and Wildlife Wetland Identification map; Topographic map; Visual inspection (certification) of the proposed site

☐ Yes ☐ No

Within the area overlying a subsurface mine.

- Written confirmation or verification or map from the NM EMNRD-Mining and Mineral Division

☐ Yes ☐ No

Within an unstable area

- Engineering measures incorporated into the design; NM Bureau of Geology & Mineral Resources, USGS; NM Geological Society, Topographic map

☐ Yes ☐ No

Within a 100-year floodplain.

- FEMA map

☐ Yes ☐ No

18.

On-Site Closure Plan Checklist: (19.15.17.13 NMAC) **Instructions:** Each of the following items must be attached to the closure plan. Please indicate, by a check mark in the box, that the documents are attached.

☒ Siting Criteria Compliance Demonstrations - based upon the appropriate requirements of 19.15.17.10 NMAC

☒ Proof of Surface Owner Notice - based upon the appropriate requirements of Subsection F of 19.15.17.13 NMAC

☐ Construction/Design Plan of Burial Trench (if applicable) based upon the appropriate requirements of 19.15.17.11 NMAC

☐ Construction/Design Plan of Temporary Pit (for in-place burial of a drying pad) - based upon the appropriate requirements of 19.15.17.11 NMAC

☒ Protocols and Procedures - based upon the appropriate requirements of 19.15.17.13 NMAC

☒ Confirmation Sampling Plan (if applicable) - based upon the appropriate requirements of Subsection F of 19.15.17.13 NMAC

☒ Waste Material Sampling Plan - based upon the appropriate requirements of Subsection F of 19.15.17.13 NMAC

☒ Disposal Facility Name and Permit Number (for liquids, drilling fluids and drill cuttings or in case on-site closure standards cannot be achieved)

☒ Soil Cover Design - based upon the appropriate requirements of Subsection H of 19.15.17.13 NMAC

☒ Re-vegetation Plan - based upon the appropriate requirements of Subsection I of 19.15.17.13 NMAC

☒ Site Reclamation Plan - based upon the appropriate requirements of Subsection G of 19.15.17.13 NMAC

19

Operator Application Certification:

I hereby certify that the information submitted with this application is true, accurate and complete to the best of my knowledge and belief

Name (Print): _____ Title: _____

Signature: _____ Date: _____

e-mail address: _____ Telephone: _____

20

OCD Approval: ☐ Permit Application (including closure plan) ☒ Closure Plan (only) ☐ OCD Conditions (see attachment)OCD Representative Signature: Jonathan Kelly Approval Date: 6/08/2012Title: Deputy Oil & Gas Inspector, District #3 OCD Permit Number: _____

21

Closure Report (required within 60 days of closure completion): Subsection K of 19.15.17.13 NMAC*Instructions: Operators are required to obtain an approved closure plan prior to implementing any closure activities and submitting the closure report. The closure report is required to be submitted to the division within 60 days of the completion of the closure activities. Please do not complete this section of the form until an approved closure plan has been obtained and the closure activities have been completed.*☒ Closure Completion Date: 12/01/2008

22

Closure Method:☐ Waste Excavation and Removal ☒ On-Site Closure Method ☐ Alternative Closure Method ☐ Waste Removal (Closed-loop systems only)
☐ If different from approved plan, please explain.

23.

Closure Report Regarding Waste Removal Closure For Closed-loop Systems That Utilize Above Ground Steel Tanks or Haul-off Bins Only:*Instructions: Please identify the facility or facilities for where the liquids, drilling fluids and drill cuttings were disposed. Use attachment if more than two facilities were utilized.*

Disposal Facility Name _____ Disposal Facility Permit Number: _____

Disposal Facility Name: _____ Disposal Facility Permit Number: _____

Were the closed-loop system operations and associated activities performed on or in areas that *will not* be used for future service and operations?☐ Yes (If yes, please demonstrate compliance to the items below) ☐ No*Required for impacted areas which will not be used for future service and operations*

- ☐
- Site Reclamation (Photo Documentation)
-
- ☐
- Soil Backfilling and Cover Installation
-
- ☐
- Re-vegetation Application Rates and Seeding Technique

24

Closure Report Attachment Checklist: *Instructions: Each of the following items must be attached to the closure report. Please indicate, by a check mark in the box, that the documents are attached.*

- ☒
- Proof of Closure Notice (surface owner and division)
-
- ☒
- Proof of Deed Notice (required for on-site closure)
-
- ☒
- Plot Plan (for on-site closures and temporary pits)
-
- ☐
- Confirmation Sampling Analytical Results (if applicable)
-
- ☒
- Waste Material Sampling Analytical Results (required for on-site closure)
-
- ☒
- Disposal Facility Name and Permit Number
-
- ☒
- Soil Backfilling and Cover Installation
-
- ☐
- Re-vegetation Application Rates and Seeding Technique
-
- ☒
- Site Reclamation (Photo Documentation)

On-site Closure Location: Latitude 36 87262N Longitude -107.33406W NAD ☐ 1927 ☒ 1983

25

19.

Operator Application Certification:

I hereby certify that the information submitted with this application is true, accurate and complete to the best of my knowledge and belief

Name (Print): Michael K Lane Title: Sr EH & S SpecialistSignature: [Signature] Date: 1/14/09e-mail address: myke.lane@williams.com Telephone: 505-634-4219

WILLIAMS PRODUCTION COMPANY ROSA UNIT #377A
1895' FNL & 1915' FWL, SECTION 26, T31N, R5W, NMPM
RIO ARriba COUNTY, NEW MEXICO ELEVATION: 6543'

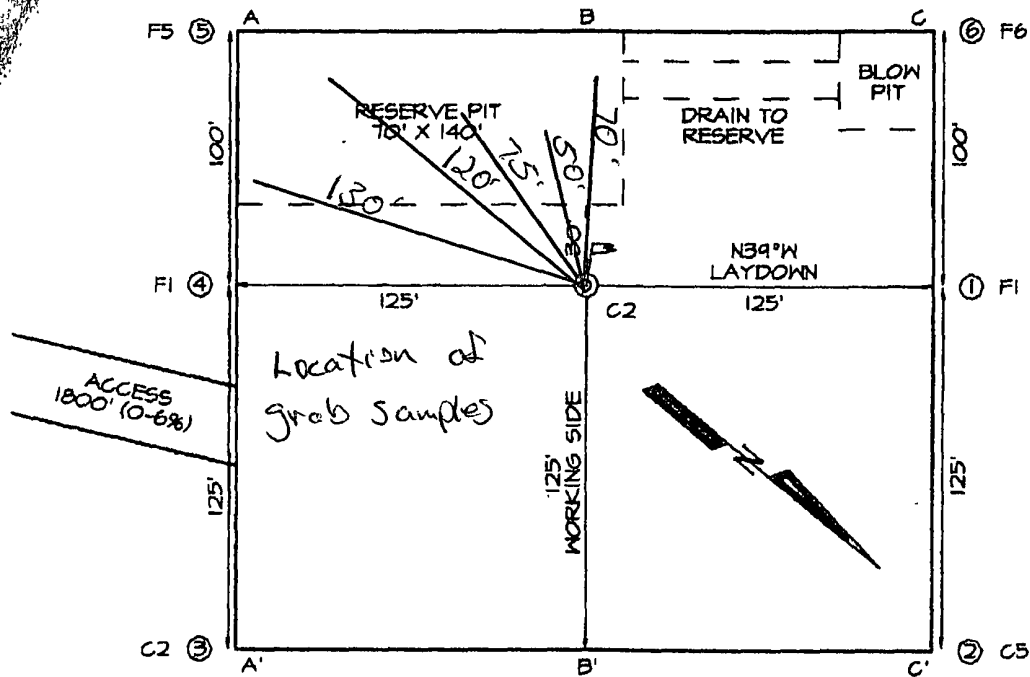

LATITUDE: 36.87262° N
LONGITUDE: 107.39406° W
 DATUM: NAD1983

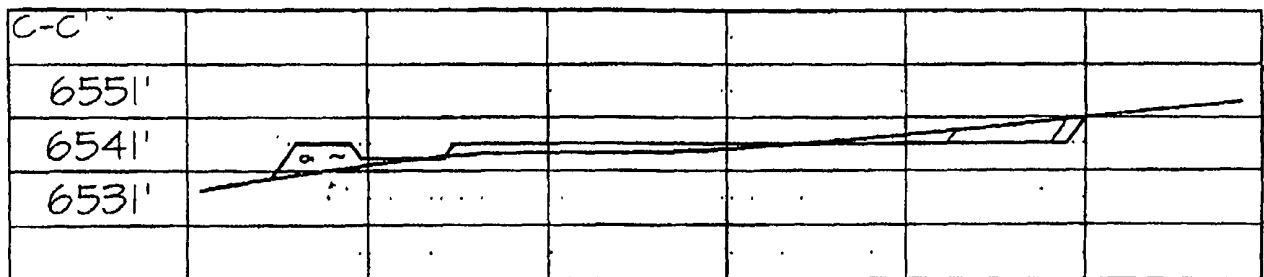
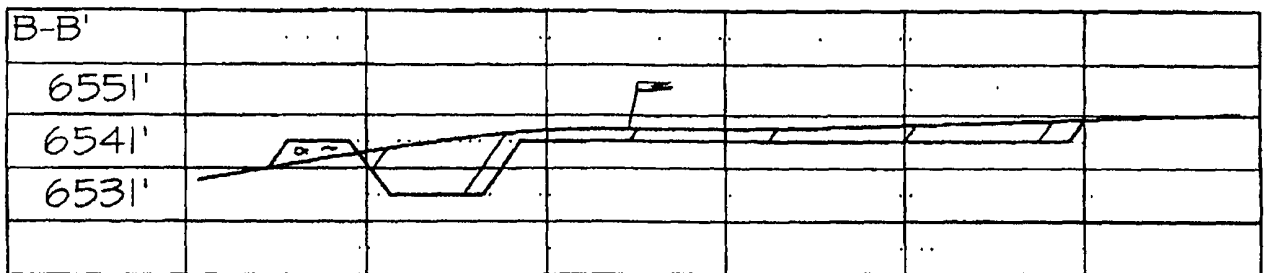
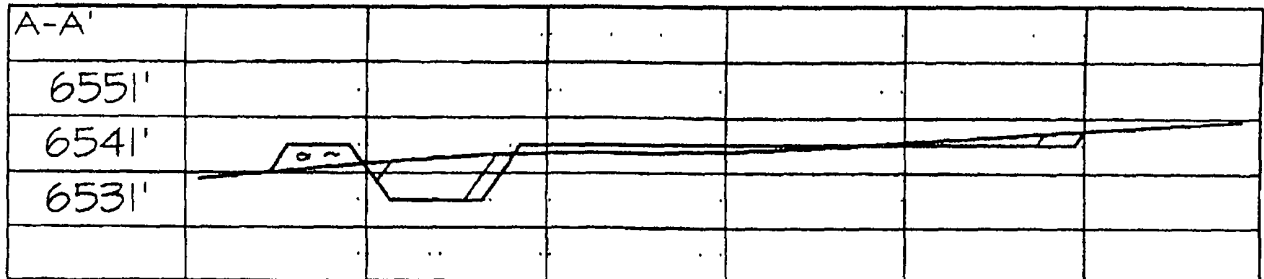

**EPA METHOD 8015 Modified
Nonhalogenated Volatile Organics
Total Petroleum Hydrocarbons**

Client	WPX	Project #	04108-0003
Sample ID	Res Pit Stabilized	Date Reported	12-11-08
Laboratory Number	48390	Date Sampled	11-26-08
Chain of Custody No	5860	Date Received	12-04-08
Sample Matrix	Soil	Date Extracted	12-09-08
Preservative	Cool	Date Analyzed	12-10-08
Condition	Intact	Analysis Requested	8015 TPH

Parameter	Concentration (mg/Kg)	Det. Limit (mg/Kg)
Gasoline Range (C5 - C10)	ND	0.2
Diesel Range (C10 - C28)	ND	0.1
Total Petroleum Hydrocarbons	ND	0.2

ND - Parameter not detected at the stated detection limit

References Method 8015B, Nonhalogenated Volatile Organics, Test Methods for Evaluating Solid Waste, SW-846, USEPA, December 1996

Comments **Rosa Unit #377A**

Analyst

Review

EPA Method 8015 Modified
Nonhalogenated Volatile Organics
Total Petroleum Hydrocarbons

Quality Assurance Report

Client	QA/QC	Project #	N/A
Sample ID	12-10-08 QA/QC	Date Reported	12-11-08
Laboratory Number	48381	Date Sampled	N/A
Sample Matrix	Methylene Chloride	Date Received	N/A
Preservative	N/A	Date Analyzed	12-10-08
Condition	N/A	Analysis Requested	TPH

	I-Cal Date	I-Cal RF	C-Cal RF	% Difference	Accept Range
Gasoline Range C5 - C10	05-07-07	1 0077E+003	1 0081E+003	0.04%	0 - 15%
Diesel Range C10 - C28	05-07-07	9 9655E+002	9 9695E+002	0.04%	0 - 15%

Blank Conc. (mg/L - mg/Kg)	Concentration	Detection Limit
Gasoline Range C5 - C10	ND	0.2
Diesel Range C10 - C28	ND	0.1
Total Petroleum Hydrocarbons	ND	0.2

Duplicate Conc. (mg/Kg)	Sample	Duplicate	% Difference	Accept Range
Gasoline Range C5 - C10	8.2	8.4	2.4%	0 - 30%
Diesel Range C10 - C28	4.7	4.8	2.1%	0 - 30%

Spike Conc. (mg/Kg)	Sample	Spike Added	Spike Result	% Recovery	Accept Range
Gasoline Range C5 - C10	8.2	250	254	98.5%	75 - 125%
Diesel Range C10 - C28	4.7	250	253	99.2%	75 - 125%

ND - Parameter not detected at the stated detection limit

References Method 8015B, Nonhalogenated Volatile Organics, Test Methods for Evaluating Solid Waste, SW-846, USEPA, December 1996

Comments **QA/QC for Samples 48381, 48384, 48385, 48387, 48390, 48434, and 48452.**

Analyst

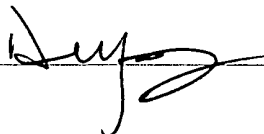

Review

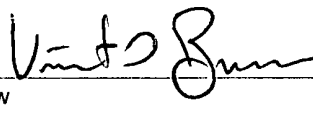



envirotech

Analytical Laboratory

EPA METHOD 8021 AROMATIC VOLATILE ORGANICS

Client	WPX	Project #	04108-0003
Sample ID	Res Pit Stabilized	Date Reported	12-11-08
Laboratory Number	48390	Date Sampled	11-26-08
Chain of Custody	5860	Date Received	12-04-08
Sample Matrix	Soil	Date Analyzed	12-10-08
Preservative	Cool	Date Extracted	12-09-08
Condition	Intact	Analysis Requested	BTEX

Parameter	Concentration (ug/Kg)	Det. Limit (ug/Kg)
Benzene	1.7	0.9
Toluene	23.2	1.0
Ethylbenzene	1.6	1.0
p,m-Xylene	19.7	1.2
o-Xylene	6.4	0.9
Total BTEX	52.6	

ND - Parameter not detected at the stated detection limit

Surrogate Recoveries	Parameter	Percent Recovery
	Fluorobenzene	99.0 %
	1,4-difluorobenzene	99.0 %
	Bromochlorobenzene	99.0 %

References Method 5030B, Purge-and-Trap, Test Methods for Evaluating Solid Waste, SW-846, USEPA, December 1996

Method 8021B, Aromatic Volatile Organics, Test Methods for Evaluating Solid Waste, SW-846, USEPA, December 1996

Comments: Rosa Unit #377A

Analyst

Review



envirotech

Analytical Laboratory

EPA METHOD 8021 AROMATIC VOLATILE ORGANICS

Client	N/A	Project #	N/A
Sample ID	12-10-BT QA/QC	Date Reported	12-11-08
Laboratory Number	48381	Date Sampled	N/A
Sample Matrix	Soil	Date Received	N/A
Preservative	N/A	Date Analyzed	12-10-08
Condition	N/A	Analysis	BTEX

Calibration and Detection Limits (ug/L)	I-Cal RF	C-Cal RF	%Diff	Blank Conc	Detect. Limit
		Accept. Range 0 - 15%			
Benzene	1.3823E+006	1.3851E+006	0.2%	ND	0.1
Toluene	1.3424E+006	1.3450E+006	0.2%	ND	0.1
Ethylbenzene	1.2173E+006	1.2197E+006	0.2%	ND	0.1
p,m-Xylene	2.9567E+006	2.9626E+006	0.2%	ND	0.1
o-Xylene	1.2561E+006	1.2587E+006	0.2%	ND	0.1

Duplicate Conc. (ug/Kg)	Sample	Duplicate	%Diff	Accept Range	Detect. Limit
Benzene	ND	ND	0.0%	0 - 30%	0.9
Toluene	77.0	78.8	2.3%	0 - 30%	1.0
Ethylbenzene	34.5	31.4	9.0%	0 - 30%	1.0
p,m-Xylene	689	677	1.8%	0 - 30%	1.2
o-Xylene	272	267	2.0%	0 - 30%	0.9

Spike Conc. (ug/Kg)	Sample	Amount Spiked	Spiked Sample	% Recovery	Accept Range
Benzene	ND	50.0	48.0	96.0%	39 - 150
Toluene	77.0	50.0	125.5	98.8%	46 - 148
Ethylbenzene	34.5	50.0	82.4	97.5%	32 - 160
p,m-Xylene	689	100	783	99.2%	46 - 148
o-Xylene	272	50	324	101%	46 - 148

ND - Parameter not detected at the stated detection limit

References: Method 5030B, Purge-and-Trap, Test Methods for Evaluating Solid Waste, SW-846, USEPA, December 1996
Method 8021B, Aromatic and Halogenated Volatiles by Gas Chromatography Using Photoionization and/or Electrolytic Conductivity Detectors, SW-846, USEPA December 1996

Comments: QA/QC for Samples 48381, 48382, 48384, 48385, 48387 - 48390, 48434, and 48452.

Analyst 

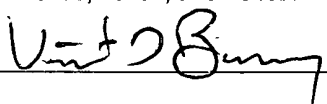
Review 



Client:	WPX	Project #:	04108-0003
Sample ID:	Res. Pit Stabilized	Date Reported:	12-12-08
Laboratory Number:	48390	Date Sampled:	11-26-08
Chain of Custody No:	5860	Date Received:	12-04-08
Sample Matrix:	Soil	Date Extracted:	12-08-08
Preservative:	Cool	Date Analyzed:	12-08-08
Condition:	Intact	Analysis Needed:	TPH-418 1

Parameter	Concentration (mg/kg)	Det. Limit (mg/kg)
Total Petroleum Hydrocarbons	105	5.0

ND = Parameter not detected at the stated detection limit.

References: Method 418.1, Petroleum Hydrocarbons, Total Recoverable, Chemical Analysis of Water and Waste, USEPA Storet No. 4551, 1978.

Comments: **Rosa Unit #377A.**

Analyst

Review



envirotech

Analytical Laboratory

EPA METHOD 418.1
TOTAL PETROLEUM
HYDROCARBONS
QUALITY ASSURANCE REPORT

Client:	QA/QC	Project #:	N/A
Sample ID:	QA/QC	Date Reported:	12-12-08
Laboratory Number:	12-08-TPH.QA/QC 48387	Date Sampled:	N/A
Sample Matrix:	Freon-113	Date Analyzed:	12-08-08
Preservative:	N/A	Date Extracted:	12-08-08
Condition:	N/A	Analysis Needed:	TPH

Calibration	I-Cal Date	C-Cal Date	I-Cal RF	C-Cal RF	% Difference	Accept Range
	12-03-08	12-08-08	1,590	1,550	2.5%	+/- 10%

Blank Conc. (mg/Kg)	Concentration	Detection Limit
TPH	ND	16.5

Duplicate Conc. (mg/Kg)	Sample	Duplicate	% Difference	Accept Range
TPH	20.3	21.6	6.4%	+/- 30%

Spike Conc. (mg/Kg)	Sample	Spike Added	Spike Result	% Recovery	Accept Range
TPH	20.3	2,000	1,650	81.7%	80 - 120%

ND = Parameter not detected at the stated detection limit.

References. Method 418.1, Petroleum Hydrocarbons, Total Recoverable, Chemical Analysis of Water and Waste, USEPA Storet No. 4551, 1978.

Comments: QA/QC for Samples 48387 - 48391, 48402 - 48405 and 48415 - 48416.

Analyst

Review



Client:	WPX	Project #:	04108-0003
Sample ID:	Res. Pit Stablized	Date Reported:	12-12-08
Lab ID#:	48390	Date Sampled:	11-26-08
Sample Matrix:	Soil	Date Received:	12-04-08
Preservative:	Cool	Date Analyzed:	12-09-08
Condition:	Intact	Chain of Custody:	5860

Parameter	Concentration (mg/Kg)
-----------	-----------------------

Total Chloride

120

Reference: U.S.E.P.A., 4500B, "Methods for Chemical Analysis of Water and Wastes", 1983.
Standard Methods For The Examination of Water And Waste Water", 18th ed , 1992.

Comments: **Rosa Unit #377A.**

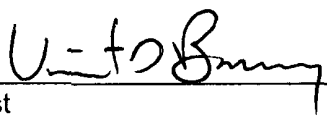

Analyst

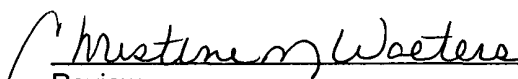

Review

CHAIN OF CUSTODY RECORD

5860

Client: WPX		Project Name / Location ROSA UNIT # 377A				ANALYSIS / PARAMETERS													
Client Address:		Sampler Name: GLAND S.				<div style="display: flex; justify-content: space-between;"> <div> TPH (Method 8015) BTEX (Method 8021) VOC (Method 8260) RCRA 8 Metals Cation / Anion RCI TCLP with H/P PAH TPH (418.1) CHLORIDE Sample Cool Sample Intact </div> </div>													
Client Phone No.:		Client No. 04108-0003																	
Sample No / Identification	Sample Date	Sample Time	Lab No.	Sample Matrix	No / Volume of Containers	Preservative HgCl ₂ HCl		TPH (Method 8015)	BTEX (Method 8021)	VOC (Method 8260)	RCRA 8 Metals	Cation / Anion	RCI	TCLP with H/P	PAH	TPH (418.1)	CHLORIDE	Sample Cool	Sample Intact
Res. Pit	11/24	1015	48390	Soil Solid	1			✓	✓	✓						✓	✓	✓	✓
Stabilized				Soil Solid															
				Soil Solid															
				Soil Solid															
				Soil Solid															
				Soil Solid															
				Soil Solid															
				Soil Solid															
				Soil Solid															
				Soil Solid															
				Soil Solid															
				Soil Solid															
Relinquished by: (Signature)					Date	Time	Received by: (Signature)					Date	Time						
					12/4	1155						12/4/08	1155						
Relinquished by: (Signature)							Received by: (Signature)												
Relinquished by: (Signature)							Received by: (Signature)												

ENVIROTECH INC.
5796 U.S. Highway 64 • Farmington, NM 87401 • Tel 505-632-0615



STATE OF NEW MEXICO:

COUNTY OF RIO ARRIBA:

RECORDATION NOTICE OF PIT BURIAL

In accordance with Section 19.15.17.13.F.1.f of the NMAC, operator hereby provides notice in the public record of an on-site burial of a temporary pit at the following location:

Well Name: ROSA UNIT 377A
Latitude (DDD MM.MMM'): 107.35569
Longitude (DDD MM.MMM'): 36.86559
Unit Letter (1/4, 1/4): M
Section: 27
Township: T31N
Range: R05W
County: RIO ARRIBA
State: NEW MEXICO

IN WITNESS WHEREOF, this Recordation Notice of Pit Burial has been executed on the date indicated below by the undersigned.

WILLIAMS COMPANIES, INC.



Michael K. Lane EH&S Specialist

1/13/09
Date

STATE OF NEW MEXICO
COUNTY OF SAN JUAN

This document was acknowledged before me on this 13 day of January 2009 by Michael K Lane, EH&S Specialist of WILLIAMS COMPANIES, INC.

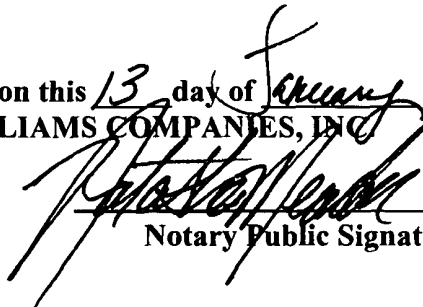

Notary Public Signature

My Commission Expires
11/30/2011

TASHA MEADOR
Notary Name Printed

Meador, Tasha (E&P)

From: johnny@adobecontractorsinc.com
Sent: Friday, November 14, 2008 2:52 PM
To: Brandon Powell
Cc: JJ Miller; Lane, Myke (E&P); Meador, Tasha (E&P); Higgins, Larry (E&P)
Subject: Pit closure notice

Brandon,
we finished the Rosa Unit 258A closure today. We will move to the Rosa Unit #377A on Monday. We are still working on the Rosa Unit #378. We will finish it early next week. That crew will still move to the Rosa Unit #257A. Let me know if you have any questions.
Thanks,

Johnny Stinson
Adobe Contractors
(505)632-1486 office
(505)320-6076 cell
johnny@adobecontractorsinc.com

11/19/2008

Exploration & Production
San Juan Basin Operations
720 So. Main / PO Box 640
Aztec, NM 87410
505-634-4200 / 505-634-4205 fax



Temporary Pit Inspection

FACILITY INFORMATION

Facility Name: ROSA UNIT # 377-A	API #: 30-039-29925
----------------------------------	---------------------

Pit Type: <input checked="" type="checkbox"/> Drilling <input type="checkbox"/> Workover <input type="checkbox"/> Cavitation	Inspection: <input checked="" type="checkbox"/> Daily <input type="checkbox"/> Weekly <input type="checkbox"/> Monthly
--	--

Pit Liner intact (no visible tears)	<input type="checkbox"/> Yes <input checked="" type="checkbox"/> No If No, Report to EH&S immediately	Date / Time Reported: 9/5/08 @ 10:40 AM
Pit Properly Fenced (no fence on rig side if on site)	<input checked="" type="checkbox"/> Yes <input type="checkbox"/> No <input type="checkbox"/> Not Required (if site fully fenced)	
Pit Slopes intact	<input checked="" type="checkbox"/> Yes <input type="checkbox"/> No	
Adequate freeboard (liquid level 2 <u>vertical</u> feet from berm top)	<input checked="" type="checkbox"/> Yes <input type="checkbox"/> No <input type="checkbox"/> Not Applicable	
Free oil or sheen present on pit	<input type="checkbox"/> Yes <input checked="" type="checkbox"/> No	
Flare Pit free of liquids	<input checked="" type="checkbox"/> Yes <input type="checkbox"/> No <input type="checkbox"/> Not Applicable	
Comments: TWO TEARS IN PIT LINER UP ON LEVEL GROUND ON SOUTH / EAST SIDE. REPORTED TO RON SHORTER 10: 40 AM – 9/5/08. MESSAGE LEFT W/ MYKE LANE @ 10:45 AM – 9/5/08. NO DANGER GETTING TO FLUID LEVEL. THEY SAID THEY WOULD TAKE CARE OF IT AFTER RIG MOVES OFF ON 9/7/08.		
Inspector Signature: HARMON COCKRELL		
Printed Name: HARMON COCKRELL		
Title: DRILLING CONSULTANT (T.D.C.I.)		
Date: 9/05/2008 Phone: (505) 486-1935		

Record Retention: Submit with Closure
File: EH&S

Exploration & Production
San Juan Basin Operations
720 So. Main / PO Box 640
Aztec, NM 87410
505-634-4200 / 505-634-4205 fax



Temporary Pit Inspection

FACILITY INFORMATION

Facility Name: ROSA UNIT #377-A	API #: 30-039-29925
---------------------------------	---------------------

Pit Type: <input checked="" type="checkbox"/> Drilling <input type="checkbox"/> Workover <input type="checkbox"/> Cavitation	Inspection: <input checked="" type="checkbox"/> Daily <input type="checkbox"/> Weekly <input type="checkbox"/> Monthly
--	--

Pit Liner intact (no visible tears)	<input checked="" type="checkbox"/> Yes <input type="checkbox"/> No If No, Report to EH&S immediately	Date / Time Reported:
Pit Properly Fenced (no fence on rig side if on site)	<input checked="" type="checkbox"/> Yes <input type="checkbox"/> No <input type="checkbox"/> Not Required (if site fully fenced)	
Pit Slopes intact	<input checked="" type="checkbox"/> Yes <input type="checkbox"/> No	
Adequate freeboard (liquid level 2 <u>vertical</u> feet from berm top)	<input checked="" type="checkbox"/> Yes <input type="checkbox"/> No <input type="checkbox"/> Not Applicable	
Free oil or sheen present on pit	<input type="checkbox"/> Yes <input checked="" type="checkbox"/> No	
Flare Pit free of liquids	<input checked="" type="checkbox"/> Yes <input type="checkbox"/> No <input type="checkbox"/> Not Applicable	
Comments:		
Inspector Signature: WILLIE MOCK		
Printed Name: WILLIE MOCK		
Title: DRILLING CONSULTANT (T.D.C.I.)		
Date: 8/28/2008 Phone: (505) 793-0528		

Record Retention: Submit with Closure
File: EH&S

Exploration & Production
San Juan Basin Operations
720 So. Main / PO Box 640
Aztec, NM 87410
505-634-4200 / 505-634-4205 fax



Temporary Pit Inspection

FACILITY INFORMATION

Facility Name: ROSA UNIT #377-A	API #: 30-039-29925
---------------------------------	---------------------

Pit Type: <input checked="" type="checkbox"/> Drilling <input type="checkbox"/> Workover <input type="checkbox"/> Cavitation	Inspection: <input checked="" type="checkbox"/> Daily <input type="checkbox"/> Weekly <input type="checkbox"/> Monthly
--	--

Pit Liner intact (no visible tears)	<input checked="" type="checkbox"/> Yes <input type="checkbox"/> No If No, Report to EH&S immediately	Date / Time Reported:
Pit Properly Fenced (no fence on rig side if on site)	<input checked="" type="checkbox"/> Yes <input type="checkbox"/> No <input type="checkbox"/> Not Required (if site fully fenced)	
Pit Slopes intact	<input checked="" type="checkbox"/> Yes <input type="checkbox"/> No	
Adequate freeboard (liquid level 2 <u>vertical</u> feet from berm top)	<input checked="" type="checkbox"/> Yes <input type="checkbox"/> No <input type="checkbox"/> Not Applicable	
Free oil or sheen present on pit	<input type="checkbox"/> Yes <input checked="" type="checkbox"/> No	
Flare Pit free of liquids	<input checked="" type="checkbox"/> Yes <input type="checkbox"/> No <input type="checkbox"/> Not Applicable	
Comments:		
Inspector Signature: WILLIE MOCK		
Printed Name: WILLIE MOCK		
Title: DRILLING CONSULTANT (T.D.C.I.)		
Date: 8/29/2008 Phone: (505) 793-0528		

Record Retention: Submit with Closure
File: EH&S

Exploration & Production
San Juan Basin Operations
720 So. Main / PO Box 640
Aztec, NM 87410
505-634-4200 / 505-634-4205 fax



Temporary Pit Inspection

FACILITY INFORMATION

Facility Name: ROSA UNIT #377-A	API #: 30-039-29925
---------------------------------	---------------------

Pit Type: <input checked="" type="checkbox"/> Drilling <input type="checkbox"/> Workover <input type="checkbox"/> Cavitation	Inspection: <input checked="" type="checkbox"/> Daily <input type="checkbox"/> Weekly <input type="checkbox"/> Monthly
--	--

Pit Liner intact (no visible tears)	<input checked="" type="checkbox"/> Yes <input type="checkbox"/> No If No, Report to EH&S immediately	Date / Time Reported:
Pit Properly Fenced (no fence on rig side if on site)	<input checked="" type="checkbox"/> Yes <input type="checkbox"/> No <input type="checkbox"/> Not Required (if site fully fenced)	
Pit Slopes intact	<input checked="" type="checkbox"/> Yes <input type="checkbox"/> No	
Adequate freeboard (liquid level 2 <u>vertical</u> feet from berm top)	<input checked="" type="checkbox"/> Yes <input type="checkbox"/> No <input type="checkbox"/> Not Applicable	
Free oil or sheen present on pit	<input type="checkbox"/> Yes <input checked="" type="checkbox"/> No	
Flare Pit free of liquids	<input checked="" type="checkbox"/> Yes <input type="checkbox"/> No <input type="checkbox"/> Not Applicable	
Comments:		
Inspector Signature: WILLIE MOCK		
Printed Name: WILLIE MOCK		
Title: DRILLING CONSULTANT (T.D.C.I.)		
Date: 8/30/2008 Phone: (505) 793-0528		

Record Retention: Submit with Closure
File: EH&S

Exploration & Production
San Juan Basin Operations
720 So. Main / PO Box 640
Aztec, NM 87410
505-634-4200 / 505-634-4205 fax



Temporary Pit Inspection

FACILITY INFORMATION

Facility Name: ROSA UNIT #377-A	API #: 30-039-29925
---------------------------------	---------------------

Pit Type: <input checked="" type="checkbox"/> Drilling <input type="checkbox"/> Workover <input type="checkbox"/> Cavitation	Inspection: <input checked="" type="checkbox"/> Daily <input type="checkbox"/> Weekly <input type="checkbox"/> Monthly
--	--

Pit Liner intact (no visible tears)	<input checked="" type="checkbox"/> Yes <input type="checkbox"/> No If No, Report to EH&S immediately	Date / Time Reported:
Pit Properly Fenced (no fence on rig side if on site)	<input checked="" type="checkbox"/> Yes <input type="checkbox"/> No <input type="checkbox"/> Not Required (if site fully fenced)	
Pit Slopes intact	<input checked="" type="checkbox"/> Yes <input type="checkbox"/> No	
Adequate freeboard (liquid level 2 <u>vertical</u> feet from berm top)	<input checked="" type="checkbox"/> Yes <input type="checkbox"/> No <input type="checkbox"/> Not Applicable	
Free oil or sheen present on pit	<input type="checkbox"/> Yes <input checked="" type="checkbox"/> No	
Flare Pit free of liquids	<input checked="" type="checkbox"/> Yes <input type="checkbox"/> No <input type="checkbox"/> Not Applicable	
Comments:		
Inspector Signature: WILLIE MOCK		
Printed Name: WILLIE MOCK		
Title: DRILLING CONSULTANT (T.D.C.I.)		
Date: 8/31/2008 Phone: (505) 793-0528		

Record Retention: Submit with Closure
File: EH&S

Exploration & Production
San Juan Basin Operations
720 So. Main / PO Box 640
Aztec, NM 87410
505-634-4200 / 505-634-4205 fax



Temporary Pit Inspection

FACILITY INFORMATION

Facility Name: ROSA UNIT #377-A	API #: 30-039-29925
--	----------------------------

Pit Type: <input checked="" type="checkbox"/> Drilling <input type="checkbox"/> Workover <input type="checkbox"/> Cavitation	Inspection: <input checked="" type="checkbox"/> Daily <input type="checkbox"/> Weekly <input type="checkbox"/> Monthly
---	---

Pit Liner intact (no visible tears)	<input checked="" type="checkbox"/> Yes <input type="checkbox"/> No If No, Report to EH&S immediately	Date / Time Reported:
Pit Properly Fenced (no fence on rig side if on site)	<input checked="" type="checkbox"/> Yes <input type="checkbox"/> No <input type="checkbox"/> Not Required (if site fully fenced)	
Pit Slopes intact	<input checked="" type="checkbox"/> Yes <input type="checkbox"/> No	
Adequate freeboard (liquid level 2 <u>vertical</u> feet from berm top)	<input checked="" type="checkbox"/> Yes <input type="checkbox"/> No <input type="checkbox"/> Not Applicable	
Free oil or sheen present on pit	<input type="checkbox"/> Yes <input checked="" type="checkbox"/> No	
Flare Pit free of liquids	<input checked="" type="checkbox"/> Yes <input type="checkbox"/> No <input type="checkbox"/> Not Applicable	
Comments:		
Inspector Signature: WILLIE MOCK		
Printed Name: WILLIE MOCK		
Title: DRILLING CONSULTANT (T.D.C.I.)		
Date: 9/1/2008 Phone: (505) 793-0528		

Record Retention: Submit with Closure
File EH&S

Exploration & Production
San Juan Basin Operations
720 So. Main / PO Box 640
Aztec, NM 87410
505-634-4200 / 505-634-4205 fax



Temporary Pit Inspection

FACILITY INFORMATION

Facility Name: ROSA UNIT #377-A	API #: 30-039-29925
---------------------------------	---------------------

Pit Type: <input checked="" type="checkbox"/> Drilling <input type="checkbox"/> Workover <input type="checkbox"/> Cavitation	Inspection: <input checked="" type="checkbox"/> Daily <input type="checkbox"/> Weekly <input type="checkbox"/> Monthly
--	--

Pit Liner intact (no visible tears)	<input checked="" type="checkbox"/> Yes <input type="checkbox"/> No If No, Report to EH&S immediately	Date / Time Reported:
Pit Properly Fenced (no fence on rig side if on site)	<input checked="" type="checkbox"/> Yes <input type="checkbox"/> No <input type="checkbox"/> Not Required (if site fully fenced)	
Pit Slopes intact	<input checked="" type="checkbox"/> Yes <input type="checkbox"/> No	
Adequate freeboard (liquid level 2 <u>vertical</u> feet from berm top)	<input checked="" type="checkbox"/> Yes <input type="checkbox"/> No <input type="checkbox"/> Not Applicable	
Free oil or sheen present on pit	<input type="checkbox"/> Yes <input checked="" type="checkbox"/> No	
Flare Pit free of liquids	<input checked="" type="checkbox"/> Yes <input type="checkbox"/> No <input type="checkbox"/> Not Applicable	
Comments:		
Inspector Signature: WILLIE MOCK		
Printed Name: WILLIE MOCK		
Title: DRILLING CONSULTANT (T.D.C.I.)		
Date: 9/2/2008 Phone: (505) 793-0528		

Record Retention: Submit with Closure
File: EH&S

Exploration & Production
San Juan Basin Operations
720 So. Main / PO Box 640
Aztec, NM 87410
505-634-4200 / 505-634-4205 fax



Temporary Pit Inspection

FACILITY INFORMATION

Facility Name: ROSA UNIT # 377-A	API #: 30-039-29925
---	----------------------------

Pit Type: <input checked="" type="checkbox"/> Drilling <input type="checkbox"/> Workover <input type="checkbox"/> Cavitation	Inspection: <input checked="" type="checkbox"/> Daily <input type="checkbox"/> Weekly <input type="checkbox"/> Monthly
---	---

Pit Liner intact (no visible tears)	<input checked="" type="checkbox"/> Yes <input type="checkbox"/> No If No, Report to EH&S immediately	Date / Time Reported:
Pit Properly Fenced (no fence on rig side if on site)	<input checked="" type="checkbox"/> Yes <input type="checkbox"/> No <input type="checkbox"/> Not Required (if site fully fenced)	
Pit Slopes intact	<input checked="" type="checkbox"/> Yes <input type="checkbox"/> No	
Adequate freeboard (liquid level 2 <u>vertical</u> feet from berm top)	<input checked="" type="checkbox"/> Yes <input type="checkbox"/> No <input type="checkbox"/> Not Applicable	
Free oil or sheen present on pit	<input type="checkbox"/> Yes <input checked="" type="checkbox"/> No	
Flare Pit free of liquids	<input checked="" type="checkbox"/> Yes <input type="checkbox"/> No <input type="checkbox"/> Not Applicable	

Comments:

Inspector Signature: HARMON COCKRELL

Printed Name: HARMON COCKRELL

Title: DRILLING CONSULTANT (T.D.C.I.)

Date: 9/03/2008

Phone: (505) 486-1935

Record Retention: Submit with Closure
File: EH&S

Exploration & Production
San Juan Basin Operations
720 So. Main / PO Box 640
Aztec, NM 87410
505-634-4200 / 505-634-4205 fax



Temporary Pit Inspection

FACILITY INFORMATION

Facility Name: ROSA UNIT # 377-A	API #: 30-039-29925
----------------------------------	---------------------

Pit Type: <input checked="" type="checkbox"/> Drilling <input type="checkbox"/> Workover <input type="checkbox"/> Cavitation	Inspection: <input checked="" type="checkbox"/> Daily <input type="checkbox"/> Weekly <input type="checkbox"/> Monthly
--	--

Pit Liner intact (no visible tears)	<input checked="" type="checkbox"/> Yes <input type="checkbox"/> No If No, Report to EH&S immediately	Date / Time Reported:
Pit Properly Fenced (no fence on rig side if on site)	<input checked="" type="checkbox"/> Yes <input type="checkbox"/> No <input type="checkbox"/> Not Required (if site fully fenced)	
Pit Slopes intact	<input checked="" type="checkbox"/> Yes <input type="checkbox"/> No	
Adequate freeboard (liquid level 2 <u>vertical</u> feet from berm top)	<input checked="" type="checkbox"/> Yes <input type="checkbox"/> No <input type="checkbox"/> Not Applicable	
Free oil or sheen present on pit	<input type="checkbox"/> Yes <input checked="" type="checkbox"/> No	
Flare Pit free of liquids	<input checked="" type="checkbox"/> Yes <input type="checkbox"/> No <input type="checkbox"/> Not Applicable	

Comments:

Inspector Signature: HARMON COCKRELL

Printed Name: HARMON COCKRELL

Title: DRILLING CONSULTANT (T.D.C.I.)

Date: 9/04/2008	Phone: (505) 486-1935
-----------------	-----------------------

Record Retention: Submit with Closure
File: EH&S

Exploration & Production
San Juan Basin Operations
720 So. Main / PO Box 640
Aztec, NM 87410
505-634-4200 / 505-634-4205 fax



Temporary Pit Inspection

FACILITY INFORMATION

Facility Name: ROSA UNIT # 377-A	API #: 30-039-29925
---	----------------------------

Pit Type: <input checked="" type="checkbox"/> Drilling <input type="checkbox"/> Workover <input type="checkbox"/> Cavitation	Inspection: <input checked="" type="checkbox"/> Daily <input type="checkbox"/> Weekly <input type="checkbox"/> Monthly
---	---

Pit Liner intact (no visible tears)	<input checked="" type="checkbox"/> Yes <input type="checkbox"/> No If No, Report to EH&S immediately	Date / Time Reported:
Pit Properly Fenced (no fence on rig side if on site)	<input checked="" type="checkbox"/> Yes <input type="checkbox"/> No <input type="checkbox"/> Not Required (if site fully fenced)	
Pit Slopes intact	<input checked="" type="checkbox"/> Yes <input type="checkbox"/> No	
Adequate freeboard (liquid level 2 <u>vertical</u> feet from berm top)	<input checked="" type="checkbox"/> Yes <input type="checkbox"/> No <input type="checkbox"/> Not Applicable	
Free oil or sheen present on pit	<input type="checkbox"/> Yes <input checked="" type="checkbox"/> No	
Flare Pit free of liquids	<input checked="" type="checkbox"/> Yes <input type="checkbox"/> No <input type="checkbox"/> Not Applicable	
Comments:		
Inspector Signature: HARMON COCKRELL		
Printed Name: HARMON COCKRELL		
Title: DRILLING CONSULTANT (T.D.C.I.)		
Date: 9/05/2008 Phone: (505) 486-1935		

Record Retention: Submit with Closure
File: EH&S

UNITED STATES
DEPARTMENT OF THE INTERIOR
BUREAU OF LAND MANAGEMENT

SUBMIT IN
DUPLICATE

(See other instructions on
reverse side)

FORM APPROVED
OMB NO 1004-0137
Expires February 28, 1995

WELL COMPLETION OR RECOMPLETION REPORT AND LOG*						5 LEASE DESIGNATION AND LEASE NO NMSF-078768	
						6 IF INDIAN, ALLOTTEE OR	
1a TYPE OF WELL <input type="checkbox"/> OIL WELL <input checked="" type="checkbox"/> GAS WELL <input type="checkbox"/> DRY <input type="checkbox"/> OTHER						7 UNIT AGREEMENT NAME Rosa Unit	
b TYPE OF COMPLETION <input checked="" type="checkbox"/> NEW WELL <input type="checkbox"/> WORKOVER <input type="checkbox"/> DEEPEN <input type="checkbox"/> PLUG BACK <input type="checkbox"/> DIFF RESVR <input type="checkbox"/> OTHER							
2 NAME OF OPERATOR WILLIAMS PRODUCTION COMPANY						8 FARM OR LEASE NAME, WELL NO Rosa Unit COM #377A	
3 ADDRESS AND TELEPHONE NO P.O. Box 640, Aztec, NM 87410 (505) 634-4208						9 API WELL NO 30-039-29925	
4 LOCATION OF WELL (Report location clearly and in accordance with any State requirements)* At Surface 1895' FNL & 1915' FWL, Sec 26 (F), T31N, R5W At top production interval reported below 1166' FNL & 1157' FWL, Sec 26 (D), T31N, R5W At total depth Same						10 FIELD AND POOL, OR WILDCAT Basin Fruitland Coal	
						11 SEC, T, R, M, OR BLOCK AND SURVEY OR AREA SEC 26-31N-5W	
				14 PERMIT NO	DATE ISSUED	12 COUNTY OR Rio Arriba	13 STATE New Mexico
15 DATE SPUDDED 8-29-08	16 DATE T D REACHED 9-22-08	17 DATE COMPLETED (READY TO PRODUCE) 10-24-08		18 ELEVATIONS (DK, RKB, RT, GR, ETC)* 6543' GR		19 ELEVATION CASINGHEAD	
20 TOTAL DEPTH, MD & TVD 3691' MD / 3497' TVD		21 PLUG, BACK T D, MD & TVD 3679' MD / 3485' TVD		22 IF MULTICOMP, HOW MANY	23 INTERVALS DRILLED BY	ROTARY TOOLS x	CABLE TOOLS
24 PRODUCING INTERVAL(S), OF THIS COMPLETION - TOP, BOTTOM, NAME (MD AND TVD)* Basin Fruitland Coal 3460' - 3591' MD						25 WAS DIRECTIONAL SURVEY MADE YES	
26 TYPE ELECTRIC AND OTHER LOGS RUN Mud Logging only on this well						27 WAS WELL CORED NO	
28 CASING REPORT (Report all strings set in well)							
CASING SIZE/GRADE		WEIGHT, LB/FT		DEPTH SET (MD)		HOLE SIZE	
9-5/8", K-55		36 0#		337'		12-1/4"	
7", K-55		23 0#		3453'		8-3/4"	
29 LINER RECORD				30 TUBING RECORD			
SIZE	TOP (MD)	BOTTOM (MD)	SACKS CEMENT*	SCREEN (MD)	SIZE	DEPTH SET (MD)	PACKER SET (MD)
5-1/2", 15 5#, K-55	3301'	3679'	0 SX		2-7/8", 6 5# J-55	3617'	
31 PERFORATION RECORD (Interval, size, and number) Basin Fruitland Coal - 3460' - 3591' MD				32 ACID, SHOT, FRACTURE, CEMENT SQUEEZE, ETC			
				DEPTH INTERVAL (MD)	AMOUNT AND KIND OF MATERIAL USED		
					Well was not fraced or acidized		
33 PRODUCTION							
DATE OF FIRST PRODUCTION		PRODUCTION METHOD (Flowing, gas lift, pumping-size and type of pump) Flowing				WELL STATUS (PRODUCING OR SI) SI - waiting on tie-in	
DATE OF TEST 10-17-08	TESTED 1 hr	CHOKE SIZE 2'	PROD'N FOR TEST PERIOD	OIL - BBL	GAS - MCF	WATER - BBL	GAS-OIL RATIO
FLOW TBG PRESS 0 oz	CASING PRESSURE 32 oz	CALCULATED 24-HOUR RATE		OIL - BBL	GAS - MCF 869 mcf/d	WATER - BBL	OIL GRAVITY-API (CORR)
34 DISPOSITION OF GAS (Sold, used for fuel, vented, etc) TO BE SOLD						TEST WITNESSED BY Weldon Higgins	
35 LIST OF ATTACHMENTS SUMMARY OF POROUS ZONES, WELLBORE DIAGRAM							
36 I hereby certify that the foregoing and attached information is complete and correct as determined from all available records							

SIGNED _____ TITLE Drlg COM DATE 10-27-08



ROSA UNIT 377A

Submit To Appropriate District Office Two Copies <u>District I</u> 1625 N French Dr., Hobbs, NM 88240 <u>District II</u> 1301 W Grand Avenue, Artesia, NM 88210 <u>District III</u> 1000 Rio Brazos Rd., Aztec, NM 87410 <u>District IV</u> 1220 S St Francis Dr., Santa Fe, NM 87505	State of New Mexico Energy, Minerals and Natural Resources Oil Conservation Division 1220 South St. Francis Dr. Santa Fe, NM 87505	Form C-105 July 17, 2008
		1. WELL API NO 30-039-29925
		2 Type of Lease <input type="checkbox"/> STATE <input type="checkbox"/> FEE <input checked="" type="checkbox"/> FED/INDIAN
		3 State Oil & Gas Lease No NMSF-078768
WELL COMPLETION OR RECOMPLETION REPORT AND LOG		
4 Reason for filing <input type="checkbox"/> COMPLETION REPORT (Fill in boxes #1 through #31 for State and Fee wells only) <input checked="" type="checkbox"/> C-144 CLOSURE ATTACHMENT (Fill in boxes #1 through #9, #15 Date Rig Released and #32 and/or #33, attach this and the plat to the C-144 closure report in accordance with 19 15 17 13 K NMAC)		5 Lease Name or Unit Agreement Name Rosa Unit
		6 Well Number Rosa Unit #377A
7 Type of Completion <input checked="" type="checkbox"/> NEW WELL <input type="checkbox"/> WORKOVER <input type="checkbox"/> DEEPENING <input type="checkbox"/> PLUGBACK <input type="checkbox"/> DIFFERENT RESERVOIR <input type="checkbox"/> OTHER		
8 Name of Operator WILLIAMS PRODUCTION, LLC		9 OGRID 120782
10 Address of Operator P O BOX 640 AZTEC, NM 87410		11 Pool name or Wildcat
12. Location	Unit Ltr	Section
Surface:		
BH:		
13 Date Spudded	14 Date T D Reached	15 Date Rig Released 10/24/2008
16. Date Completed (Ready to Produce)		17 Elevations (DF and RKB, RT, GR, etc)
18 Total Measured Depth of Well	19 Plug Back Measured Depth	20 Was Directional Survey Made?
21 Type Electric and Other Logs Run		
22 Producing Interval(s), of this completion - Top, Bottom, Name		
23 CASING RECORD (Report all strings set in well)		
CASING SIZE	WEIGHT LB /FT	DEPTH SET
24 LINER RECORD		25 TUBING RECORD
SIZE	TOP	BOTTOM
26 Perforation record (interval, size, and number)		27 ACID, SHOT, FRACTURE, CEMENT, SQUEEZE, ETC
		DEPTH INTERVAL AMOUNT AND KIND MATERIAL USED
28 PRODUCTION		
Date First Production		Production Method (Flowing, gas lift, pumping - Size and type pump)
		Well Status (Prod or Shut-in)
Date of Test	Hours Tested	Choke Size
		Prod'n For Test Period
		Oil - Bbl
		Gas - MCF
		Water - Bbl
		Gas - Oil Ratio
Flow Tubing Press	Casing Pressure	Calculated 24-Hour Rate
		Oil - Bbl
		Gas - MCF
		Water - Bbl
		Oil Gravity - API - (Corr)
29 Disposition of Gas (Sold, used for fuel, vented, etc)		30 Test Witnessed By
31 List Attachments		
32 If a temporary pit was used at the well, attach a plat with the location of the temporary pit Attached		
33 If an on-site burial was used at the well, report the exact location of the on-site burial		
Latitude 36 87262N Longitude -107 33406W NAD 1927 X1983		
I hereby certify that the information shown on both sides of this form is true and complete to the best of my knowledge and belief		
Signature	Printed Name	Title
		Date
E-mail Address:		

WILLIAMS PRODUCTION
TEMP PIT CLOSURE REPORT ADDENDUM
ROSA UNIT 377A

Req #

- 1 Date & How free standing liquids removed in following manner: 11/1/2008
Liquids removed by vacuum truck and hauled to Basin Disposal, Permit # NM 01-0005
-
- 3 Return receipt sent & received from surface owner:
Williams notified the SMA of its intent to use a temporary pit and onsite burial in the Surface Use Plan in the well APD. The SMA was notified by email see attached. No return receipt required per BLM:FFO/NMOCD MOU dated 5/4/09.
-
- 4 Rig off location on following date: 10/24/2008
Pit covered on following date: 12/1/2008
Reseeding started/scheduled for following date:
Date and mix to follow BLM/USFS COAs in APD per BLM:FFO/NMOCD MOU dated 5/4/09.
-
- 6 Pit liner removed on following date: 11/17/2008
Pit liner removed by following company: Adobe Construction

Pit liner removed in following manner:
Cut liner above mud level after stabilization by manually &/or mechanically cutting liner. Removed all anchored material on date given.
Facility where Pit liner disposed: S.J. Regional Landfill, NMED Permit SWM-052426
-
- 7 Solidification process accomplished in following manner:
Adobe construction used combination of natural drying & mechanical mixing. Pit contents were mixed with non-waste, earthen material to a consistency that is safe & stable. The mixing ratio per Adobe on the order of 2.7:1 to 3:1 and varied during closure depending on the initial moisture content of the mud and drill solids.
-
- 8 Five point composite sample provided: Envirotech Results Attached
-
- 9 Testing of earth by following company: Envirotech, Inc.
Material & method used for solidification, non-waste earthen material:
Grading & backfilling area with approximately 4' of soils and earthen materials recovered during site construction, to one foot consisting of topsoil.
-

ROSA UNIT 377A

- 10** Re-contouring to match surrounding geography done in following manner (using BMP's):
Reestablish drainage and contours to approximately match previous topography meeting Conditions of Approval in APD and as specified by Surface Management Agency Inspectors.
-

- 11** Sundry (C103) to NMOCD when area seeded and seed mix used:
Williams will comply with Surface Management Agency reseeding requirements in COAs of the APD for the referenced well, per BLM:FFO/NMOCD MOU dated 5/4/09.
-

- 12** Date pit was covered: 12/1/2008
Revegetation and restoration completion See item 11 and refer to MOU.
-
- 13** Company setting steel marker on site: Adobe Construction
Date marker set: 3/24/2009
Type cmt & depth of cmt to place marker: 2 sx Pre-mixed concrete @ 4' depth
Type of marker used: (check one) Steel Post
Pertinent information on marker (operator, lease, well name/#, S-T-R-UL):
Williams Production, NMSF-0787680, S26-T31N-R5W-F, PIT BURIAL
-

Attached information :

- **** Sample results from Form C141 (Release Notification & Corrective Action) Attached
- Date & time release occurred: NA
- **** C105 (Completion Rpt) w/Applicable Pit Information Attached
-



District II
PO Drawer DD, Artesia, NM 88211-0719

OIL CONSERVATION DIVISION
PO Box 2088
Santa Fe, NM 87504-2088

Submit to Appropriate District Office
State Lease - 4 Copies
Fee Lease - 3 Copies

District III
1000 Rio Brazos Rd., Aztec, NM 87410

District IV
PO Box 2088, Santa Fe, NM 87504-2088

Permit # 2965

☐ AMENDED REPORT

RCVD JUN 7 1962

WELL LOCATION AND ACREAGE DEDICATION PLAT OL CONS. DIV.

*API Number 030-039-29925		*Pool Code 71629	*Pool Name BASIN FRUITLAND COAL	*Flow Rate 5.3
*Property Code 17033	*Property Name ROSA UNIT			*Well Number 377A
*OGRID No 120782	*Operator Name WILLIAMS PRODUCTION COMPANY			*Elevation 6543

¹⁰ Surface Location

UL or lot no	Section	Township	Range	Lot Idn	Feet from the	North/South line	Feet from the	East/West line	County
F	26	31N	5W		1895	NORTH	1915	WEST	RIO ARRIBA

¹¹ Bottom Hole Location If Different From Surface

UL or lot no	Section	Township	Range	Lot Idn	Feet from the	North/South line	Feet from the	East/West line	County
D	26	31N	5W		1190	NORTH	1190	WEST	RIO ARBITA

¹² Dedicated Acres	320.0 Acres - (N/2)	¹³ Joint or Infill	¹⁴ Consolidation Code	¹⁵ Order No
-------------------------------	---------------------	-------------------------------	----------------------------------	------------------------

NO ALLOWABLE WILL BE ASSIGNED TO THIS COMPLETION UNTIL ALL INTERESTS HAVE BEEN CONSOLIDATED
OR A NON-STANDARD UNIT HAS BEEN APPROVED BY THE DIVISION

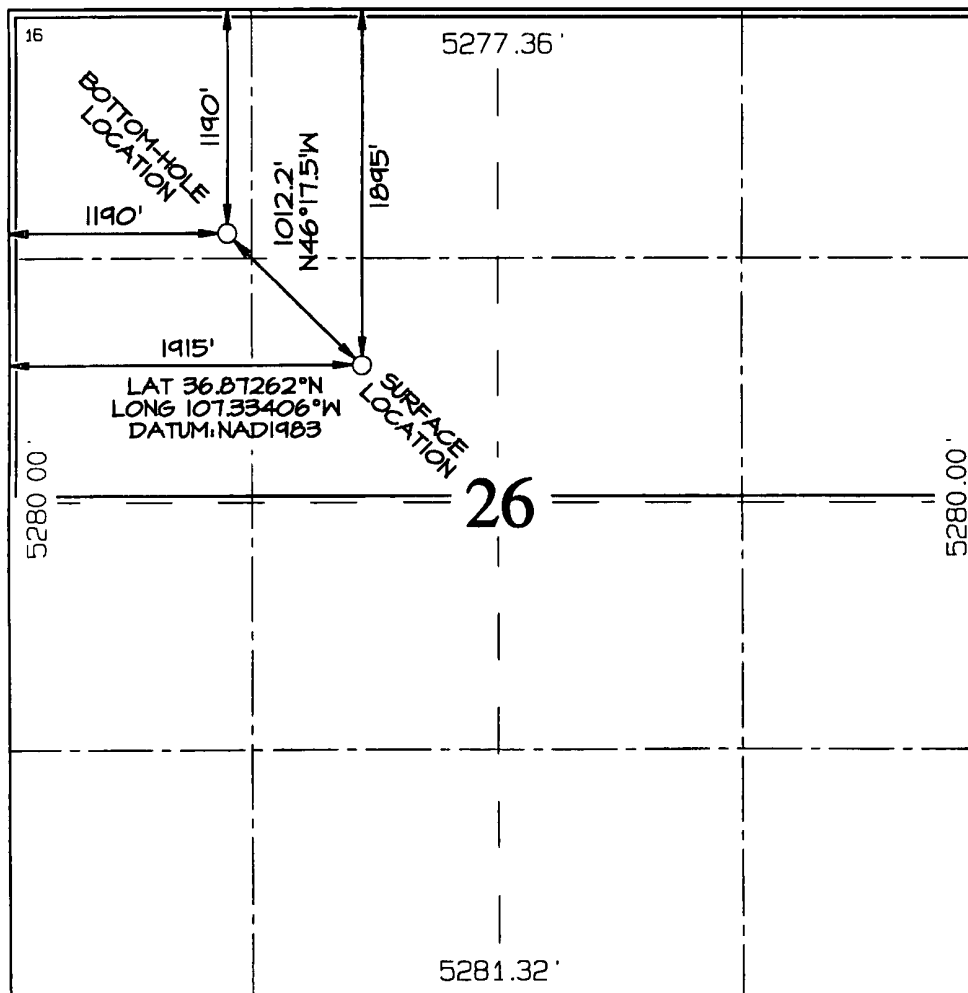

17 OPERATOR CERTIFICATION

I hereby certify that the information
contained herein is true and complete
to the best of my knowledge and belief

Signature

Printed Name _____

Title

Date _____

18 SURVEYOR CERTIFICATION

I hereby certify that the well location shown on this plat was plotted from field notes of actual surveys made by me or under my supervision, and that the same is true and correct to the best of my belief

Survey Date: DECEMBER 2, 2005

Signature and Seal of Professional Surveyor



JASON C. EDWARDS
Certificate Number 15269