

**UNITED STATES  
DEPARTMENT OF THE INTERIOR  
BUREAU OF LAND MANAGEMENT**  
Sundry Notices and Reports on Wells

**RECEIVED****JUL 11 2012**Farmington Field Office  
Bureau of Land Management1. **Type of Well**    ☒ Gas       ☐ Oil5. **Lease Number**  
NMNM-270246. **If Indian, All. or  
Tribe Name**7. **Unit Agreement Name**2. **Name of Operator**

ConocoPhillips c/o BHP Billiton San Juan Coal

8. **Well Name & Number**  
Twin Mounds 30 #13. **Address & Phone No. of Operator**

PO Box 561, Waterflow, NM 87421 (505) 598-2000

9. **API Well No.**  
30-045-25751**Location of Well, Footage, Sec., T, R, M**

790' FNL &amp; 990' FWL, Section 30, T-30-N, R-14-W,

10. **Field and Pool**  
Basin Dakota  
Gallup11. **County & State**  
San Juan County, NM**12. CHECK APPROPRIATE BOX TO INDICATE NATURE OF NOTICE, REPORT, OTHER DATA****Type of Submission**☐ Notice of Intent☒ Subsequent Report☐ Final Abandonment**Type of Action**☐ Abandonment☐ Recompletion☐ Plugging Back☐ Casing Repair☐ Altering Casing☒ Other – Below Grade Marker☐ Change of Plans☐ New Construction☐ Non-Routine Fracturing☐ Water Shut off☐ Conversion to InjectionRCVD AUG 3 '12  
OIL CONS. DIV.  
DIST. 3**13. Describe Proposed or Completed Operations**

BHP – San Juan Coal for ConocoPhillips has set an underground plate instead of a 4" above ground marker to prevent stray electrical currents from entering the underground coal mine. Please find the attached certified survey.

**14. I hereby certify that the foregoing is true and correct.**

Signed

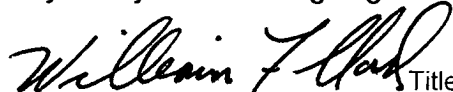

Title

William Clark

Contractor

Date

July 10, 2012

Type or print name

E-mail address: billc@apluswell.comPHONE: (505)325-2627

(This space for Federal or State Office use)

APPROVED BY

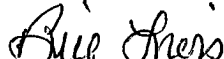

Title

Branch Chief Environmental

Date

7/16/12

CONDITION OF APPROVAL, if any:

Title 18 U.S.C. Section 1001, makes it a crime for any person knowingly to make to any department or agency of the United States any false, fictitious or fraudulent statements or representations as to any matter within its jurisdiction.

**NMOCDA**

**P & A WELL SURVEY**  
**CONOCO MESA TWIN NO. 30-1 WELL LOCATED IN THE**  
**NW/4 NW/4 SECTION 30, T.30N., R.14W.,**  
**N.M.P.M., SAN JUAN COUNTY, NEW MEXICO.**

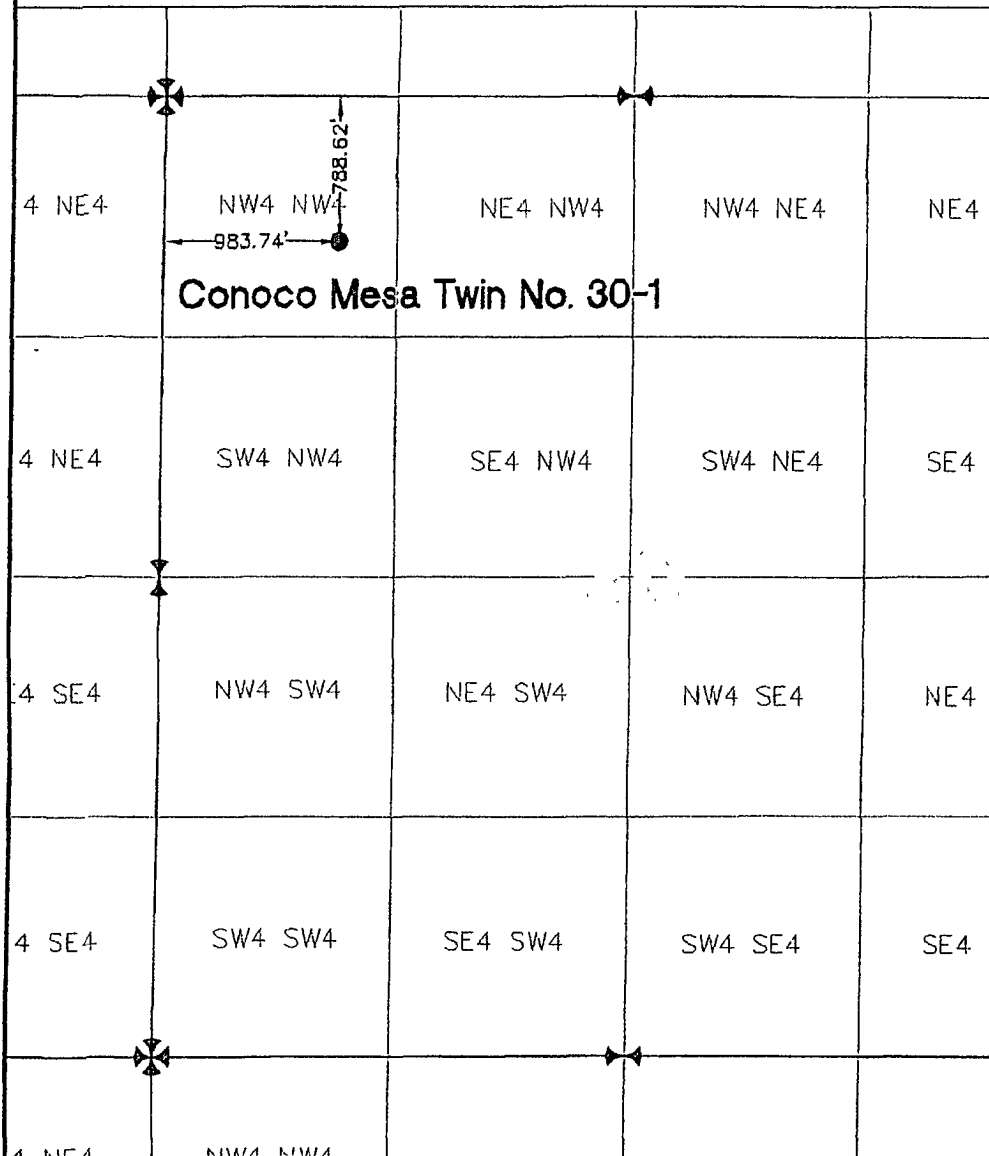

Denotes found B.M. brass  
cap monument

**NAD 1927 NEW  
MEXICO WEST**

**N2107316.12  
E347067.03  
El. 5492**

**Lat 36 47 24.79738  
Long 108 21 22.50215**



**SCALE: 1"=500'**

**BASIS OF BEARING:**  
**STATIC C.P.S. SURVEY, SOLUTIONS**  
**OBTAINED FROM SATELLITES TRACKED**  
**APRIL, 2003. REFERENCE H.A.R.N.**  
**NETWORK POINTS FMN 0 AND E432.**  
**BEARING N 86°37'34" W (NAD27**  
**NEW MEXICO WEST) SCALE FACTOR**  
**= 0.99968810**

I, Peter Epp, a Registered Professional Surveyor under the laws of the State of New Mexico, hereby certify that this plat was prepared from the field notes of a actual survey meeting the minimum requirements of the standards for easement surveys and is true and correct to the best of my knowledge and belief.



*Peter Epp*  
 Peter Epp P.L.S. New Mexico L.S. # 15512

Date: 12MAR12

CHECKED BY PE

DRAWN BY RC



**EPP & ASSOCIATES, INC.**  
**PROFESSIONAL LAND SURVEYORS**

433 4th Avenue West  
 P.O. Box 837  
 Cimig, CO 81625

Phone (970) 824-8236  
 Fax (970) 824-5227

**Prepared for:**  
**State of New Mexico**  
**Oil Conservation Commission**