

Submit 3 Copies To Appropriate District
Office
District I
1625 N. French Dr., Hobbs, NM 88240
District II
1301 W. Grand Ave., Artesia, NM 88210
District III
1000 Rio Brazos Rd., Aztec, NM 87410
District IV
1220 S. St. Francis Dr., Santa Fe, NM
87505

State of New Mexico
Energy, Minerals and Natural Resources

Form C-103
May 27, 2004

OIL CONSERVATION DIVISION
1220 South St. Francis Dr.
Santa Fe, NM 87505

WELL API NO. 30-045-26077
5. Indicate Type of Lease STATE <input type="checkbox"/> FEE <input checked="" type="checkbox"/>
6. State Oil & Gas Lease No.
7. Lease Name or Unit Agreement Name Monte Carlo
8. Well Number 2
9. OGRID Number
10. Pool name or Wildcat Wildcat Gallup

SUNDRY NOTICES AND REPORTS ON WELLS (DO NOT USE THIS FORM FOR PROPOSALS TO DRILL OR TO DEEPEN OR PLUG BACK TO A DIFFERENT RESERVOIR. USE "APPLICATION FOR PERMIT" (FORM C-101) FOR SUCH PROPOSALS.)	
1. Type of Well: Oil Well Gas Well <input checked="" type="checkbox"/> Other	
2. Name of Operator Dugan Production Corp. c/o BHP Billiton San Juan Coal	
3. Address of Operator PO Box 561, Waterflow, NM 87421 (505) 598-2000	
4. Well Location Unit Letter M : 800 feet from the South line and 910 feet from the West line Section 24 Township 30N Range 15W NMPM San Juan County	
11. Elevation (Show whether DR, RKB, RT, GR, etc.) 5365 ' GL ' KB	
Pit or Below-grade Tank Application <input type="checkbox"/> or Closure <input type="checkbox"/>	
Pit type _____ Depth to Groundwater _____ Distance from nearest fresh water well _____ Distance from nearest surface water _____	
Pit Liner Thickness: _____ mil Below-Grade Tank: Volume _____ bbls; Construction Material _____	

12. Check Appropriate Box to Indicate Nature of Notice, Report or Other Data

NOTICE OF INTENTION TO:

PERFORM REMEDIAL WORK ☐ PLUG AND ABANDON ☐
TEMPORARILY ABANDON ☐ CHANGE PLANS ☐
PULL OR ALTER CASING ☐ MULTIPLE COMPL ☐

OTHER: ☐

SUBSEQUENT REPORT OF:

REMEDIAL WORK ☐ ALTERING CASING ☐
COMMENCE DRILLING OPNS. ☐ P AND A ☐
CASING/CEMENT JOB ☐

OTHER: **Below Grade Marker** ☒

13. Describe proposed or completed operations. (Clearly state all pertinent details, and give pertinent dates, including estimated date of starting any proposed work). SEE RULE 1103. For Multiple Completions: Attach wellbore diagram of proposed completion or recompletion.

RCVD JUL 12 '12
OIL CONS. DIV.
DIST. 3

BHP – San Juan Coal for Dugan Production has set an underground plate instead of a 4" above ground marker to prevent stray electrical currents from entering the underground coal mine. Please find the attached certified survey.

I hereby certify that the information above is true and complete to the best of my knowledge and belief. I further certify that any pit or below-grade tank has been/will be constructed or closed according to NMOCD guidelines ☐, a general permit ☐ or an (attached) alternative OCD approved plan ☐.

SIGNATURE William Clark TITLE Contractor DATE July 10, 2012

Type or print name _____ E-mail address: billc@apluswell.com PHONE: (505)325-2627

For State Use Only

APPROVED BY: [Signature] TITLE Deputy Oil & Gas Inspector, District #3 DATE 11/18/12
Conditions of Approval (if any): AV

P & A WELL SURVEY
MONTE CARLO NO. 2 WELL LOCATED IN THE
SW/4 SW/4 SECTION 24, T.30N., R.15W.,
N.M.P.M., SAN JUAN COUNTY, NEW MEXICO.

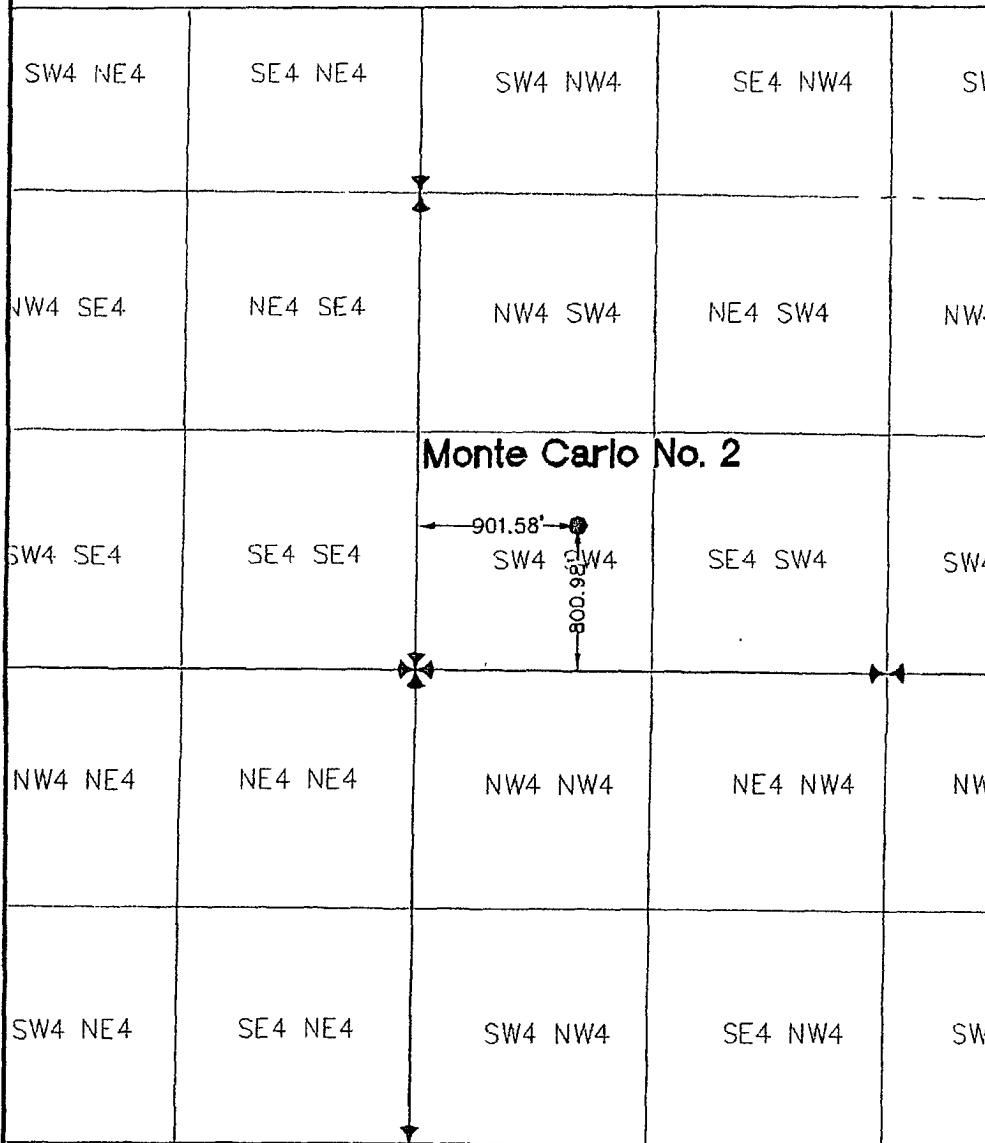

NAD 1927 NEW MEXICO WEST

N2108943.82
E341721.09
EL 5319.08

Lat 36 47 40.58839
Long 108 22 28.33983



SCALE: 1"=500'

BASIS OF BEARING:
STATIC G.P.S. SURVEY, SOLUTIONS
OBTAINED FROM SATELLITES TRACKED
APRIL, 2003. REFERENCE N.A.S.N.
NETWORK POINTS FMN 0 AND E432.
BEARING N 66°37'54" W (NAD87
NEW MEXICO WEST) SCALE FACTOR
= 0.99985810

I, Peter Epp, a Registered Professional Surveyor under the laws of the State of New Mexico, hereby certify that this plat was prepared from the field notes of a actual survey meeting the minimum requirements of the standards for easement surveys and is true and correct to the best of my knowledge and belief.

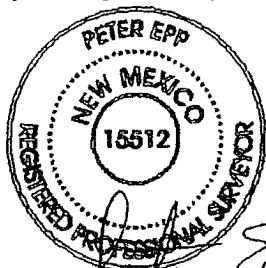

Peter Epp P.L.S. New Mexico L.S. # 15512

Date: 12MAR12

CHECKED BY PE

DRAWN BY RC



EPP & ASSOCIATES, INC.
PROFESSIONAL LAND SURVEYORS

433 4th Avenue West
P.O. Box 837
Craig, CO 81625

Phone (970) 824-8236
Fax (970) 824-5227

Prepared for:
State of New Mexico
Oil Conservation Commission