

Submit 3 Copies To Appropriate District Office
District I
1625 N. French Dr., Hobbs, NM 88240
District II
1301 W. Grand Ave., Artesia, NM 88210
District III
1000 Rio Brazos Rd., Aztec, NM 87410
District IV
1220 S. St. Francis Dr., Santa Fe, NM 87505

State of New Mexico
Energy, Minerals and Natural Resources

OIL CONSERVATION DIVISION
1220 South St. Francis Dr.
Santa Fe, NM 87505

Form C-103
Revised March 25, 1999

WELL API NO. 30-045-32140
5. Indicate Type of Lease STATE <input type="checkbox"/> FEE <input checked="" type="checkbox"/>
6. State Oil & Gas Lease No.

SUNDRY NOTICES AND REPORTS ON WELLS (DO NOT USE THIS FORM FOR PROPOSALS TO DRILL OR TO DEEPEN OR PLUG BACK TO A DIFFERENT RESERVOIR. USE "APPLICATION FOR PERMIT" (FORM C-101) FOR SUCH PROPOSALS.)		7. Lease Name or Unit Agreement Name:
1. Type of Well: Oil Well <input type="checkbox"/> Gas Well <input checked="" type="checkbox"/> Other		
2. Name of Operator Lance Oil & Gas Company, Inc.	8. Well No. WF FRPC 17 #2	
3. Address of Operator PO Box 70, Kirtland, NM 87417	9. Pool name or Wildcat Basin Fruitland Coal	
4. Well Location Unit Letter <u>E</u> : <u>1975</u> feet from the <u>N</u> line and <u>575'</u> feet from the <u>W</u> line Section <u>17</u> Township <u>29N</u> Range <u>14W</u> NMPM County <u>San Juan</u>		
10. Elevation (Show whether DR, RKB, RT, GR, etc.) 5160' GR		

11. Check Appropriate Box to Indicate Nature of Notice, Report or Other Data	
NOTICE OF INTENTION TO:	SUBSEQUENT REPORT OF:
PERFORM REMEDIAL WORK <input type="checkbox"/> PLUG AND ABANDON <input type="checkbox"/>	REMEDIAL WORK <input type="checkbox"/> ALTERING CASING <input type="checkbox"/>
TEMPORARILY ABANDON <input type="checkbox"/> CHANGE PLANS <input type="checkbox"/>	COMMENCE DRILLING OPNS. <input type="checkbox"/> PLUG AND ABANDONMENT <input type="checkbox"/>
PULL OR ALTER CASING <input type="checkbox"/> MULTIPLE COMPLETION <input type="checkbox"/>	CASING TEST AND CEMENT JOB <input type="checkbox"/>
OTHER: <input checked="" type="checkbox"/>	OTHER: <input type="checkbox"/>

12. Describe proposed or completed operations. (Clearly state all pertinent details, and give pertinent dates, including estimated date of starting any proposed work). SEE RULE 1103. For Multiple Completions: Attach wellbore diagram of proposed completion or recompilation.

Lance Oil & Gas Company, Inc. requests Basin Fruitland Coal formation infill well be added to APD, tests indicate no Pictured Cliffs production in area, PC formation will not be completed. Only production will come from FC well. N/2 pro-ration unit. Per revised plat. All other approved conditions remain the same.
NSL approved via Admin. Order NSL 5008.

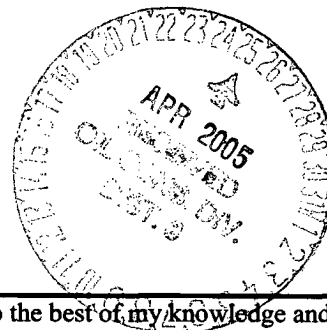

I hereby certify that the information above is true and complete to the best of my knowledge and belief.

SIGNATURE Anne Jones TITLE Sr. Landman DATE 4/19/05
Type or print name Anne Jones Telephone No. 505-598-5601 ex 62

(This space for State use)
APPROVED BY [Signature] TITLE SENIOR OIL & GAS INSPECTOR, DIST. 9 DATE APR 25 2005
Conditions of approval, if any:

State of New Mexico
Energy, Minerals & Mining Resources Department
OIL CONSERVATION DIVISION
2040 South Pacheco
Santa Fe, NM 87505

Form C - 102

☒ AMENDED REPORT

WELL LOCATION AND ACREAGE DEDICATION PLAT

APN Number 30-045- 32140	Pool Code 71429	Pool Name Basin Fruitland Coal
Property Code	Property Name WF FRPC 17	Well Number 2
OGRD No. 19219	Operator Name RICHARDSON OPERATING COMPANY	Elevation 5160'

Surface Location									
U. or Lot E	Sec. 17	Twp. 29 N.	Rgn. 14 W.	Lot Blk.	Feet from 1975'	North/South North	Feet from 575'	East/West West	County SAN JUAN

Bottom Hole Location if Different From Surface									
U. or Lot	Sec.	Twp.	Rgn.	Lot Blk.	Feet from	North/South	Feet from	East/West	County

Dedication 320	Job #	Consolidation	Order No.
--------------------------	-------	---------------	-----------

NO ALLOWABLE WILL ASSIGNED TO THIS COMPLETION UNTIL ALL INTERESTS HAVE BEEN CONSOLIDATED
OR A NON-STANDARD UNIT HAS BEEN APPROVED BY THE DIVISION

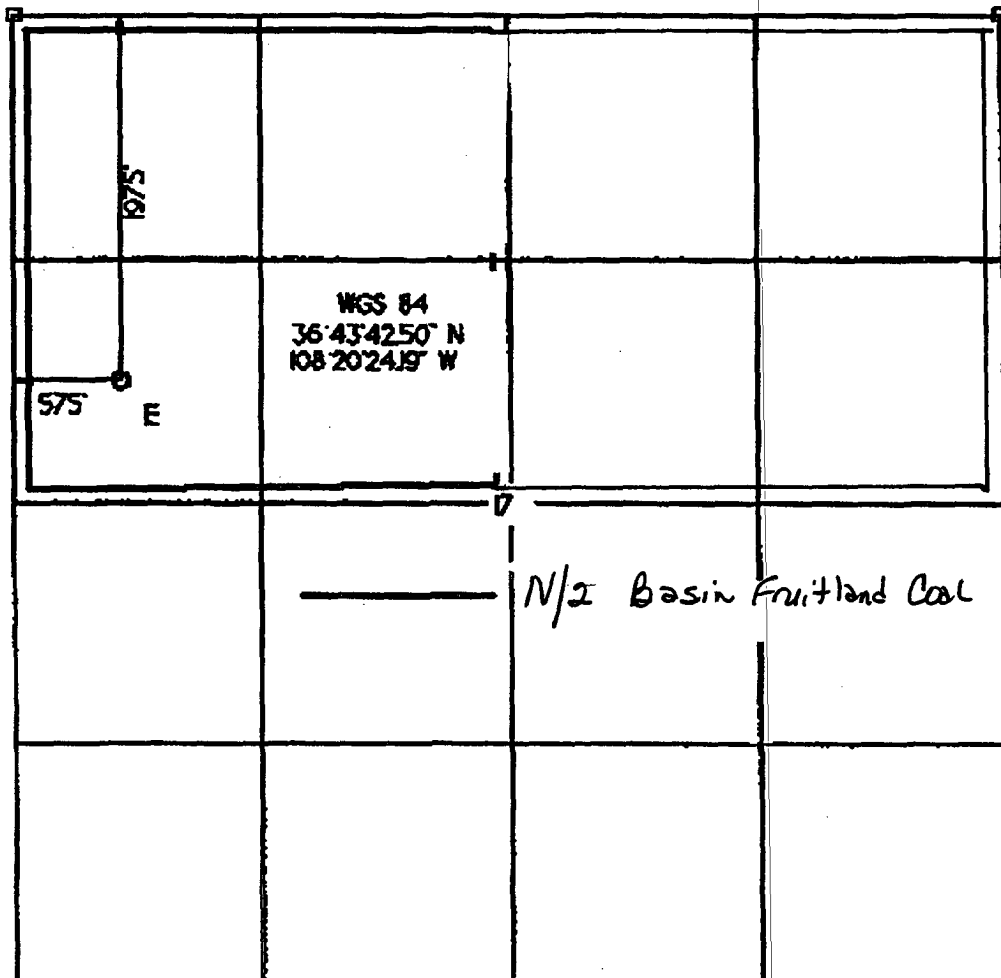

OPERATOR CERTIFICATION
I hereby certify that the information contained herein is true and complete to the best of my knowledge and belief.

Signature
Anne Jones

Printed Name
Anne Jones

Title
Landman

Date
4/19/05

SURVEYOR CERTIFICATION

I hereby certify that the well location on this plat was plotted from field notes of actual surveys made by me or under my supervision, and that the same is true and correct to the best of my belief.

Date of Survey

rev: 01/14/04

Signature and Seal of Professional Surveyor

