

Submit 3 Copies To Appropriate District  
Office  
District I  
1625 N. French Dr., Hobbs, NM 88240  
District II  
1301 W. Grand Ave., Artesia, NM 88210  
District III  
1000 Rio Brazos Rd., Aztec, NM 87410  
District IV  
1220 S. St. Francis Dr., Santa Fe, NM  
87505

State of New Mexico  
Energy, Minerals and Natural Resources  
**OIL-CONSERVATION DIVISION**  
1220 South St. Francis Dr.  
Santa Fe, NM 87505

Form C-103  
May 27, 2004

<b>SUNDRY NOTICES AND REPORTS ON WELLS</b> (DO NOT USE THIS FORM FOR PROPOSALS TO DRILL OR TO DEEPEN OR PLUG BACK TO A DIFFERENT RESERVOIR. USE "APPLICATION FOR PERMIT" (FORM C-101) FOR SUCH PROPOSALS.)		WELL API NO. <b>30-045-32769</b>
1. Type of Well: Oil Well <input type="checkbox"/> Gas Well <input checked="" type="checkbox"/> Other		5. Indicate Type of Lease STATE <input type="checkbox"/> FEE <input type="checkbox"/>
2. Name of Operator <b>BP AMERICA PRODUCTION COMPANY</b>		6. State Oil & Gas Lease No.
3. Address of Operator <b>P.O. BOX 3092 HOUSTON, TX 77079-2064</b>		7. Lease Name or Unit Agreement Name <b>Mudge LS</b>
4. Well Location Unit Letter <u>K</u> : <u>2040</u> feet from the <u>South</u> line and <u>1945</u> feet from the <u>West</u> line Section <u>23</u> Township <u>31N</u> Range <u>11W</u> NMPM <u>SAN JUAN</u> County		8. Well Number <u>7 N</u>
11. Elevation (Show whether DR, RKB, RT, GR, etc.) <u>5795' GR</u>		9. OGRID Number <u>000778</u>
Pit or Below-grade Tank Application <input checked="" type="checkbox"/> or Closure <input type="checkbox"/>		10. Pool name or Wildcat <b>Basin Dakota &amp; Blanco Mesaverde</b>
Pit type <u>DRILLING</u> Depth to Groundwater <u>&gt;100'</u> Distance from nearest fresh water well <u>&lt;5000'</u> Distance from nearest surface water <u>**&lt;100'</u>		
Pit Liner Thickness: <u>12</u> mil Below-Grade Tank: Volume _____ bbls; Construction Material _____		

**\*\*This well is in the drainage leading to the Animas River**

12. Check Appropriate Box to Indicate Nature of Notice, Report or Other Data

NOTICE OF INTENTION TO:		SUBSEQUENT REPORT OF:	
PERFORM REMEDIAL WORK <input type="checkbox"/>	PLUG AND ABANDON <input type="checkbox"/>	REMEDIAL WORK <input type="checkbox"/>	ALTERING CASING <input type="checkbox"/>
TEMPORARILY ABANDON <input type="checkbox"/>	CHANGE PLANS <input type="checkbox"/>	COMMENCE DRILLING OPNS. <input type="checkbox"/>	P AND A <input type="checkbox"/>
PULL OR ALTER CASING <input type="checkbox"/>	MULTIPLE COMPL <input type="checkbox"/>	CASING/CEMENT JOB <input type="checkbox"/>	
OTHER: <u>LINED DRILLING PIT</u> <input checked="" type="checkbox"/>		OTHER: <input type="checkbox"/>	

13. Describe proposed or completed operations. (Clearly state all pertinent details, and give pertinent dates, including estimated date of starting any proposed work). SEE RULE 1103. For Multiple Completions: Attach wellbore diagram of proposed completion or recompletion.

Construct a lined drilling pit per BP America – San Juan Basin Drilling/ Workover Pit Construction Plan issued date of 11/17/2004. Pit will be closed according to closure plan on file.

Surface location changed due to cactus. BLM approved above surface location 6/14/05

I hereby certify that the information above is true and complete to the best of my knowledge and belief. I further certify that any pit or below-grade tank has been/will be constructed or closed according to NMOCD guidelines ☒, a general permit ☐ or an (attached) alternative OCD-approved plan ☐.

SIGNATURE Cherry Hlava TITLE Regulatory Analyst DATE 06/14/2005  
Type or print name Cherry Hlava E-mail address: hlavac@bp.com Telephone No. 281-366-4081

**For State Use Only**

APPROVED BY: [Signature] TITLE DEPUTY OIL & GAS INSPECTOR, DIST. 8 DATE JUN 17 2005  
Conditions of Approval (if any): \_\_\_\_\_

PAD LAYOUT PLAN & PROFILE  
 BP AMERICA PRODUCTION COMPANY  
 Mudge LS #7N  
 2040' F/SL 1945' F/WL  
 SEC. 23, T31N, R11W, N.M.P.M.  
 SAN JUAN COUNTY, NEW MEXICO

Lat: 36.8825°  
 Long: 107.9631°  
 Lat: 36°52'57"  
 Long: 107°57'47"

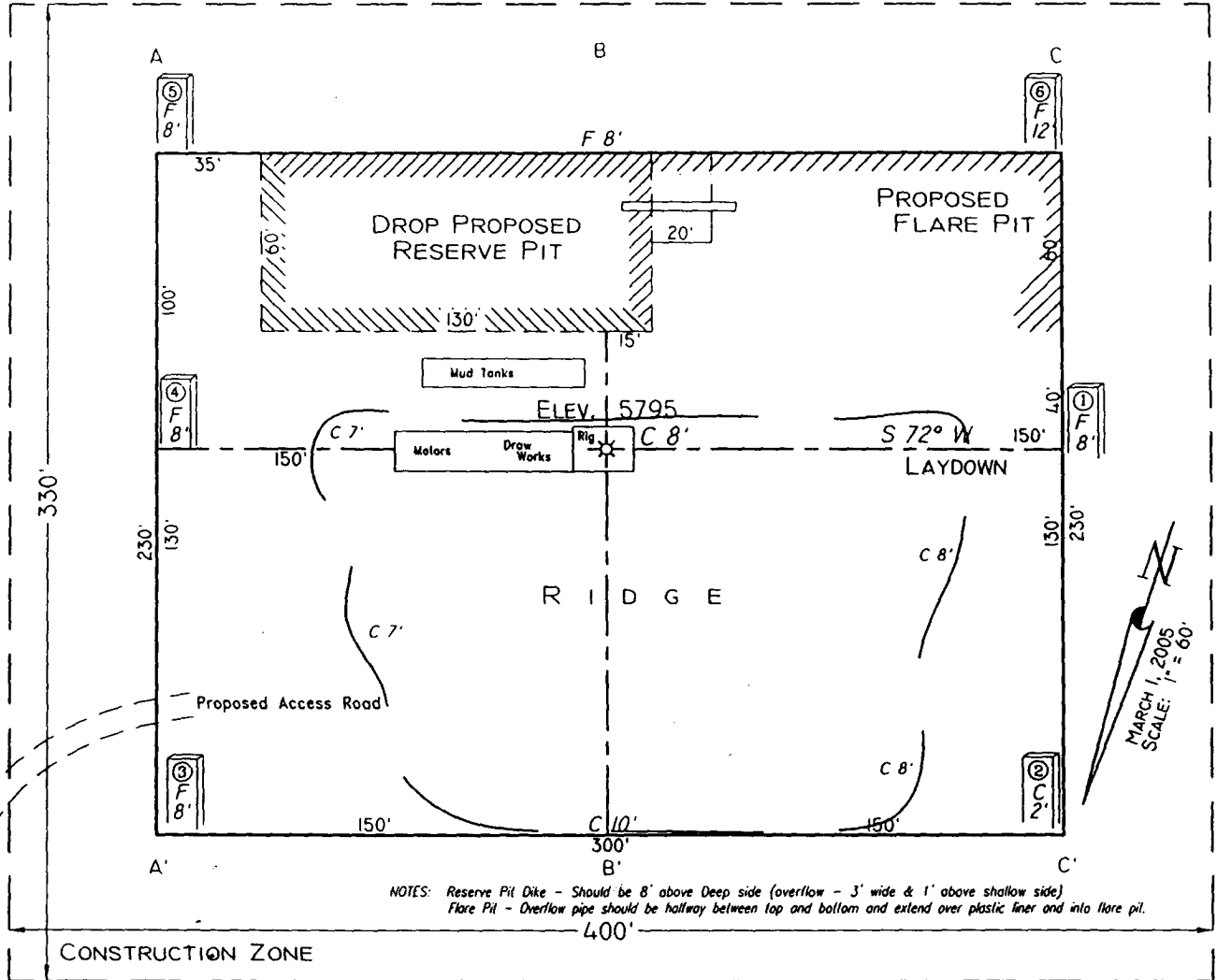

NOTES: Reserve Pit Dike - Should be 8' above Deep side (overflow - 3' wide & 1' above shallow side)  
 Flare Pit - Overflow pipe should be halfway between top and bottom and extend over plastic liner and into flare pit.

CONSTRUCTION ZONE

Area of Construction Zone - 330'x400' or 3.03 acres, more or less.

SCALE: 1"=60' HORIZ.  
 1"=40' VERT.

County Road 2900

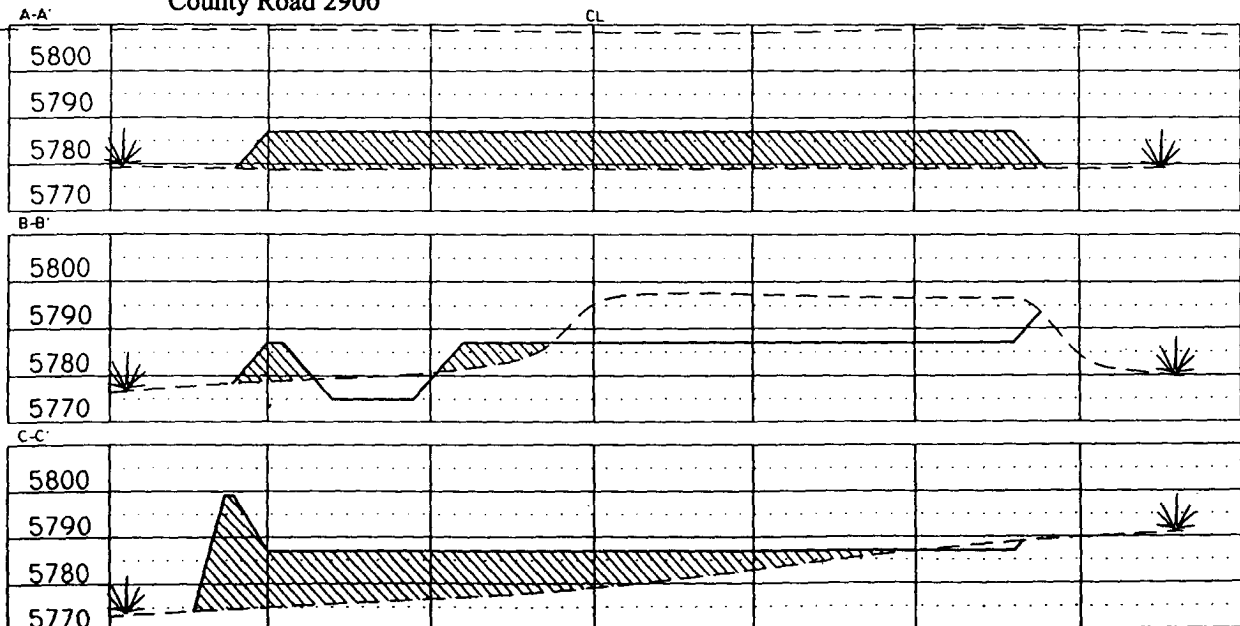

NOTE: Contractor shall call One-Call for location of any marked or unmarked pipelines or cables well pad and/or access at least two (2) working prior to construction.

Cuts and fills shown approximate - final final elevation is to be adjusted by earthwork balance. Slopes are approximate and include additional areas for sideslopes and drainage. Final Pad Dimensions to be verified by Contractor.

VANN SURV.  
 P. O. Box 1  
 Farmington,