

UNITED STATES
DEPARTMENT OF THE INTERIOR
BUREAU OF LAND MANAGEMENT

FORM APPROVED
OMB No. 1004-0137
Expires: March 31, 2007

SUNDRY NOTICES AND REPORTS ON WELLS

Do not use this form for proposals to drill or to re-enter an abandoned well. Use Form 3160-3 (APD) for such proposals.

5. Lease Serial No.
SF-079353

6. If Indian, Allottee or Tribe Name

7. If Unit or CA/Agreement, Name and/or No.

8. Well Name and No.

San Juan 32-8 Unit #260A

9. API Well No.

30-045-32750

10. Field and Pool, or Exploratory Area
Basin Fruitland Coal

11. County or Parish, State

San Juan County, NM

SUBMIT IN TRIPLICATE- Other instructions on reverse side.

1. Type of Well
☐ Oil Well ☒ Gas Well ☐ Other

2. Name of Operator
ConocoPhillips Company

3a. Address
4001 Penbrook, Odessa, TX 79762

3b. Phone No. (include area code)
432-368-1352

4. Location of Well (Footage, Sec., T., R., M., or Survey Description)

Surface: SWSW 1200 FSL - 300 FWL Section 17, T32N, R8W, NMPM
Bottom Hole: NESE 1500 FSL - 700 FEL, Section 18, T32N, R8W, NMPM

12. CHECK APPROPRIATE BOX(ES) TO INDICATE NATURE OF NOTICE, REPORT, OR OTHER DATA

TYPE OF SUBMISSION

TYPE OF ACTION

- ☒ Notice of Intent
☐ Subsequent Report
☐ Final Abandonment Notice

- ☐ Acidize
☐ Alter Casing
☐ Casing Repair
☐ Change Plans
☐ Convert to Injection
☐ Deepen
☐ Fracture Treat
☐ New Construction
☐ Plug and Abandon
☐ Plug Back
☐ Production (Start/Resume)
☐ Reclamation
☐ Recomplete
☐ Temporarily Abandon
☐ Water Disposal

- ☐ Water Shut-Off
☐ Well Integrity
☒ Other **Move location & drill as a directional well**

13. Describe Proposed or Completed Operation (clearly state all pertinent details, including estimated starting date of any proposed work and approximate duration thereof. If the proposal is to deepen directionally or recompleat horizontally, give subsurface locations and measured and true vertical depths of all pertinent markers and zones. Attach the Bond under which the work will be performed or provide the Bond No. on file with BLM/BIA. Required subsequent reports shall be filed within 30 days following completion of the involved operations. If the operation results in a multiple completion or recompletion in a new interval, a Form 3160-4 shall be filed once testing has been completed. Final Abandonment Notices shall be filed only after all requirements, including reclamation, have been completed, and the operator has determined that the site is ready for final inspection.)

ConocoPhillips requests to move the location of this well and drill as a directional wellbore as per the attached revised supporting documents.

The new location of this well will be:

Surface: SWSW 1200 FSL - 300 FWL Section 17, T32N, R8W, NMPM
Bottom Hole: NESE 1500 FSL - 700 FEL, Section 18, T32N, R8W, NMPM

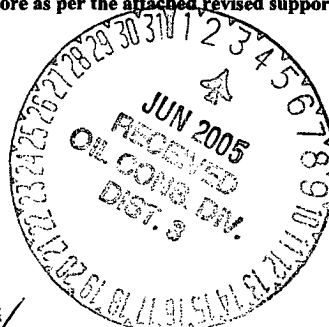

HOLD C104 FOR Directional Survey

14. I hereby certify that the foregoing is true and correct
Name (Printed/Typed)

Vicki Westby

Title Staff Agent

Signature

Vicki Westby (pj)

Date

05/19/2005

THIS SPACE FOR FEDERAL OR STATE OFFICE USE

Approved by

Ray Sene

Title Branch Chief EP

Date

6/1/05

Conditions of approval, if any, are attached. Approval of this notice does not warrant or certify that the applicant holds legal or equitable title to those rights in the subject lease which would entitle the applicant to conduct operations thereon.

Office

FFO

Title 18 U.S.C. Section 1001 and Title 43 U.S.C. Section 1212, make it a crime for any person knowingly and willfully to make to any department or agency of the United States any false, fictitious or fraudulent statements or representations as to any matter within its jurisdiction.

(Instructions on page 2)

NMOC

District I
1625 N. French Dr., Hobbs, NM 88240
District II
1301 W. Grand Avenue, Artesia, NM 88210
District III
1000 Rio Brazos Rd., Aztec, NM 87410
District IV
1220 S. St. Francis Dr., Santa Fe, NM 87505

State of New Mexico
Energy, Minerals & Natural Resources Department
OIL CONSERVATION DIVISION
1220 South St. Francis Dr.
Santa Fe, NM 87505
OTC FARMING

Form C-
Revised June 10, 2000
Submit to Appropriate District Office
State Lease - 4 Copies
Fee Lease - 3 Copies

☐ AMENDED REPORT

WELL LOCATION AND ACREAGE DEDICATION PLAT

BASIN FRUITLAND COAL (GAS)

*API Number 30-045-32750		*Pool Code 71629		*Pool Name	
*Property Code 31330		*Property Name SAN JUAN 32-8 UNIT			
*OGRID No. 217817		*Operator Name CONOCOPHILLIPS COMPANY			
*Well Number 260A		*Elevation 6752			

10 Surface Location					
UL or lot no. M	Section 17	Township 32N	Range 08W	Lot Idn 1200	Feet from the North/South line 300
Feet from the East/West line WEST					
County SAN JUAN					

11 Bottom Hole Location If Different From Surface					
UL or lot no. I	Section 18	Township 32N	Range 08W	Lot Idn 1500	Feet from the North/South line 700
Feet from the East/West line EAST					
County SAN JUAN					

*Dedicated Acres 272.95		*Joint or Infill	*Consolidation Code	*Order No.
----------------------------	--	------------------	---------------------	------------

NO ALLOWABLE WILL BE ASSIGNED TO THIS COMPLETION UNTIL ALL INTERESTS HAVE BEEN CONSOLIDATED OR A NON-STANDARD UNIT HAS BEEN APPROVED BY THE DIVISION

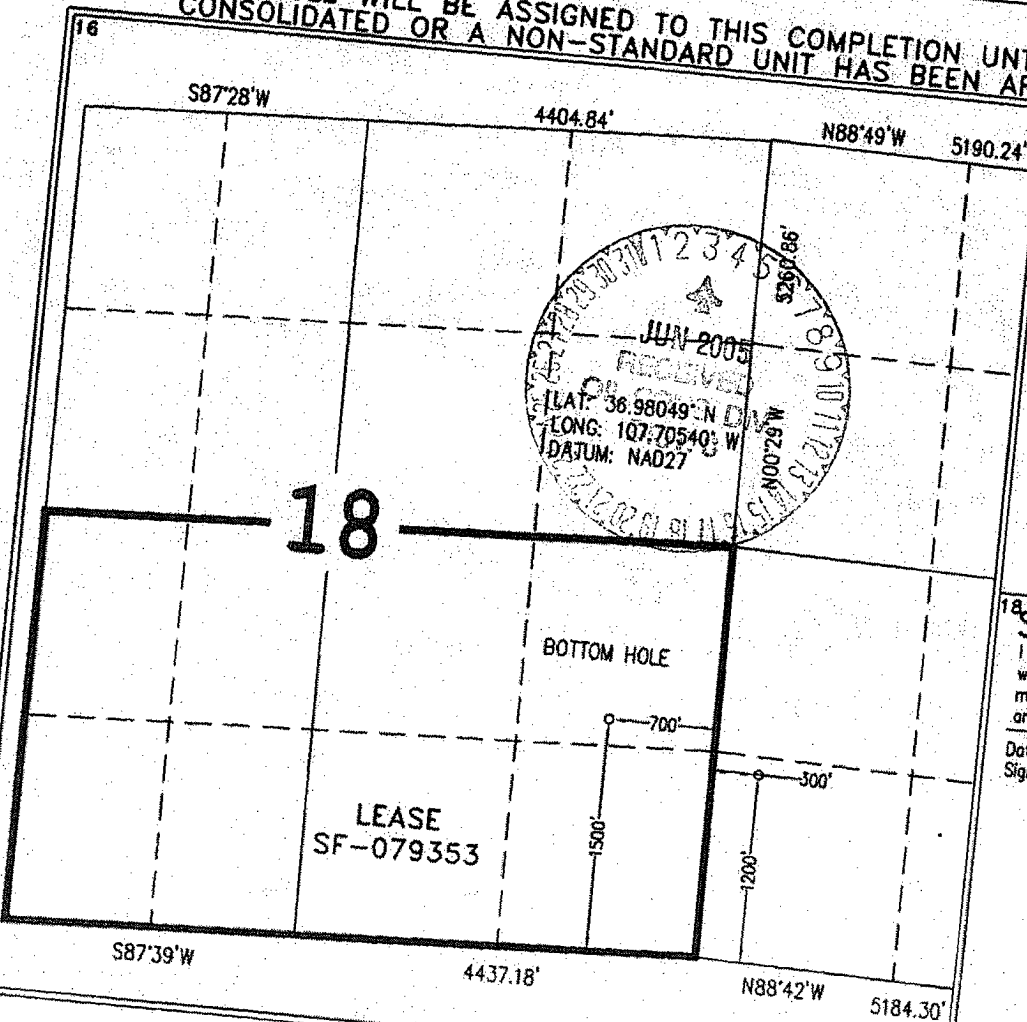

17 OPERATOR CERTIFICATION

I hereby certify that the information contained herein is true and complete to the best of my knowledge and belief.

Vicki Westby
Signature

Vicki Westby
Printed Name

Staff Agent
Title and E-mail Address

5/19/2005
Date

18 SURVEYOR CERTIFICATION

I hereby certify that the well location shown on this plat was plotted from field notes of actual surveys made by me or under my supervision, and that the same is true and correct to the best of my belief.

Date of Survey: 03/10/05

Signature and Seal of Professional Surveyor

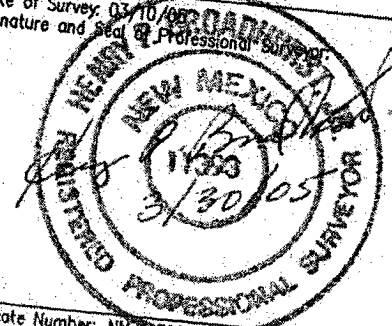

Certificate Number

Submit 3 Copies To Appropriate District
Office
District I
1625 N. French Dr., Hobbs, NM 88240
District II
1301 W. Grand Ave., Artesia, NM 88210
District III
1000 Rio Brazos Rd., Aztec, NM 87410
District IV
1220 S. St. Francis Dr., Santa Fe, NM
87505

State of New Mexico
Energy, Minerals and Natural Resources

Form C- 1 03
May 27, 2004

OIL CONSERVATION DIVISION
1220 South St. Francis Dr.
Santa Fe, NM 87505

WELL API NO.

5. Indicate Type of Lease

STATE ☐ FEE ☐

6. State Oil & Gas Lease No.

7. Lease Name or Unit Agreement Name

San Juan 32-8 Unit

8. Well Number 260A

9. OGRID Number 217817

10. Pool name or Wildcat

Basin Fruitland Coal

SUNDRY NOTICES AND REPORTS ON WELLS

(DO NOT USE THIS FORM FOR PROPOSALS TO DRILL OR TO DEEPEN OR PLUG BACK TO A DIFFERENT RESERVOIR. USE "APPLICATION FOR PERMIT" (FORM C-101) FOR SUCH PROPOSALS.)

1. Type of Well: Oil Well ☐ Gas Well ☒ Other

2. Name of Operator
ConocoPhillips Company

3. Address of Operator
4001 Penbrook, Odessa, TX 79762

4. Well Location
Unit Letter M 1200 feet from the South line and 300 feet from the West line
Section 17 Township 32N Range 8W NMPM San Juan County

11. Elevation (Show whether DR, RKB, RT, GR, etc.)
6752' GL

Pit or Below-grade Tank Application ☒ Closure ☐

Pit type drill Depth to Groundwater 210' Distance from nearest fresh water well > 1 Mile Distance from nearest surface water 200'

Liner Thickness: mil Below-Grade Tank: Volume bb1s; Construction Material

12. Check Appropriate Box to Indicate Nature of Notice, Report or Other Data

NOTICE OF INTENTION TO:

PERFORM REMEDIAL WORK ☐ PLUG AND ABANDON ☐
TEMPORARILY ABANDON ☐ CHANGE PLANS ☐
PULL OR ALTER CASING ☐ MULTIPLE COMPL ☐

OTHER: ☐

SUBSEQUENT REPORT OF:

REMEDIAL WORK ☐ ALTERING CASING ☐
COMMENCE DRILLING OPNS. ☐ P AND A ☐
CASING/CEMENT JOB ☐

OTHER: ☐

13. Describe proposed or completed operations. (Clearly state all pertinent details, and give pertinent dates, including estimated date of starting any proposed work). SEE RULE 1103. For Multiple Completions: Attach wellbore diagram of proposed completion or recompletion.

The pit will be constructed and closed in accordance with Rule 50 and as per the Nov. 1, 2004 Guidelines. See the attached diagram that details the location of the pit in reference to the proposed wellhead. The drill pit will be lined. The drill pit will be closed after the well has been completed.

I hereby certify that the information above is true and complete to the best of my knowledge and belief. I further certify that any pit or below-grade tank has been/will be constructed or closed according to NMOCD guidelines ☐, a general permit ☐ or an (attached) alternative OCD-approved plan ☐

SIGNATURE Vicki Westby

TITLE Staff Agent

DATE 5/19/2005

Type or print name

E-mail address:

Telephone No.

For State Use Only

APPROVED BY: TITLE DATE
Conditions of Approval (if any):

CONOCOPHILLIPS COMPANY SAN JUAN 32-8 UNIT #260A
 1200' FSL & 300' FWL, SECTION 17, T32N, R08W, NMPM
 SAN JUAN COUNTY, NEW MEXICO ELEVATION: 6752'

LATITUDE: 36.98049° N
 LONGITUDE: 107.70540° W
 DATUM: NAD27

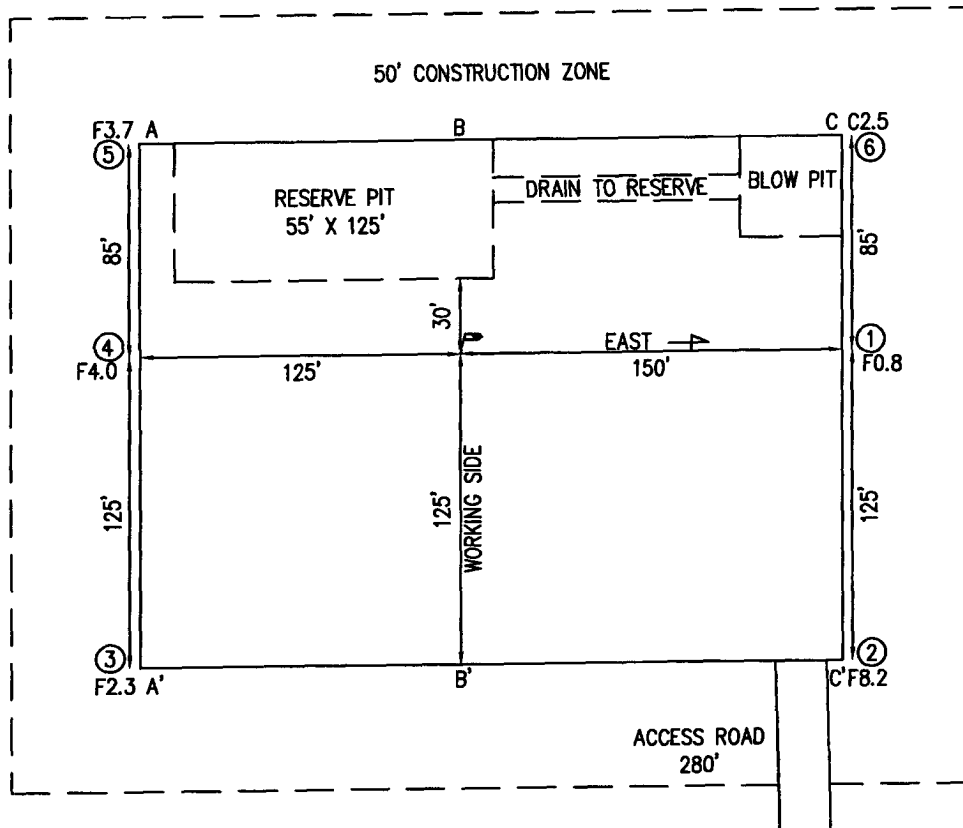

PLAT NOTE:
 SURFACE OWNER
 BLM

A-A'						
6762'						
6752'						
6742'						

B-B'						
6762'						
6752'						
6742'						

C-C'						
6762'						
6752'						
6742'						

PROJECT PROPOSAL - New Drill / Sidetrack

SAN JUAN 32-8 260A

Lease:		AFE #: WAN.CBM.5141		AFE \$:	
Field Name: hPHILLIPS 32-8		Rig:	State: NM	County: SAN JUAN	API #:
Geoscientist: Cloud, Tom A		Phone: +1 832 486-2377	Prod. Engineer: Limb, H G		Phone: 1-832-486-2427
Res. Engineer: Peterson, Brad T		Phone: 486-2055	Proj. Field Lead:		Phone:

Primary Objective (Zones):

Zone	Zone Name
JCV	BASIN FRUITLAND COAL (GAS)

Location: Surface

Straight Hole

Latitude: 36.98	Longitude: -107.71	X:	Y:	Section: 17	Range: 8W
Footage X: 300 FWL	Footage Y: 1200 FSL	Elevation: 6752	(FT)	Township: 32N	

Tolerance:

Location: Bottom Hole

Straight Hole

Latitude:	Longitude:	X:	Y:	Section: 18	Range: 8W
Footage X: 700 FEL	Footage Y: 1500 FSL	Elevation:	(FT)	Township: 32N	

Tolerance:

Location Type: Year Round Start Date (Est.): Completion Date: Date In Operation:

Formation Data: Assume KB = 6765 Units = FT

Formation Call & Casing Points	Depth (TVD in Ft)	SS (Ft)	Depletion (Yes/No)	BHP (PSIG)	BHT	Remarks
SAN JOSE	13	6752	<input type="checkbox"/>			
SURFACE CSG	213	6552	<input type="checkbox"/>			12-1/4 hole. 9 5/8" 32.3 ppf, H-40, STC casing. Circulate cement to surface.
NCMT	765	6000	<input type="checkbox"/>			
OJAM	2280	4485	<input type="checkbox"/>			
KRLD	2330	4435	<input type="checkbox"/>			
FRLD	3235	3530	<input type="checkbox"/>			
Intermediate Casing	3265	3500	<input type="checkbox"/>			8 3/4" Hole. 7", 23 ppf, J-55, LTC Casing. Circulate cement to surface.
TOP COAL	3280	3485	<input type="checkbox"/>			
BASE MAIN COAL	3465	3300	<input type="checkbox"/>	1100		
BASE LOWEST COAL	3660	3105	<input type="checkbox"/>			
PCCF	3660	3105	<input type="checkbox"/>			
Total Depth	3740	3025	<input type="checkbox"/>			6-1/4" hole possibly underreamed to 9.5". Optional Liner: 5.5", 15.5#, J-55 LTC - left uncemented.

Reference Wells:

Reference Type	Well Name	Comments
----------------	-----------	----------

PROJECT PROPOSAL - New Drill / Sidetrack

SAN JUAN 32-8 260A

Logging Program:					
Intermediate Logs: <input type="checkbox"/> Log only if show <input type="checkbox"/> GR/ILD <input type="checkbox"/> Triple Combo					
TD Logs: <input type="checkbox"/> Triple Combo <input type="checkbox"/> Dipmeter <input type="checkbox"/> RFT <input type="checkbox"/> Sonic <input type="checkbox"/> VSP <input type="checkbox"/> TDT					
TD includes 80 feet sump/rathole & COPC will comply with					
Additional Information: the BLM's Conditions of Approval for the proposed sump/rathole in this non-producing Pictured Cliffs formation					
Log Type	Stage	From (Ft)	To (Ft)	Tool Type/Name	Remarks

Comments: Location/Tops/Logging - Directional well. Mud Log from intermediate casing shoe to TD will be obtained.

Zones - Mud Log from intermediate casing shoe to TD will be obtained.

Drilling Mud Program:

Surface: spud mud

Intermediate: fresh water mud with bentonite and polymer as needed

Below Intermediate: air/mist drilling media with foamer, polymer, & corrosion inhibitor as needed

Centralizer Program:

Surface: centralizers placed 10' above the shoe latched over a stop collar and at the top of the 2nd, 3rd, & 4th joints

Intermediate: centralizers placed 10' above the shoe latched over a stop collar and at the top of the 2nd, 4th, 6th, 8th, & 10th joints

Turbolizers placed one per joint from the top of the Ojo Alamo to the top of the Kirtland Shale

BHL Hardlines: must stay south of 1980 FSL and west of 10' FEL sec. 18

General/Work Description -

San Juan 32-8 #260A

Formation	TVD	MD
San Jose	13	13
Surface Casing	213	213
NCMT	765	769.85
OJAM	2280	2496.69
KRLD	2330	2550.03
FRLD	3235	3473.76
Intermediate Casing	3265	3503.76
TOP COAL	3280	3518.76
Base Main Coal	3465	3703.76
Base Lowest Coal	3660	3898.76
PCCF	3660	3898.76
Total Depth	3740	3978.76

San Juan 32-8 # 260A
Halliburton Cementing Program

SURFACE CASING :

Drill Bit Diameter	12.25"	
Casing Outside Diameter	9.625"	Casing Inside Diam. 9.001"
Casing Weight	32.3	ppf
Casing Grade	H-40	
Shoe Depth	230'	
Cement Yield	1.21	cuft/sk
Cement Density	15.6	lb/gal
Excess Cement	125	%
Cement Required	141	sx

SHOE 230 ', 9.625 ", 32.3 ppf, H-40 STC

INTERMEDIATE CASING :

Drill Bit Diameter	8.75"	
Casing Outside Diameter	7"	Casing Inside Diam. 6.456"
Casing Weight	20	ppf
Casing Grade	J-55	
Shoe Depth	3504'	
Lead Cement Yield	2.91	cuft/sk
Lead Cement Density	11.5	lb/gal
Lead Cement Excess	160	%
Tail Cement Length	315'	
Tail Cement Yield	1.33	cuft/sk
Tail Cement Density	13.5	lb/gal
Tail Cement Excess	160	%
Lead Cement Required	411	sx
Tail Cement Required	100	sx

LINER TOP 3484 '

SHOE 3504 ', 7 ", 20 ppf, J-55

LINER BOTTOM 3979' (Uncemented)

SAN JUAN 32-8 #260A
HALLIBURTON OPTION

9-5/8 Surface Casing		
Cement Recipe	Standard Cement	
	+ 3% Calcium Chloride	
	+ 0.25 lb/sx Flocele	
Cement Volume	141	sx
Cement Yield	1.21	cuft/sx
Slurry Volume	170.7	cuft
	30.4	bbls
Cement Density	15.6	ppg
Water Required	5.29	gal/sx

7" Intermediate Casing		
Lead Slurry		
Cement Recipe	Standard Cement	
	+ 3% Econolite (Lost Circulation Additive)	
	+ 10 lb/sx Gilsonite (Lost Circ. Additive)	
	+ 0.25 lb/sx Flocele (Lost Circ. Additive)	
Cement Required	411	sx
Cement Yield	2.91	cuft/sx
Slurry Volume	1194.9	cuft
	212.8	bbls
Cement Density	11.5	ppg
Water Required	16.88	gal/sx

7" Intermediate Casing		
Tail Slurry		
Cement Slurry	50 / 50 POZ: Standard Cement	
	+ 2% Bentonite (Light Weight Additive)	
	+ 5 lbm/sk Gilsonite (Lost Circ. Additive)	
	+ 0.25 lbm/sk Flocele (lost Circ. Additive)	
	+ 2% Calcium Chloride (Accelerator)	
Cement Required	100	sx
Cement Yield	1.33	cuft/sx
Slurry Volume	132.7	cuft
	23.6	bbls
Cement Density	13.5	ppg
Water Required	5.36	gal/sx

SCHLUMBERGER OPTION

9-5/8 Surface Casing		
Cement Recipe	Class G Cement	
	+ 3% S001 Calcium Chloride	
	+ 0.25 lb/sx D029 Cellophane Flakes	
Cement Volume	147	sx
Cement Yield	1.16	cuft/sx
Slurry Volume	170.7	cuft
	30.4	bbls
Cement Density	15.8	ppg
Water Required	4.983	gal/sx

7" Intermediate Casing		
Lead Slurry		
Cement Recipe	Class G Cement	
	+ 3% D079 Extender	
	+ 0.25 lb/sx D029 Cellophane Flakes	
	+ 0.2% D046 Antifoam)	
Cement Required	460	sx
Cement Yield	2.61	cuft/sx
Slurry Volume	1200.8	cuft
	213.9	bbls
Cement Density	11.7	ppg
Water Required	15.876	gal/sx

7" Intermediate Casing		
Tail Slurry		
Cement Slurry	50 / 50 POZ : Class G Cement	
	+ 2% D020 Bentonite	
	+ 5 lb/sx D024 Gilsonite extender	
	+ 0.25 lb/sx D029 Cellophane Flakes	
	+ 2% S001 Calcium Chloride	
	+ 0.2% D046 Antifoam	
Cement Required	100	sx
Cement Yield	1.27	cuft/sx
Slurry Volume	126.9	cuft
	22.6	bbls
Cement Density	13.5	ppg
Water Required	5.182	gal/sx

Property : San Juan 32-8 Well #: 260A

Surface Location:

Unit: M Section: 17 Township: 32N Range: 8W

County: San Juan State: New Mexico

Footage: 1200 from the South line, 300 from the West line.

CATHODIC PROTECTION

ConocoPhillips (COP) proposes to drill a cathodic protection deep well groundbed for the subject well. COP will drill a hole vertically at the surface large enough to accommodate 20 feet of 8 inch diameter PVC pipe for surface casing to assist in further drilling and loading. Casing may be cemented in place for stability if needed. COP will drill a 6-7/8" hole to an anticipated minimum depth of 300' (maximum depth of 500'). Cement plugs will not be used unless more than one water zone is encountered. Prior drilling history for the area indicates only one zone to that depth. If more than one water zone is encountered, notification will be made and details of cement and casing will be provided.

All drilling activity will remain on the existing well pad and a Farmington based company will be doing the drilling for ConocoPhillips.