

All distances must be from the outer boundaries of the Section.

Operator Meridian Oil Inc.		Lease ALLISON UNIT (E-504-10)		Well No. 100
Unit Letter K	Section 16	Township 32-N	Range 6-W	County SAN JUAN
Actual Footage Location of Wells 1780 feet from the SOUTH line and 1540 feet from the WEST line				
Ground Level Elev. 6137	Producing Formation Fruitland Coal	Pool Basin	Dedicated Acreage 12320 Acres	

1. Outline the acreage dedicated to the subject well by colored pencil or hachure marks on the plat below.
2. If more than one lease is dedicated to the well, outline each and identify the ownership thereof (both as to working interest and royalty).
3. If more than one lease of different ownership is dedicated to the well, have the interests of all owners been consolidated by communitization, unitization, force-pooling, etc?

☒ Yes ☐ No If answer is "yes," type of consolidation Unitization

If answer is "no," list the owners and tract descriptions which have actually been consolidated. (Use reverse side of this form if necessary.)

No allowable will be assigned to the well until all interests have been consolidated (by communitization, unitization, forced-pooling, or otherwise) or until a non-standard unit, eliminating such interests, has been approved by the Division.

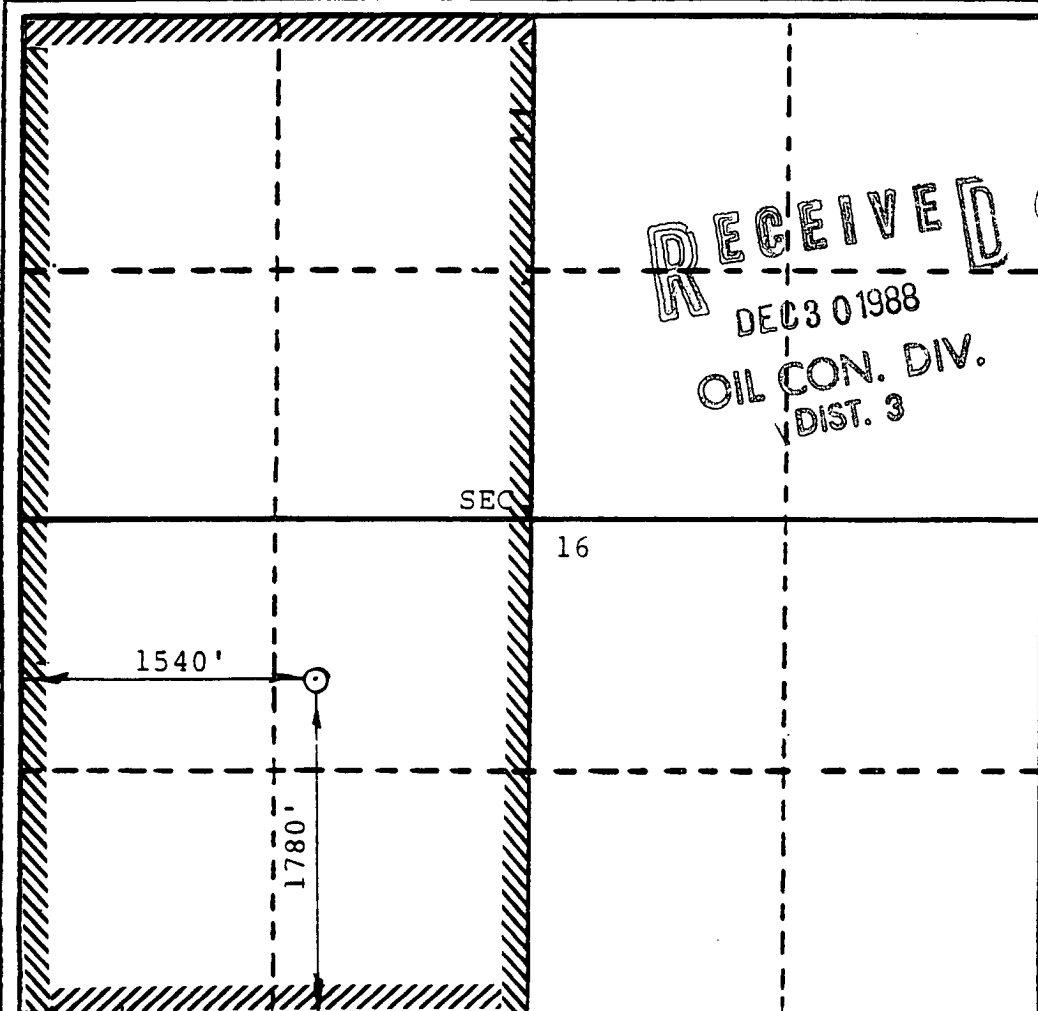

CERTIFICATION

I hereby certify that the information contained herein is true and complete to the best of my knowledge and belief.

*[Signature]*

Name  
Regulatory Affairs  
Position  
Meridian Oil Inc.

Company  
12-27-88

Date

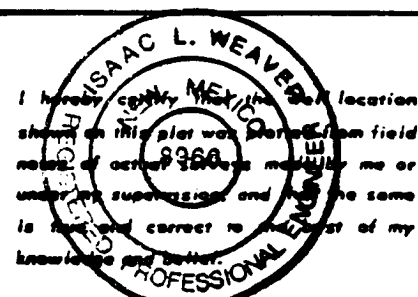

MARCH 9, 1988

Date Surveyed  
ISAAC L. WEAVER  
Registered Professional Engineer  
and/or Land Surveyor

Certificate No.

8966